

Responsibility is not accepted for errors made by others in scaling from this drawing. All construction information should be taken from figured dimensions only.

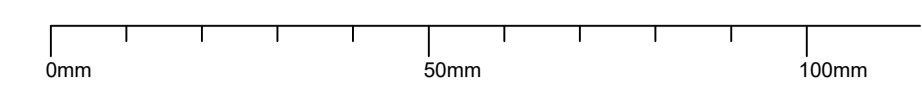

A1 Original Sheet Size

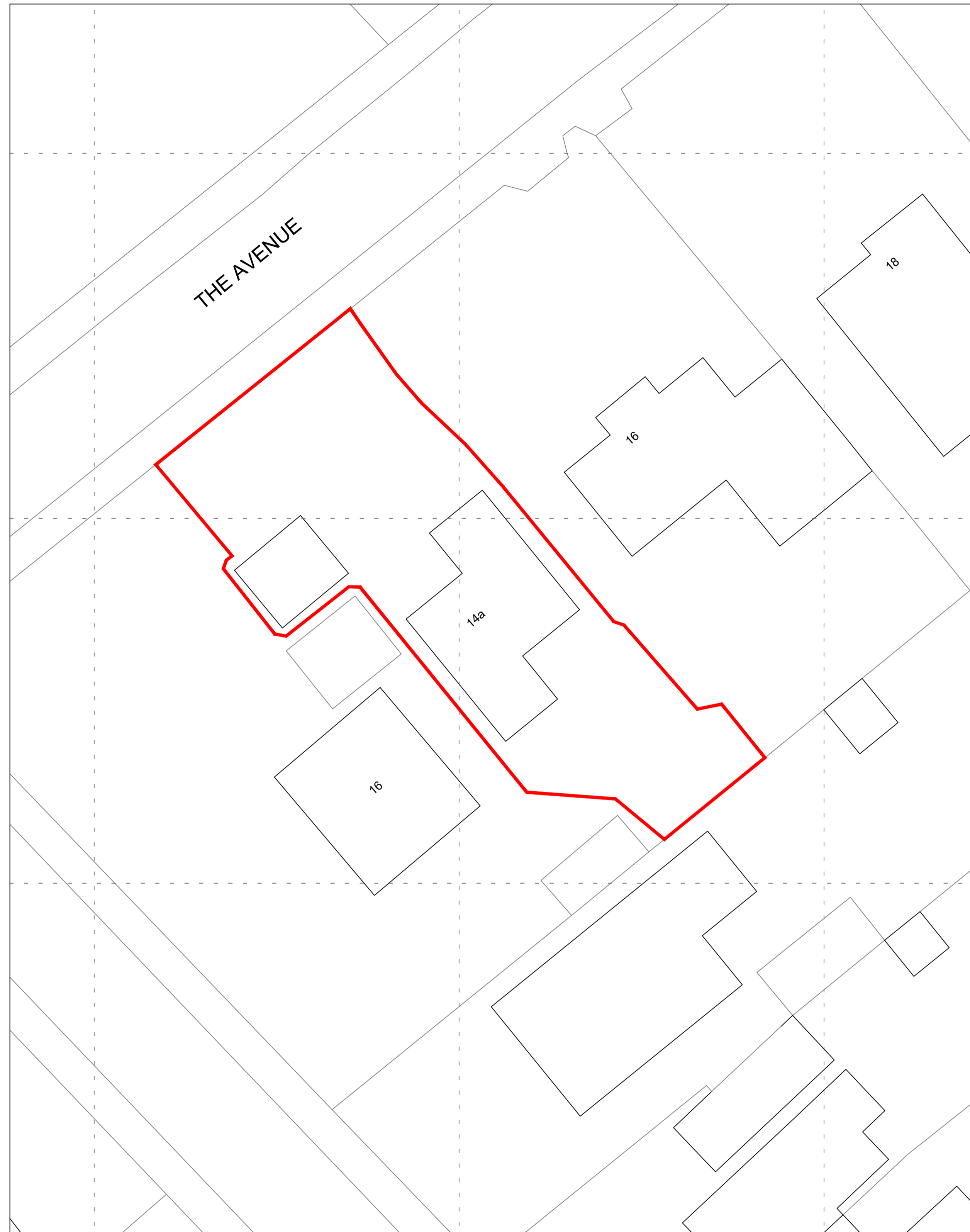

BLOCK PLAN - EXISTING



BLOCK PLAN - PROPOSED

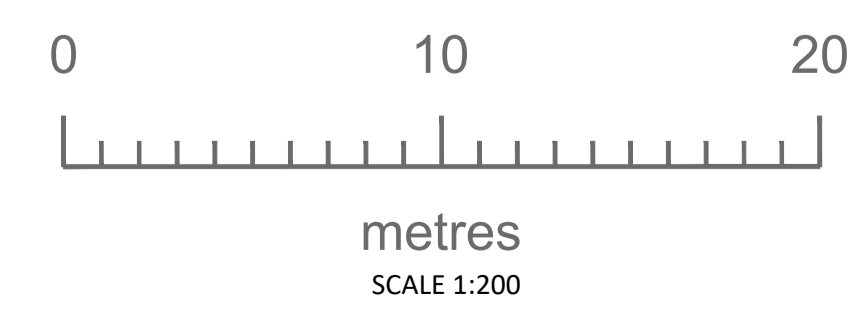

rev	date	description
0	NOV' 21	PLANNING APPLICATION ISSUE

SJP Planning & Design
79 Weston Road,
Long Ashton,
Bristol.
BS41 9AD

Tel: 07977 224502
Email: steve.popper@blueyonder.co.uk

project: PROPOSED LOFT ALTERATION TO:
14A THE AVENUE
CLEVEDON
NORTH SOMERSET
BS21 7ED

title: EXISTING AND PROPOSED
SITE LAYOUT PLAN

drawn SP checked IL
date NOV' 21 size A1
scale 1:200

number 195-21-PA-007 rev 0