

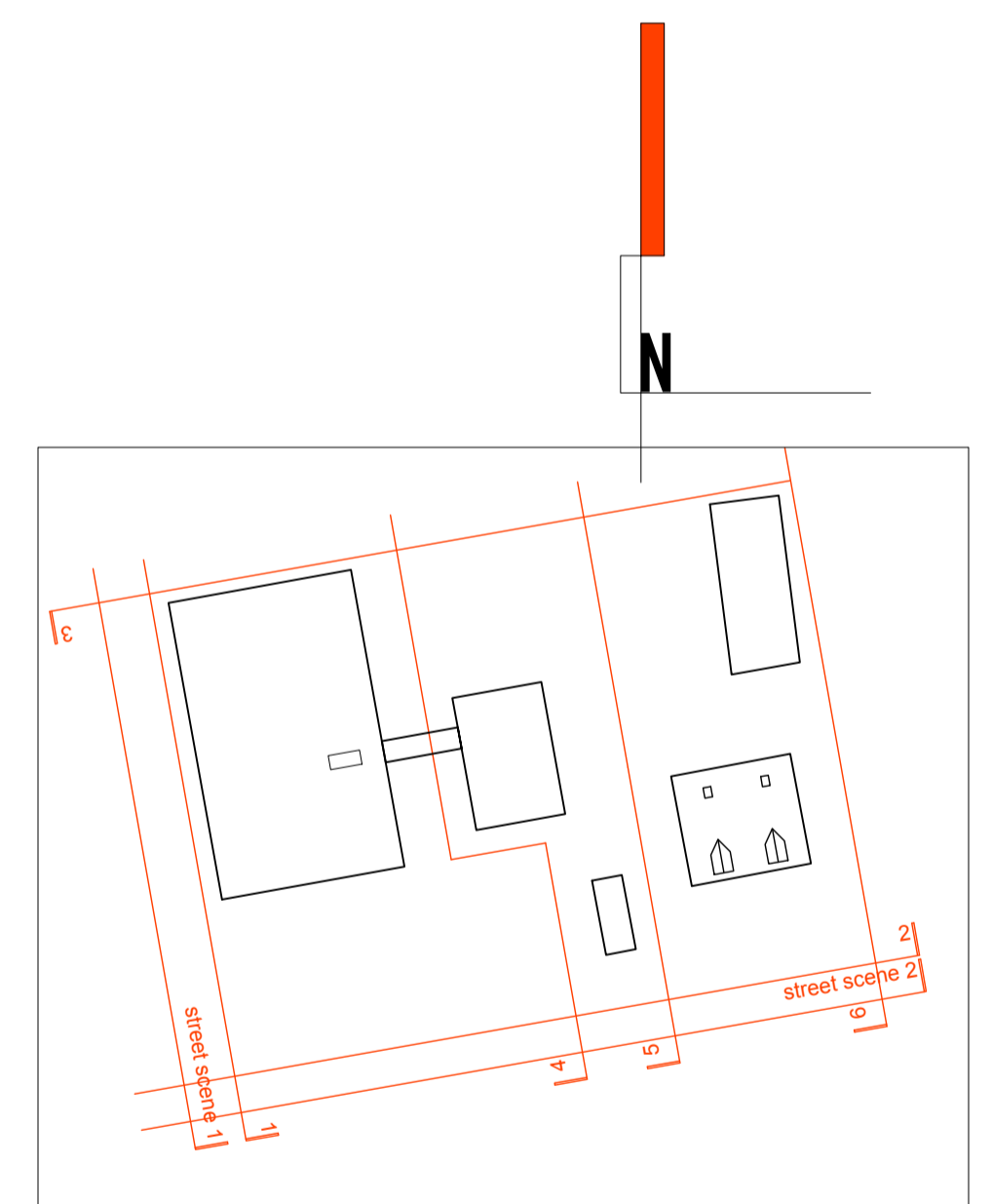

schedule		area	sqft	floor	type
no.	accom	m ²			
1	1b 2p	50.78	546.6	GF	apt
2	1b 2p	50.78	546.6	GF	apt
3	1b 2p	50.78	546.6	GF	apt
4	1b 2p	50.78	546.6	GF	apt
5	1b 2p	50.78	546.6	GF	apt
6	2b 3p	62.18	669.3	GF	apt
7	3b 6p	93.00	1001.1	3 fl	semi
8	3b 6p	93.00	1001.1	3 fl	semi
9	1b 2p	44.00	473.6	GF	coach hse
10	2b 4p	80.65	868.1	FF	apt
11	2b 4p	80.65	868.1	FF	apt
12	1b 2p	53.18	572.4	FF	apt
13	1b 2p	53.18	572.4	FF	apt
14	2b 3p	62.18	669.3	FF	apt
15	2b 4p	80.65	868.1	SF	apt
16	2b 4p	80.65	868.1	SF	apt
17	2b 3p	62.18	669.3	SF	apt
total		1099.40	11833.9		

Nett			
GF	360.08	3875.9	
FF	329.84	3550.4	
SF	223.48	2405.5	
semis	186.00	2002.1	
Total	1099.40	11833.9	

GIA			
ground	360.09	3876.0	
first	362.52	3902.2	
second	258.75	2785.2	
semi hse	186	2002.1	
coach hse	44.00	473.6	
Total	1211.36	13039.1	



elevations and street scenes positions - nts

Revision	Date	By	No
redesign of proposals to suit planning comments rear apartment single storey	10.02.20 07.10.19	nh	B A

Nick Hutchings Architect Ltd

Connolly Land & Developments Ltd.

The Viceroy
Hucknall Road
Nottingham. NG5 1FS

proposed second floor plan
352 P 30 B

scale - 1:100
DRAWN : NH

date - Sept 19

A1

second floor plan - 1:100

