

ALL FIGURED DIMENSIONS TO BE CHECKED ON SITE PRIOR TO CONSTRUCTION  
IF IN DOUBT CONSULT DESIGNWORKS

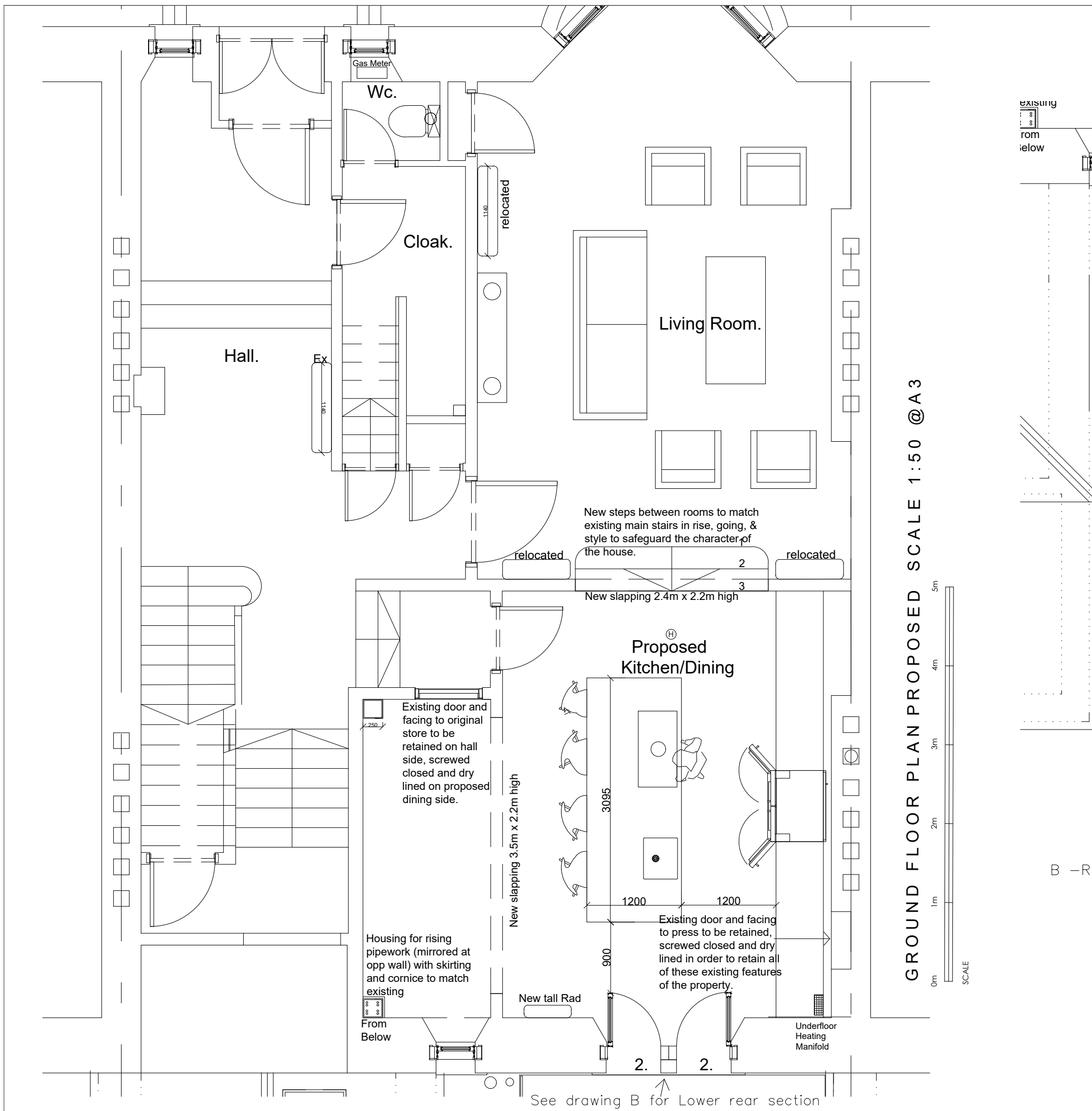

GROUND FLOOR PLAN PROPOSED SCALE 1:50 @A3

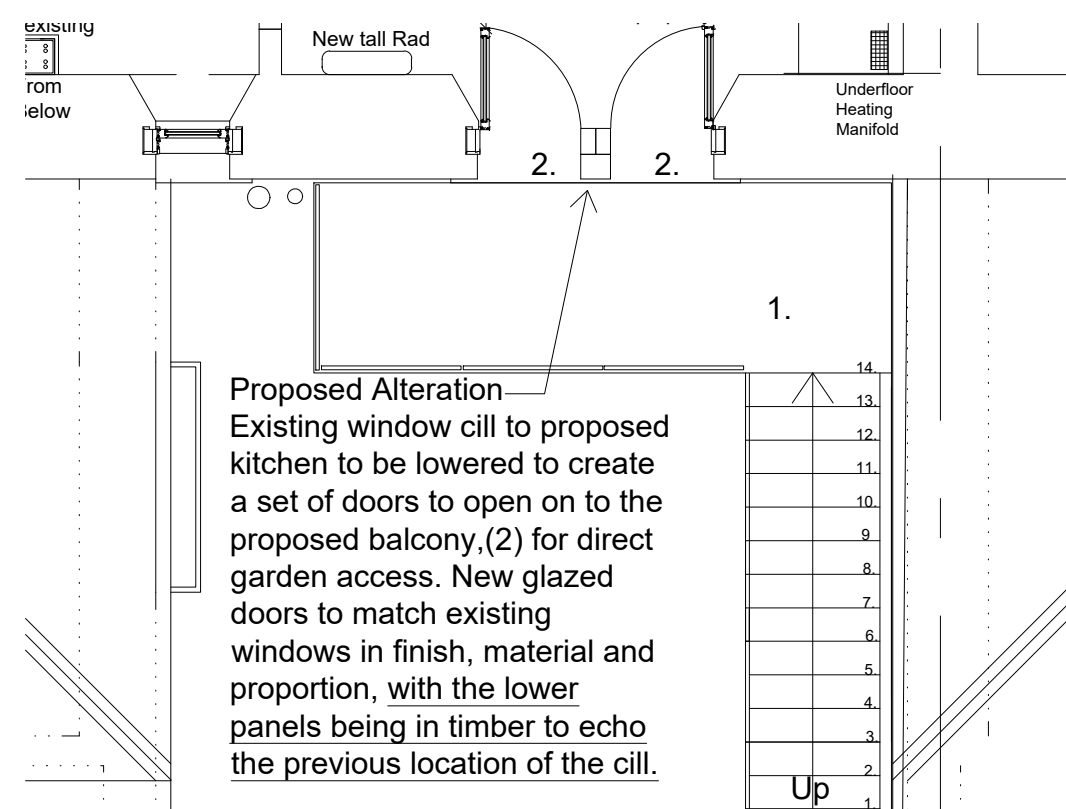

**Proposed Alteration**  
Existing window cill to proposed kitchen to be lowered to create a set of doors to open on to the proposed balcony, (2) for direct garden access. New glazed doors to match existing windows in finish, material and proportion, with the lower panels being in timber to echo the previous location of the cill.

Existing sandstone mullion to be retained and extended with matching stone.

Proposed steel and frameless glass balustraded balcony with steps (1) to directly access the garden level. Balcony and steps finished with non-slip, non-combustible fire rated external decking system.

Steel frame supporting balcony and steps to be polyester powder coated in black to match all exterior rainwater goods and window frames.

See DW20/51/014 for additional details.

B -Rear Exterior balcony and Steps 1:50

Proposed Ground Floor 1:50

project 17 Kingsborough Gardens, Glasgow G12 9NH		drawn by VG	
scale 1:50 at A3	<b>DESIGNWORKS</b> INTERIOR DESIGNERS & ARCHITECTS 38 GIBSON STREET GLASGOW G12 8NX TEL 0141-339-9520 FAX 0141-337-2127 E-mail info@designworks-scotland.co.uk		drawing no. DW20/51/011
date 02/09/20			client Ms L Thomson, Mr I Taylor

See drawing B for Lower rear section