



**UK
Planning
Maps**

6 BUSH TREES WHICH WILL BE
REMOVED ARE WITHIN
THE PROPOSAL AREA



BUSH TREE MAP ✓

35 St. Helens Crescent, Llanellen, Abergavenny, NP7 9HN

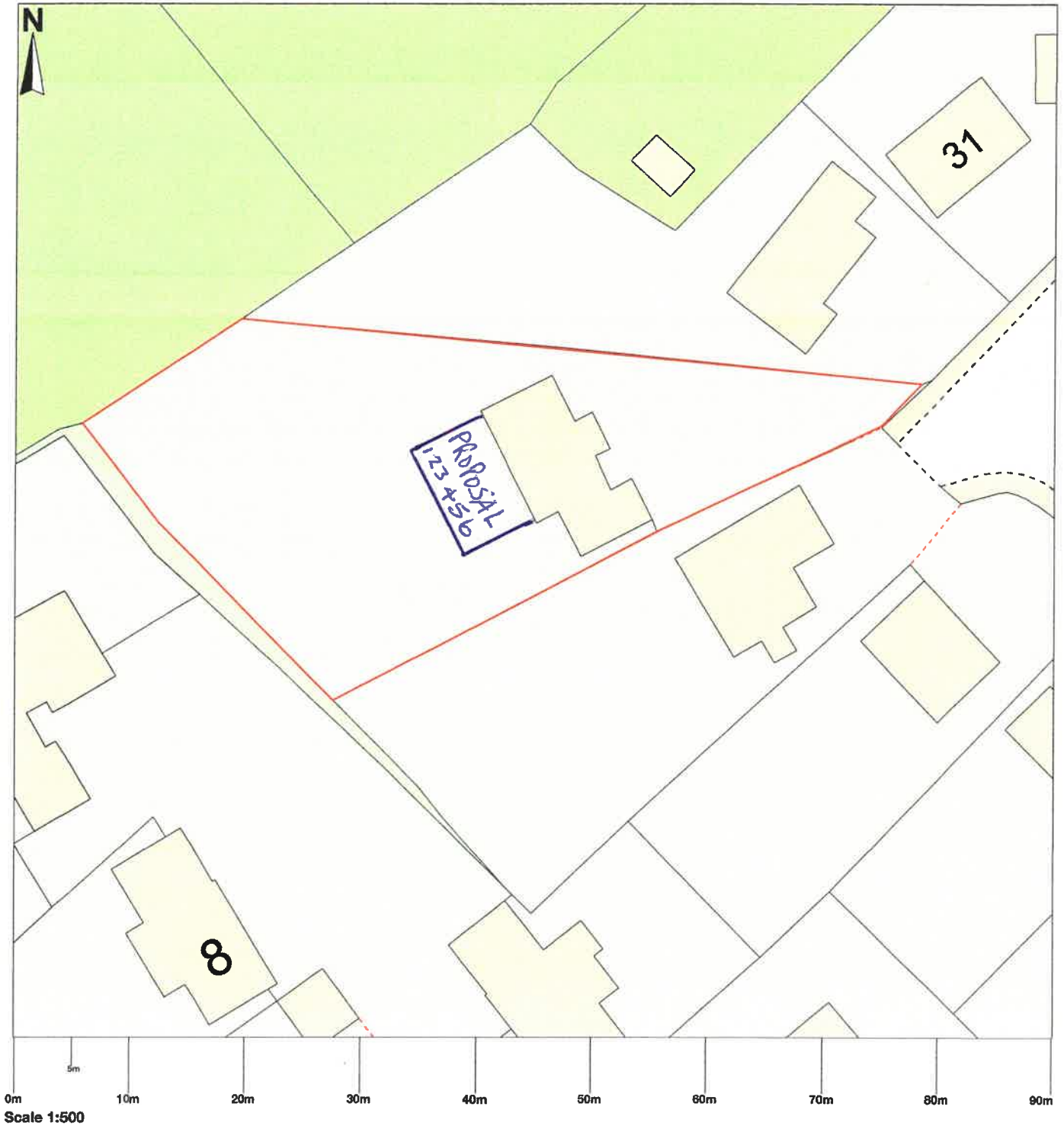

Map area bounded by: 329998,210897 330088,210987. Produced on 19 July 2021 from the OS National Geographic Database. Reproduction in whole or part is prohibited without the prior permission of Ordnance Survey. © Crown copyright 2021. Supplied by UKPlanningMaps.com a licensed OS partner (100054135). Unique plan reference: b90cuk/663366/898830