

SECTION THROUGH FRONT WALL
1:5

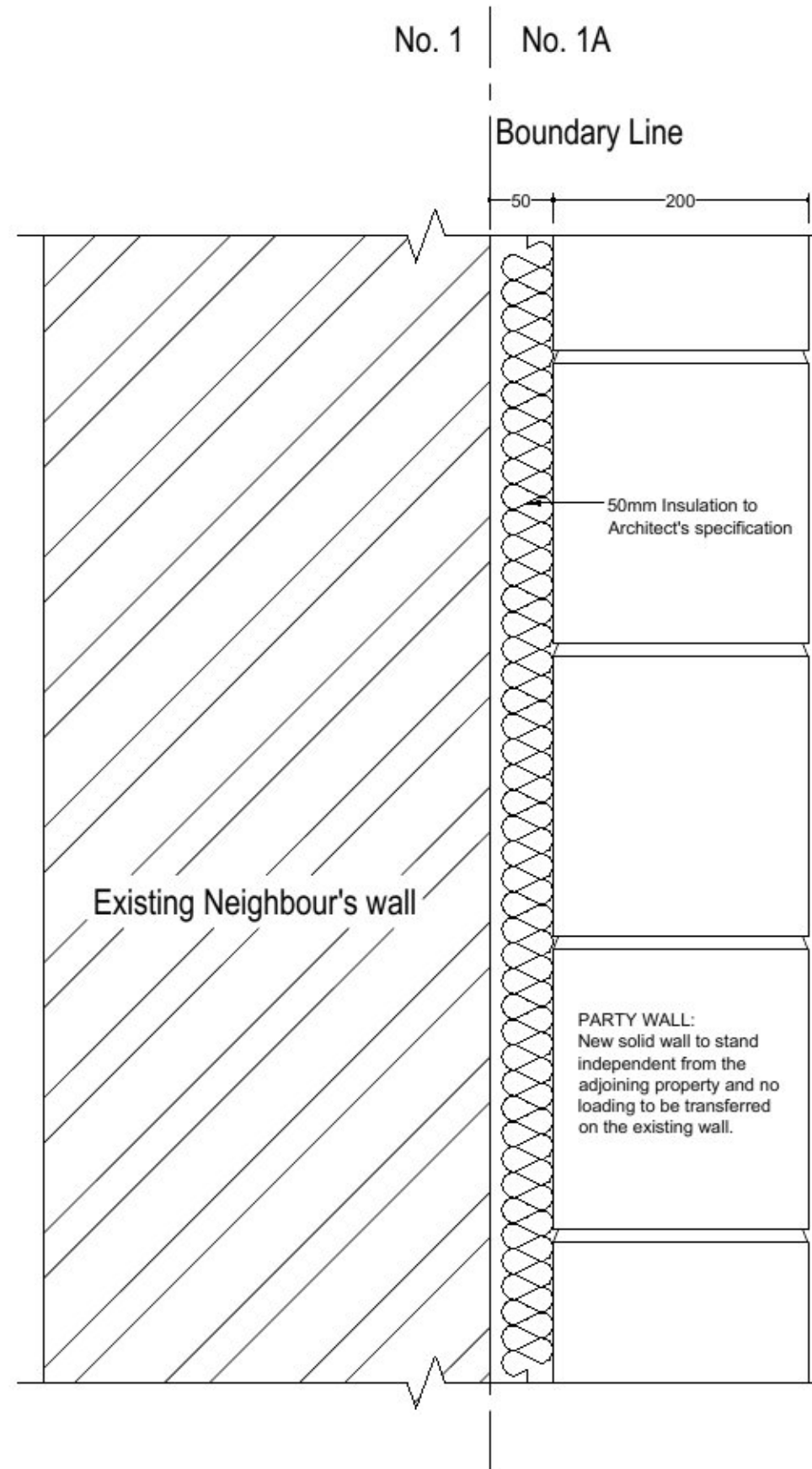

SECTION THROUGH PARTY WALL
1:5

GENERAL NOTES

1. This drawing is to be read in conjunction with all relevant Architects, Engineers and Specialists drawings, together with all relevant documents.
2. DO NOT SCALE. Work to figured dimensions only. All dimensions, setting out and levels are to be verified on site with the Architect prior to the commencement of any site works.
3. All dimensions are to be verified on site prior to the commencement of any site works. Any variations are to be recorded and reported to the Engineer so that adjustments may be made to the structural scheme if necessary.
4. The Contractor shall be responsible for and must take all necessary precautions to ensure the stability of the existing structure and earthworks on adjoining sites during the course of the contract.
5. Materials and construction are to be in accordance with the relevant British Standards and Codes of Practice.
6. All steelwork to be Grade 43 in Accordance with B.S. 4360 for quality and workmanship to the approval of the Engineer. The steelwork contractor is to be responsible for providing site dimensions to enable fabrication. Details to be drawn for the engineers approval.
7. Steelwork is to be shot-blasted and primed with **ZINCPHOSPHATE PRIMER - 75 MICRONS** minimum.

THIS DRAWING IS THE PROPERTY OF THE ALPHA DESIGN PARTNERS AND IS NOT TO BE REPRODUCED, DISCLOSED, OR COPIED WITHOUT WRITTEN PERMISSION

No work appertaining to the plans should be carried out until the plans and calculations have been examined by the local authority, and formal written approval obtained. Any works carried out before such approval is obtained, is done solely at contractors or owners risk.

ALPHA DESIGN PARTNERS LTD
Consulting Engineers
36 Chadway, Dagenham, Essex,
RM8 1UH.

PROJECT	1A ORWELL ROAD, CO12 3LD.	
DRAWING	PROPOSED SECTION DETAILS (Structural)	
CLIENT		
DATE	22/11/2021	SCALE 1:5
DRG NO.	AR/1DR/03	

