

0m 10m 20m 30m 40m
Scale 1:500

Ingleton Wood LLP shall have no liability to the Employer arising out of any unauthorized modification or amendment to, or any transmission, copy or use of the material, or any proprietary work contained therein, by the Employer, Other Project Team Member, or any other third party. All dimensions are to be checked and verified on-site by the Main Contractor prior to commencement; any discrepancies are to be reported to the Contract Administrator.
This drawing is to be read in conjunction with all other relevant drawings and specifications.
Do Not Scale © Ingleton Wood LLP

Key

- Dashed line denotes contractors compound - form solid hording using Heras 151 steadfast system.
- 1** Proposed location of Sports Hall - Existing Groundsman shed and container to be demolished and disposed of from site. Extents of site for Sport's hall to be cleared, with all soft and hardstandings grubbed up and removed from site to facilitate proposed works.
- 2** Existing 90x55m Rugby Pitch with 5m run off to be retained for duration of works.
- 3** Existing playing field used for site compound to be reinstated upon completion of the works.
- 4** Proposed new Groundsmans hut and external PE storage - These works are to be completed as an initial phase to ensure the existing equipments can be relocated prior to demolition of these facilities.

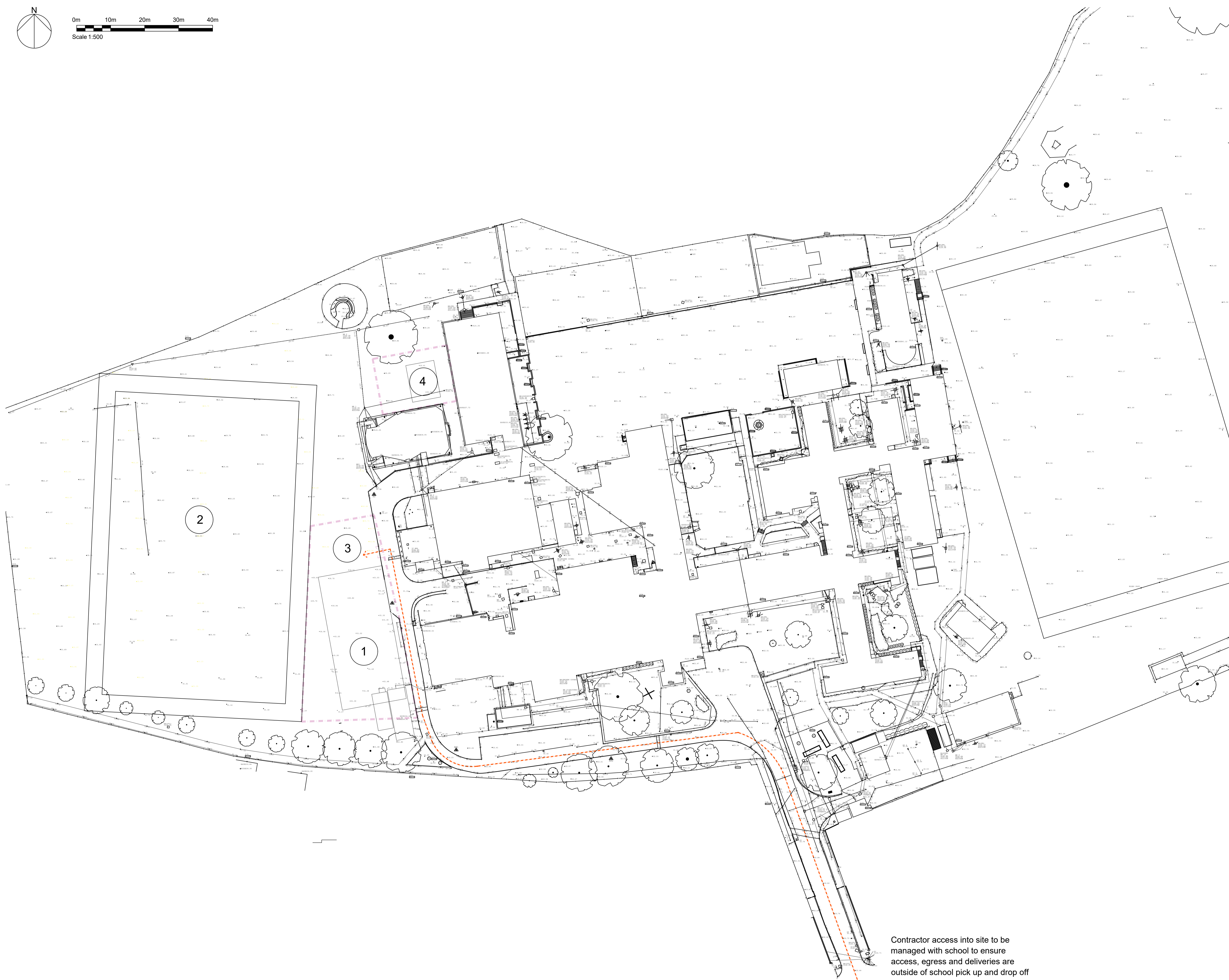

Contractor access into site to be managed with school to ensure access, egress and deliveries are outside of school pick up and drop off

P01	00/00/00	XX	XX
Rev	Description	Date	CHK
Project No:	Scale @ A1:	Drawn By:	
501752	As Indicated	MC	

Ingleton Wood Property and Construction Consultants
 Working office: Colchester
 T: 01206 224270
 www.ingletonwood.co.uk

Vision, form and function
 Project:
 Chislehurst and Sidcup Grammar School
 DA15 9AG

Client:
 Chislehurst and Sidcup Grammar School

Title:
 Existing Demolished Block Plan

Drawing Number:	CHSGSH-IWD-XX-XX-DR-A-2401		
Status:	Purpose of Issue:	Revision:	
S2	Information	P01	