

0m 10m 20m 30m 40m  
Scale 1:500

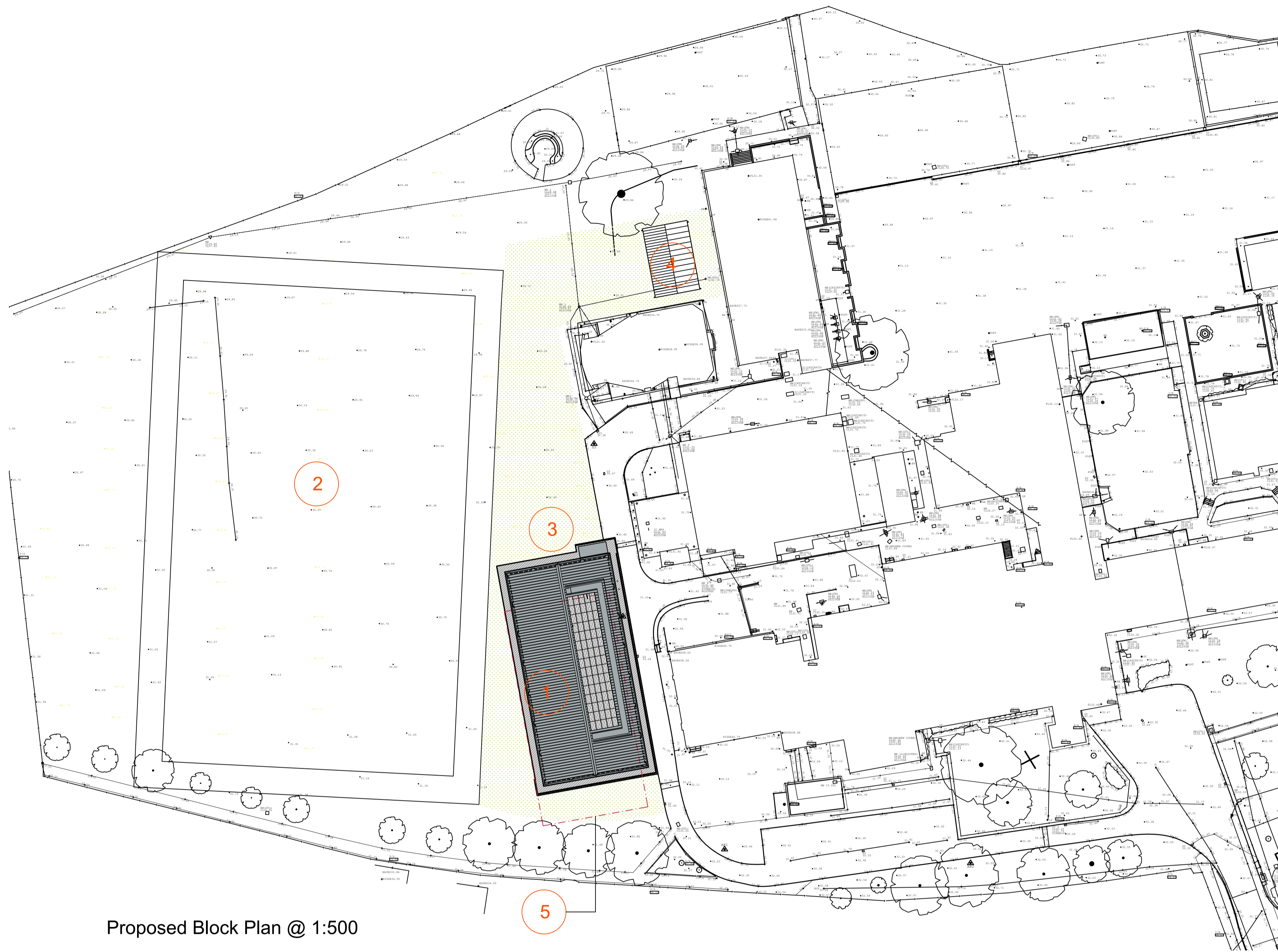

Proposed Block Plan @ 1:500

Key

- 1 Proposed Sports Hall with associated access path around the building for maintenance and to link with existing site access.
- 2 Existing 90x55m Rugby Pitch with 5m run off to be retained for duration of works.
- 3 Existing playing field used for site compound to be reinstated upon completion of the works.
- 4 Proposed new Groundsmans hut and external PE storage -
- 5 Previous Planning Application building location

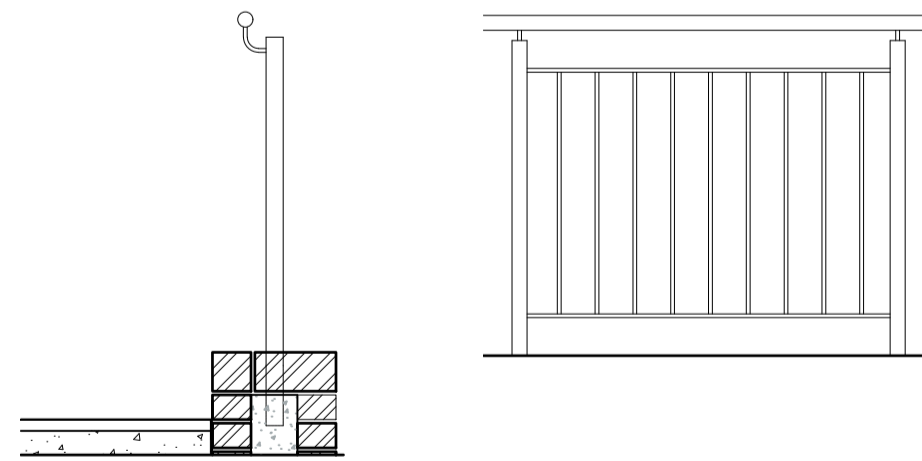

Typical elevation of Infill between handrail supports  
Spacing of balustrade to be less than 100mm

General Notes  
Relating to Handrail and Balustrade to top of retaining wall

--- Denotes extents of balustrade to top of retaining wall

40mm Ø handrail as specified. Fitted in complete compliance with the manufacturers instructions.  
Tube sections to be polyester coated. Top of handrails to be set at 900mm above top of wall.

Path and retaining wall to perimeter of new sports hall to be built as structural and civil engineers details. Handrail system fixed to mass fill as Structural Engineers details.

Insert expansion joints at abutment path and adjacent walls consisting of 10 x 125mm bitumen impregnated fibreboard recessed with a 20mm polysulphide mastic bead to seal, finished level with ramp surface.

Brickwork to sides of to be of 102mm stretcher bond brickwork as specified built off proposed foundations Structural Engineers details.

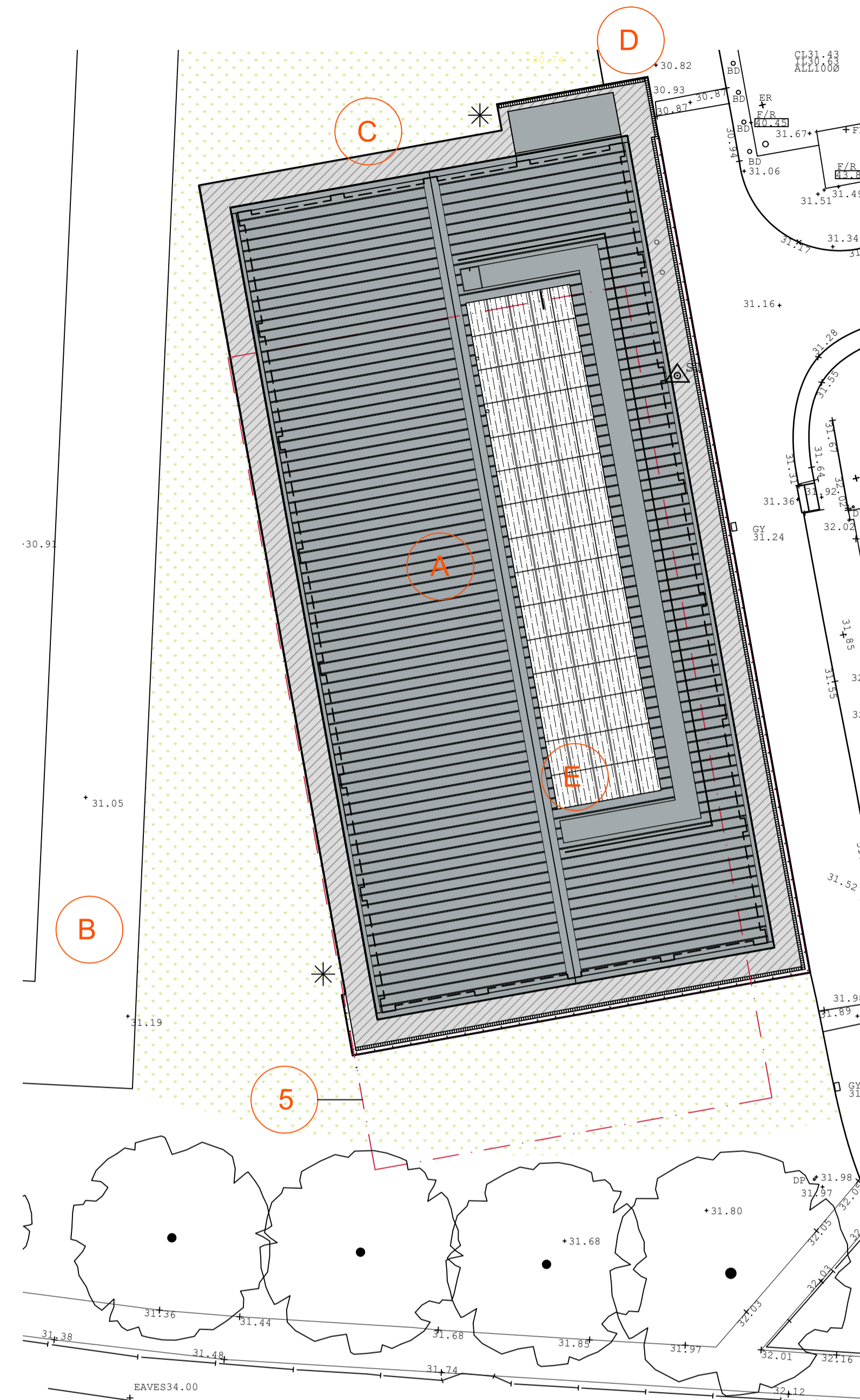

Proposed Block Plan @ 1:200

Key

- A Proposes Sports Hall with associated access path around the building for maintenance and to link with existing site access.
- \* Doors opening on to pedestrian areas to have Broxap BX14/DB door barriers finished between 900-1100mm in height from finished external level.
- B Existing 90x55m Rugby Pitch with 5m run off to be retained for duration of works.
- C Existing playing field used for site compound to be reinstated upon completion of the works.
- D Proposed road kerbing and retaining wall as structural engineers details. 2 no. Broxap Heavy duty Economy bollards BX14 6501 to be placed as shown, root dixed, 140mm Dia. slope top with Class 2 white reflective band finished in anthracite Grey RAL 7016.
- E Proposed PV Panels to roof with access from first floor plant room via hatch and mansafe fall arrest system.

Ingleton Wood LLP shall have no liability to the Employer arising out of any unauthorized modification or amendment to, or any transmission, copy or use of the material, or any proprietary work contained therein, by the Employer, Other Project Team Member, or any other third party. All dimensions are to be checked and verified on-site by the Main Contractor prior to commencement, any discrepancies are to be reported to the Contract Administrator.  
This drawing is to be read in conjunction with all other relevant drawings and specifications.  
Do Not Scale Ingleton Wood LLP

P01	First Issue	NOV 20	AW	AM
Rev	Description	Date	Cnk	Apr
Project No:	Scale @ A1:	As Indicated	Drawn By:	MC
501752				



Vision, form and function  
Project:  
Chislehurst and Sidcup Grammar School  
Sidcup  
DA15 9AG

Client:  
Chislehurst and Sidcup Grammar School

Title:  
Proposed Block Plan

Drawing Number:	CHSGSH-IWD-XX-XX-DR-A-2402
Status:	Purpose of Issue:
D2	Tender
Revision:	P01