

Address	The Old Vicarage, Vicarage Lane, Barrow Gurney, BS48 3RT
Proposal	Application for Listed Building Consent for installation of 10 roof mounted solar panels on the detached outbuilding
Title	Eastern elevation (existing)
Drawing Number	D7
Scale	1:100
Date	2 December 2021

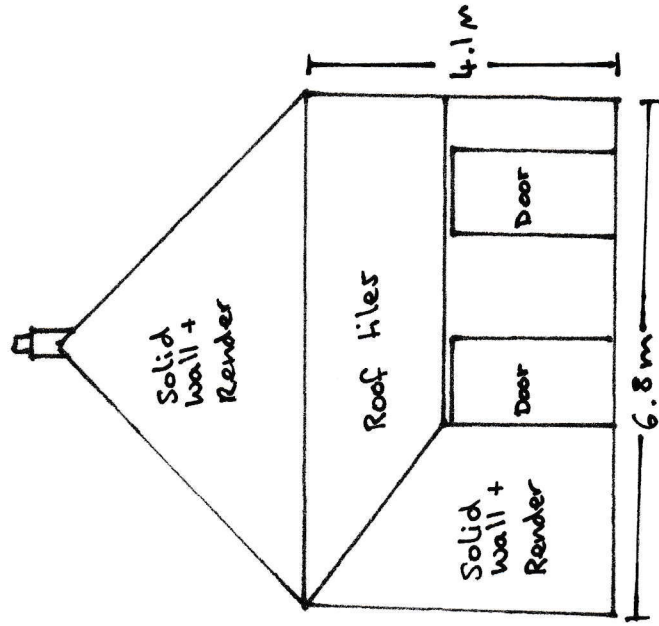

0 1 2  
metres

Address	The Old Vicarage, Vicarage Lane, Barrow Gurney, BS48 3RT
Proposal	Application for Listed Building Consent for installation of 10 roof mounted solar panels on the detached outbuilding
Title	Eastern elevation (proposed)
Drawing Number	D8
Scale	1:100
Date	2 December 2021

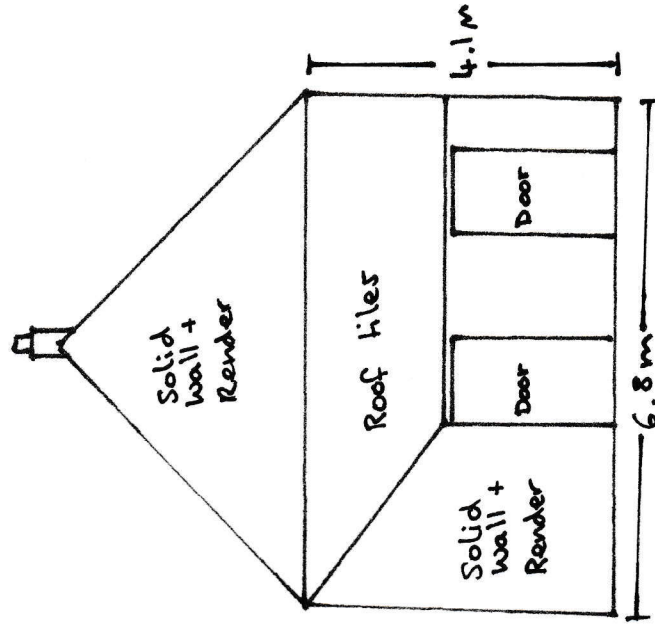

0 1 2  
metres