

This Plan includes the following Licensed Data: OS MasterMap Black and White PDF Location Plan by the Ordnance Survey National Geographic Database and incorporating surveyed revision available at the date of production. Reproduction in whole or in part is prohibited without the prior permission of Ordnance Survey. The representation of a road, track or path is no evidence of a right of way. The representation of features, as lines is no evidence of a property boundary. © Crown copyright and database rights, 2021. Ordnance Survey 0100031673

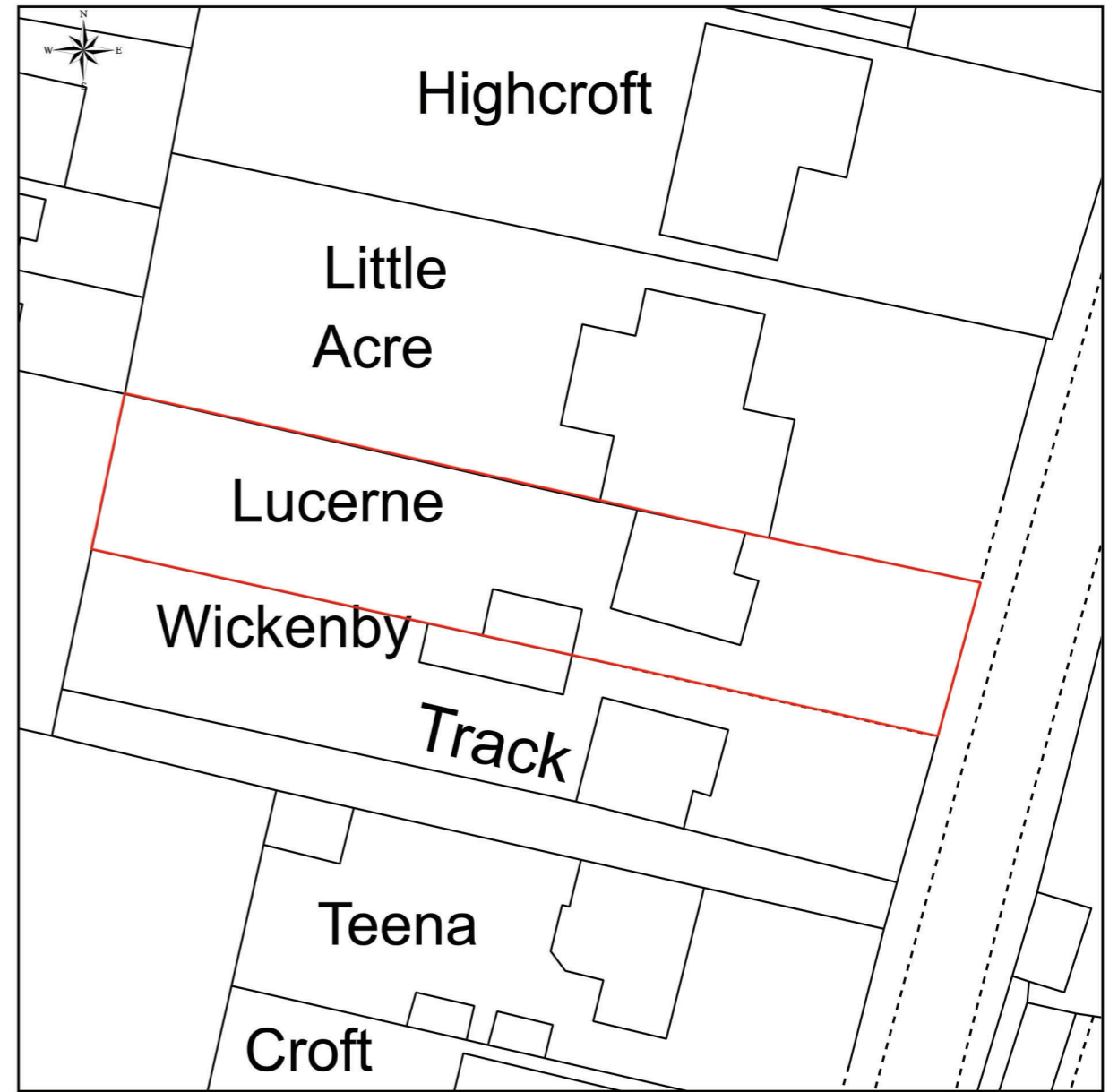

Scale: 1:1250, paper size: A4



This Plan includes the following Licensed Data: OS MasterMap, Black and White Site Plan/Block Plan by the Ordnance Survey National Geographic Database and incorporating surveyed revision available at the date of production. Reproduction in whole or in part is prohibited without the prior permission of Ordnance Survey. The representation of a road, track or path is no evidence of a right of way. The representation of features, as lines is no evidence of a property boundary. © Crown copyright and database rights, 2021. Ordnance Survey 0100031673



Scale: 1:500, paper size: A4

Design Drawings

Description of Works:

Loft Conversion with rear dormer

Client:

Bissett

Site Address:

Lucerne
Croft Road
Thurlaston
LE9 7TB

Planning Permission:

Not Approved

Drawing Number:

D301- 04/11/2021

Drawing Revision:

04/11/2021 - A

Materiality:

All materials to be as close as possible to existing.

Building Control:

Not Approved

DRAWING NOTES

This Project involves developing a Loft conversion with new rear dormer to create a master bedroom.

All new materials are to be as close to the existing as possible. This includes the brickwork, roof tiles and uPVC windows and doors.

LEGAL NOTICE

Copyright remains the property of The Practical Planning Company Ltd – no copies of these plans to be made without approval. Drawings must not be used for quotations until the relevant approvals have been granted and checked on site by client and principal contractor. Any discrepancies in sizes or relevant details which may affect quotations and/or building costs and procedures must be reported to The Practical Planning Company Ltd and the drawings must be amended prior to any commencement of said quotations and building works. Starting work before approval of plans by building control is at the customer's own risk. It is the responsibility of the contractor/builder to check all sizes on site prior to and during the build.

It is the responsibility of the client and principal contractor/builder to conform to both building regulations and Construction (Design & Management) Regulations (CDM 2015). If existing trees are to be retained, they should be subject to a full arboricultural survey/inspection for safety. All trees are to be planted a minimum of five metres from buildings and three metres from drainage and services. A suitable method of foundation is to be provided to accommodate the proposed tree planting.

Any alterations to these drawings should be checked for compliance with planning and building control. It is the responsibility of the client to check that these plans do not contravene, affect covenants or encroach boundaries, that they are in line with matters relating to land title, and that issues relating to The Party Wall etc Act 1996 are implemented at the relevant stages.

Main Project Contact:
Benjamin Heginbotham

Email:
hello@practicalplanningco.co.uk

Phone:
07743 686654

