

PROPOSED BACK ELEVATION in application 21/03575/HOUSE

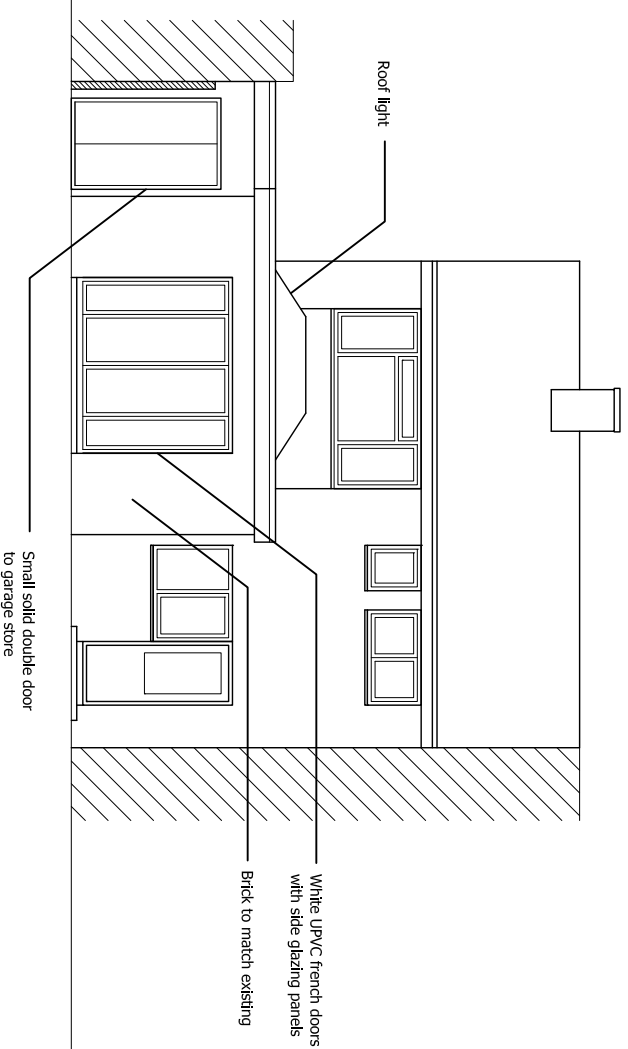

PROPOSED AMENDED BACK ELEVATION



ACUTE ARCHITECTS
AND ENGINEERING
www.acutearchitects.co.uk

client
KAY MORRIS

job No.
A211

project
30 PHILIP AVENUE
SWANLEY
BR8 8HQ

drawing title
Proposed Rear Elevations

Revision

Proposed Rear Elevations
Amendment

scale
1:100 @ A3

dwg No.
A211-600

date
Dec 2021

Please note:
Drawings can be scaled for planning purposes only. All dimensions to be checked on site.
Drainage and services are to be checked and located prior to commencement of work.

All work to be carried out in accordance with the building Regs. 2000 or any subsequent amendments and to the satisfaction of the local building control inspector.

Proprietary components must be installed in strict accordance with the manufacturers instructions and details. Contractors are responsible for verifying component suitability for intended purpose.

Proposals are subject to structural engineers designs and approval.

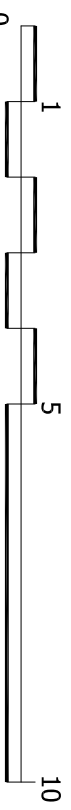

Scale 1:100