

SECTION AA'

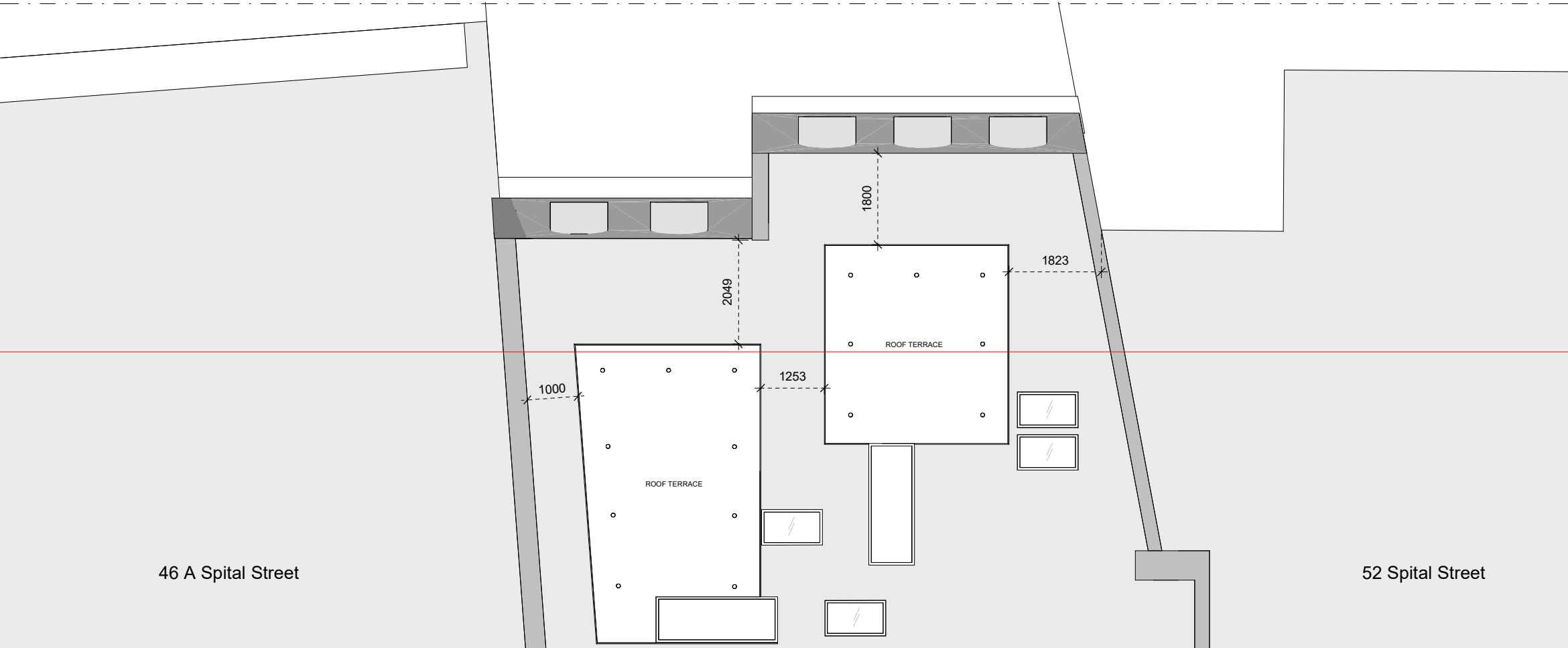

SECTION AA'

P140 Cross section with context

1:25 @ A1, 1:50 @ A3



NOTE:
 Architectural Information - the level of detail shown on the drawings is relative to the submission of a PLANNING APPLICATION.
 The drawings should therefore not be used for any other purpose without both the prior agreement of the architect, and subsequent checking / development by others.
 Dimensions and setting out - should be checked on site; see above.
 Structure & Construction - these drawings, unless expressly noted otherwise, have not been fully coordinated with a Structural Engineer's input and show indicative construction build-up only.
 Building Control - the client / the contractor will liaise directly with Local Authority to ensure the project is completed in accordance with the Building Regulations.
 Planning - the client/ the contractor will ensure that the project is completed in accordance with the approved Planning drawings and take responsibility for the discharge of any planning conditions.
 Party Walls & Rights to Light - the client/ the contractor will ensure that any notices and consents required are obtained before work commences.
 Freeholder / Leaseholder / Restricted covenants / Easement approvals - the client will ensure that any notices and consents required are obtained before work commences.
 Archaeological & Ecological - the client/ the contractor will ensure that any notices and consents required are obtained before work commences.

NOTE:
 Glazing Allowances will need to be negotiated with Building Control as per Approved Document L1B Conservation of Fuel and Power.

Areas provided on drawings are rounded to the nearest whole unit. Measurements are based upon received survey information and as such a reasonable allowance should be made for discrepancies or deviations that may occur during construction.

Revisions		
No.	Description	Date
1	Revision for Planning	08/11/21

PROPOSED

Note: Do not scale from this drawing. All dimensions to be checked on site by the contractor and to be his responsibility.

Arcvelop Ltd.
 1 Pembroke Villas
 Notting Hill
 London
 W2 4EA

T 0207 050 0703
 E info@arcvelop.com

Project Name: 50 Spital Street
 Project Number: 10015

Drawing Name
 Cross section with context
Drawing No
 P140
Revision
 1
Scale
 1:25 @ A1, 1:50 @ A3