

This copy is a reproduction of the original drawing made by the authority of East Lindsey District Council pursuant to section 47 of the Copyright, Design and Patents Act 1988. Unless the Act provides a relief or exception to copyright, the copy must be treated as if it were the original drawing without the prior permission of the copyright owner.

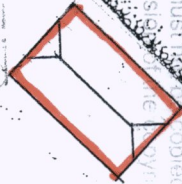

AGARTH HOUSE



OUTBUILDING APPROVED
29.07.21 REF: 11
N/05/01205/21

EXISTING FENCE & GATE RELOCATED

EXISTING JACUZZI RELOCATED

LEGBOURNE ROAD

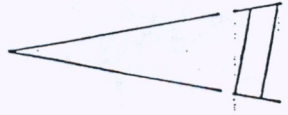

©

JOB TITLE
NEW GARAGE & STORE

AGARTH HOUSE
LEGBOURNE ROAD
LOUTH

CLIENT
R. NOBLE ESQ

TITLE
BLOCK PLAN AS
PROPOSED

SCALE
1:500

DATE
NOVEMBER 2021

DRAWING No.
1308/03

JOHN STANTON ARCHITECT

1 WATERHEN COTTAGES
POVERTY LANE
TATHWELL
LOUTH LN11 9SY
LINCOLNSHIRE

TEL. LOUTH (01507) 605941

