

ARBORICULTURAL REPORT

- CONTENTS:**
 1. INTRODUCTION
 2. TREE SURVEY
 3. ARBORICULTURAL IMPLICATIONS & IMPACT ASSESSMENT
 4. TREE PROTECTION

1. INTRODUCTION

Background: LSDP were appointed to prepare an Arboricultural Survey & Report to satisfy Local Authority requirements in respect to the proposed scheme at 'The Bungalow', The Street, Thornham Magna. The report is based on survey information collected in July 2019, and revised in March 2020 and November 2021.

The Site: The site comprises the eastern part of the former 'Bungalow' garden curtilage and is accessed via a strip of land running along the northern edge of the curtilage, past the western part, which is subject to a planning permission for two detached dwellings. (Planning Ref: DC/20/04979). The site is bordered to the north and south by neighbouring residential curtilage and to the west by agricultural land.

2. TREE SURVEY

Generally: The trees were appraised in accordance with BS5837:2012 and original survey details of nine individual trees and two groups were recorded and rationale for categorisation is outlined below; please see schedule and drawing opposite for other survey information.
 The larger mature native trees located on the site peripheries provide screening and enclosure and contribute to local landscape character; they are recorded as 'A1' or 'B1' category (high, or moderate landscape value). The other trees are a mixture of native and exotic trees that are of either smaller stature, or otherwise have no special arboricultural, landscape, or cultural value and are recorded as 'C2' category (low landscape value).

3. ARBORICULTURAL IMPLICATIONS & IMPACT ASSESSMENT

Removal of Trees: It is proposed to remove the T9 ash, which is a 'C' category tree in poor condition.
Encroachment into Root Protection Areas (RPAs): The proposal encroaches into the RPA of T8 Ash for the purpose of driveway construction. Part of this proposed surface is approved under Application Ref:DC/20/04979; it is proposed to extend the surface using 'no dig' construction as per the detail opposite and this can be achieved with no significant adverse impact on the tree.

Proximity of Dwellings to Tree canopies: The proposed layout allows adequate space around trees, to accommodate future growth and minimise potential issues with shading / perception of hazard in relation to dwellings and amenity spaces.

4. TREE PROTECTION

Generally
 Before any machinery or materials are brought onto site and before any demolition, development or stripping of soil commences, The Root Protection Area (RPA) indicated on the drawing shall be set out and the Protective Barriers and Ground Protection installed as shown on the drawing.
 The Protective Barriers and Ground Protection shall not be removed or altered without prior recommendation by an arboriculturist and approval of the local planning authority.

- The areas protected by barriers shall be subject to the following restrictions:
 I. Existing soil levels within the protected areas shall not be altered
 II. No excavation of any kind shall take place within the protected areas.
 III. The protected areas shall not be used for storage of any kind
 IV. No vehicles or machinery shall be allowed into the areas protected by barriers
 V. Should the developer require the above restrictions to be breached for unforeseen reasons, an appropriate method of works must be agreed with the Local Authority prior to any works taking place within the protected areas.

Protective Barriers
 Protective Barriers shall be erected to prevent access into designated areas around retained trees. Once installed, all weather notices shall be attached to each barrier with words such as: "Construction Exclusion Zone - No Access". Protective Barriers shall be erected in accordance with BS5837: 2012 Fig 2.

Ground Protection
 Ground protection shall be installed where access is required through designated areas around trees.

For temporary pedestrian access, ground protection shall comprise scaffold boards laid over a 50mm minimum depth of sharp sand, over a geotextile membrane.

Where vehicular access is required within the RPA, ground protection shall take the form of a permeable surface laid on a cellular confinement system, constructed using a no-dig specification. See diagram opposite.

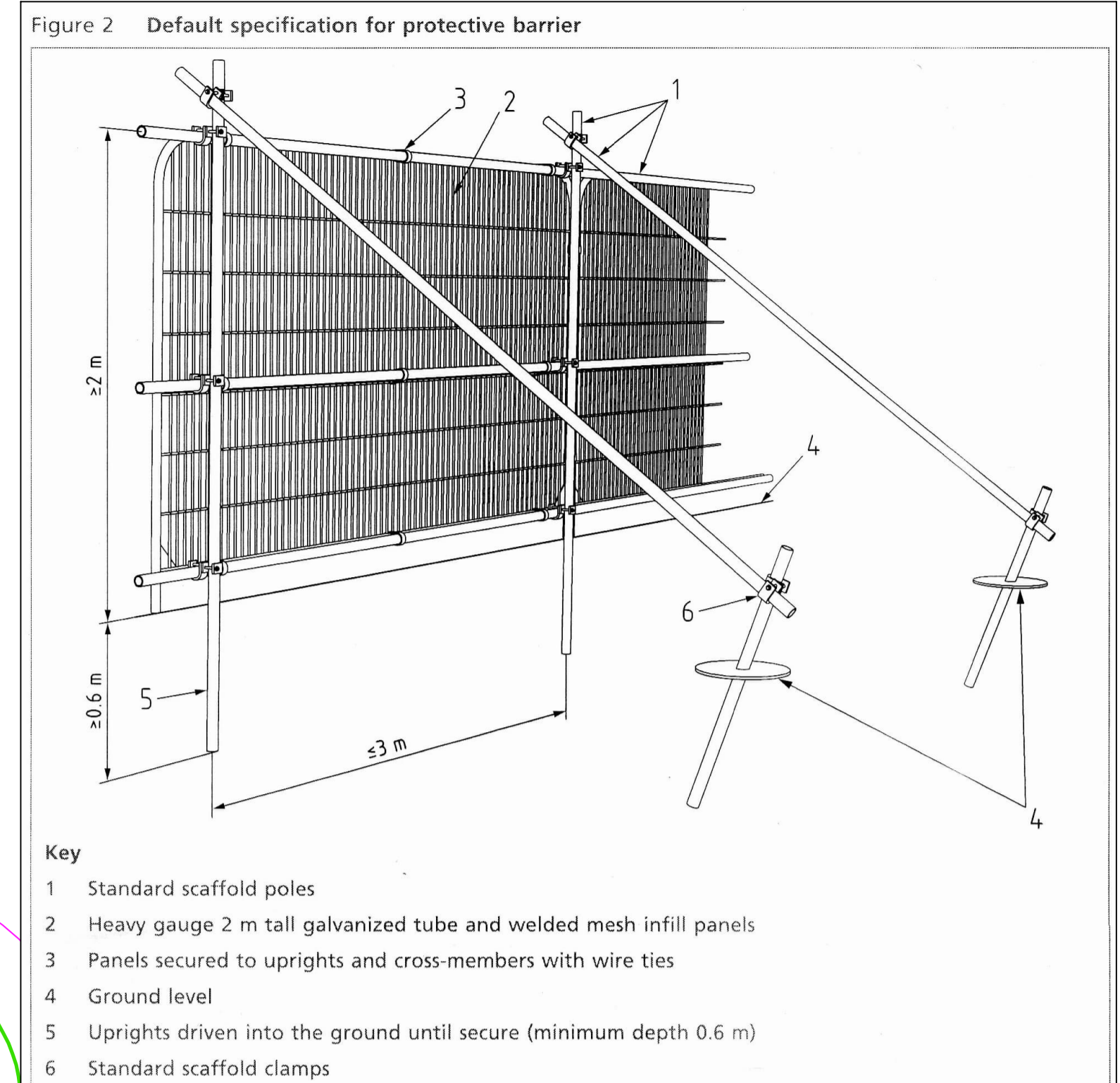
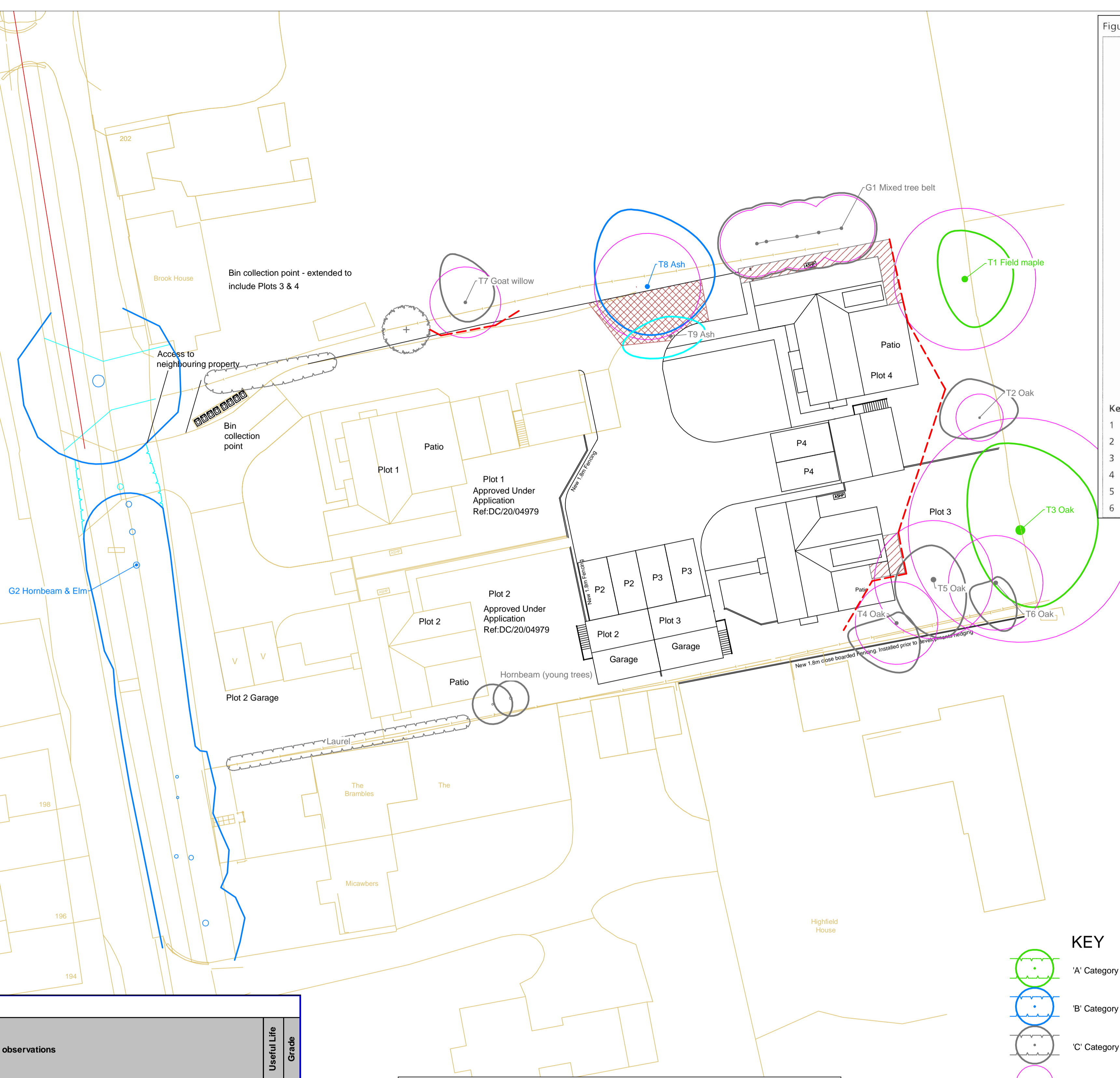

- Key**
 1 Standard scaffold poles
 2 Heavy gauge 2 m tall galvanized tube and welded mesh infill panels
 3 Panels secured to uprights and cross-members with wire ties
 4 Ground level
 5 Uprights driven into the ground until secure (minimum depth 0.6 m)
 6 Standard scaffold clamps

Ref	Species	Stem Dia (mm)	Stems	Height (m)	Can. clear (m)	Br. clear (m)	Age Class	Physiology	Structural Condition	Arboricultural Value	Landscape Value	Cultural/Conservation Value	General observations	Useful Life	Grade
T1	Field maple	600	1	15	2	N.A	M	N	F	M	M	H	Lapsed coppice located on ditch bank, eastern boundary.	40+	A3
T2	Oak	200	1	9	2	N.A	M	N	F	L	L	L	Located adjacent to eastern boundary. Ivy clad.	40+	C2
T3	Oak	950	1	17	2	6N	M	N	F	M	H	M	Located on ditch bank, eastern boundary. Ivy clad	40+	A2
T4	Oak	350	1	15	5	N.A	M	N	F	L	L	L	Located adjacent to southern boundary. Suppressed by neighbouring tree.	40+	C2
T5	Oak	500	1	15	5	N.A	M	N	F	L	L	L	Located adjacent to southern boundary	40+	C2
T6	Oak	350	1	15	5	N.A	M	N	F	L	L	L	Located adjacent to southern boundary. Suppressed by neighbouring tree.	40+	C2
T7	Goat willow	300	1	9	2	N.A	M	N	F	L	L	L	Located in neighbouring border, on bank. Ivy clad. Leaning north across ditch	20+	C2
T8	Ash	350	1	15	5	N.A	M	N	F	L	M	L	Located on edge of lawn area. Ivy clad. Buttress roots and also roots visible on ground surface.	20+	B2
T9	Ash	300	1	15	5	N.A	M	N	F	L	L	L	Located on edge of lawn area. Stem divides at 3m height into one dominant and one sub-leader.	20+	C2
G1	Mixed tree belt	250	1	10	2	N.A	M	N	F	L	L	L	Overgrown plantation of trees on edge of neighbouring site, species include ash, Norway spruce, Wellingtonia and sycamore	40+	C2
G2	Bolted hornbeam hedge	250	MS	6	2	N.A	M	N	F	L	M	M	Located adjacent to stream, site frontage. Includes occasional elm.	20+	B2

NOTES & ABBREVIATIONS:
Age Class: Y (Young) – Less than 1/3 of life completed, M (Middle Aged) 1/3 - 2/3 of life completed, M (Mature) – more than 2/3 of life completed, OM (Over Mature) - more than 2/3 of life completed and declining, V (Veteran) – Veteran trees have no precise definition but are trees considered to be of biological aesthetic or cultural value because of their age.
Physiology: N - Normal, P - Poor, D - Dying. Given relative to species, age and location.
Structural Condition: G (Good) – No, or remediable physical defects or decay, F (Fair) - Physical defects or decay present, risk of failure of stem or large limbs within twelve months considered to be low, P (Poor) - Physical defects or decay present, risk of failure of stem or large limbs within twelve months considered to be high.

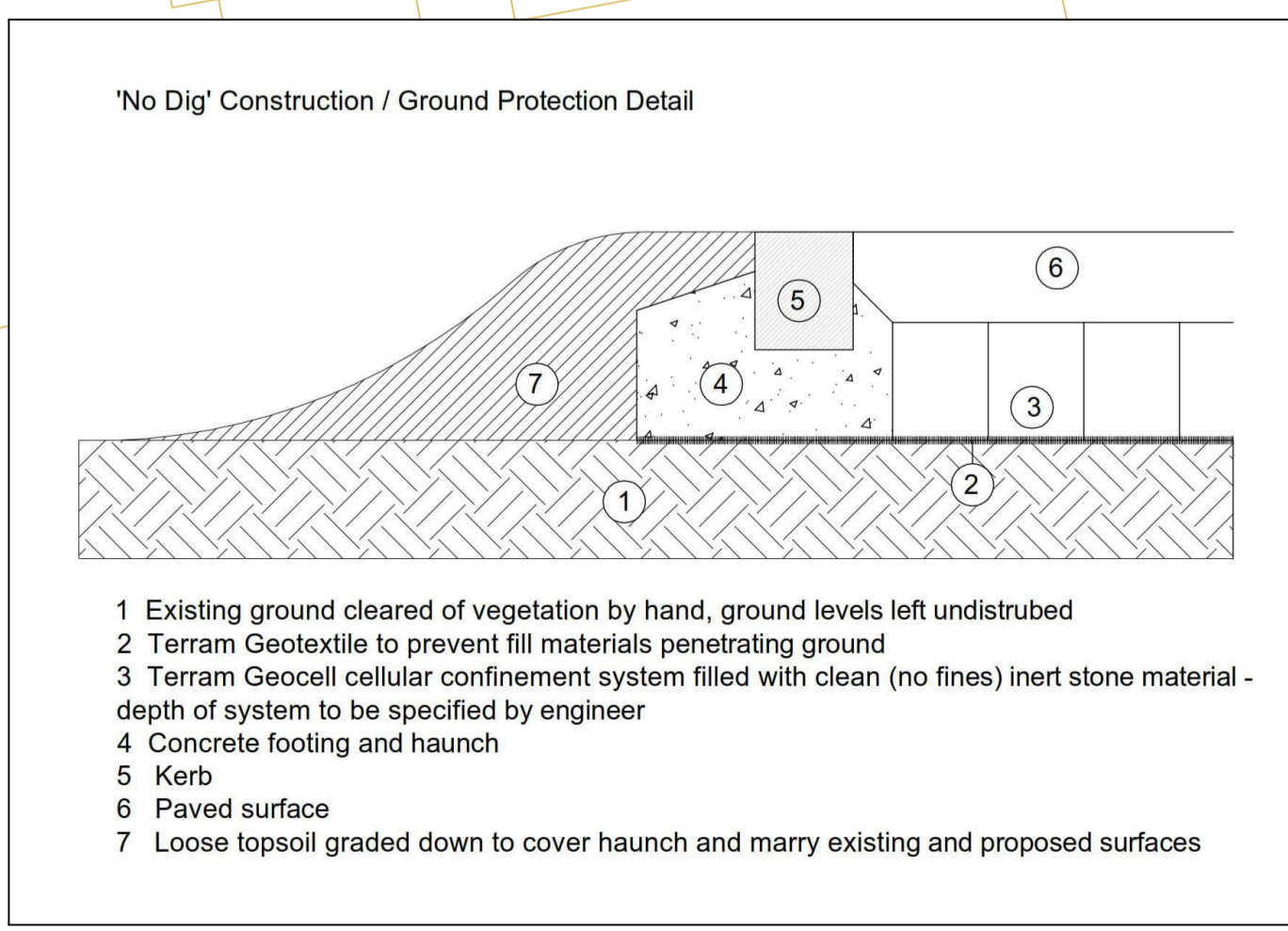

- KEY**
- 'A' Category Tree / Hedge
 - 'B' Category Tree / Hedge
 - 'C' Category Tree / Hedge
 - Root Protection Area (RPA)
 - Scrub
 - Trees / Hedges to be removed / cut back
 - Proposed hedge
 - Proposed tree
 - Tree Protection Barrier: To be weldmesh panels installed in accordance with BS 5837: 2012 Fig 2
 - Existing Permanent Ground Protection: Comprising 'Geoweb' or equivalent cellular confinement system filled with inert stone and laid as 'no dig' surface, retained thereafter, as base to proposed paving. See arboricultural report.
 - Proposed Permanent Ground Protection; to specification above
 - Temporary Ground Protection Comprising scaffold boards laid over a 50mm minimum depth of sharp sand, over a geotextile membrane. See arboricultural report

The original of this drawing was produced in colour - a monochrome copy should not be relied upon.

Revisions :

Land & Sculpture Design Partnership
 LANDSCAPE ARCHITECTURE · SCULPTURE · ARBORICULTURE

SITE : The Bungalow, Thornham Magna
 DRG : Tree Survey, AIA & Protection Plan
 DRN BY : GH
 SCALE : 1:250 @ A1
 DATE : November 2021
 No : LSDP 1769-01

OCTAGON HOUSE · THE WATER RUN · HITCHAM · IPSWICH · IP7 7LN
 T : 01449 740272 · E : LSDP@btinternet.com