

Take down existing 'nib' wall (Covered under Certificate of Lawful Development Application)

Take out existing raised floor, shower tray, heads, valves etc. (Covered under Certificate of Lawful Development Application)

Existing door be taken off, frame made good and door re-hung, utilising existing ironmongery (Covered under Certificate of Lawful Development Application)

Remove existing sink, mirror and splashback and cart off site (Covered under Certificate of Lawful Development Application)

Total 3no. new shower enclosures, trays, shower head, mixer valve etc.

New cubicle system installed

Remove existing radiator, package, label and store safely on castle grounds. New Rad to replace existing - location tbc (Covered under Listed Building Application)

Dado to be removed and line existing walls with new Hygenic Wall panels. (Covered under Certificate of Lawful Development Application)

New wash hand basin to be installed. Pipework connection TBC.

Replace existing toilet with new (Covered under Certificate of Lawful Development Application)

Replace existing cubicle system with new (Covered under Certificate of Lawful Development Application)

New vinyl flooring to replace existing. New timber skirting boards to be fitted to match existing. (Covered under Certificate of Lawful Development Application)

PROPOSED BATHROOM ALTERATIONS  
BATHROOM NUMBER : F14 (FIRST FLOOR, WEST WING)

SCALE 1 : 20

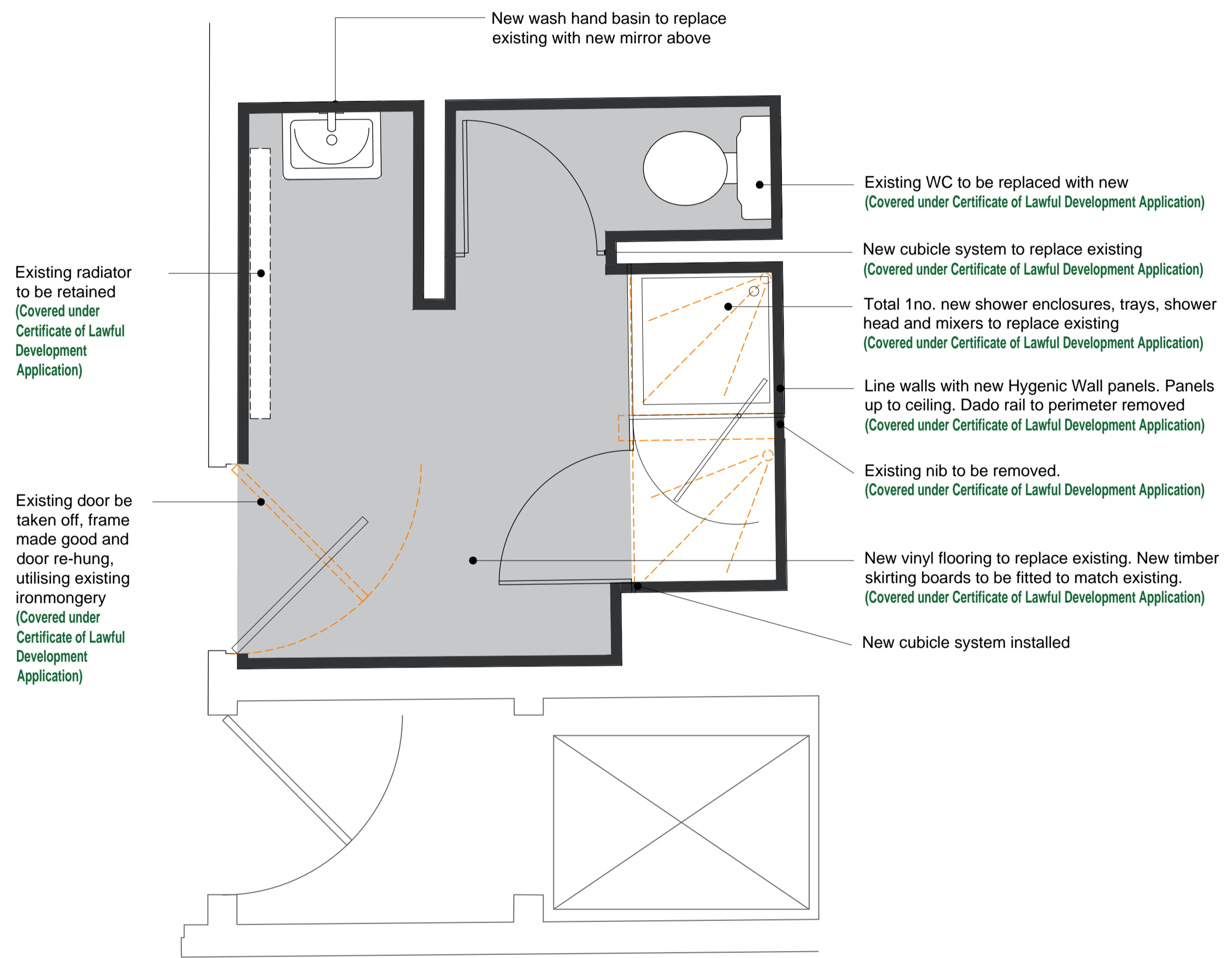

Existing radiator to be retained (Covered under Certificate of Lawful Development Application)

Existing door be taken off, frame made good and door re-hung, utilising existing ironmongery (Covered under Certificate of Lawful Development Application)

New wash hand basin to replace existing with new mirror above

Existing WC to be replaced with new (Covered under Certificate of Lawful Development Application)

New cubicle system to replace existing (Covered under Certificate of Lawful Development Application)

Total 1no. new shower enclosures, trays, shower head and mixers to replace existing (Covered under Certificate of Lawful Development Application)

Line walls with new Hygenic Wall panels. Panels up to ceiling. Dado rail to perimeter removed (Covered under Certificate of Lawful Development Application)

Existing nib to be removed. (Covered under Certificate of Lawful Development Application)

New vinyl flooring to replace existing. New timber skirting boards to be fitted to match existing. (Covered under Certificate of Lawful Development Application)

New cubicle system installed

PROPOSED BATHROOM ALTERATIONS  
BATHROOM NUMBER : F26 (FIRST FLOOR, EAST WING)

SCALE 1 : 20

C	Updated to suit clients comments.	30.11.21
B	Updated to suit clients comments.	30.11.21
A	Update to show what is covered in each applications.	23.11.21
Revision	Description	Date

**NB**  
Architects  
**DA**

www.nbda-architects.co.uk Tel 01625 575550

Client PGL HOLIDAYS

Project FORD CASTLE  
BERWICK-UPON-TWEED  
Drawing PROPOSED BATHROOM  
ALTERATIONS EXAMPLE  
SHEET 3

Drawing No 2035\MC-102 Revision C  
Scale 1:20@A1 Date 23.07.21 Drawn JWH

This drawing is copyright of N.B.D.A. Ltd. and should not be reproduced without permission. Dimensions should not be scaled off this drawing. All dimensions should be checked on site.

A1 Drawing