

COPYRIGHT NOTICE:
 This drawing is the copyright of the Architects and may not be reproduced or used except by written permission.

© Crown copyright and database rights (2014) Ordnance Survey licence number 100047514
 HSSP
 This drawing is to be used in conjunction with all relevant drawings and specifications. It is not scale from this drawing. All levels and dimensions to be checked on site. All levels and dimensions are to be taken to the immediate attention of HSSP Architects Ltd. Responsibility cannot be accepted for alterations made to the design without prior approval of HSSP Architects Ltd.
 Copyright reserved. This drawing may only be used for the client and location specified in the title block. It may not be copied or disclosed to any other party without the written consent of HSSP Architects Ltd.
 Prior to any work commencing on site, the engineer is to be contacted regarding the current status, revision or regulatory approval of the drawing.
 All work to be to the written satisfaction of the HSE or local Authority with all relevant drawings drawn or submitted on time. All work to be completed and approved by the end of the specified and level of work approved at the discretion of HSSP Architects Ltd. All work to be completed and level of work to be completed or checked and verified on the on-site specific level of work as commencing.
 This drawing is to be used in conjunction with clients specifications, requirements and structural engineers design.

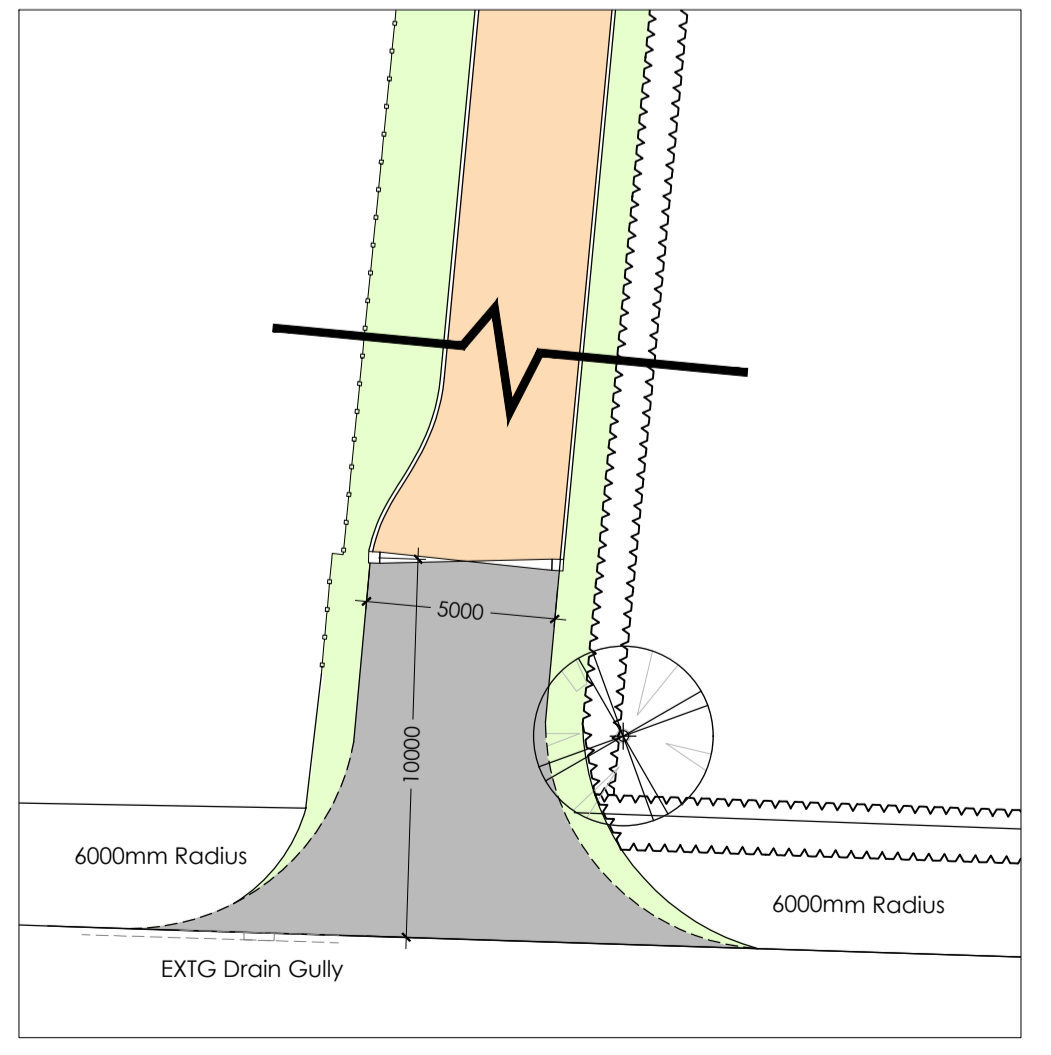
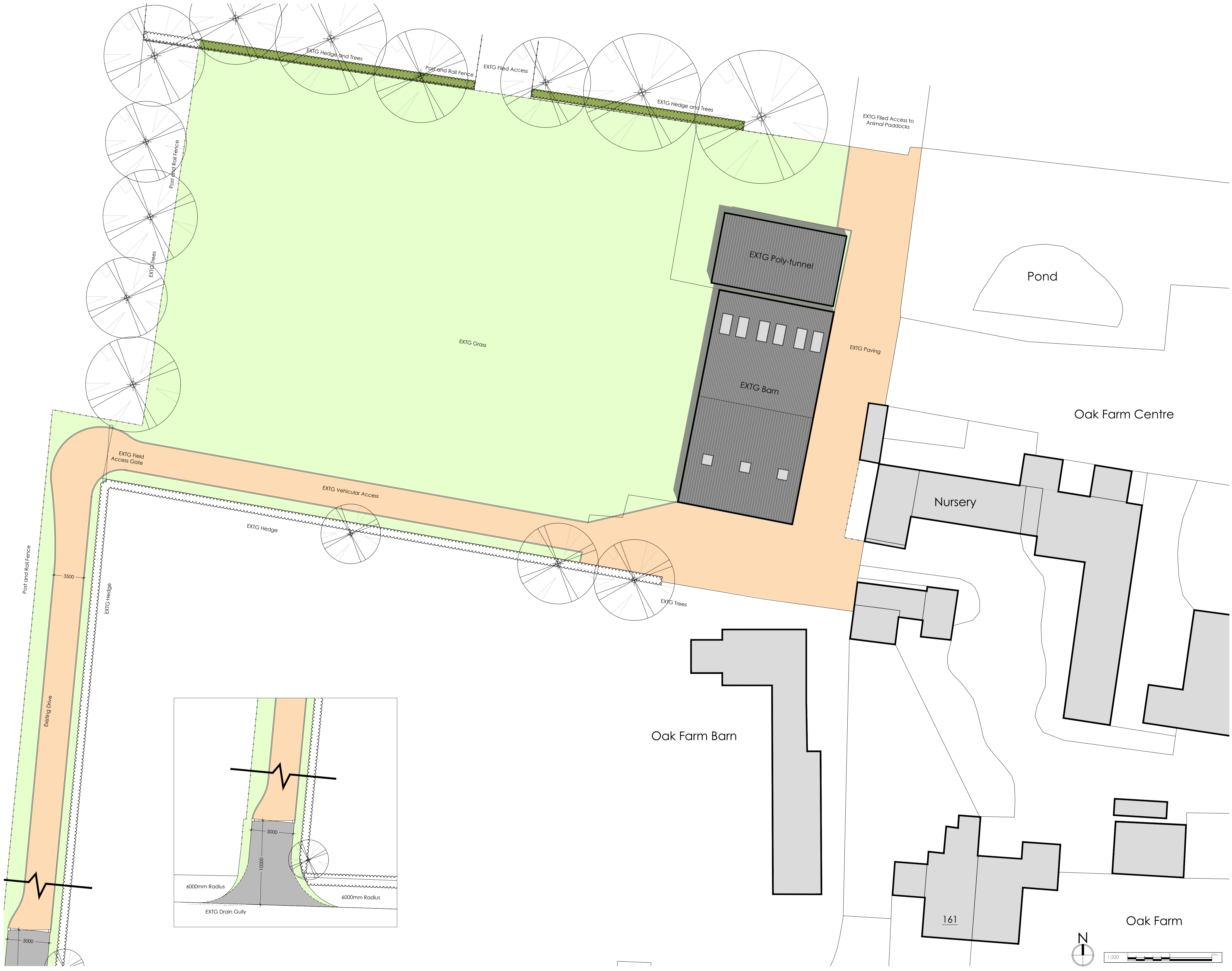

Site layout legend:

	Proposed site boundary		Red line site area: 4796.4sqm
	Block paving		Proposed tree planting
	Tarmac finish		Existing tree planting (root protection in red)
	450x450 riven faced paving slabs		Removed trees
	Areas laid to grass		1.8 CBF - 1.8m close boarded timber fence
	Low level landscape planting		

Revision Notes:
 Drawing Status:

PLANNING

hssp architects

Pera Business Park, Nottingham Road
 Melton Mowbray, LE13 0PB

Telephone: 01 664 563 288 Fax: 01 664 563 360
 E-Mail: info@hssparchitects.co.uk Web: www.hssparchitects.co.uk

Project:
 Barn Conversion
 Oak Farm, Drayton Lane
 Drayton Bassett
 Helen and Sarah Jones

Title:
 Existing Site Plan

Scale:	Drawn:	Checked:	Date:
1:200	LB	HC	Dec '21
Drawing No:	Revision:		
8454-01-02			

HSSP A1

