

**Proposed Agricultural Dwelling,
Little Farm, Rimswell Road, Halsham, Hull HU12 0BT**

October 2021

Job No. 2504

Drawing No. P2

Jonathan S. Hobson R.I.B.A.

Ingleby and Hobson Architects RIBA

FIRST FLOOR, 28 LAIRGATE, BEVERLEY, E. YORKSHIRE, HU17 8EP

Tel: 01482 868690

email inghob@gmail.com

Note this drawing is Copyright & shall not be reproduced or made use of without the authority of Ingleby & Hobson Ltd Architects

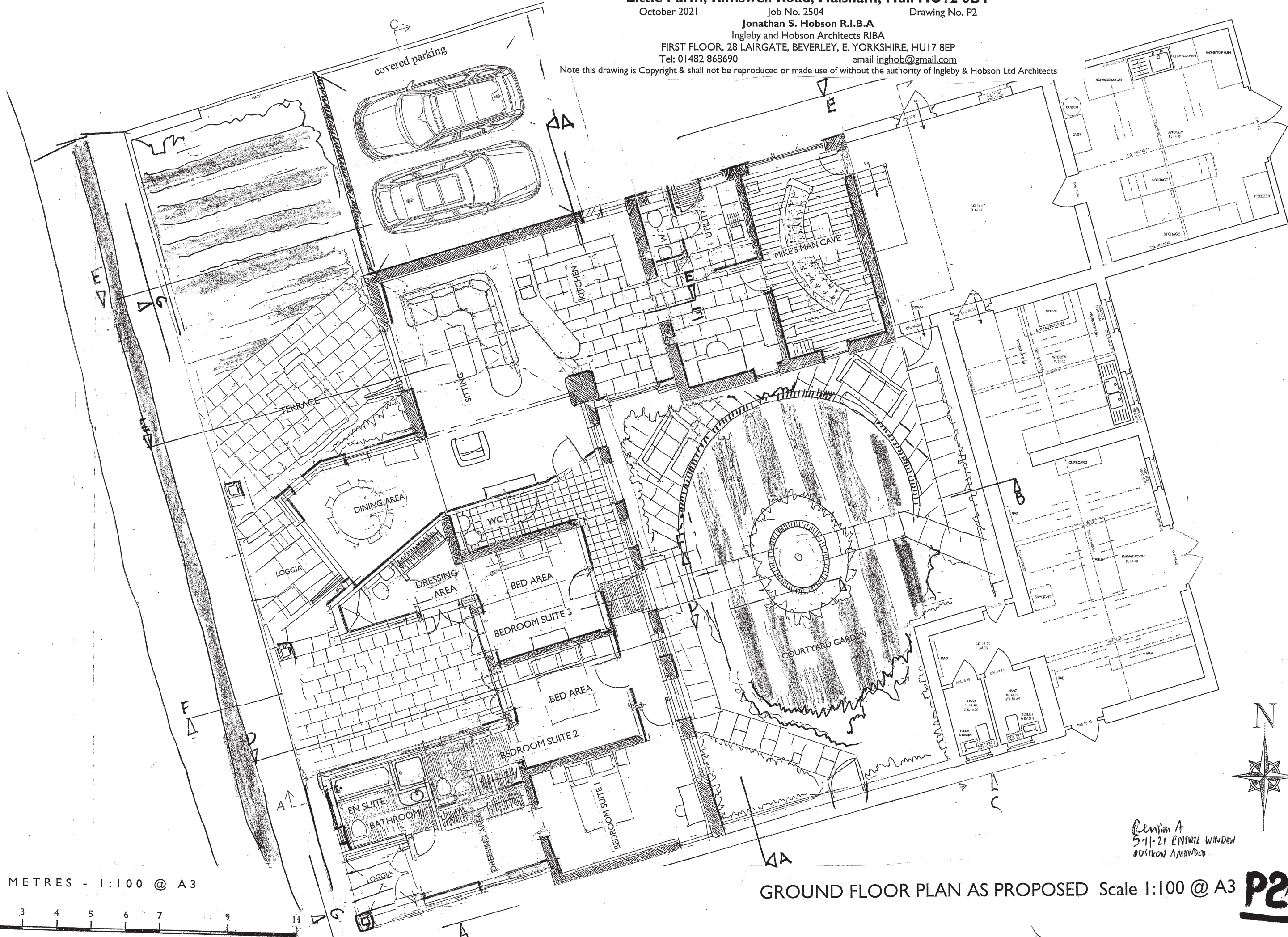

Revision A
5-11-21 ENSUITE WINDOW
POSITION AMENDED

GROUND FLOOR PLAN AS PROPOSED Scale 1:100 @ A3

P2

SCALE OF METRES - 1:100 @ A3

