

DO NOT SCALE FROM THIS DRAWING.
Except for planning purposes. All dimensions must be verified by the main contractor before the commencement on site of any item of work or the preparation of shop drawings for their own work or that of sub-contractor or suppliers.
This drawing is to be read in conjunction with all relevant documents. Any queries or discrepancies must be reported immediately to the architect.
This document is copyright of Studio Hudson Ltd

Key

Planning Application Boundary

Site Ownership Boundary

Line of existing building

Outline of existing trees to be retained

Outline of root protection zone
As identified in Tree Survey
Ref: tbc

T1, T2 etc
Outline of tree to be removed

Outline of new proposed
hedge and tree screening

Home Electric Vehicle charger point



Rolec Type 2, Mode 3 charging sockets are to be installed in locations shown and to be installed in accordance with manufacturer's requirements:

- i. BASICCHARGE EV Freestanding pedestal charging unit 3.6kW, 16A with built-in 20A, 30mA Type A (DC Sensitive) RCBO By Rolec or Similar
- ii. WALLPOD EV Wall mounted charging unit 3.6kW, 16A with built-in 20A, 30mA Type A (DC Sensitive) RCBO By Rolec or Similar

The base of the pedestal charging post features a cut out at surface level. The cut out is sufficient to allow suitably sized and rated Steel Wire Armoured (SWA) cable to access the Mount to supply the charging unit. SWA to be ducted below ground to the internally located isolator or as required by the Electrical Engineer

Wall mounted unit to be located as illustrated on the layouts and ducted via the sub-floor from the internal consumer unit.

The electrical supply shall be provided from the proposed plots installation consumer unit incorporating 30mA RCD protection in locations illustrated on the electrical layouts.



Example of hedge screening and woven willow fencing

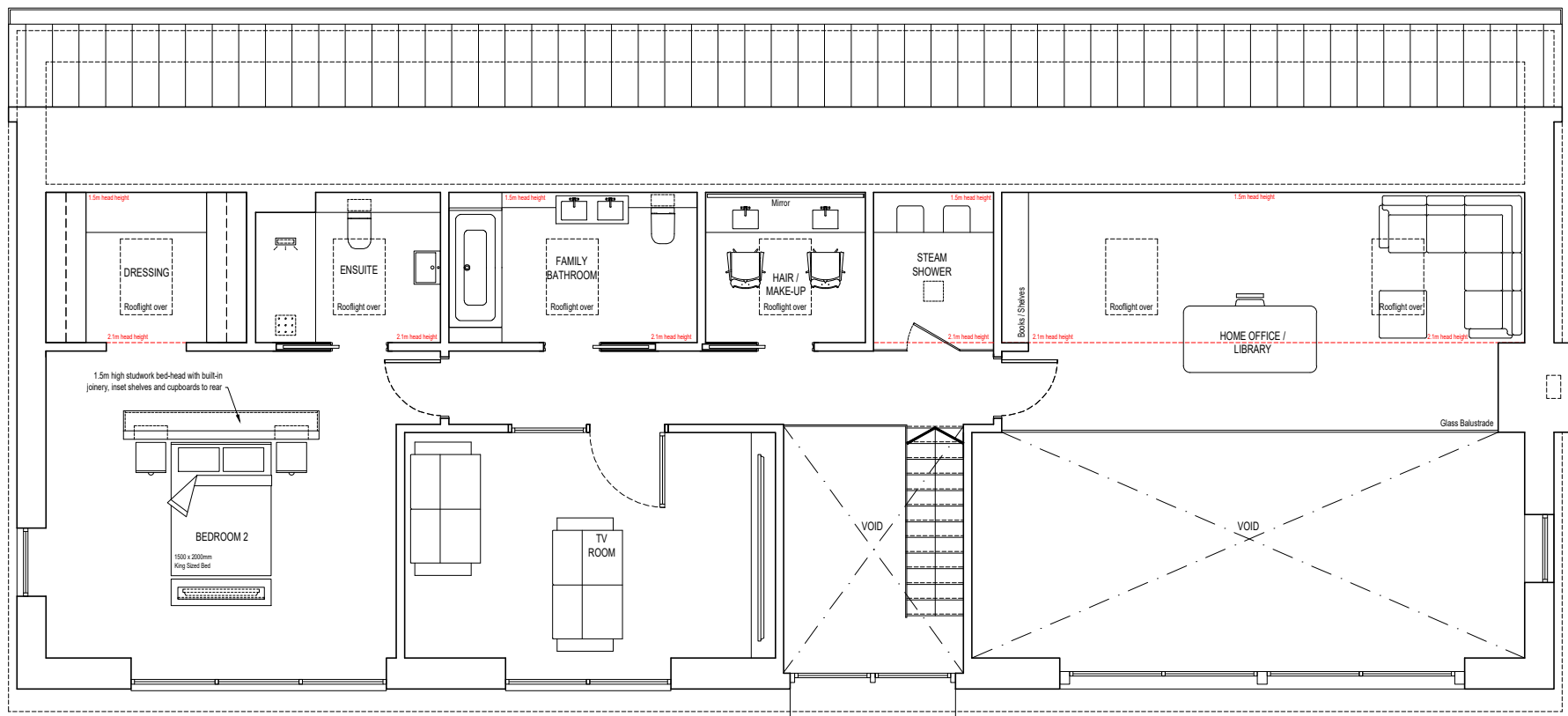

2 PLAN

Proposed First Floor Plan

SCALE 1: 100



1 PLAN

Proposed Ground Floor Plan

SCALE 1: 100



Studio Hudson Ltd. 2 Wilman Road, Royal Tunbridge Wells, Kent. TN4 9AJ

t: 01892 673 158 e: info@studio-hudson.co.uk
www.studio-hudson.co.uk

For Planning Submission Purposes

Project: Newlands, Delaware Farm

Hever Road, Edenbridge. TN8 7LD

Drawing Title:

Proposed Layouts

Drawing Number:

20017a-P-300

Date:

Nov 2021

Scale

Noted @ A1

Rev

B

