

PROPOSED SITE PLAN
SCALE 1:100

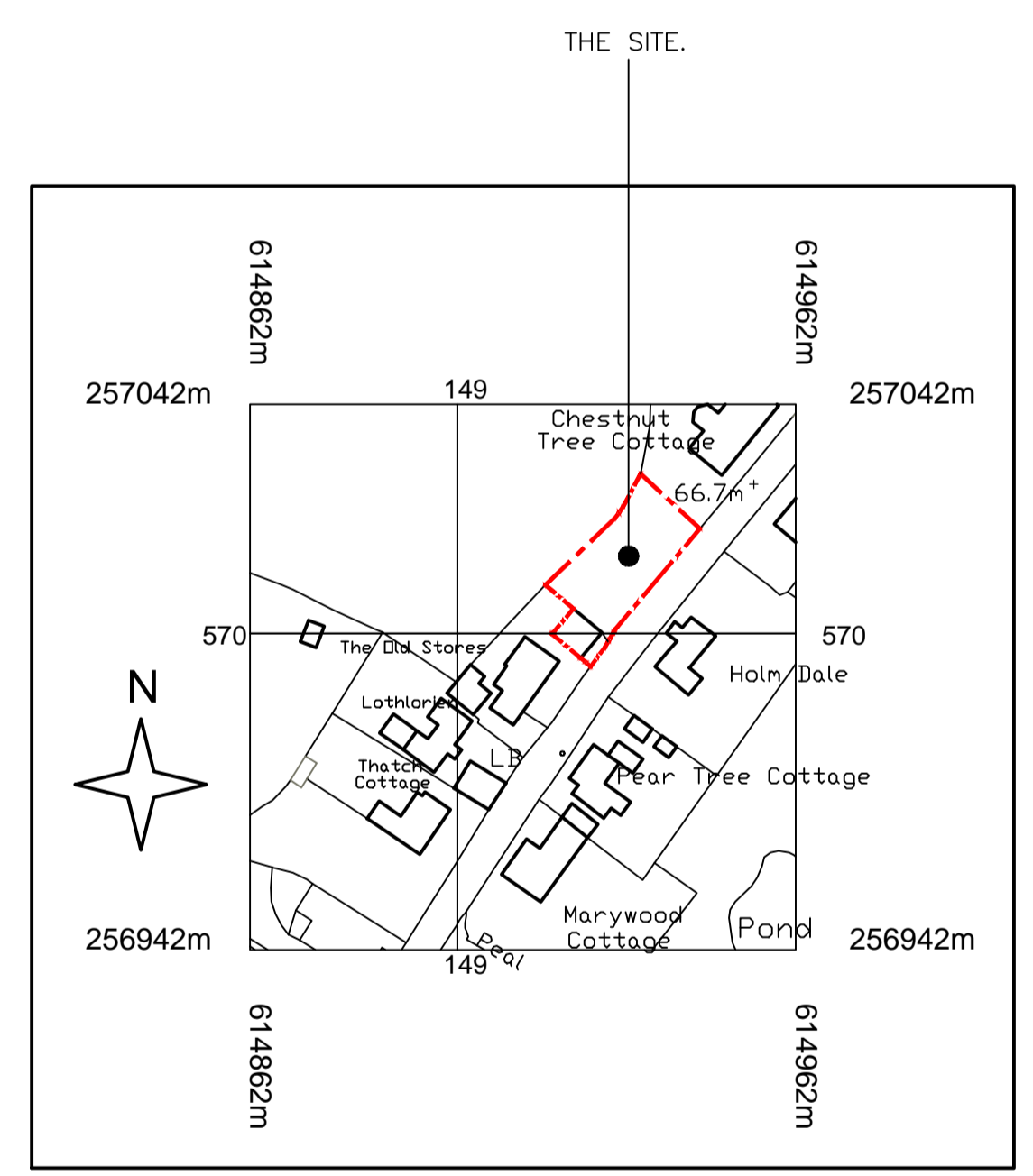

20 0 20 40 60 80 100
Metres

© Crown copyright and database rights 2021 OS 100035409
Reproduction in whole or in part is prohibited
without the permission of Ordnance Survey.

LOCATION PLAN
SCALE 1:1250.

Contract
PROPOSED DETACHED DWELLING ON LAND
ADJACENT TO "THE OLD STORES", STONE STREET,
CROWFIELD, SUFFOLK. IP6 9SZ.

Title
PROPOSED SITE & LOCATION PLANS.

Client
MR ADAM GRAY.

| REV | DATE | DESCRIPTION |
|----------|------|---|
| PB 12/21 | | PRELIMINARY—ISSUED FOR APPROVAL OF LANDSCAPE CONDITION 4. |
| PA 09/21 | | PRELIMINARY—ISSUED FOR BUILDING REGS APPROVAL. |
| REV | DATE | DESCRIPTION |

Stour Valley Design
Planning & Building Design Service
Swan Corner, Mill Lane, Bradfield, Essex, CO11 2UT
Telephone Numbers: (0)1255 870332; Mobile: 07759 328066
email address: simonankard@btinternet.com
website address: www.stour-valley-design.co.uk

Scale 1:100, 1:1250.
Date MAY 2021.
Drawn S. TANKARD

Drawing No. 21-2021-03
PB