

All Dimensions Shall be Checked on Site by the Contractor Prior to Commencement of Work on Site. Do Not Scale. If in Doubt Ask.

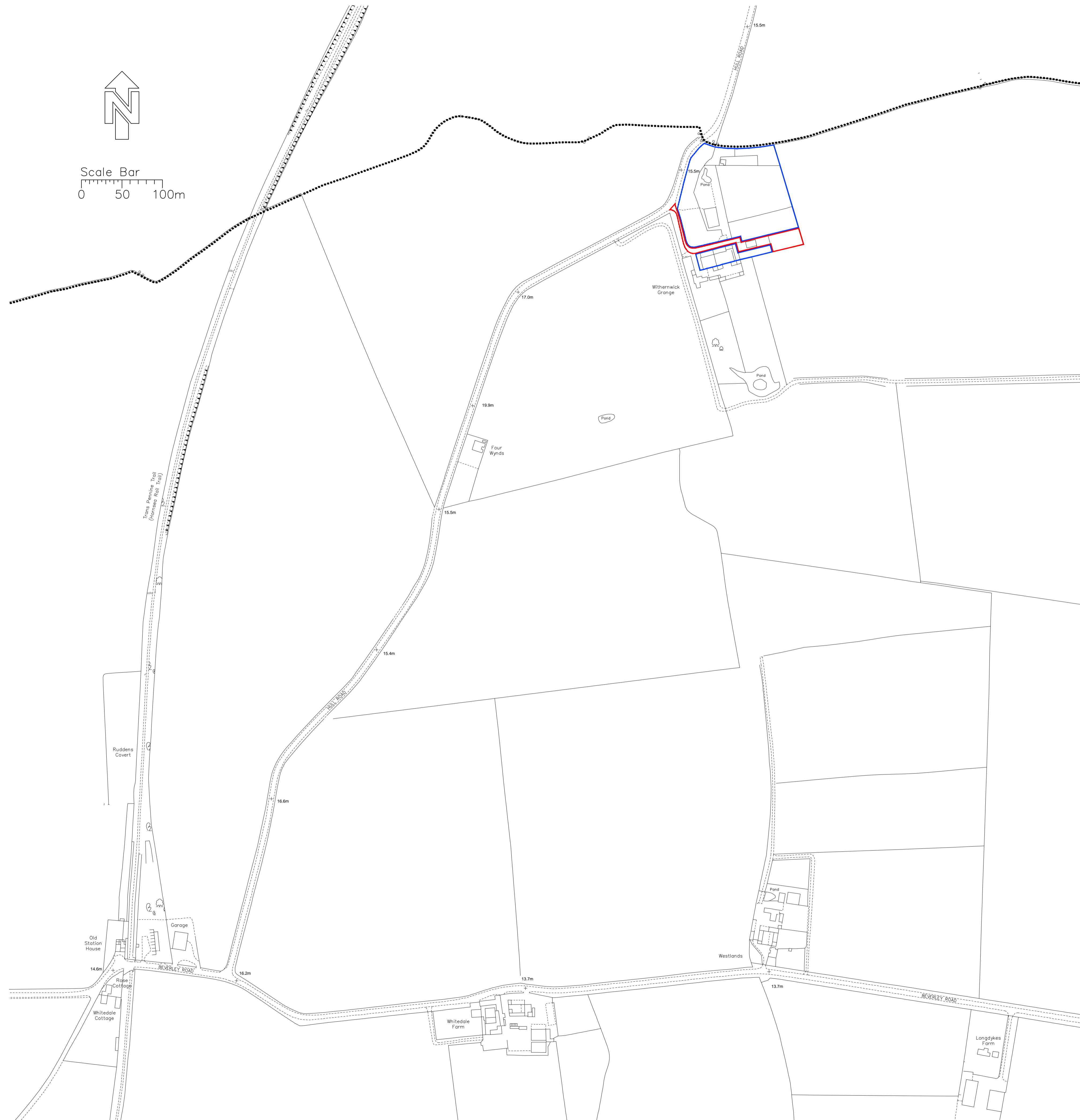
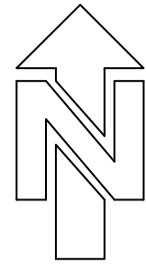

A: Added Scale Bar / Amended  
Agricultural Building Position 21/12/21

Revisions	Date
-----------	------

**Robert Farrow (Design) Ltd**  
Architecture : Planning : Construction  
Topographical Surveys

Millar House, 32 Northgate, Hessle,  
East Riding of Yorkshire, HU13 9AA  
Tel : 01482 640699  
E-mail: rfd@farrow.karoo.co.uk

**Client:** Mr & Mrs Thompson

**Title:** Location Plan  
Proposed Use of Agricultural  
Building for Stables at:  
Grange Barn, Hull Road, Whiteedale,  
East Riding of Yorkshire, HU11 4TY

Scale	Drawn by	Drg no.	Date	Contract no.
1:2500	SB	3A	Oct21	21100

Scale correct when printed at A1