

All Dimensions Shall be Checked on Site by the Contractor Prior to Commencement of Work on Site. Do Not Scale. If in Doubt Ask.

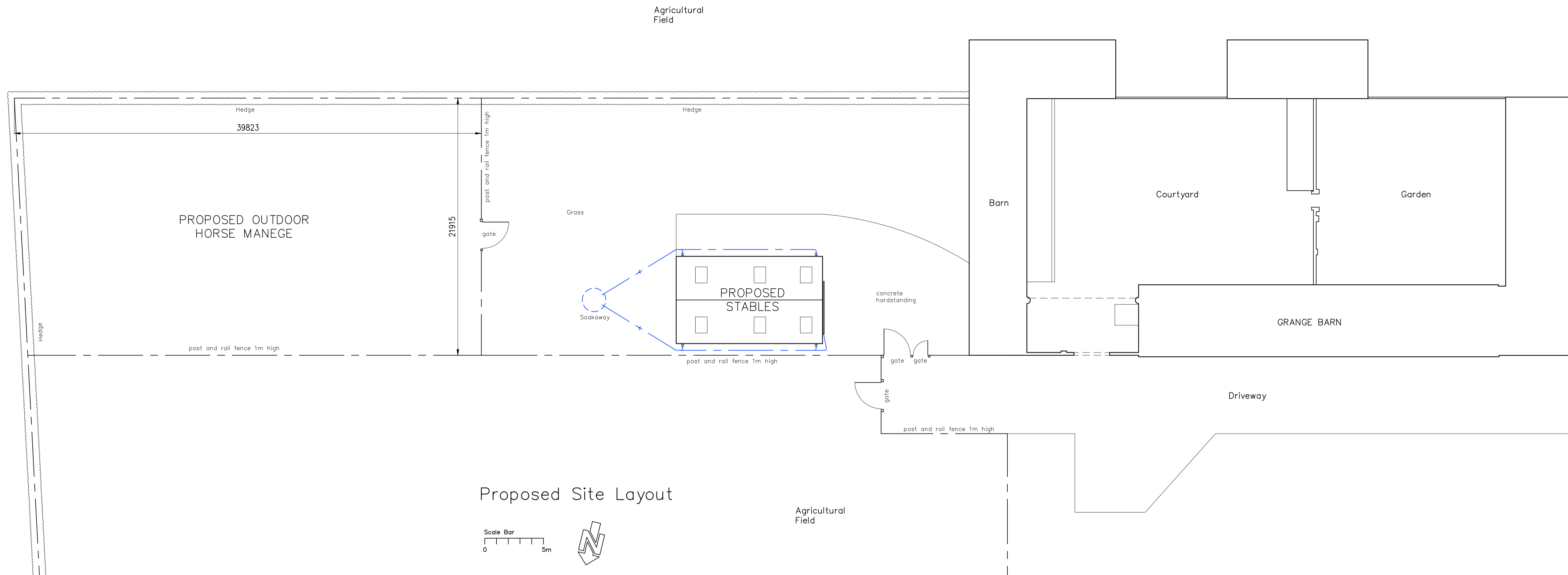

Proposed Site Layout

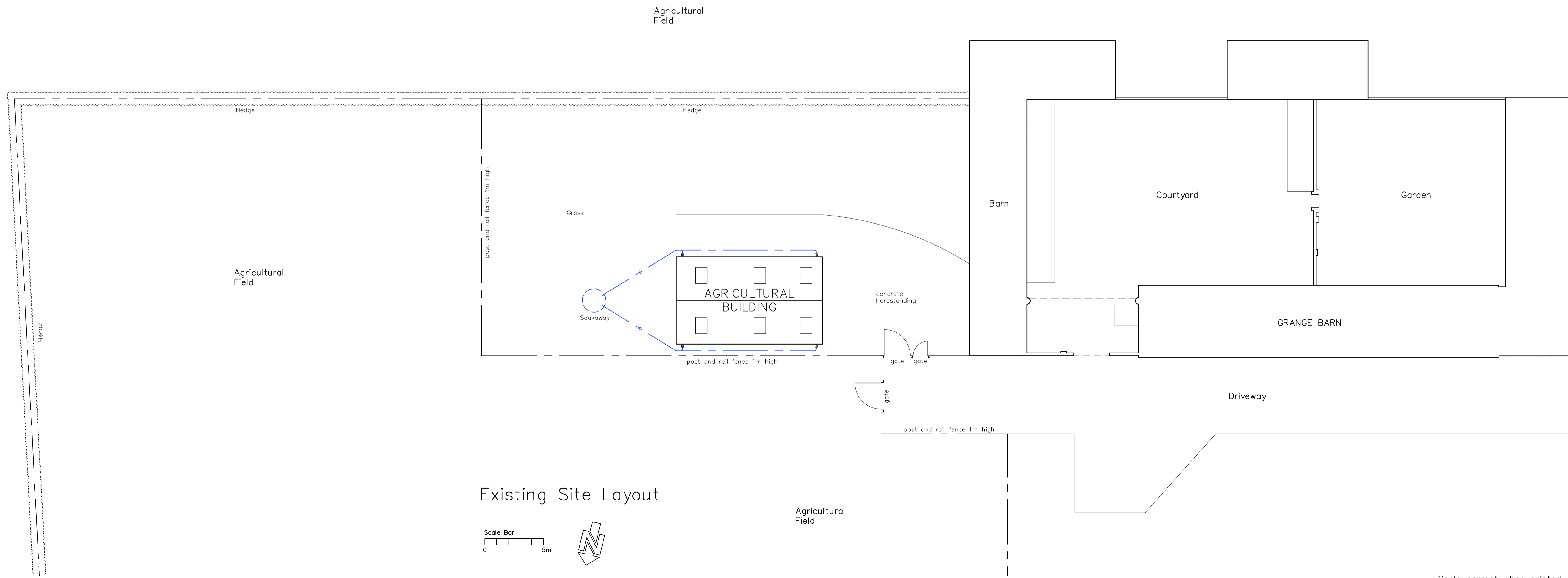

Existing Site Layout

Revisions	Date			
Robert Farrow (Design) Ltd Architecture : Planning : Construction Topographical Surveys Millar House, 32 Northgate, Hessle, East Riding of Yorkshire, HU13 9AA Tel : 01482 640699 E-mail: rfd@farrow.karoo.co.uk				
Client: Mr & Mrs Thompson				
Title: Site Layout Proposed Use of Agricultural Building for Stables at: Grange Barn, Hull Road, Whitdale, East Riding of Yorkshire, HU11 4TY				
Scale	Drawn by	Drg no.	Date	Contract no.
1:200	SB	1	Oct21	21100