

PROPOSED PLAN 1:100

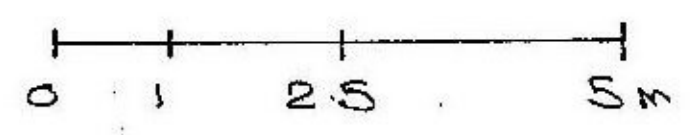

REVISIONS

- A 6.12.2021 Door to extension changed to bi-fold
- B 9.12.2021 Sycamore trees noted

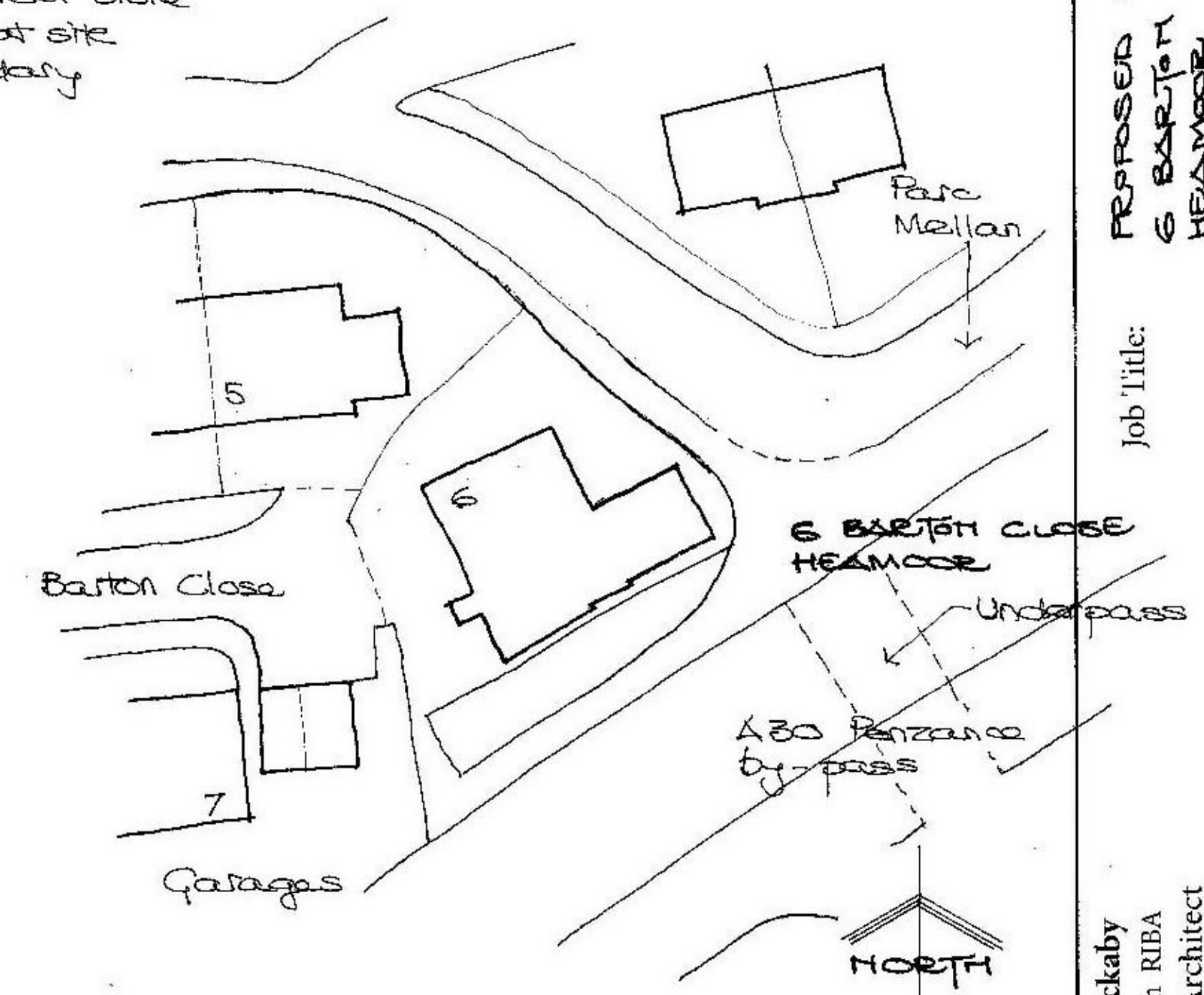

PROPOSED BLOCK PLAN 1:500

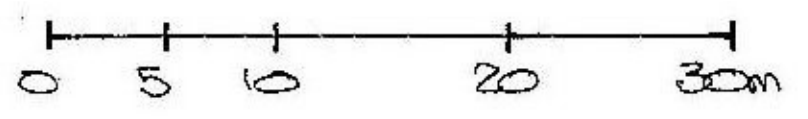

Peggy Rickaby
 BA Dip Arch RIBA
 Chartered Architect
 Milldowns Cottage Ladydowns Newmill
 Penzance TR20 8UZ
 Telephone 01736 796952
 email: peggyrickaby@ladydowns.com

Job Title: **PROPOSED EXTENSION TO 6 BARTON CLOSE HEAMORE**
 Drawing Title: **PROPOSED PLAN PROPOSED BLOCK PLAN**
 Scale: 1:100 & 1:500 at A3
 Date: 3.12.2021
 Drawing No: **SJ.3 A.B**

This drawing is copyright. All dimensions & setting out to be checked on site by contractor.