

Lawrence Hannah. The information contained in this drawing may not be used or reproduced in any way without express written consent.
Use figured dimensions only, do not scale.

ELECTRICAL

- lightswitch
- 2 way lightswitch
- dimmer lightswitch
- downlight (IP65 in Bathrooms)
- bulkhead fitting (IP65 in Bathrooms)
- pendant lampholder
- wall mounted uplighter
- external wall light with PIR & switch facility
- Track of Spotlights
- 2-gang 13A switched socket
- 2-gang 13A RCD exterior socket
- 1-gang 13A switched socket
- cooker control & connection unit
- 13A fused spur outlet
- interlinked mains heat detector
- interlinked mains smoke detector
- interlinked mains carbon monoxide detector

- extract fan - ceiling mounted
- extract fan - wall mounted
- telephone point
- TV aerial point
- MCB distribution board
- Flourescent strip lights
- Cooker Extract Hood
- Pull cord light switch

The electrical contractor is to be responsible for design, supply and installation of all electrical works and for co-ordination of mains supplies.

All electrical work to be in strict accordance with IEE 18th Edition regulations and carried out by an NICEIC registered contractor.

Include all electrics associated with heating and appliances to kitchen / utility room

All fittings to be flush mounted with

Contractor to provide full NICEIC test certificates for each installation on completion.

PLUMBING & HEATING

- BOILER External Oil Boiler specification advised by specialist
- STAT room thermostat
- WATER incoming water and stop-cock location
- RAD stelrad softline radiator with thermostatic and lockshield valves
- HTR chrome finish heated towel rail (exposed connection pipes to be chrome)
- Outside tap
- Shower
- Shower screen
- CYL Water cylinder specification advised by specialist

The plumbing contractor will be responsible for design, supply and installation of all plumbing and heating systems including sizing of boiler pipe sizing and layout

Hot and cold water supplies to be provided to all appliances shown on drawings.

All pipework to be concealed.

BASIS certificates for boilers to be provided upon completion

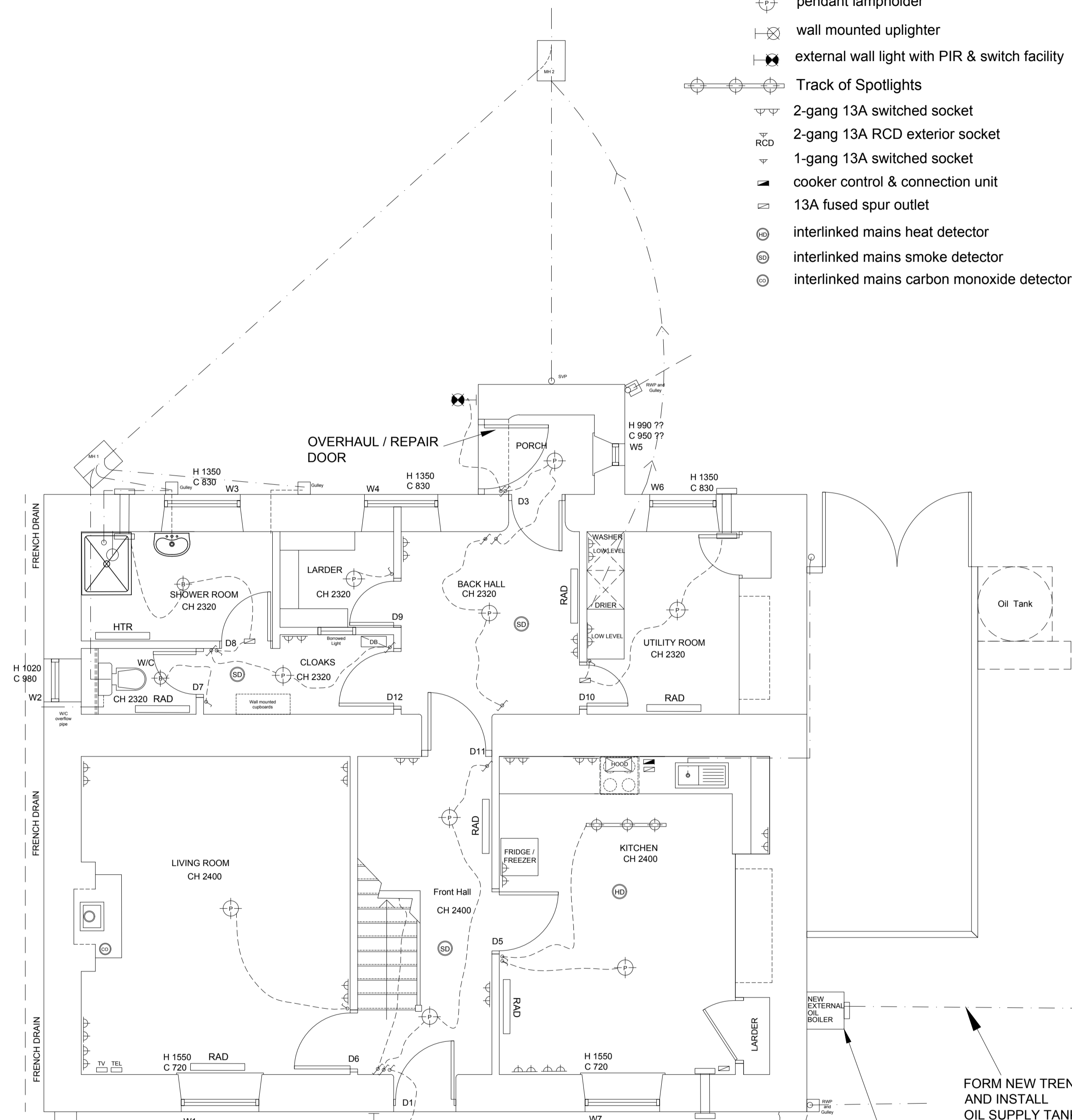

GROUND FLOOR PLAN

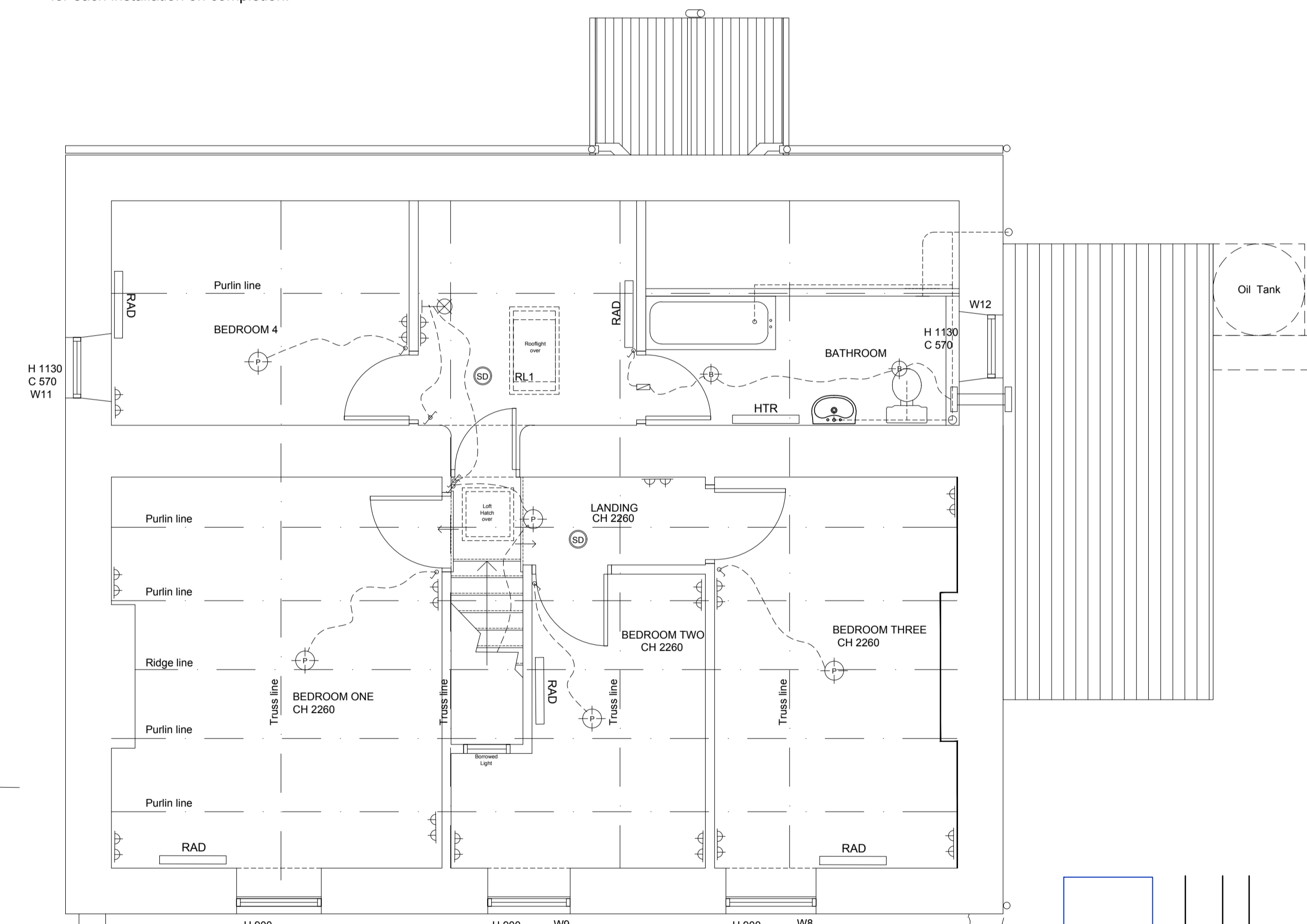

1ST FLOOR PLAN

LAWRENCE HANNAH
ARCHITECTURE DESIGN PROJECT MANAGEMENT

date	rev	amendment
client		
THE NATIONAL TRUST		
property		
GALLOWS HILL FARM		
drawing		
PROPOSED PLANS		
drawn	checked	
CS		
date	13.12.2021	scale 1:50@A1 1:100@A3
drawing no.	BS4409-GHF-05	rev A

39 BLOSSOM STREET
YORK YO24 1AQ
T: 01904 659 800
F: 01904 659 991
E: info@lh-property.com
www.lh-property.com