

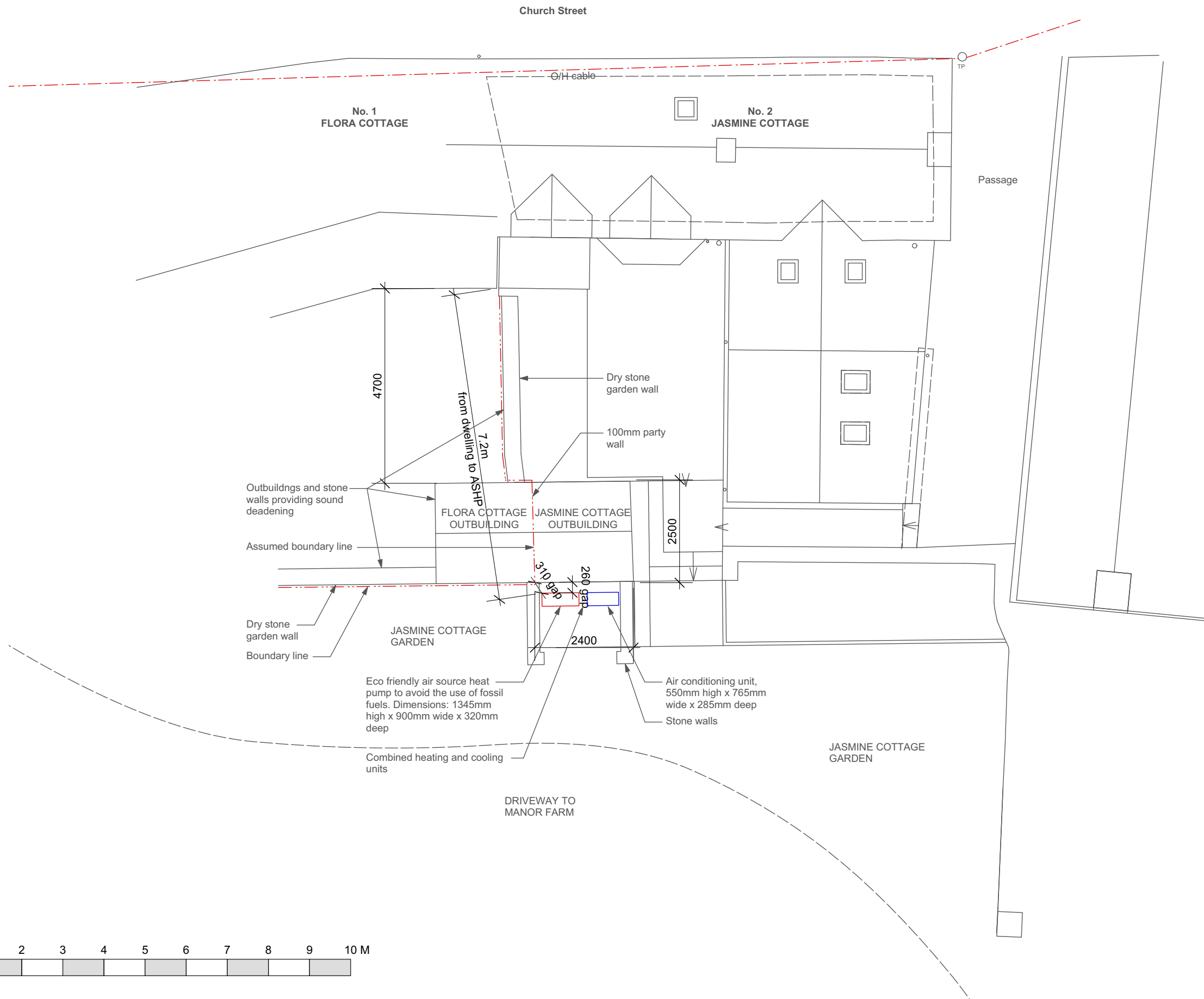

- NOTES:**
1. This drawing and its design is the copyright of Cotswold Architects Ltd. and may not be reproduced in any form without their prior consent.
 2. Do not scale off this drawing.
 3. Dimensions to be checked on site.



CLIENT:
Ana Morales & Eduardo Flores
cotswold architects.
 RIBA CHARTERED ARCHITECTS
www.cotswoldarchitects.com
info@cotswoldarchitects.com

tel. 01285 238528

PROJECT:
Retrospective Application for ASHP:
Jasmine Cottage
2 Church Street
Fife
OX7 6HF

TITLE:
Proposed Site Plan
PLANNING

DRAWING NO.	REV.
17-067-P-SP-200	

SCALE:
 1:100@A3

DATE:
 Dec 2021

