

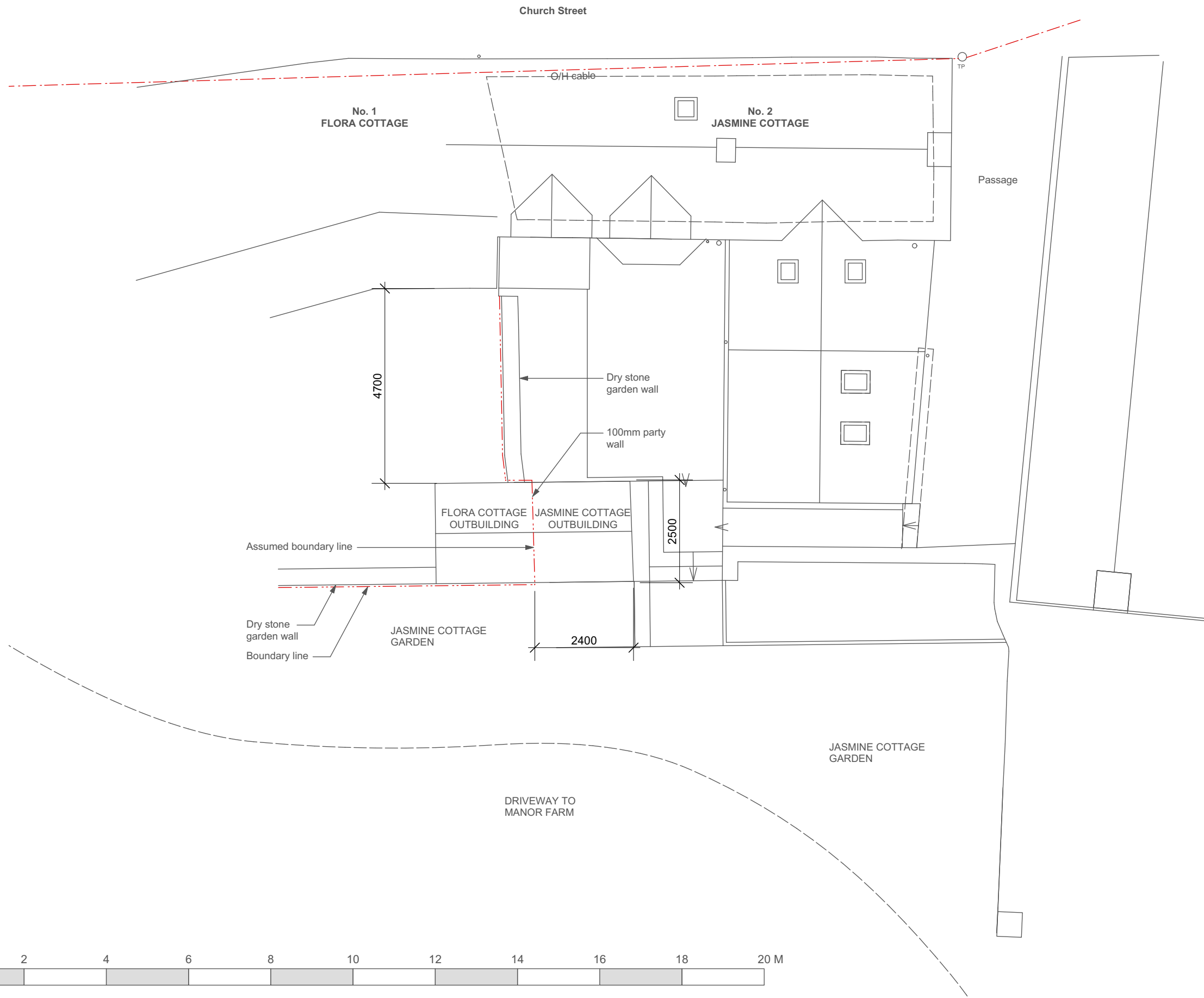

**NOTES:**  
 1. This drawing and its design is the copyright of Cotswold Architects Ltd. and may not be reproduced in any form without their prior consent.  
 2. Do not scale off this drawing.  
 3. Dimensions to be checked on site.



CLIENT:  
**Ana Morales & Eduardo Flores**  
**cotswold architects.**  
 RIBA CHARTERED ARCHITECTS  
[www.cotswoldarchitects.com](http://www.cotswoldarchitects.com)  
[info@cotswoldarchitects.com](mailto:info@cotswoldarchitects.com)

tel. 01285 238528

PROJECT:  
 Retrospective Application for ASHP:  
 Jasmine Cottage  
 2 Church Street  
 Fifield  
 OX7 6HF

TITLE:  
**Existing Site Plan**

DRAWING NO.	REV.
<b>17-067-E-SP200</b>	

SCALE:  
 1:100@A3

DATE:  
 Dec 2021

