

General Notes  
 1. Do not scale this drawing. All dimensions to be as noted. Contractor to check all dimensions on site before carry out works.  
 2. This drawing is for the private and confidential use of the client for whom it was undertaken and it should not be reproduced in whole or in part or relied upon by third parties for any use without the express written authority of Beech Architects Limited.

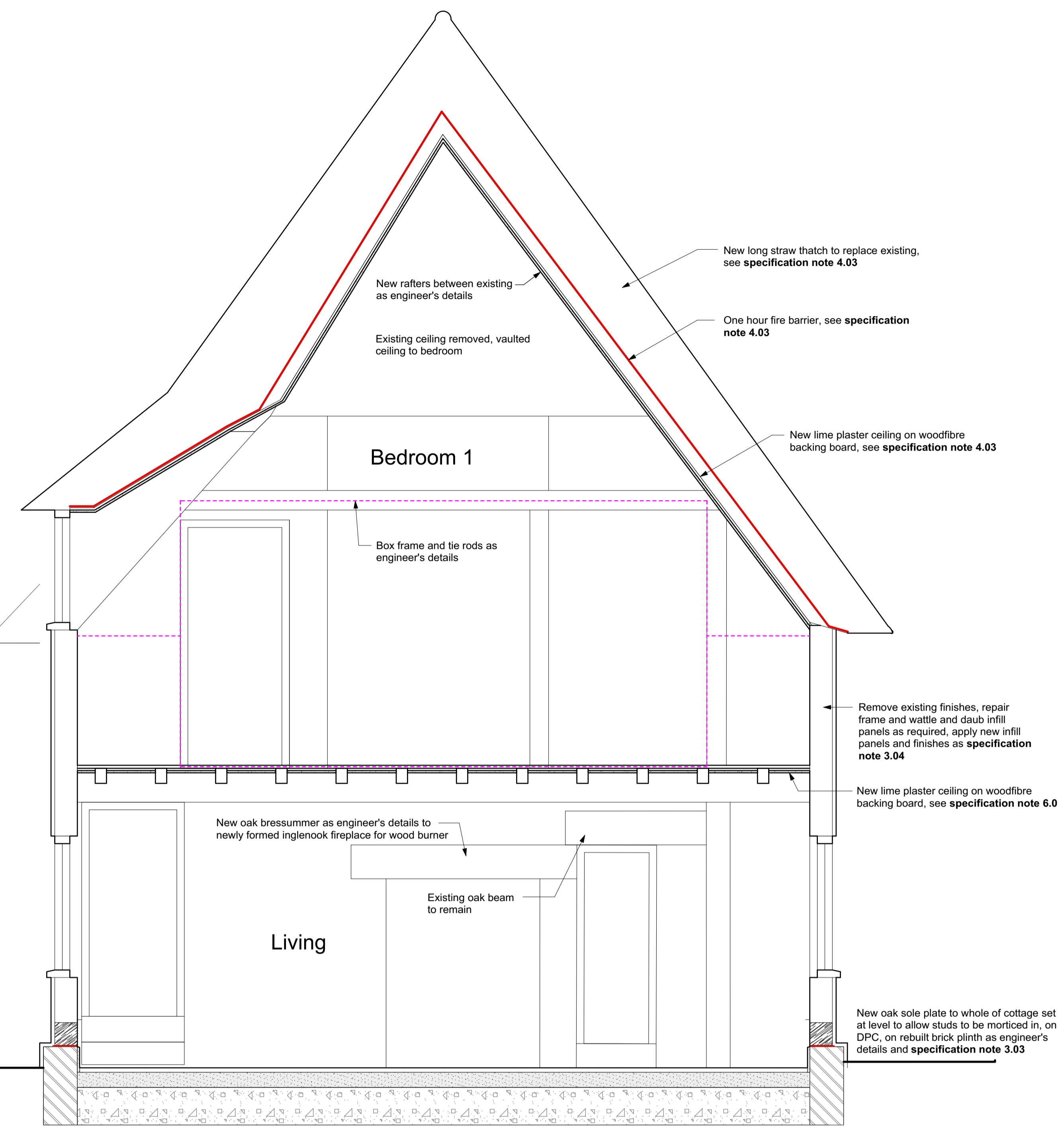

New ground floor of breathable Limecrete construction, see specification note 5.02

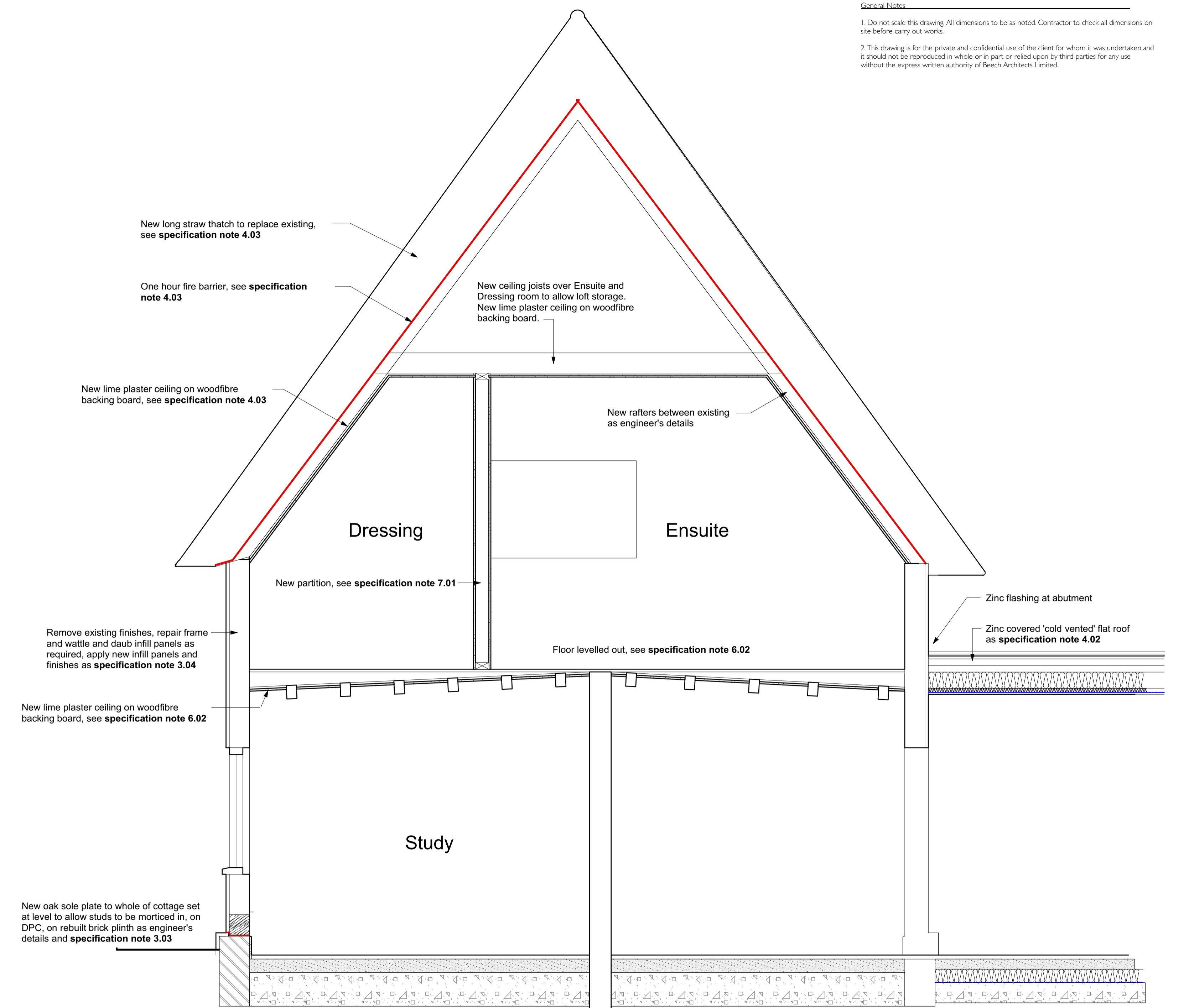

New ground floor of breathable Limecrete construction, see specification note 5.02

Ground floor as specification note 5.01, with ground bearing reinforced slab as engineer's details

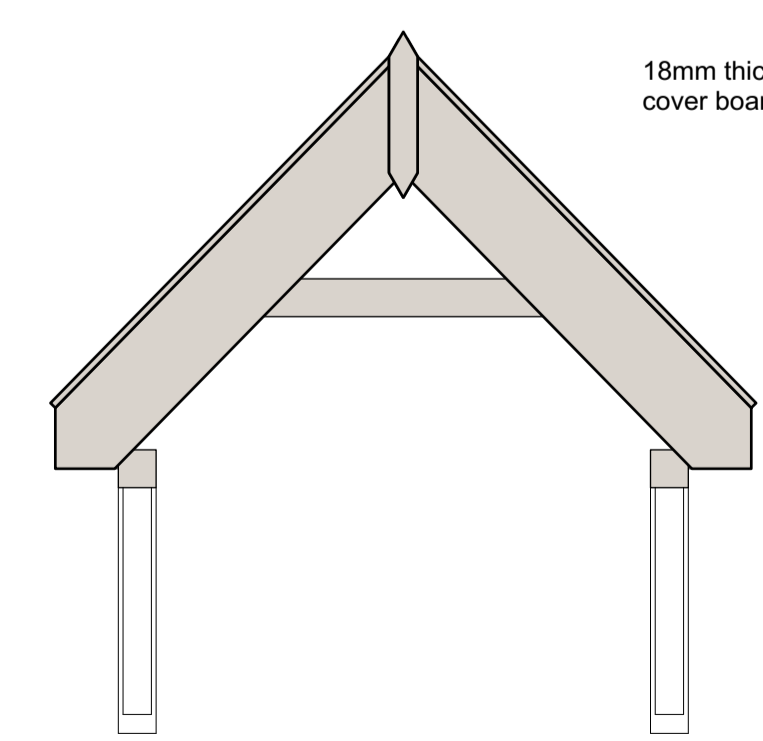

18mm thick oak barge boards, cover boards, fascias etc

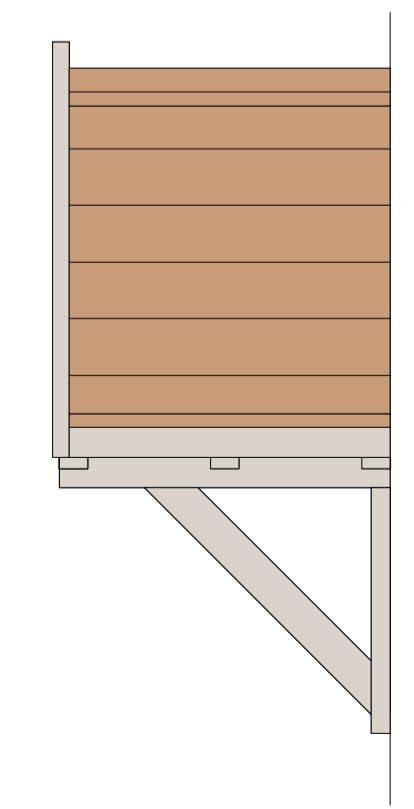

William Blythe Barco Old English red clay pan tile roof, on 25 x 38mm treated timber battens

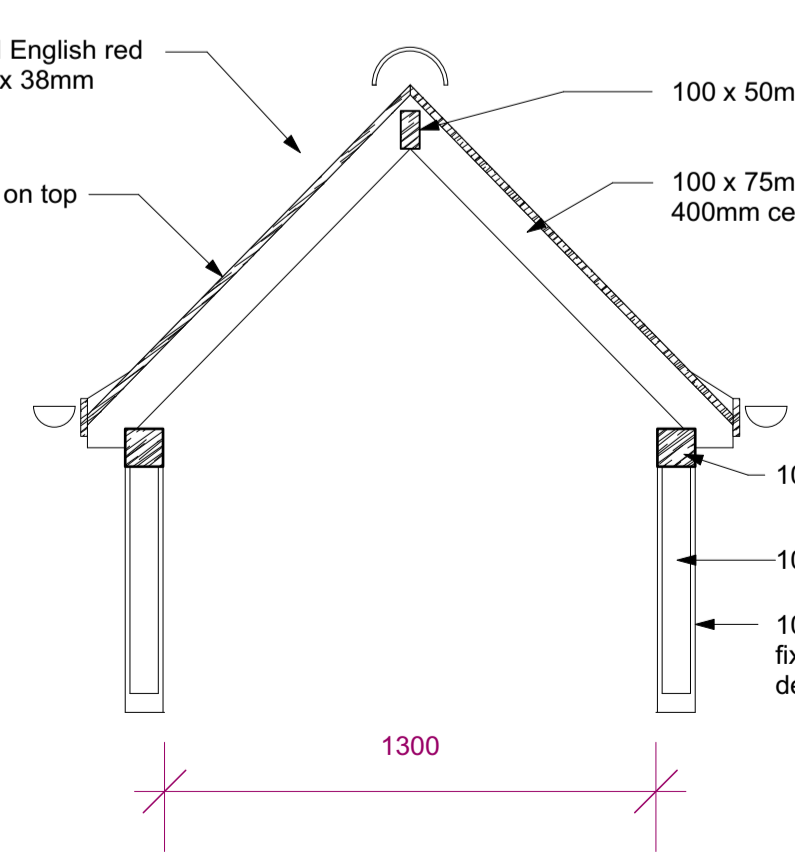

1300

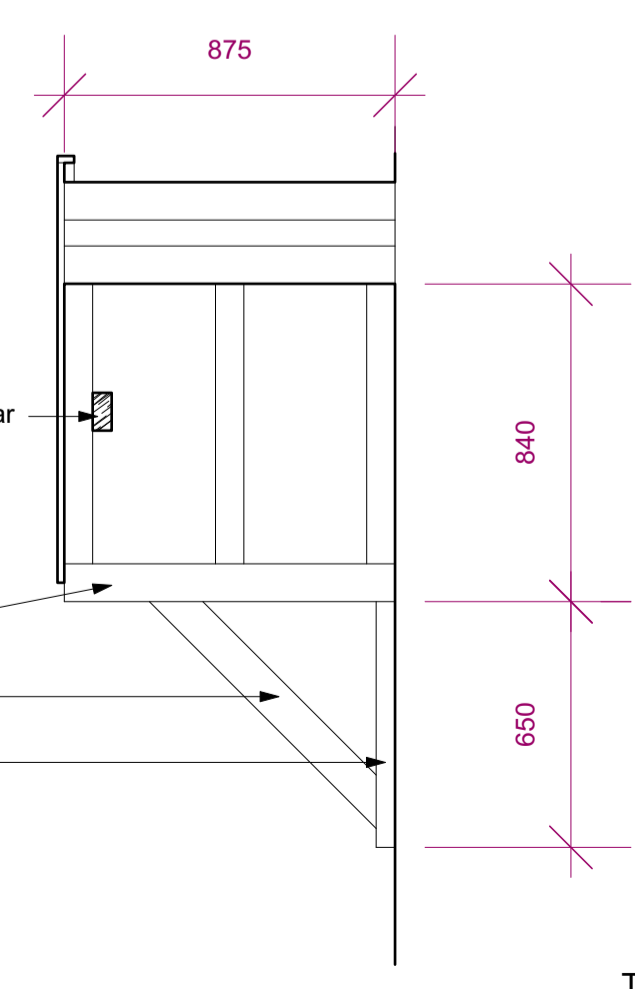

875

840

650

TO BE READ IN CONJUNCTION WITH THE SPECIFICATION DOCUMENT

A 20.12.21 First issue  
 Rev

**Beech ARCHITECTS**  
 Church Farm Barn  
 The Street  
 Thornston  
 Suffolk  
 IP23 7JR  
 www.beecharchitects.com  
 enquiries@beecharchitects.com  
 t 01379 678442

CLIENT  
 Giles and Jackie West

PROJECT  
 Town Meadow Cottage,  
 The Common,  
 Stuston,  
 Diss, Suffolk  
 IP21 4AA

DRAWING  
 Sections of Cottage

SCALE	DATE	DRAWN BY	CHECKED
1:50 @ A1	Sept 21	IJT	CB
DRAWING NUMBER	JOB NUMBER	STATUS	REV
WD06	471	Building Regs	A

This drawing is copyright and remains the property of Beech Architects Ltd. Original size A1. Scale shown will be incorrect if reproduced in any other format. All dimensions to be checked on site.