

DO NOT SCALE this drawing, figured dimensions only are to be used.
© This drawing is the sole copyright of BN1 Architects.
Any discrepancies between this drawing and other information should be reported to the Architect.
MODIFICATIONS TO THIS DRAWING TO BE MADE SOLELY ON ORIGINAL MAGNETIC MEDIA, AND MAY ONLY BE CARRIED OUT BY BN1 ARCHITECTS.
THE BOUNDARY SHOWN IS BASED ON INFORMATION SUPPLIED BY OTHERS, NOT BN1 ARCHITECTS ALL BOUNDARIES TO BE VERIFIED ON SITE.

Rev:	Date:	Description:	By:	Rvw:
A	08.12.21	Land in ownership shown on Location Plan	CB	
B	12.12.21	Location Plan updated	CB	

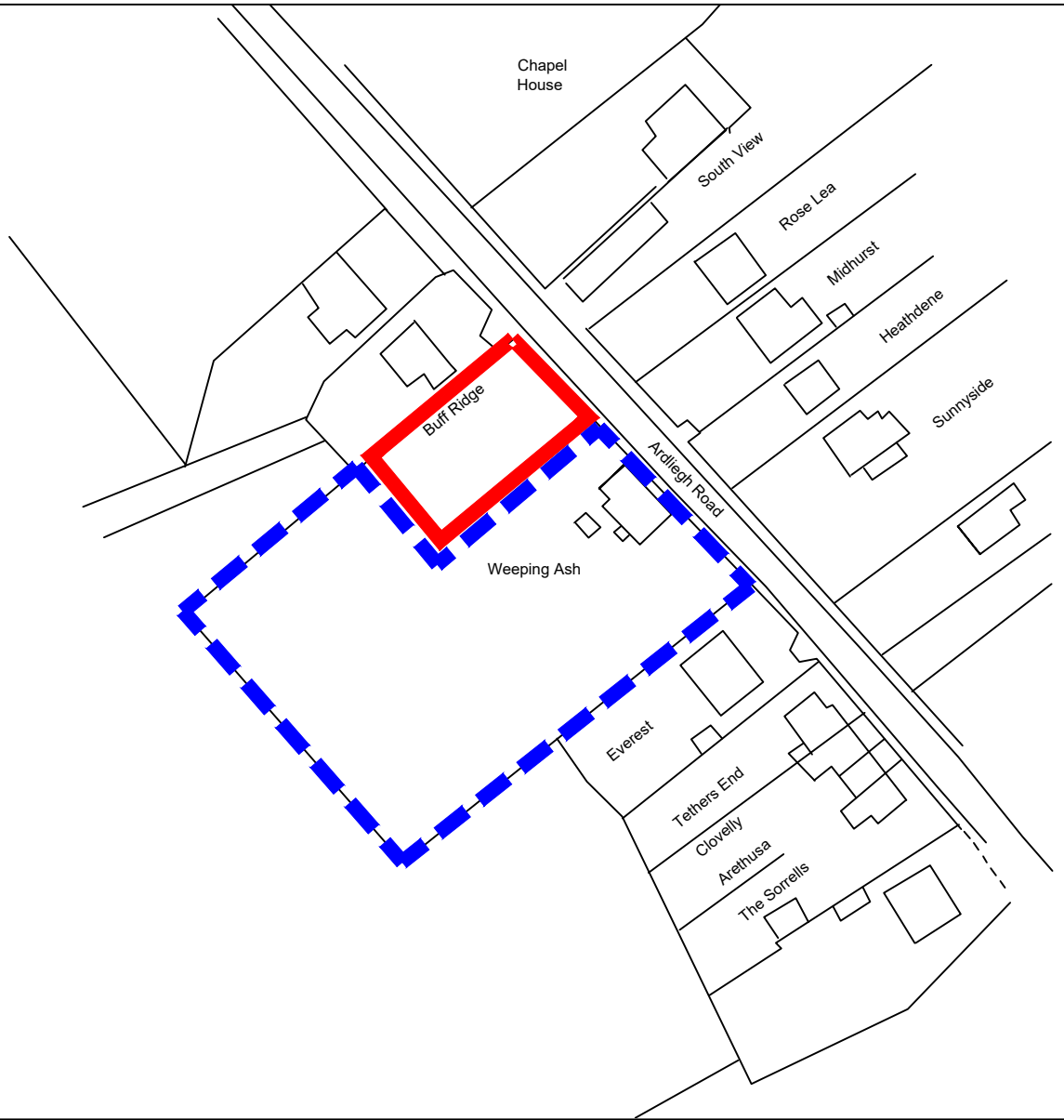

Location Plan Scale 1:1250

KEY

Site Boundary

Land in ownership

Schedule of Accomodation

PLOT 2	5 Bed	9P	189.4 sq m	2039 sq ft
TOTAL				2039 sq ft

BN1 ARCHITECTS



Client:	202 Ditching Road Brighton, East Sussex BN1 6JE Telephone: 01273 500968 E-mail: chrisbrooks@bn1architects.co.uk Website : bn1architects.co.uk Project Name:	Mobile : 07913 916721
Drawing Title:	Weeping Ash Ardleigh Road Great Bromley	
Project No:	BN317	Revision: B
Drawing No:	P - 010	
Drawing Status:	Planning	
Date:	18.11.21	
Scale:	1:200	
Drawn:	@ A1 @ A3	Reviewed:

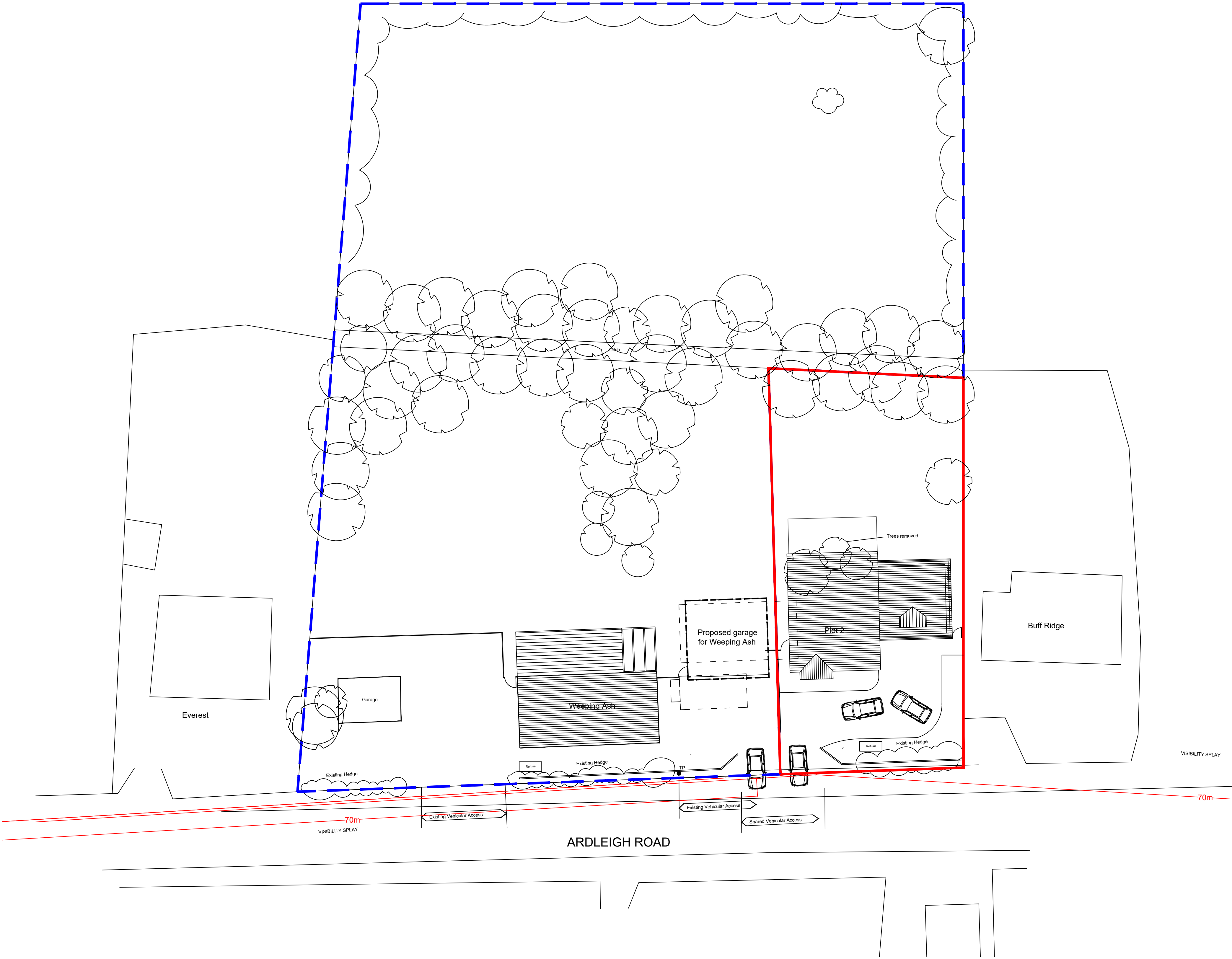

Block Plan Plot 2 Scale 1:200