

AREA SCHEDULE		
AREA	Sqm	Sqft
Total	135.8	1461.4
Total Sales	7.3	78.5
Total BOH, of which:	128.5	1382.9
- Toilets	3.9	41.9
- Freezer	4.5	48.4
- Chiller	6.1	65.6
- BOH	51.6	555.4
- Staff area	62.4	671.6

DOOR SCHEDULE						
Door Ref	Location	W x H	Vision Panel	Wall Thickness	Fire Rated	Door Furniture
DG01	ENTRANCE	925x2100	GLAZED	-	-	Cranked D Handle
DG02	STAFF ENTRANCE	825x2100	GLAZED	-	-	Cranked D Handle
DG03	CHILLER	900x2100	-	-	-	
DG04	W/C LOBBY	Existing	-	-	-	
DG05	MANAGER'S OFFICE	Existing	-	-	-	
DG06	W/C	Existing	-	-	-	
DG07	REAR EXIT	810x2100	-	-	-	DIGI LOCK
DG08	REMOTE STORAGE AREA	1405x2100	-	-	-	DIGI LOCK
DG09	FREEZER	900x2100	-	-	-	

PLEASE NOTE THAT ALL DOOR OPENING DIMENSIONS ARE TO BE TAKEN ON SITE PRIOR TO ORDERING & INSTALLATION.

- GENERAL NOTES**
- ALL WORKS WITHIN THIS DOCUMENT TO BE INSTALLED/CARRIED OUT IN COMPLIANCE WITH THE LATEST BUILDING REGULATIONS AND BRITISH STANDARDS.
 - CONTRACTOR MUST CHECK AND VERIFY ALL ON SITE DIMENSIONS PRIOR TO MANUFACTURE/INSTALLATION AND MUST REPORT ANY DISCREPANCIES BACK TO RETAIL DESIGN SOLUTIONS. FAILURE TO DO SO WILL BE AT THE CONTRACTORS EXPENSE.
 - ANY CONSTRUCTION/MANUFACTURE DRAWINGS IN THIS DOCUMENT ARE INDICATIVE ONLY. IT IS THE RESPONSIBILITY OF THE CONTRACTOR TO ENSURE THEY ARE FIT FOR PURPOSE, AND TO MAKE AMENDMENTS WHERE NECESSARY PRIOR TO INSTALLATION.
 - THE CONTENTS OF THIS DOCUMENT ARE THE PROPERTY OF RETAIL DESIGN SOLUTIONS LTD AND MUST NOT BE COPIED OR DISTRIBUTED IN WHOLE OR PART WITHOUT FORMAL CONSENT.

TERMINOLOGY KEY

PC Principal Contractor
SAC Security & Alarm Contractor

REV	DATE	NOTES
-	04/01/2024	DESIGN PACK PRODUCED

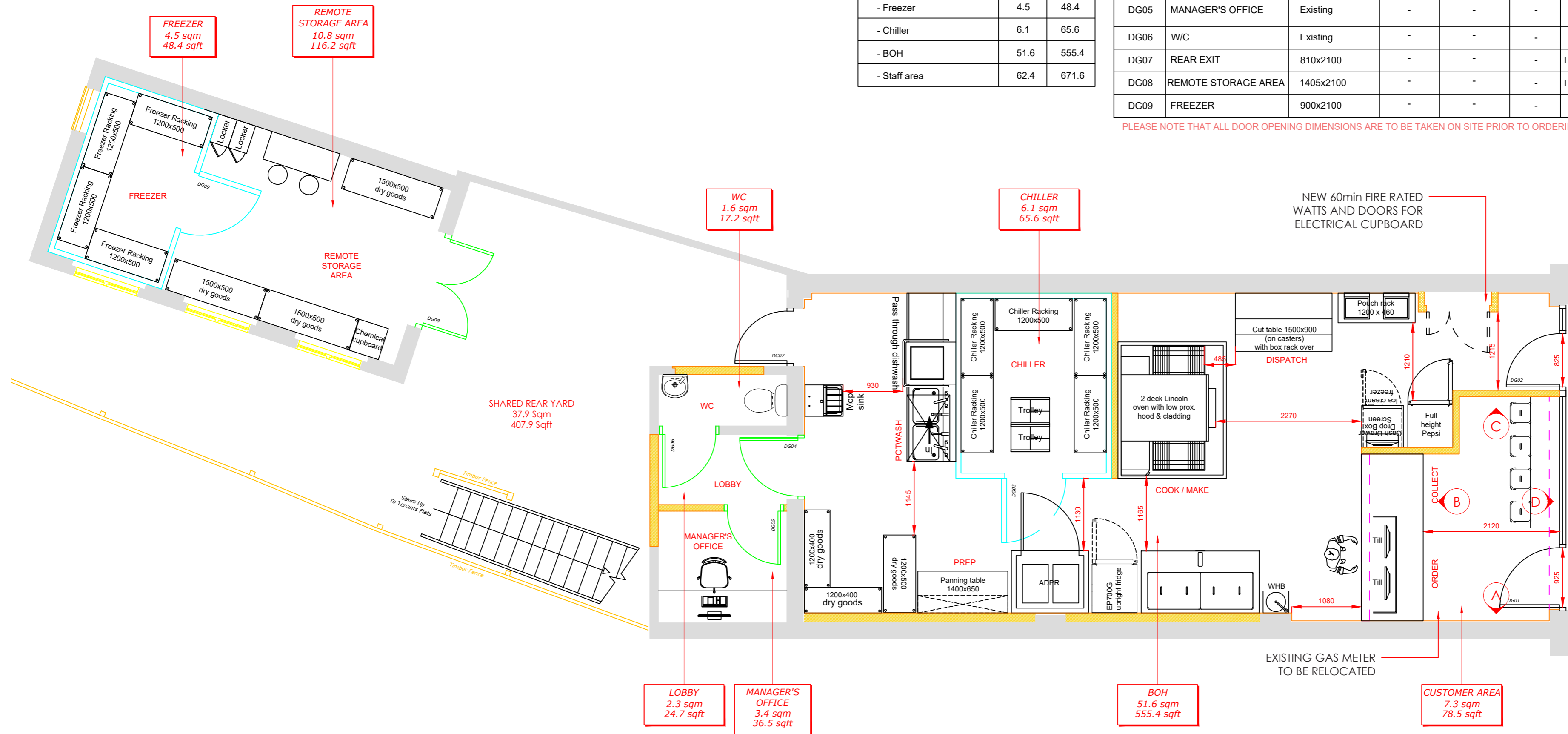

PROJECT: SIDCUP

ADDRESS: 131 STATION ROAD, SIDCUP, KENT, DA15 7AA

PROPOSED GROUND FLOOR GENERAL ARRANGEMENT

Scale: 1:50@A2

DATE: 03/06/2024

PROJECT: SIDCUP

Pizza Hut

DRAWN BY: rds

The Mill Store, Foundry Lane, Earls Colne, Essex, CO6 2SB, Tel. 01787 224878

WALL TYPES

	Existing Structural
	Proposed New Partitions
	Existing Column
	No Access
	Proposed Bulkhead

- PROPOSED GENERAL ARRANGEMENT NOTES**
- Shop Front**
- New shop front to be installed with double doors
 - New Facia and Projecting Signage.
- Flooring**
- New Vinyl to rear of Service Counter.
 - New Tiling and Mat to Customer Area.
- Walls**
- All new internal partition walls