

EXISTING PLANS, SHOWING REMOVAL OF WALLS  
 AS PERMITTED BY THE ORIGINAL PLANNING APPLICATION.  
 REF NO: PF/20/1518 (Planning Permission).

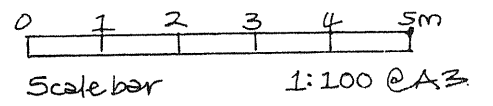

EX 01A

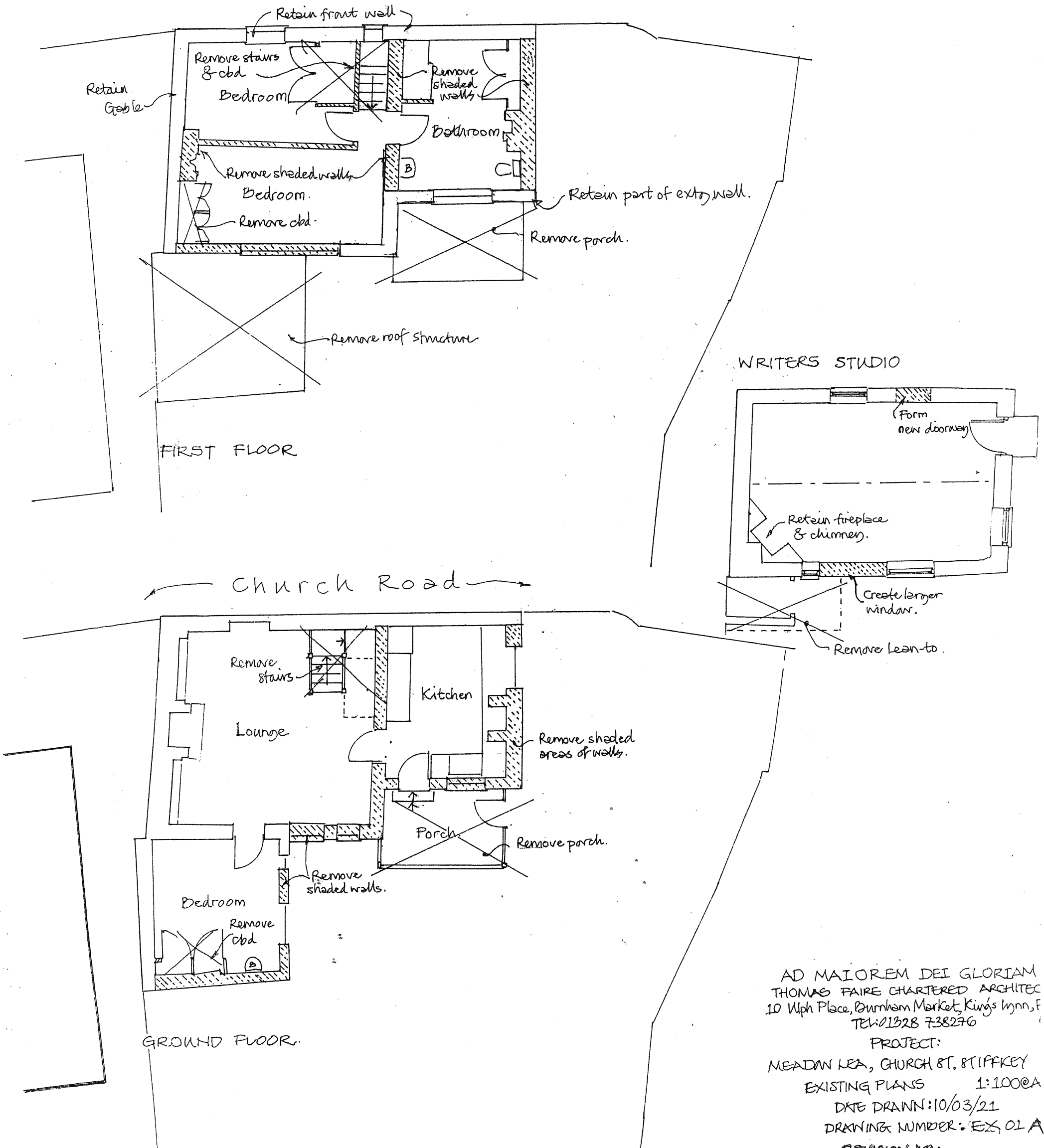

AD MAIOREM DEI GLORIAM  
 THOMAS FAIRE CHARTERED ARCHITECT  
 10 Wph Place, Burnham Market, King's Lynn, F  
 TEL: 01328 738276  
 PROJECT:  
 MEADAN LEA, CHURCH ST, ST IFFKEY  
 EXISTING PLANS 1:100@A  
 DATE DRAWN: 10/03/21  
 DRAWING NUMBER: EX, 01A  
 REVISION NO: