

This drawing and the copyrights and patents therein are the property of DMP LLP and may not be used or reproduced without consent.

This drawing is to be read in conjunction with all relevant consultants and/or specialist's drawings/documents and any discrepancies or variations are to be notified to DMP LLP before the affected work commences.

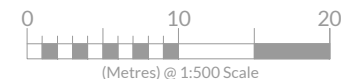

Revision

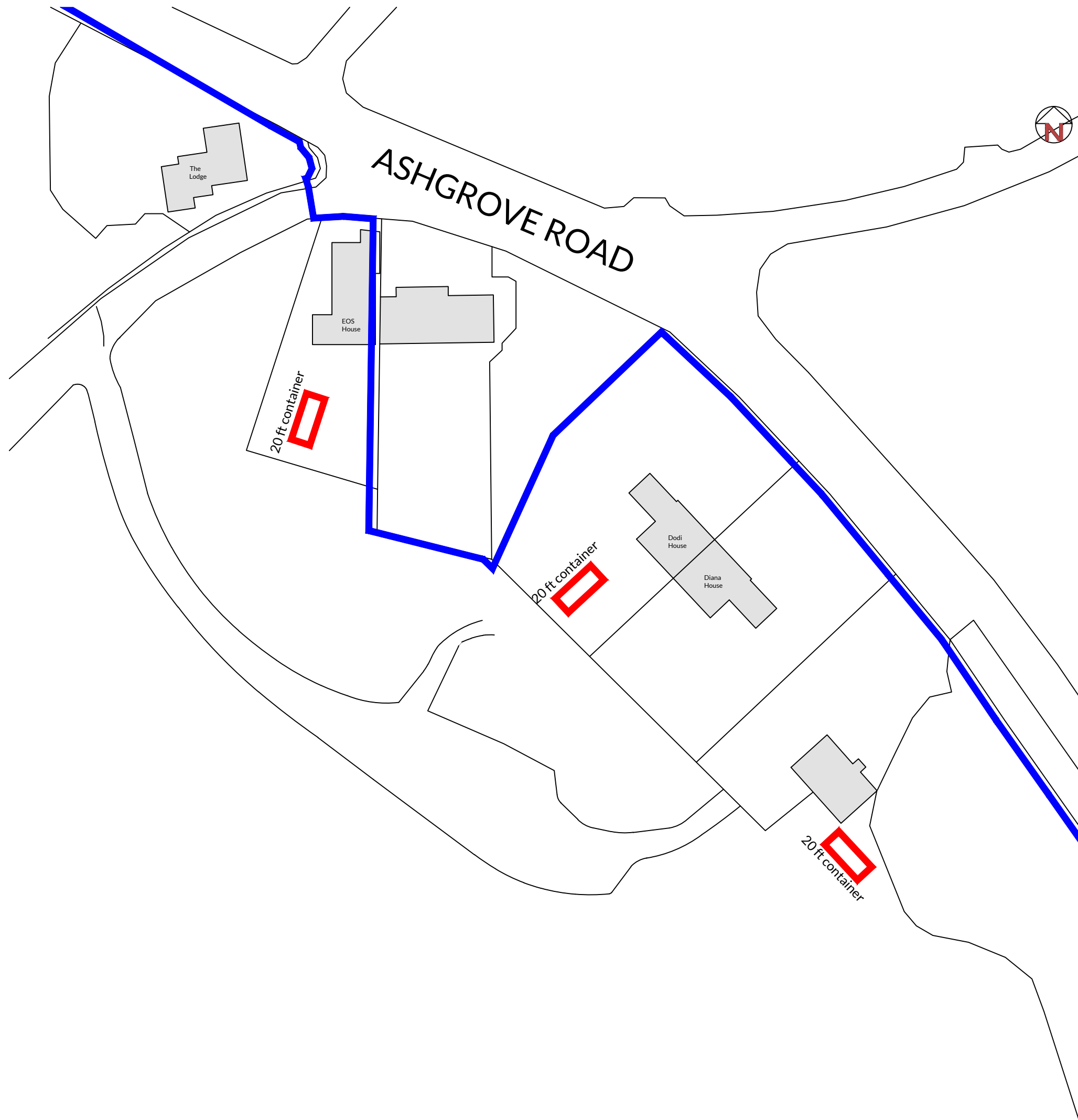

79 High Street
Tunbridge Wells
Kent
TN1 1XZ
01892 534455
dmp@dmp-llp.co.uk
www.dmp-llp.co.uk

Client.

West Heath School

Address.

Ashgrove Road
Sevenoaks
TN13 1SR

Project.

Existing Temporary Containers

Title.

Site Block Plan

Purpose of Issue.

PLANNING

Scale.	D	C	Date.
1:500	JOW	JRW	20.12.21

Job No.	Drawing No.	Revision.
57349	PL 02	