

NOTES.

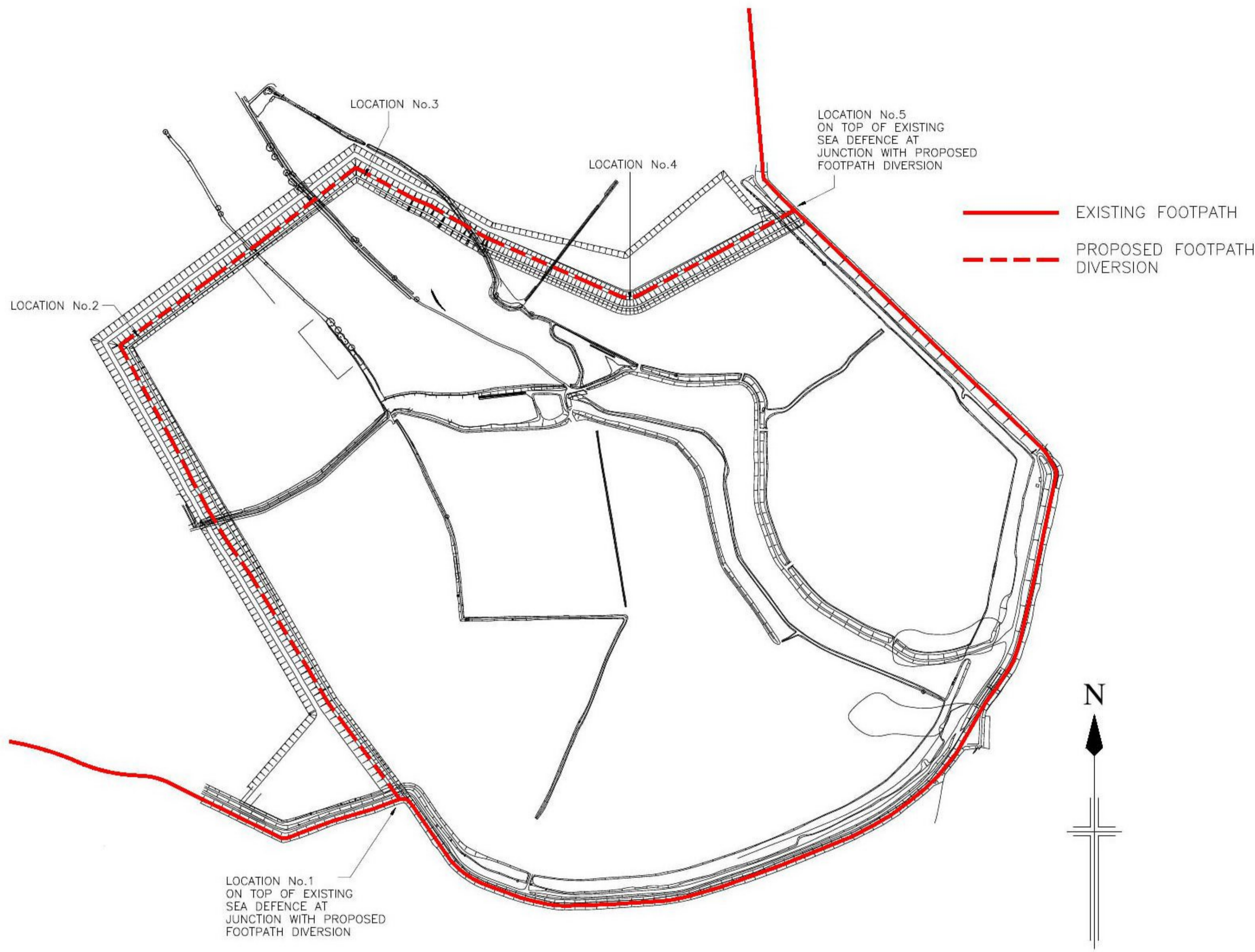

LOCATION OF PROPOSED VIEWING PLATFORMS  
SCALE 1:5000

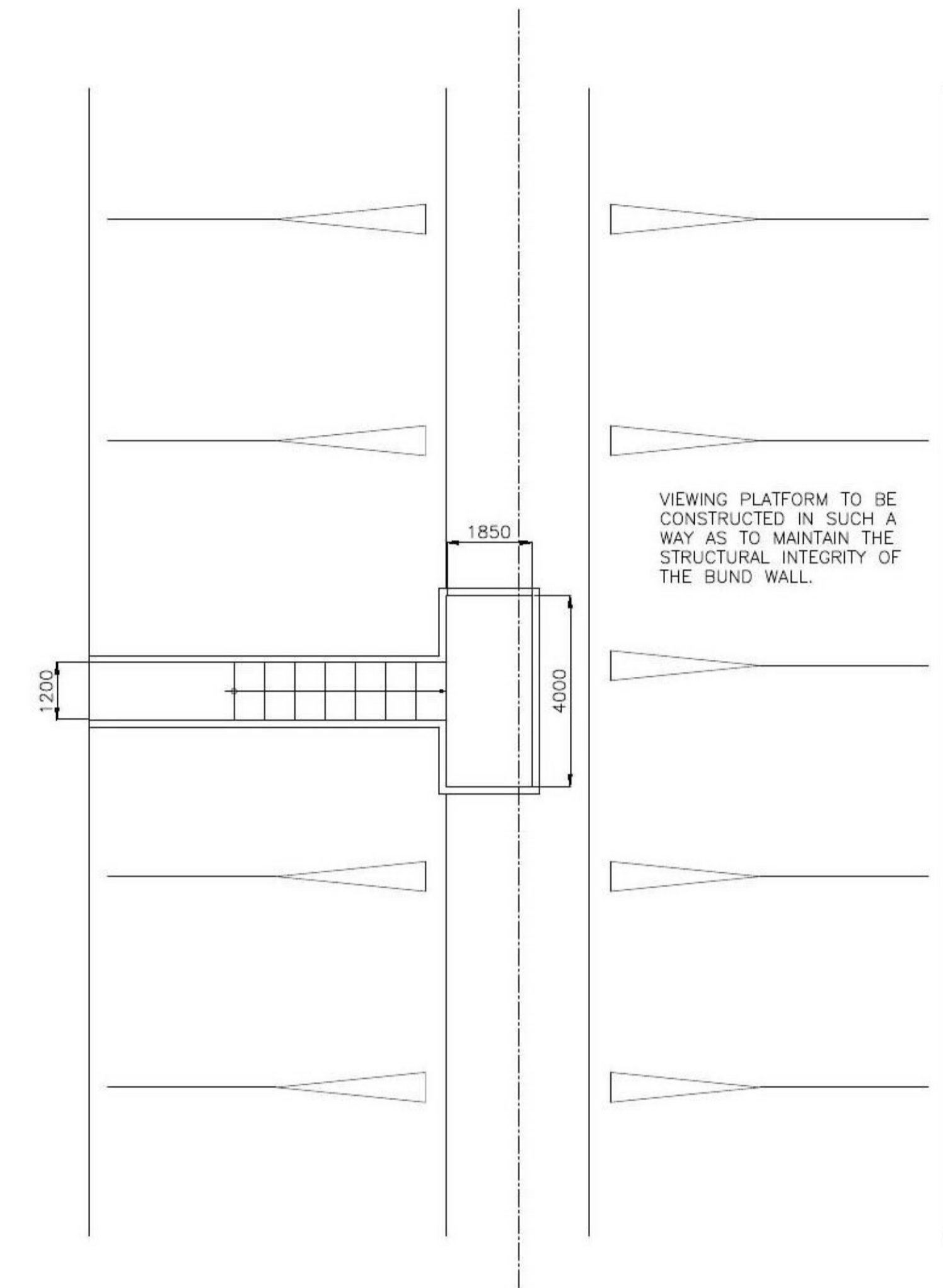

PLAN ON TYPICAL VIEWING PLATFORM  
SCALE 1:100

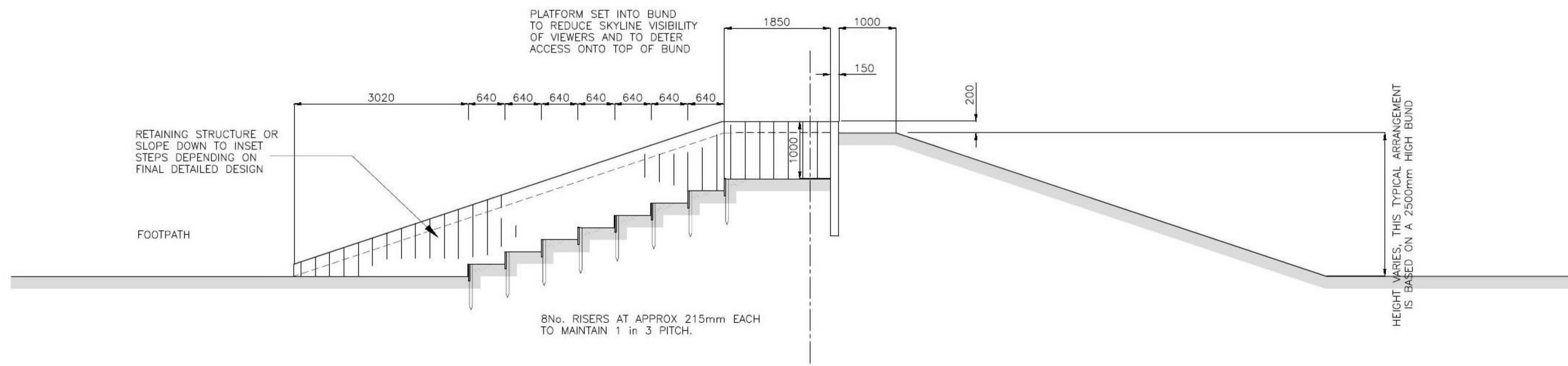

TYPICAL SECTION THROUGH VIEWING PLATFORM  
SCALE 1:50

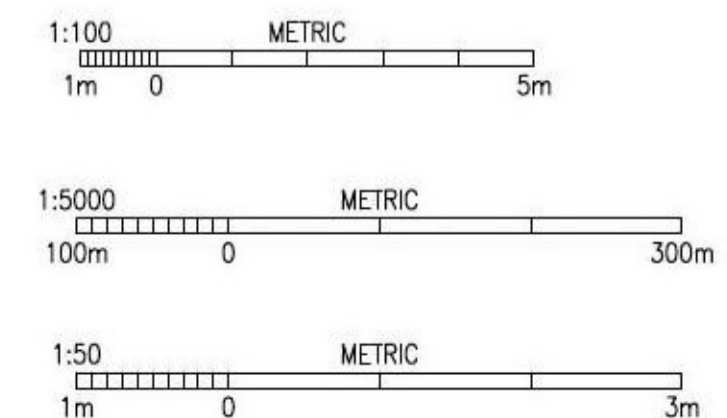

REV	DESCRIPTION
REVISIONS	

**HUTCHISON PORTS**  
**HARWICH INTERNATIONAL**

PARKESTON  
HARWICH  
ESSEX  
CO12 4SR

**CH** A member of CK Hutchison Holdings

PROJECT

MANAGED REALIGNMENT AT  
LITTLE OAKLEY,  
HAMFORD WATER.

TITLE

VIEWING PLATFORMS, LOCATIONS  
AND GENERAL ARRANGEMENT

SCALE	AS SHOWN	CHECKED
DATE	19.05.04	APPROVED
DRN	REA	ASSET No.
STATUS	PROPOSED	SHT REV
DRAWING No.	H1001/49	