

1.01 New Entrance Reinstate Philip Webb entrance to provide better access into the centre of the house.

1.02 Courtyard Wall Remove existing section of 1980s inwards curving brick wall and replace with outward curving wall. Bricks + mortar to match

1.03 Common Room Kitchen Discreet services to internal kitchen freestanding island.

1.04A Courtyard Sitting Room Partially remove existing 1980s brick-wall and install fixed glazed window with side pass door to allow better natural light and visual reading of Webb's internal elevation.

1.04B Courtyard Sitting Room Existing timber entrance door to be replaced with a glazed door.

1.04C Courtyard Sitting Room New Wood Burning Stove to be installed and new flue to extend externally through roof.

1.05 Studio. Reinstate existing Webb opening and install glazed door panel.

1.06 Omitted.

1.07A Back of House Add new opening to allow access to room GF.15.

1.07B Back of House Reconfigure Plant Room to allow for new staff WC and Guest Pantry

1.08 Service Kitchen Remove current contemporary floor finishes and to reveal original floor finishes or install lime screeded floor.

1.09A Lobby Area New opening made to ease circulation from main house to proposed Garden Room. New sliding door to replicate details of Webb's original adj. sliding door.

1.09B Lobby Area Cabinet to be relocated within adj. House Manager's Office.

1.10A Service Wing Bulkhead (in Lobby Area) Current services bulkhead to be reduced and to preserve original ceiling profile of Webb's Lobby.

1.10B Services Wing New timber-framed glazed panelled doors to enclose staff room.

1.10C Service Wing Existing Doorway to be blocked up

1.10D Service Wing New Doorway to pantry to ease circulation

1.11A Bread Oven Room Existing York Stone flags and floor level to be retained.

A.11B Opening of ash pit openings requiring the removal of brickwork to lower opening and boarding to top opening.

1.11B Bread Oven Room Original Bread Oven to be refurbished and made good. Existing brick chimney to be extended through new roof to form new flue to bread oven.

1.12 Proposed Garden Room Existing bread oven and adjacent flag stone flooring is retained. Large format glazing with sliding doors to the proposed garden room. The proposed glazing line reflects the geometry of the bread oven curved. The curved corner is set back from the main house which remains visually dominant.

1.13 New Steps New limestone steps to be the same material and detail as existing steps on the south east facade.

1.14 Common Room Kitchen Proposed Door Proposed door to allow easy access to external terrace. The original timber sash window will remain and new low-level timber door to be installed.

1.15 Garden Room Courtyard Wall Existing 1980's bricks to be removed and replaced with better matching bricks and mortar to the original service wing. Height of existing wall to be raised to conceal the proposed extension.

1.16 Window alterations to South East Facade Existing Office (GF.23) window to be removed and blanked off with traditional 'blind' window detail. The existing 'blind' window detail to the Office on the South East to be opened and window installed with detailing to match other adjacent windows on the South East Facade.

1.17 Kitchen Extract Pop up extract in kitchen island to run within floor void and connect to existing louvre at low level.

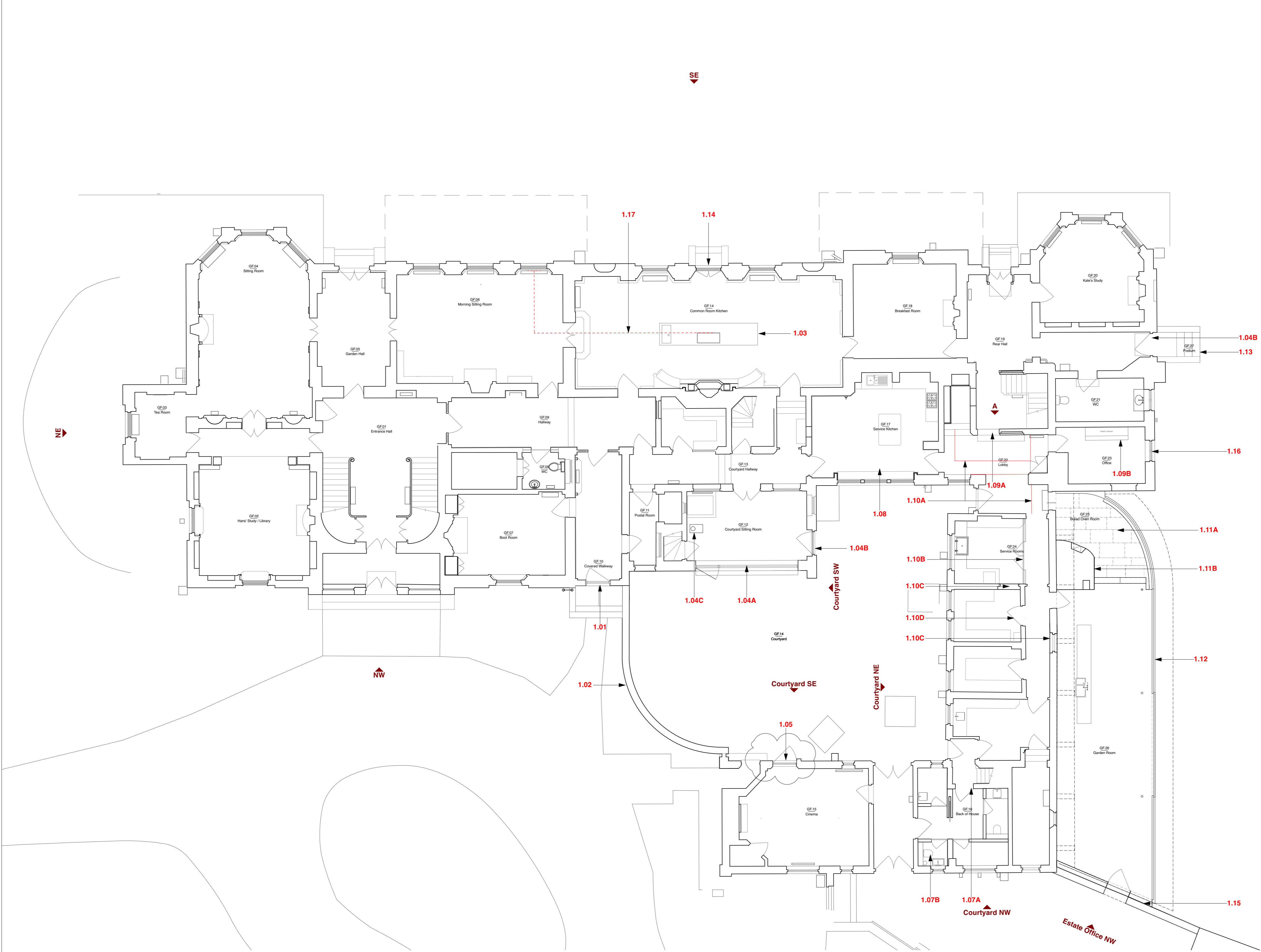

Copyright © BWT DEVELOPMENTS Ltd.

General Notes:

1. This Drawing shall be read in conjunction with all related BWT DEVELOPMENTS Ltd., Architect, Consultant and Subcontractor Drawings issued on the Project and any other relevant information.
2. This drawing is for the purpose of design intent and extent only and is not to be used for construction.
3. All dimensions are in millimetres unless otherwise indicated.
4. Do not scale from this drawing, unless for planning purposes only.
5. All dimensions to be verified on site prior to the commencement of any work or the production of shop drawings. Any discrepancies to be reported to the Designer (BWT DEVELOPMENTS Ltd.).
6. Refer to Sheet 0151-A-000-01 for Definitions + General Requirements

Notes:

Rev	Date	Description
P1	17/12/21	PLANNING

Rev	Date	Description
P1	17/12/21	PLANNING

bwt
14-15 Vernon Street, London, W14 0RJ
t 020 7183 6366
e studio@bwtondon.com
w www.bwtondon.com

PROJECT: WARRENS
BRAMSHAW, HAMPSHIRE. SO43 7JH

JOB: 0151
TITLE: PROPOSED GROUND
STATUS: PLANNING
DATE: 17/12/21 SCALE: 1:100 (A1)
DRAWN: ZT INSPECTED: BC
REV: P1 NUMBER: 0151-P-100-02

1 GROUND FLOOR - GENERAL ARRANGEMENT
Scale: 1:100

