

This copy has been made by or with the authority of Midlothian Council pursuant to Section 47 of the Designs and Patents Act 1988. Unless that Act provides a relevant exception to copyright, the copy must not be copied without the prior permission of the copyright owner.

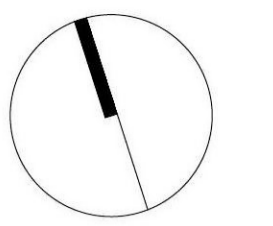

Application Boundary

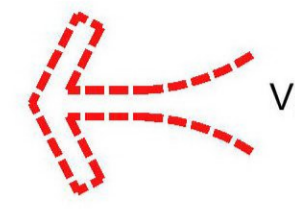

Vehicle Access



Pedestrian Access

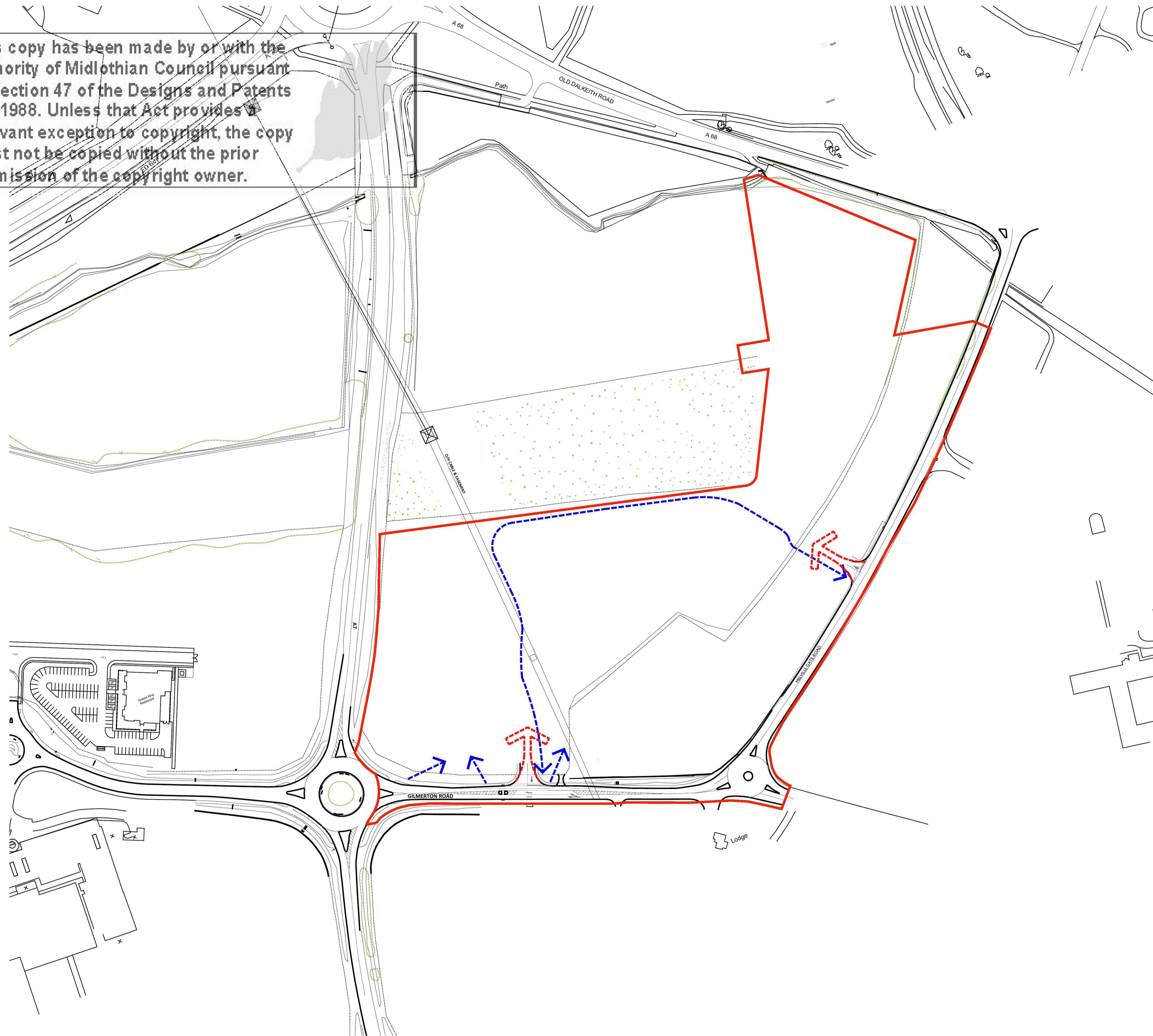

0 10 20 40 60 80 100m
1:1250 scale



HALLIDAY FRASER MUNRO
CHARTERED ARCHITECTS & PLANNING CONSULTANTS

Project:
Proposed Mixed Use Development
Sheriffhall South East

Client:
Buccleuch Property

Title:
Parameter Plan 05
Access Plan

Document Reference						
Project Code	Original Code	Volume	Location / Level	Type	Revision	Drawing Number
11658	HFM	- ZZ -	ZZ	- DR -	A -	P(00) 006

Drawing Status:	Revision
Planning	
Scale: 1:1250 @ A1	Date: Oct 2021

Do not scale this drawing.
Ordnance Survey material is reproduced with the permission of the controller of her Majesty's Stationery Office Crown Copyright reserved.
The copyright of this drawing subsists in Halliday Fraser Munro Ltd.

Registered Office:
8 Victoria Street,
Aberdeen, AB10 1XB

T: 01224 388 700
E: info@hfm.co.uk
W: hfm.co.uk