

This copy has been made by or with the authority of Midlothian Council pursuant to Section 47 of the Designs and Patents Act 1988. Unless that Act provides a relevant exception to copyright, the copy must not be copied without the prior permission of the copyright owner.

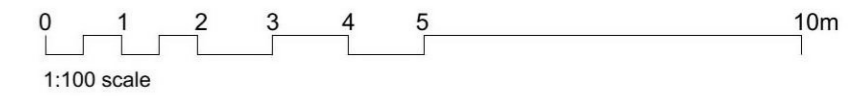
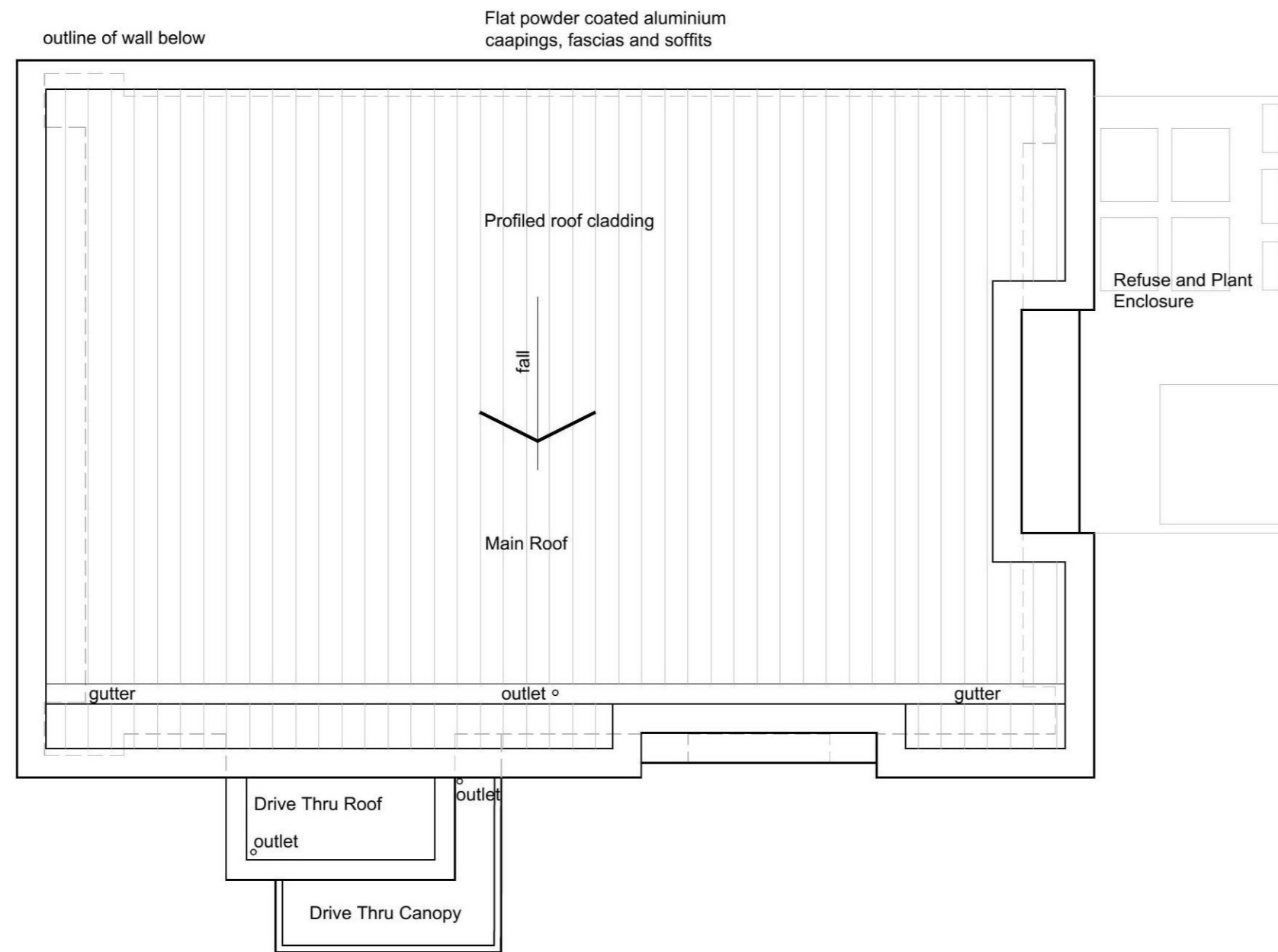

HALLIDAY FRASER MUNRO  
CHARTERED ARCHITECTS & PLANNING CONSULTANTS

Project:  
Proposed Mixed Use Development  
Sheriffhall South East

Client:  
Buccleuch Property

Title:  
Drive Thru Unit  
Roof Plan

Document Reference

Identification / Location					Drawing Number		
Project Code	Originator Code	Volume	Location / Level	Type	Role	Classification	Number
11658	HFM	- ZZ	- ZZ	- DR	- A	- P(20)	703

Drawing Status: **Planning** Revision

Scale: **1:100 @ A2** Date: **Sept 2021**

Do not scale this drawing.

Ordnance Survey material is reproduced with the permission of the controller of her Majesty's Stationery Office Crown Copyright reserved.

The copyright of this drawing subsists in Halliday Fraser Munro Ltd.

Registered Office:  
8 Victoria Street,  
Aberdeen, AB10 1XB

T: 01224 388 700  
E: info@hfm.co.uk  
W: hfm.co.uk