

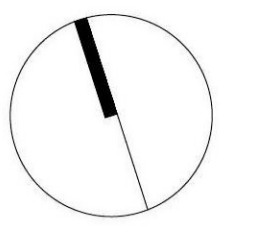



This copy has been made by or with the authority of Midlothian Council pursuant to Section 47 of the Designs and Patents Act 1988. Unless that Act provides a relevant exception to copyright, the copy must not be copied without the prior permission of the copyright owner.



-  Application Boundary
-  Established Woodland
-  Overhead Electricity Lines
-  Land Reserved for Transport Scotland

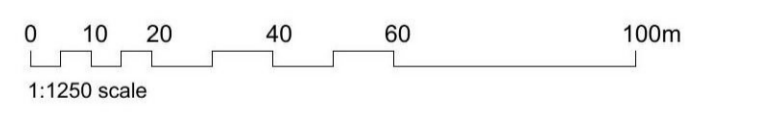
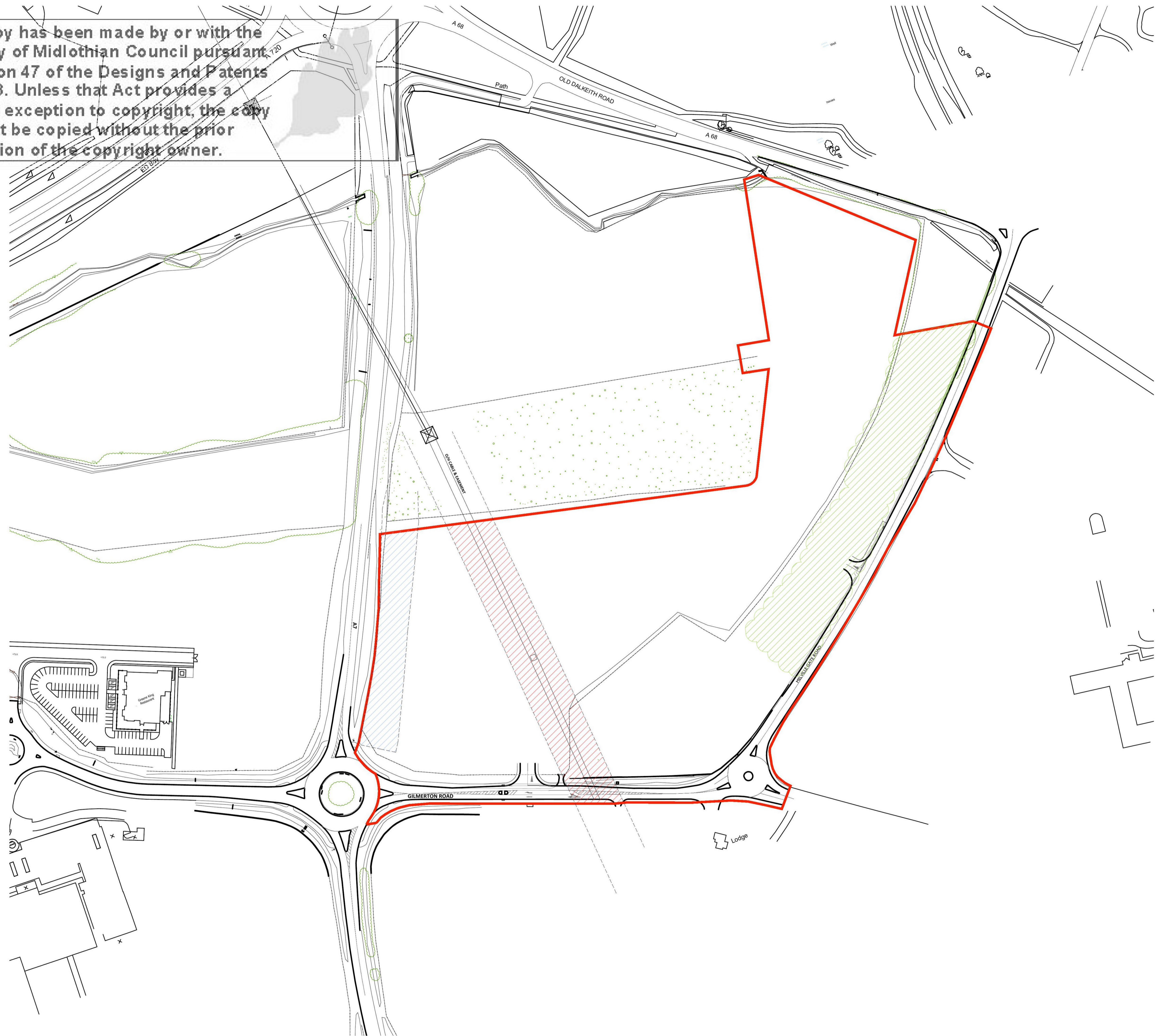

**HALLIDAY FRASER MUNRO**  
 CHARTERED ARCHITECTS & PLANNING CONSULTANTS

Project:  
 Proposed Mixed Use Development  
 Sheriffhall South East

Client:  
 Buccleuch Property

Title:  
 Parameter Plan 04  
 Constraints Plan

Document Reference

Project Code	Site Code	Volume	Location / Level	Type	Revision	Drawing Number	Number
11658	HFM	- ZZ	- ZZ	- DR	- A	- P(00)	005

Drawing Status: **Planning** Revision  
 Scale: 1:1250 @ A1 Date: Oct 2021

Do not scale this drawing.  
 Ordnance Survey material is reproduced with the permission of the controller of her Majesty's Stationery Office Crown Copyright reserved.  
 The copyright of this drawing subsists in Halliday Fraser Munro Ltd.

Registered Office: 8 Victoria Street, Aberdeen, AB10 1XB T: 01224 388 700  
 E: info@hfm.co.uk  
 W: hfm.co.uk