

Application Boundary
Area = 8.51 ha / 21 acres (or thereby)

This copy has been made by or with the authority of Midlothian Council pursuant to Section 47 of the Designs and Patents Act 1988. Unless that Act provides a relevant exception to copyright, the copy must not be copied without the prior permission of the copyright owner.

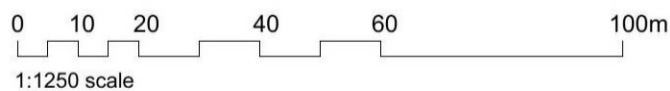

1:1250 scale

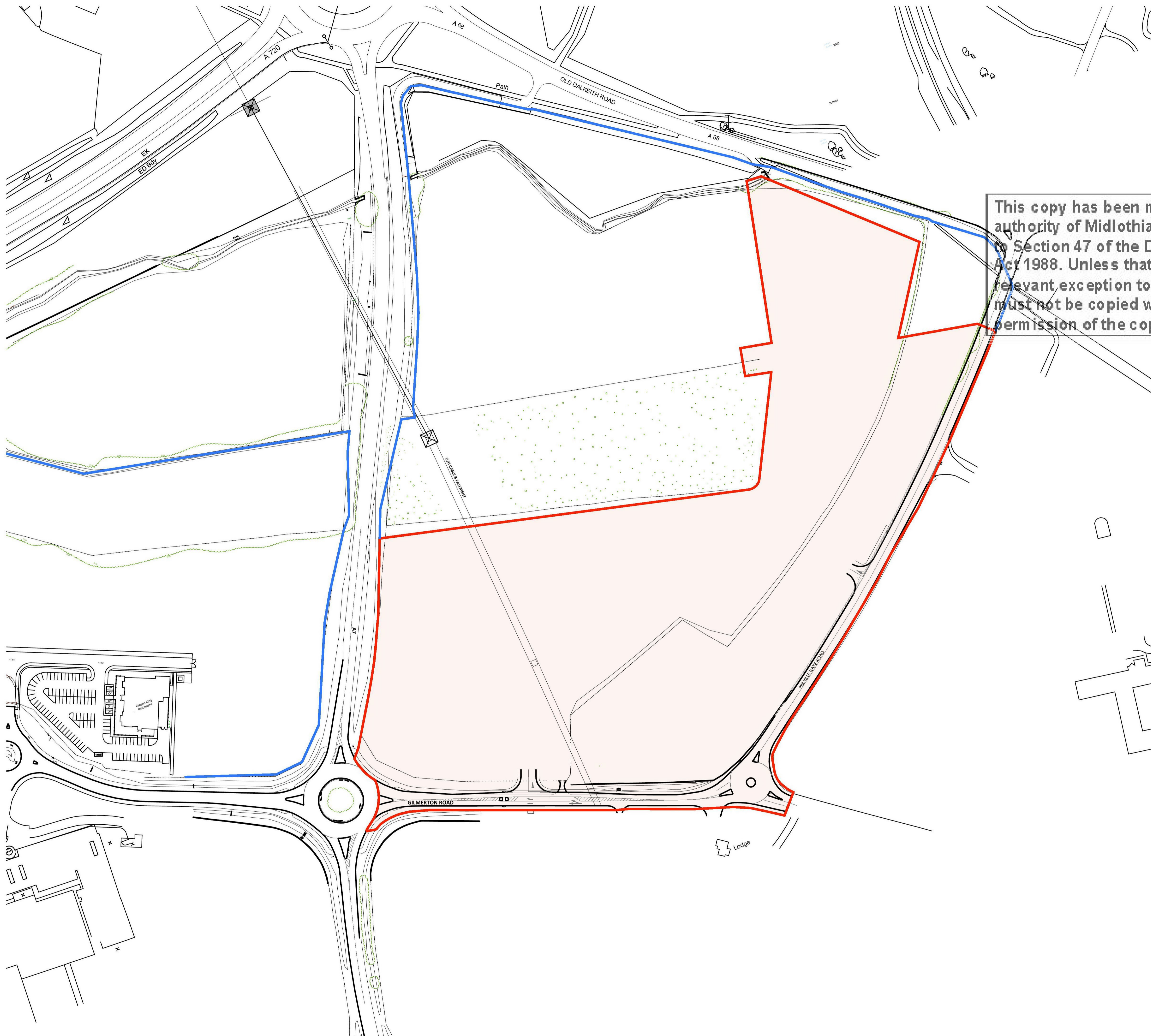
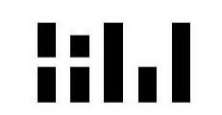

HALLIDAY FRASER MUNRO
CHARTERED ARCHITECTS & PLANNING CONSULTANTS

Project:
Proposed Mixed Use Development
Sheriffhall South East

Client:
Buccleuch Property

Title:
Location Plan

Document Reference

Project Code	Original Date	Volume	Location / Level	Type	Rev	Classification	Number
11658	-	HFM	- ZZ - ZZ	- DR - A -	P(00)		001

Drawing Status: **Planning** Revision
Scale: 1:1250 @ A1 Date: Oct 2021

Do not scale this drawing.
Ordnance Survey material is reproduced with the permission of the controller of her Majesty's Stationery Office Crown Copyright reserved.
The copyright of this drawing subsists in Halliday Fraser Munro Ltd.

Registered Office: 8 Victoria Street, Aberdeen, AB10 1XB
T: 01224 388 700
E: info@hfm.co.uk
W: hfm.co.uk