

**ARC ENVIRONMENTAL LTD**  
 Solum House  
 Unit 1 Elliott Court  
 St. John's Road  
 Meadowfield  
 Durham, DH7 8PN  
 Tel: (0191) 378 6380  
 Fax: (0191) 378 0494  
 e-mail: admin@arc-environmental.com  
 web: www.arc-environmental.com

The contractor shall check all dimensions on site before commencement of any works. No dimensions to be scaled off this drawing.  
 © Copyright Reserved

LEGEND	
	APPROXIMATE PHASE I BOUNDARY

rev.	date	amendments	drawn	chckd

Client: **BUCCLEUCH PROPERTY (SHERRIFFHALL SOUTH) LTD**

Project Title:  
 Proposed Development (Phase I)  
 Sherriffhall South East, Gilmerton Road  
 Lasswade, Midlothian

Drawing Title:  
 Existing Site Layout Plan

Scale at A3: 1:1000 @ A3	Date: 23.06.17	Drawn by: P.D	Approved by: M.R.B
-----------------------------	-------------------	------------------	-----------------------

Job Ref: 17-115	Drg no: -	Rev: -
--------------------	--------------	-----------



**ARC ENVIRONMENTAL LTD**  
 Solum House  
 Unit 1 Elliott Court  
 St. John's Road  
 Meadowfield  
 Durham, DH7 8PN  
 Tel: (0191) 378 6380  
 Fax: (0191) 378 0494  
 e-mail: admin@arc-environmental.com  
 web: www.arc-environmental.com

The contractor shall check all dimensions on site before commencement of any works. No dimensions to be scaled off this drawing.  
 © Copyright Reserved

LEGEND	
	APPROXIMATE PHASE I BOUNDARY

rev.	date	amendments	drawn	chckd

Client: **BUCCLEUCH PROPERTY (SHERRIFFHALL SOUTH) LTD**

Project Title:  
 Proposed Development (Phase 1)  
 Sherriffhall South East, Gilmerston Road  
 Lasswade, Midlothian

Drawing Title:  
 Phase I Proposed Development Layout Plan

Scale at A3: NTS @ A3	Date: 23.06.17	Drawn by: P.D	Approved by: M.R.B
--------------------------	-------------------	------------------	-----------------------

Job Ref: 17-115	Drg no: -	Rev: -
--------------------	--------------	-----------

## **APPENDIX II**

### **Borehole & Trial Pit Location Plan, Borehole & Trial Pit Record Sheets**



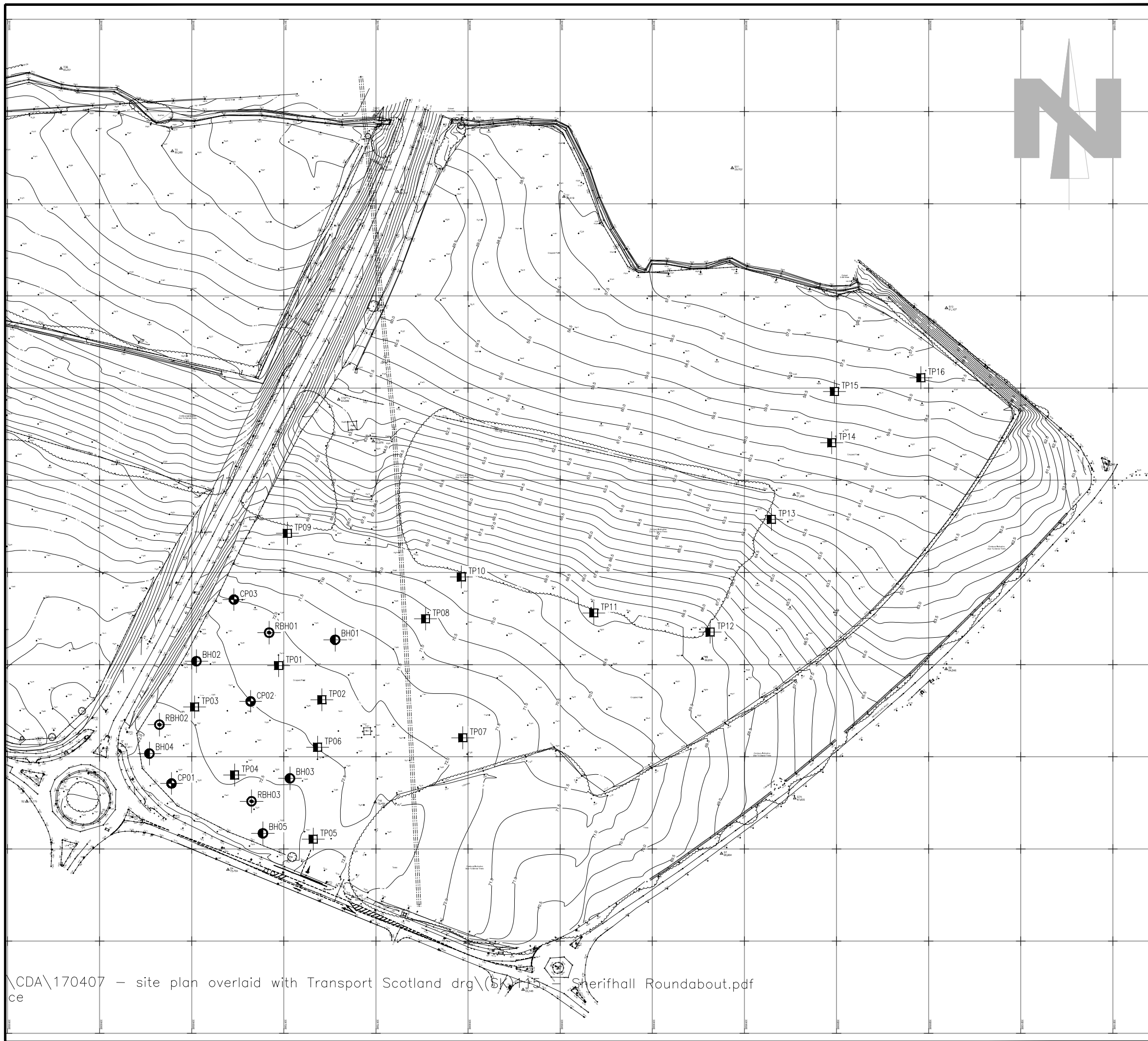

**ARC ENVIRONMENTAL LTD**

Solum House  
 Unit 1 Elliott Court  
 St. John's Road  
 Meadowfield  
 Durham, DH7 8PN  
 Tel: (0191) 378 6380  
 Fax: (0191) 378 0494  
 e-mail: admin@arc-environmental.com  
 web: www.arc-environmental.com

The contractor shall check all dimensions on site before commencement of any works. No dimensions to be scaled off this drawing.  
 © Copyright Reserved

LEGEND	
	WINDOWLESS SAMPLING BOREHOLE POSITION
	CABLE PERCUSSION BOREHOLE POSITION
	MECHANICALLY EXCAVATED TRIAL PIT POSITION
	ROTARY BOREHOLE LOCATION

rev.	date	amendments	drawn	chckd

Client:  
**QUATTRO CONSULT / AXIOM**

Project Title:  
 Sherrifhall South East

Drawing Title:  
 Borehole and Trial Pit Location Plan

Scale at A3: 1:2000 @ A3	Date: 28.04.17	Drawn by: P.D	Approved by: M.R
-----------------------------	-------------------	------------------	---------------------

Job Ref: 17-115	Drg no: -	Rev: -
--------------------	--------------	-----------

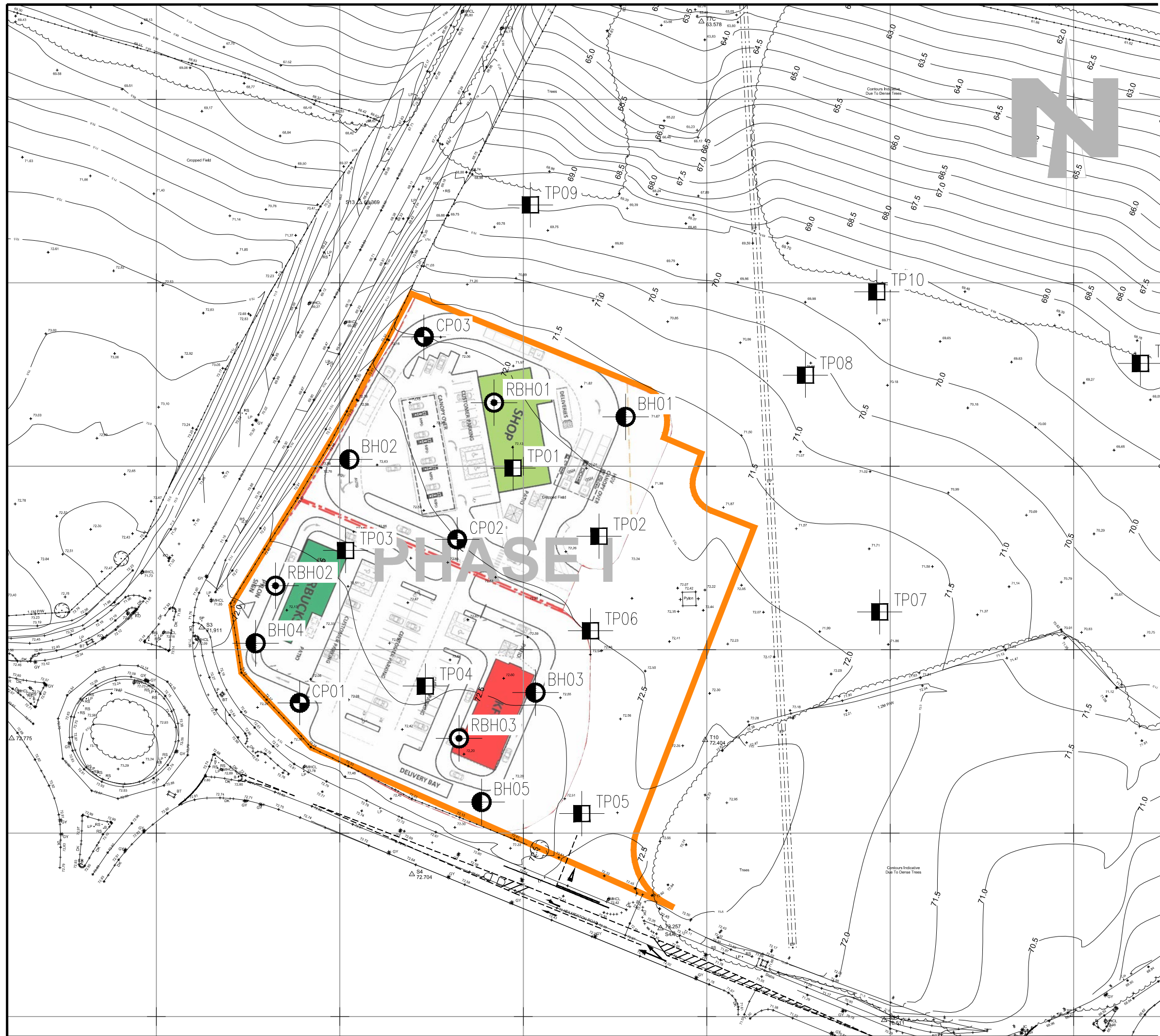

**ARC ENVIRONMENTAL LTD**  
 Solum House  
 Unit 1 Elliott Court  
 St. John's Road  
 Meadowfield  
 Durham, DH7 8PN  
 Tel: (0191) 378 6380  
 Fax: (0191) 378 0494  
 e-mail: admin@arc-environmental.com  
 web: www.arc-environmental.com

The contractor shall check all dimensions on site before commencement of any works. No dimensions to be scaled off this drawing.  
 © Copyright Reserved

LEGEND	
	WINDOWLESS SAMPLING BOREHOLE POSITION
	CABLE PERCUSSION BOREHOLE POSITION
	MECHANICALLY EXCAVATED TRIAL PIT POSITION
	ROTARY BOREHOLE LOCATION

rev.	date	amendments	drawn	chckd

Client:  
**QUATTRO CONSULT / AXIOM**

Project Title:  
 Proposed Development (Phase I)  
 Sherriffhall South East, Gilmerton Road  
 Lasswade, Midlothian

Drawing Title:  
 Borehole and Trial Pit Location Plan (Proposed)

Scale at A3: 1:1000 @ A3	Date: 23.06.17	Drawn by: P.D	Approved by: M.R.B
-----------------------------	-------------------	------------------	-----------------------

Job Ref: 17-115	Drg no: -	Rev: -
--------------------	--------------	-----------





Solum House, Unit 1 Elliott Court  
 St Johns Road, Meadowfield  
 Durham, DH7 8PN  
 Telephone: 01913786380

## BOREHOLE LOG

Project <b>Sheriffhall South East, Gilmerton Road, Lasswade, EH18 1BD</b>				<b>BOREHOLE No BH01</b>
Job No 17-115	Date 12-05-17	Ground Level (m)	Co-Ordinates ( )	
Contractor <b>Arc Environmental Limited</b>				Sheet 1 of 1

SAMPLES & TESTS			STRATA				Geology	Instrument/ Backfill
Depth	Type No	Test Result	Water	Reduced Level	Legend (Thick-ness)	DESCRIPTION		
0.00-0.32	B					Crops overlying dark brown clayey silty fine to medium SAND (TOPSOIL).		
0.32-0.45	B					Medium dense orange brown silty gravelly fine to medium SAND (GLACIOFLUVIAL DEPOSITS).		
0.45-1.00	B							
1.00-1.45	SPT	N=18				1.20 Becoming slightly gravelly.		
1.20-1.80	B							
1.80-2.00	B							
2.00-2.45	SPT	N=10						
3.00	B							
3.00-3.45	SPT	N=10						
3.50	B					3.55 Becoming loose and slightly saturated with occasional silt lenses and coal fragments.		
4.00	B							
4.00-4.00	SPT	N=5						
5.00	B							
5.00-5.45	SPT	N=5						
						Borehole completed to a depth of 5.45m.		

Boring Progress and Water Observations						Chiselling			Water Added		GENERAL REMARKS
Date	Time	Depth	Casing Depth	Casing Dia. mm	Water Dpt	From	To	Hours	From	To	
12-05-17	10.30	5.45	5.00	92	N/A						WATER OBSERVATIONS: Seepage noted at a depth of 3.55m.

All dimensions in metres Scale 1:37.5	Client <b>Axiom Project Services Limited</b>	Method/ Plant Used <b>Windowless Sampling Rig</b>	Logged By <b>SW</b>
--	---	---	------------------------

AGS3 UK BH TP LOGS.GPJ AGS3 ALL GDT 27/6/17



Solum House, Unit 1 Elliott Court  
 St Johns Road, Meadowfield  
 Durham, DH7 8PN  
 Telephone: 01913786380

## BOREHOLE LOG

Project <b>Sheriffhall South East, Gilmerton Road, Lasswade, EH18 1BD</b>				<b>BOREHOLE No BH02</b>
Job No 17-115	Date 12-05-17	Ground Level (m)	Co-Ordinates ( )	
Contractor <b>Arc Environmental Limited</b>				Sheet 1 of 1

SAMPLES & TESTS			Water	STRATA				Geology	Instrument/ Backfill
Depth	Type No	Test Result		Reduced Level	Legend	Depth (Thick-ness)	DESCRIPTION		
0.00-0.50	B				(0.50)	Crops overlying dark brown clayey silty fine to medium SAND (TOPSOIL).			
0.50-0.63	B				0.50	Loose and medium dense orange brown very gravelly fine to medium SAND (GLACIOFLUVIAL DEPOSITS).			
0.68-1.00	B								
1.00-1.60	B	N=10				1.60 Becoming slightly gravelly.			
1.00-1.45	SPT								
1.60-2.00	B								
2.00-2.45	SPT	N=9			(4.50)				
3.00	B	N=12				3.00 - 3.30 Light brown sandy silt			
3.00-3.45	SPT								
3.60-3.88	B								
3.88-4.00	B	N=12				3.88 Becoming slightly saturated with occasional silt lenses and coal fragments.			
4.00-4.45	SPT								
5.00	B	N=6			5.00				
5.00-5.45	SPT						Borehole completed to a depth of 5.45m.		

Boring Progress and Water Observations						Chiselling			Water Added		GENERAL REMARKS
Date	Time	Depth	Casing Depth	Casing Dia. mm	Water Dpt	From	To	Hours	From	To	
12-05-17	11.30	5.45	5.00	92	N/A						WATER OBSERVATIONS: Seepage noted at a depth of 3.90m.

All dimensions in metres Scale 1:37.5	Client <b>Axiom Project Services Limited</b>	Method/ Plant Used <b>Windowless Sampling Rig</b>	Logged By <b>SW</b>
--	---	---	------------------------

AGS3 UK BH TP LOGS.GPJ AGS3 ALL GDT 27/6/17



Solum House, Unit 1 Elliott Court  
 St Johns Road, Meadowfield  
 Durham, DH7 8PN  
 Telephone: 01913786380

## BOREHOLE LOG

Project <b>Sheriffhall South East, Gilmerton Road, Lasswade, EH18 1BD</b>				<b>BOREHOLE No BH03</b>
Job No 17-115	Date 12-05-17	Ground Level (m)	Co-Ordinates ( )	
Contractor <b>Arc Environmental Limited</b>				Sheet 1 of 1

SAMPLES & TESTS			STRATA				Geology	Instrument/ Backfill
Depth	Type No	Test Result	Water	Reduced Level	Legend (Thick-ness)	DESCRIPTION		
0.00-0.30	B					Crops overlying dark brown clayey silty fine to medium SAND (TOPSOIL).		
0.30	B					Medium dense orange brown gravelly fine to medium SAND (GLACIOFLUVIAL DEPOSITS).		
1.00 1.00-1.45	B SPT	N=15				1.60 Becoming loose slightly gravelly.		
1.60-2.00	B							
2.00-2.45	SPT	N=9						
2.50-2.60	B					2.50 - 2.60 Light brown sandy silt.		
2.80-3.00	B							
3.00 3.00-3.45	B SPT	N=9				3.00 Becoming slightly saturated with occasional silt lenses and coal fragments.		
4.00 4.00-4.45	B SPT	N=5						
5.00 5.00-5.45	B SPT	N=5						
					5.45	Borehole completed to a depth of 5.45m.		

Boring Progress and Water Observations						Chiselling			Water Added		GENERAL REMARKS
Date	Time	Depth	Casing Depth	Casing Dia. mm	Water Dpt	From	To	Hours	From	To	
12-05-17	13.00	5.45	5.00	92	N/A						WATER OBSERVATIONS: Seepage noted at a depth of 3.20m.

All dimensions in metres Scale 1:37.5	Client <b>Axiom Project Services Limited</b>	Method/ Plant Used <b>Windowless Sampling Rig</b>	Logged By <b>SW</b>
--	---	---	------------------------

AGS3 UK BH TP LOGS.GPJ AGS3 ALL GDT 27/6/17





Solum House, Unit 1 Elliott Court  
 St Johns Road, Meadowfield  
 Durham, DH7 8PN  
 Telephone: 01913786380

## BOREHOLE LOG

Project <b>Sheriffhall South East, Gilmerton Road, Lasswade, EH18 1BD</b>				<b>BOREHOLE No BH04</b>
Job No 17-115	Date 12-05-17	Ground Level (m)	Co-Ordinates ( )	
Contractor <b>Arc Environmental Limited</b>				Sheet 1 of 1

SAMPLES & TESTS			STRATA				Geology	Instrument/ Backfill
Depth	Type No	Test Result	Water	Reduced Level	Legend (Thick-ness)	DESCRIPTION		
0.00-0.58	B					Crops overlying dark brown clayey silty fine to medium SAND (TOPSOIL). (0.58)		
0.58-0.80	B					Medium dense orange brown gravelly fine to medium SAND (GLACIOFLUVIAL DEPOSITS). 0.80 Becoming slightly gravelly.		
0.80-1.00	B							
1.00-1.45	SPT	N=20						
1.50	B							
2.00	B							
2.00-2.45	SPT	N=14						
2.40-2.60	B					2.40 - 2.60 Light brown sandy silt.		
2.60-3.00	B							
3.00	B							
3.00-3.45	SPT	N=11				2.80 Becoming slightly saturated with occasional silt lenses and coal fragments.  3.60 Becoming loose		
4.00	B							
4.00-4.45	SPT	N=4						
5.00	B							
5.00-5.45	SPT	N=3						
							Borehole completed to a depth of 5.45m.	

Boring Progress and Water Observations						Chiselling			Water Added		GENERAL REMARKS
Date	Time	Depth	Casing Depth	Casing Dia. mm	Water Dpt	From	To	Hours	From	To	
12-05-17	14.30	5.45	5.00	92	N/A						WATER OBSERVATIONS: Seepage noted at a depth of 2.80m.

All dimensions in metres Scale 1:37.5	Client <b>Axiom Project Services Limited</b>	Method/ Plant Used <b>Windowless Sampling Rig</b>	Logged By <b>SW</b>
--	---	---	------------------------

AGS3 UK BH TP LOGS.GPJ AGS3 ALL GDT 27/6/17



Solum House, Unit 1 Elliott Court  
 St Johns Road, Meadowfield  
 Durham, DH7 8PN  
 Telephone: 01913786380

## BOREHOLE LOG

Project <b>Sheriffhall South East, Gilmerton Road, Lasswade, EH18 1BD</b>				<b>BOREHOLE No BH05</b>
Job No 17-115	Date 12-05-17	Ground Level (m)	Co-Ordinates ( )	
Contractor <b>Arc Environmental Limited</b>				Sheet 1 of 1

SAMPLES & TESTS			Water	STRATA			Geology	Instrument/ Backfill	
Depth	Type No	Test Result		Reduced Level	Legend	Depth (Thickness)			DESCRIPTION
0.00-0.42	B				(0.45)	Crops overlying dark brown clayey silty fine to medium SAND (TOPSOIL).			
0.42-0.78	B				0.45	Loose and medium dense orange brown very gravelly fine to medium SAND (GLACIOFLUVIAL DEPOSITS).			
0.78-1.00	B								
1.35-1.70	B	N=22				1.35 Becoming slightly gravelly.			
1.45-1.45	SPT								
1.70-2.00	B								
2.45-2.45	SPT	N=11				2.80 Becoming slightly saturated with occasional silt lenses and coal fragments.			
2.50-2.80	B								
2.80-3.00	B				(5.00)				
3.45-3.45	SPT	N=6							
3.50	B								
4.00	B								
4.45-4.45	SPT	N=13							
5.00	B								
5.45-5.45	SPT	N=7			5.45	Borehole completed to a depth of 5.45m.			

Boring Progress and Water Observations						Chiselling			Water Added		GENERAL REMARKS
Date	Time	Depth	Casing Depth	Casing Dia. mm	Water Dpt	From	To	Hours	From	To	
12-05-17	16.00	5.45	5.00	92	N/A						WATER OBSERVATIONS: Seepage noted at a depth of 2.80m.

All dimensions in metres Scale 1:37.5	Client <b>Axiom Project Services Limited</b>	Method/ Plant Used <b>Windowless Sampling Rig</b>	Logged By <b>SW</b>
--	---	---	------------------------

AGS3 UK BH TP LOGS.GPJ AGS3 ALL GDT 27/6/17



Solum House, Unit 1 Elliott Court  
 St Johns Road, Meadowfield  
 Durham, DH7 8PN  
 Telephone: 01913786380

## BOREHOLE LOG

Project <b>Sheriffhall South East, Gilmerton Road, Lasswade, EH18 1BD</b>				<b>BOREHOLE No CP01</b>
Job No 17-115	Date 08-05-17	Ground Level (m)	Co-Ordinates ( )	
Contractor <b>Arc Environmental Limited</b>				Sheet 1 of 1

SAMPLES & TESTS			STRATA				Geology	Instrument/ Backfill
Depth	Type No	Test Result	Water	Reduced Level	Legend (Thick-ness)	DESCRIPTION		
0.00-0.40	B				0.40	Crops overlying dark brown clayey silty fine to medium SAND (TOPSOIL).		
1.00-2.00	B			(1.60)		Medium dense very sandy gravel (GLACIOFLUVIAL DEPOSITS).		
1.20-1.65	SPT	N=21			2.00			
2.00-3.00	B					Medium dense becoming dense orange brown silty SAND. Some occasional sandy clay pockets present (GLACIOFLUVIAL DEPOSITS).		
2.00-2.45	SPT	N=18						
3.00-4.00	B							
3.00-3.45	SPT	N=15						
4.00-5.00	B							
4.00-4.45	SPT	N=18						
5.00-6.00	B							
5.00-5.45	SPT	N=19						
6.50-7.00	B							
6.50-6.95	SPT	N=22						
8.00-9.00	B							
8.00-8.45	SPT	N=25			(13.00)			
9.50-10.00	B							
9.50-9.95	SPT	N=19						
11.00-12.00	B							
11.00-11.45	SPT	N=25						
12.50-13.00	B							
12.50-12.95	SPT	N=31			13.00 Frequent silty lenses			
14.00-15.00	B							
14.00-14.45	SPT	N=30		15.00				
Borehole completed at a depth of 15.00m								

Boring Progress and Water Observations						Chiselling			Water Added		GENERAL REMARKS
Date	Time	Depth	Casing Depth	Casing Dia. mm	Water Dpt	From	To	Hours	From	To	
08-05-17	12.30	6.00	4.50	150	6.00						WATER OBSERVATIONS: Water ingress noted at a depth of 6.00m, rising to a depth of 4.50m after 20mins..
08-05-17	12.50	6.00	4.50	150	4.50						
08-05-17	16.30	15.00	15.00	150	4.50						

All dimensions in metres Scale 1:100	Client <b>Axiom Project Services Limited</b>	Method/ Plant Used Cable Percussion Borhole	Logged By <b>RT</b>
---	---	---	------------------------

AGS3 UK BH TP LOGS.GPJ AGS3 ALL GDT 27/6/17





Solum House, Unit 1 Elliott Court  
 St Johns Road, Meadowfield  
 Durham, DH7 8PN  
 Telephone: 01913786380

## BOREHOLE LOG

Project <b>Sheriffhall South East, Gilmerton Road, Lasswade, EH18 1BD</b>				<b>BOREHOLE No</b>  <b>CP02</b>
Job No <b>17-115</b>	Date <b>09-05-17</b>	Ground Level (m)	Co-Ordinates ( )	
Contractor <b>Arc Environmental Limited</b>				Sheet <b>1 of 1</b>

SAMPLES & TESTS			STRATA				Geology	Instrument/ Backfill
Depth	Type No	Test Result	Water	Reduced Level	Legend (Thick-ness)	DESCRIPTION		
0.00-1.00	B				0.20	Crops overlying dark brown clayey silty fine to medium SAND (TOPSOIL).		
1.00-2.00	B				(1.30)	Loose brown slightly gravelly fine to medium SAND (GLACIOFLUVIAL DEPOSITS).		
1.20-1.65	SPT	N=9			1.50			
2.00-3.00	B					Medium dense becoming dense orange brown silty fine SAND. Some occasional sandy clay pockets present (GLACIOFLUVIAL DEPOSITS).		
2.00-2.45	SPT	N=14						
3.00-4.00	B		↓					
3.00-3.45	SPT	N=15						
4.00-5.00	B							
4.00-4.45	SPT	N=14						
5.00-6.00	B		↓					
5.00-5.45	SPT	N=20						
6.50-7.00	B							
6.50-6.95	SPT	N=17						
8.00-9.00	B				(13.50)			
8.00-8.45	SPT	N=22						
9.50-10.00	B							
9.50-9.95	SPT	N=25						
11.00-12.00	B							
11.00-11.45	SPT	N=25						
12.50-13.00	B							
12.50-12.95	SPT	N=27						
14.00-15.00	B							
14.00-14.45	SPT	N=30			15.00			
Borehole completed at a depth of 15.00m								

Boring Progress and Water Observations						Chiselling			Water Added		GENERAL REMARKS
Date	Time	Depth	Casing Depth	Casing Dia. mm	Water Dpt	From	To	Hours	From	To	
09-05-17	12.00	5.50	4.50	150	5.50						WATER OBSERVATIONS: Water ingress noted at a depth of 5.50m, rising to a depth of 3.50m after 20mins.
09-05-17	12.20	5.50	4.50	150	3.50						
09-05-17	16.00	15.00	15.00	150	3.50						

All dimensions in metres Scale 1:100	Client <b>Axiom Project Services Limited</b>	Method/ Plant Used <b>Cable Percussion Borhole</b>	Logged By <b>RT</b>
---	---	--	------------------------

AGS3 UK BH TP LOGS.GPJ AGS3 ALL GDT 27/6/17





Solum House, Unit 1 Elliott Court  
 St Johns Road, Meadowfield  
 Durham, DH7 8PN  
 Telephone: 01913786380

## DRILLHOLE LOG

Project <b>Sheriffhall South East, Gilmerton Road, Lasswade, EH18 1BD</b>				<b>DRILLHOLE No</b>  <b>RBH01</b>
Job No 17-115	Date 04-05-17	Ground Level (m)	Co-Ordinates ( )	
Contractor <b>Arc Environmental Limited</b>				Sheet 1

RUN DETAILS			STRATA					of 1	
Depth	TCR (SCR) RQD	(SPT) Fracture Spacing	Red'cd Level	Legend	Depth (Thick-ness)	DESCRIPTION		Geology	Instrument/ Backfill
						Discontinuities	Main		
				○	0.20		Crops overlying dark brown clayey silty SAND (drillers description). Orange brown gravelly SAND with occasional silt lenses (drillers description).		○
				○	(15.80)				○
				○	16.00				○
				○	(16.00)	23.00 Becoming yellow brown	Red SANDSTONE (drillers description).		○
				○	27.00	27.00 Becoming red brown			○
				○	32.00		Borehole completed to a depth of 32.00m.		○

Drilling Progress and Water Observations							Rotary Flush				GENERAL REMARKS
Date	Time	Depth	Casing	Core Dia mm	Water Strike	Water Standing	From	To	Type	Returns	
03-05-17	16.30	45.00	15.00	150			0	32	WATER	100	Descriptions are based purley on drillers interpretation of cuttings brought to the surface and drilling rate maintained during the drilling process. <b>WATER OBSERVATIONS:</b> No water ingress encountered.

All dimensions in metres Scale 1:293.75	Client <b>Axiom Project Services Limited</b>	Method/ Plant Used <b>Rotary Drilling Rig</b>	Logged By <b>DA</b>
--	---	---	------------------------

AGS3 UK DH TP LOGS.GPJ AGS3 ALL GDT 27/6/17





Solum House, Unit 1 Elliott Court  
 St Johns Road, Meadowfield  
 Durham, DH7 8PN  
 Telephone: 01913786380

## DRILLHOLE LOG

Project <b>Sheriffhall South East, Gilmerton Road, Lasswade, EH18 1BD</b>				<b>DRILLHOLE No</b>  <b>RBH02</b>
Job No <b>17-115</b>	Date <b>04-05-17</b>	Ground Level (m)	Co-Ordinates ( )	
Contractor <b>Arc Environmental Limited</b>				Sheet <b>1</b>

RUN DETAILS			STRATA					of 1	
Depth	TCR (SCR) RQD	(SPT) Fracture Spacing	Red'cd Level	Legend	Depth (Thickness)	DESCRIPTION		Geology	Instrument/ Backfill
						Discontinuities	Main		
				○	0.20		Crops overlying dark brown clayey silty SAND (drillers description). Orange brown gravelly SAND with occasional silt lenses (drillers description).		○
				○	(15.80)				○
				○	16.00				○
				●	(14.20)		Red SANDSTONE (drillers description).		●
				●	27.00	27.00 Becoming yellow brown.			●
				■	30.20				■
				■	31.00		COAL (drillers description).		■
				●	(3.00)		Red SANDSTONE (drillers description).		●
				●	34.00		Borehole completed to a depth of 34.00m.		●

Drilling Progress and Water Observations							Rotary Flush				GENERAL REMARKS
Date	Time	Depth	Casing	Core Dia mm	Water Strike	Water Standing	From	To	Type	Returns	
04-05-17	14.00	32.00	16.00	150			0	34	WATER	100	Descriptions are based purley on drillers interpretation of cuttings brought to the surface and drilling rate maintained during the drilling process. <b>WATER OBSERVATIONS:</b> No water ingress encountered.

All dimensions in metres Scale 1:293.75	Client <b>Axiom Project Services Limited</b>	Method/ Plant Used <b>Rotary Drilling Rig</b>	Logged By <b>DA</b>
--	---	---	------------------------

AGS3 UK DH TP LOGS.GPJ AGS3 ALL GDT 27/6/17



Solum House, Unit 1 Elliott Court  
 St Johns Road, Meadowfield  
 Durham, DH7 8PN  
 Telephone: 01913786380

## DRILLHOLE LOG

Project <b>Sheriffhall South East, Gilmerton Road, Lasswade, EH18 1BD</b>				<b>DRILLHOLE No</b>  <b>RBH03</b>
Job No 17-115	Date 03-05-17	Ground Level (m)	Co-Ordinates ( )	
Contractor <b>Arc Environmental Limited</b>				Sheet 1

RUN DETAILS			STRATA					of 1	
Depth	TCR (SCR) RQD	(SPT) Fracture Spacing	Red'cd Level	Legend	Depth (Thickness)	DESCRIPTION		Geology	Instrument/ Backfill
						Discontinuities	Main		
				○	0.25		Crops overlying dark brown clayey silty SAND (drillers description). Orange brown gravelly SAND with occasional silt lenses (drillers description).		
				○	(14.75)				
				○	15.00		Red SANDSTONE (drillers description).		
				○	(24.00)				
				○	39.00		Yellow SANDSTONE (drillers description).		
				○	(6.00)				
				○	45.00		Borehole completed to a depth of 45.00m		

Drilling Progress and Water Observations							Rotary Flush				GENERAL REMARKS
Date	Time	Depth	Casing	Core Dia mm	Water Strike	Water Standing	From	To	Type	Returns	
04-05-17	16.30	45.00	15.00	150			0	45	WATER	100	Descriptions are based purley on drillers interpretation of cuttings brought to the surface and drilling rate maintained during the drilling process. WATER OBSERVATIONS: No water ingress encountered.

All dimensions in metres Scale 1:293.75	Client <b>Axiom Project Services Limited</b>	Method/ Plant Used <b>Rotary Drilling Rig</b>	Logged By <b>DA</b>
--	---	---	------------------------

AGS3 UK DH TP LOGS.GPJ AGS3 ALL.GDT 27/6/17



Solum House, Unit 1 Elliott Court  
 St Johns Road, Meadowfield  
 Durham, DH7 8PN  
 Telephone: 01913786380

## TRIAL PIT LOG

Project <b>Sheriffhall South East, Gilmerton Road, Lasswade, EH18 1BD</b>				<b>TRIAL PIT No TP01</b>
Job No 17-115	Date 02-05-17	Ground Level (m)	Co-Ordinates ( )	
Contractor <b>Arc Environmental Limited</b>				Sheet 1 of 1

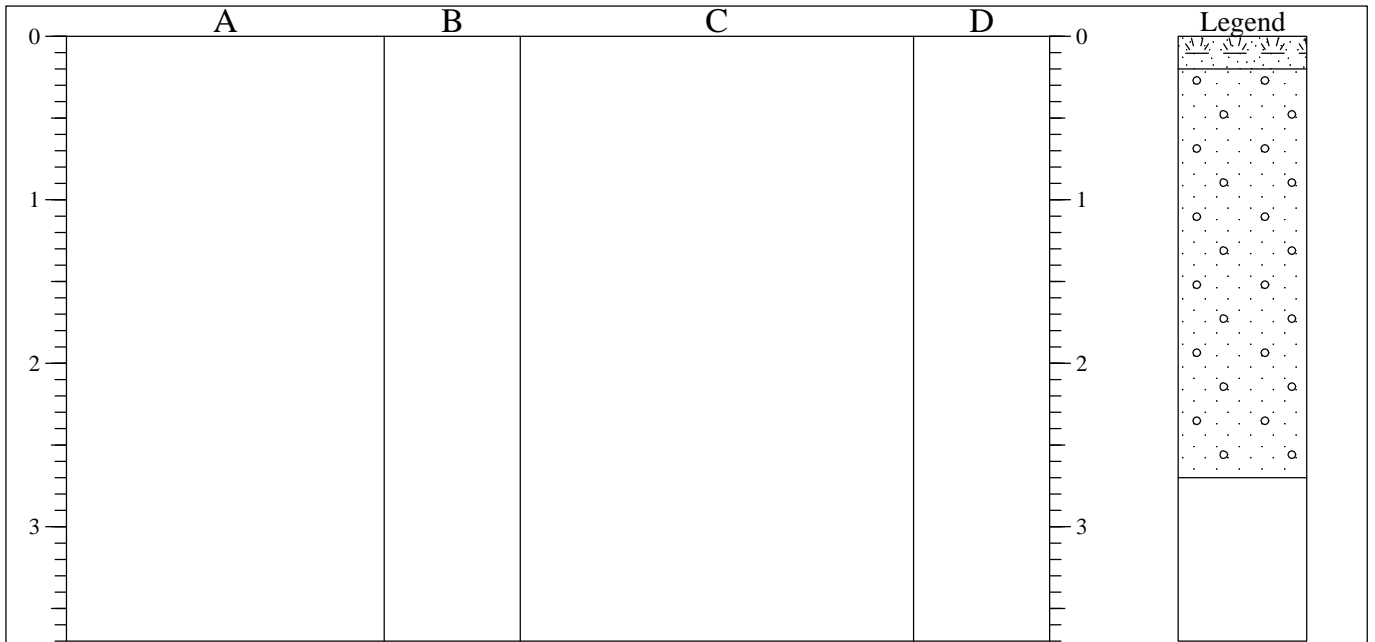

STRATA			SAMPLES & TESTS		
Depth	No	DESCRIPTION	Depth	No	Remarks/Tests
0.00-0.20		Crops overlying dark brown clayey silty fine to medium SAND (TOPSOIL).	0.10	J/D	6.0%
0.20-2.70		Orange brown gravelly fine to medium SAND (GLACIOFLUVIAL DEPOSITS).	0.30	B	
		1.00 Becoming slightly gravelly	0.50	CBR	
2.70		Trial Pit completed to a depth of 2.70m.	1.50	B	

<p>Shoring/Support: Stability: Stable</p> <div style="text-align: center;"> </div>	<p><b>GENERAL REMARKS</b></p> <p>WATER OBSERVATIONS: No water ingress encountered.</p>
--	--

All dimensions in metres Scale 1:46.25	Client <b>Axiom Project Services Limited</b>	Method/ Plant Used <b>JCB 3CX</b>	Logged By <b>MR</b>
---	---	---	------------------------

AGS3 UK TP LOGS.GPJ AGS3\_ALL.GDT 27/6/17





Solum House, Unit 1 Elliott Court  
 St Johns Road, Meadowfield  
 Durham, DH7 8PN  
 Telephone: 01913786380

## TRIAL PIT LOG

Project <b>Sheriffhall South East, Gilmerton Road, Lasswade, EH18 1BD</b>				<b>TRIAL PIT No TP02</b>
Job No 17-115	Date 02-05-17	Ground Level (m)	Co-Ordinates ( )	
Contractor <b>Arc Environmental Limited</b>				Sheet 1 of 1

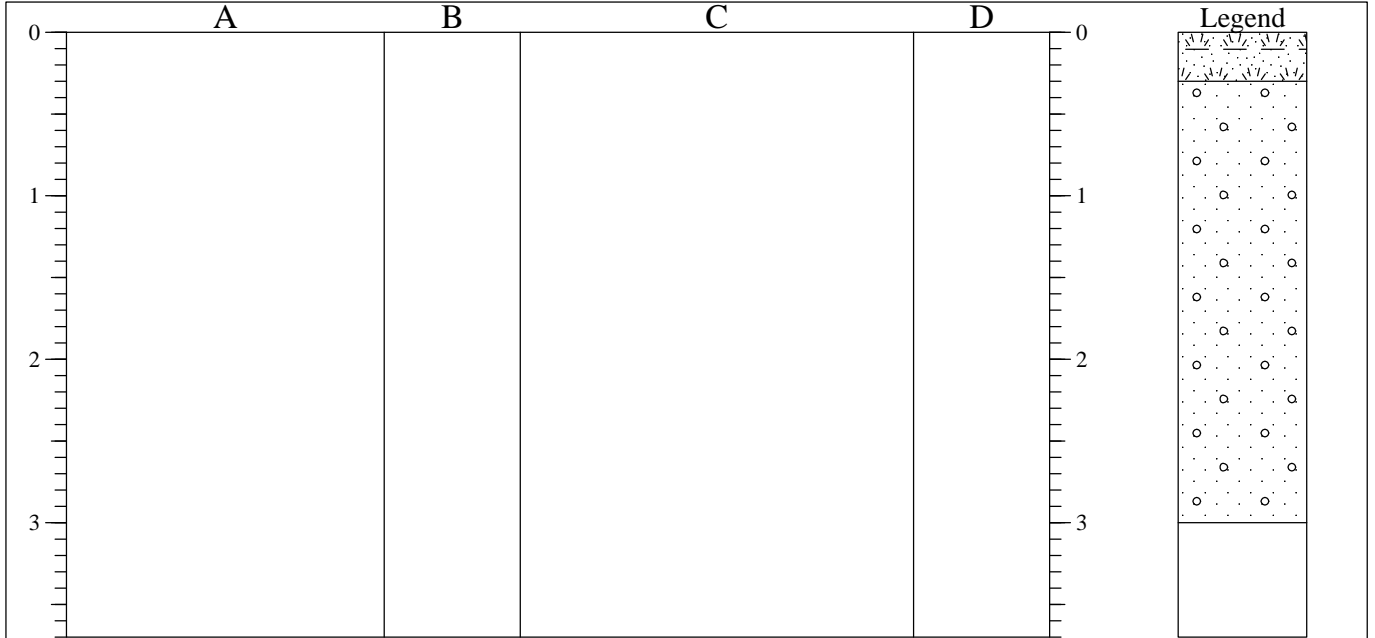

STRATA			SAMPLES & TESTS		
Depth	No	DESCRIPTION	Depth	No	Remarks/Tests
0.00-0.30		Crops overlying dark brown clayey silty fine to medium SAND (TOPSOIL).			
0.30-3.00		Orange brown gravelly fine to medium SAND (GLACIOFLUVIAL DEPOSITS).	0.20	J/D	
			1.20	B	
			2.00	B	
3.00		Trial Pit completed to a depth of 3.00m.			

Shoring/Support:  
Stability: Stable

GENERAL REMARKS
WATER OBSERVATIONS: No water ingress encountered.

AGS3 UK TP LOGS.GPJ AGS3\_ALL.GDT 27/6/17

All dimensions in metres Scale 1:46.25	Client <b>Axiom Project Services Limited</b>	Method/ Plant Used <b>JCB 3CX</b>	Logged By <b>MR</b>
---	---	---	------------------------



Solum House, Unit 1 Elliott Court  
 St Johns Road, Meadowfield  
 Durham, DH7 8PN  
 Telephone: 01913786380

## TRIAL PIT LOG

Project <b>Sheriffhall South East, Gilmerton Road, Lasswade, EH18 1BD</b>				<b>TRIAL PIT No</b>  <b>TP03</b>
Job No <b>17-115</b>	Date <b>02-05-17</b>	Ground Level (m)	Co-Ordinates ( )	
Contractor <b>Arc Environmental Limited</b>				Sheet <b>1 of 1</b>

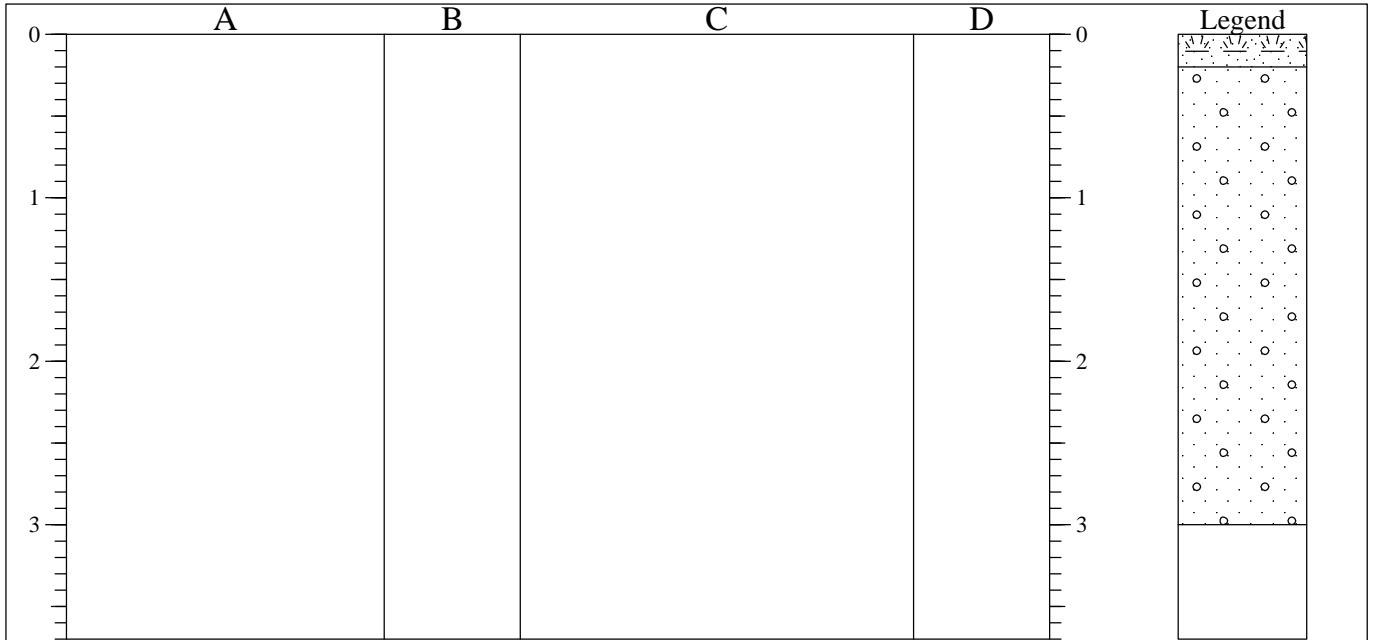

STRATA			SAMPLES & TESTS		
Depth	No	DESCRIPTION	Depth	No	Remarks/Tests
0.00-0.20		Crops overlying dark brown clayey silty fine to medium SAND (TOPSOIL).	0.10	J/D	
0.20-3.00		Orange brown gravelly fine to medium SAND (GLACIOFLUVIAL DEPOSITS).	0.70	B	
		1.00 Becoming slightly gravelly	1.50	B	
3.00		Trial Pit completed to a depth of 3.00m.			

<p>Shoring/Support: Stability: Stable</p> <div style="text-align: center;"> </div>	<p><b>GENERAL REMARKS</b></p> <p>WATER OBSERVATIONS: No water ingress encountered.</p>
--	--

AGS3 UK TP LOGS.GPJ AGS3\_ALL.GDT 27/6/17

All dimensions in metres Scale 1:46.25	Client <b>Axiom Project Services Limited</b>	Method/ Plant Used <b>JCB 3CX</b>	Logged By <b>MR</b>
---	---	---	------------------------



Solum House, Unit 1 Elliott Court  
 St Johns Road, Meadowfield  
 Durham, DH7 8PN  
 Telephone: 01913786380

## TRIAL PIT LOG

Project <b>Sheriffhall South East, Gilmerton Road, Lasswade, EH18 1BD</b>				<b>TRIAL PIT No</b>  <b>TP04</b>
Job No <b>17-115</b>	Date <b>02-05-17</b>	Ground Level (m)	Co-Ordinates ( )	
Contractor <b>Arc Environmental Limited</b>				Sheet <b>1 of 1</b>

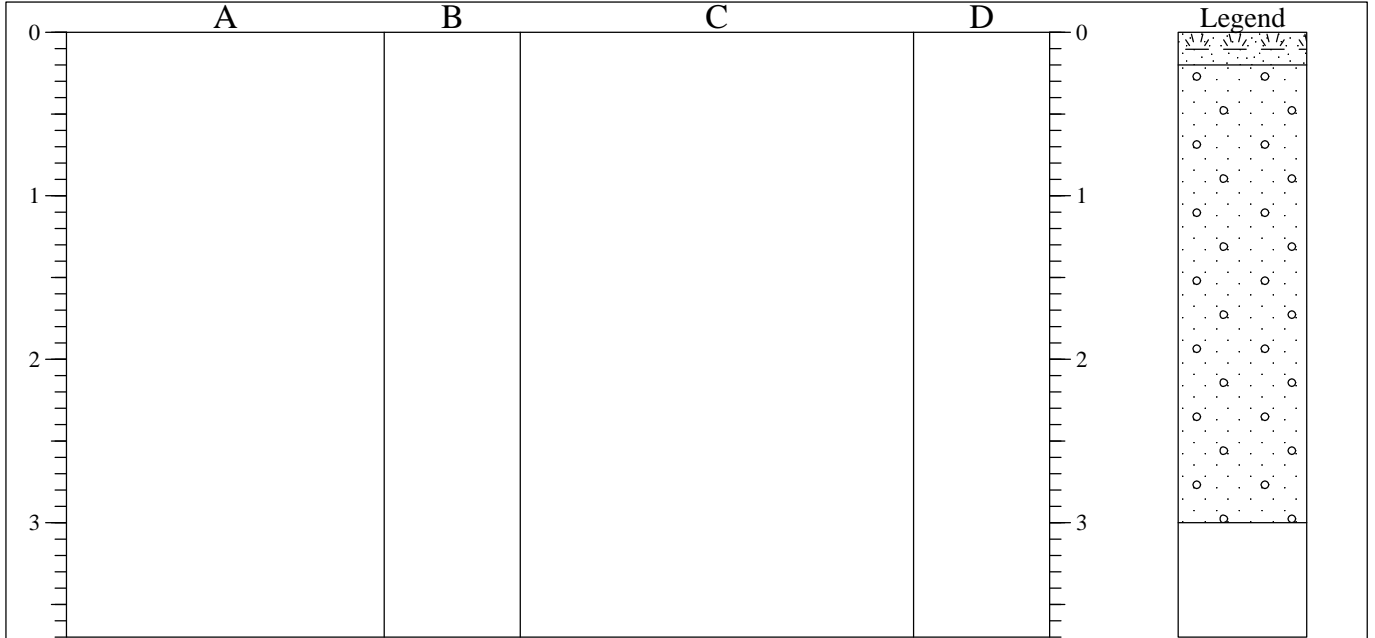

STRATA			SAMPLES & TESTS		
Depth	No	DESCRIPTION	Depth	No	Remarks/Tests
0.00-0.20		Crops overlying dark brown clayey silty fine to medium SAND (TOPSOIL).	0.10	J/D	
0.20-3.00		Orange brown gravelly fine to medium SAND (GLACIOFLUVIAL DEPOSITS).	0.40	B	
		0.60 Becoming slightly gravelly	0.50	CBR	
			1.20	B	
			2.20	B	
3.00		Trial Pit completed to a depth of 3.00m.			

<p>Shoring/Support: Stability: Stable</p> <div style="text-align: center;"> </div>	<p><b>GENERAL REMARKS</b></p> <p>WATER OBSERVATIONS: No water ingress encountered.</p>
--	--

AGS3 UK TP LOGS.GPJ AGS3\_ALL.GDT 27/6/17

All dimensions in metres Scale 1:46.25	Client <b>Axiom Project Services Limited</b>	Method/ Plant Used <b>JCB 3CX</b>	Logged By <b>MR</b>
---	---	---	------------------------



Solum House, Unit 1 Elliott Court  
 St Johns Road, Meadowfield  
 Durham, DH7 8PN  
 Telephone: 01913786380

## TRIAL PIT LOG

Project <b>Sheriffhall South East, Gilmerton Road, Lasswade, EH18 1BD</b>				<b>TRIAL PIT No</b>  <b>TP05</b>
Job No <b>17-115</b>	Date <b>02-05-17</b>	Ground Level (m)	Co-Ordinates ( )	
Contractor <b>Arc Environmental Limited</b>				Sheet <b>1 of 1</b>

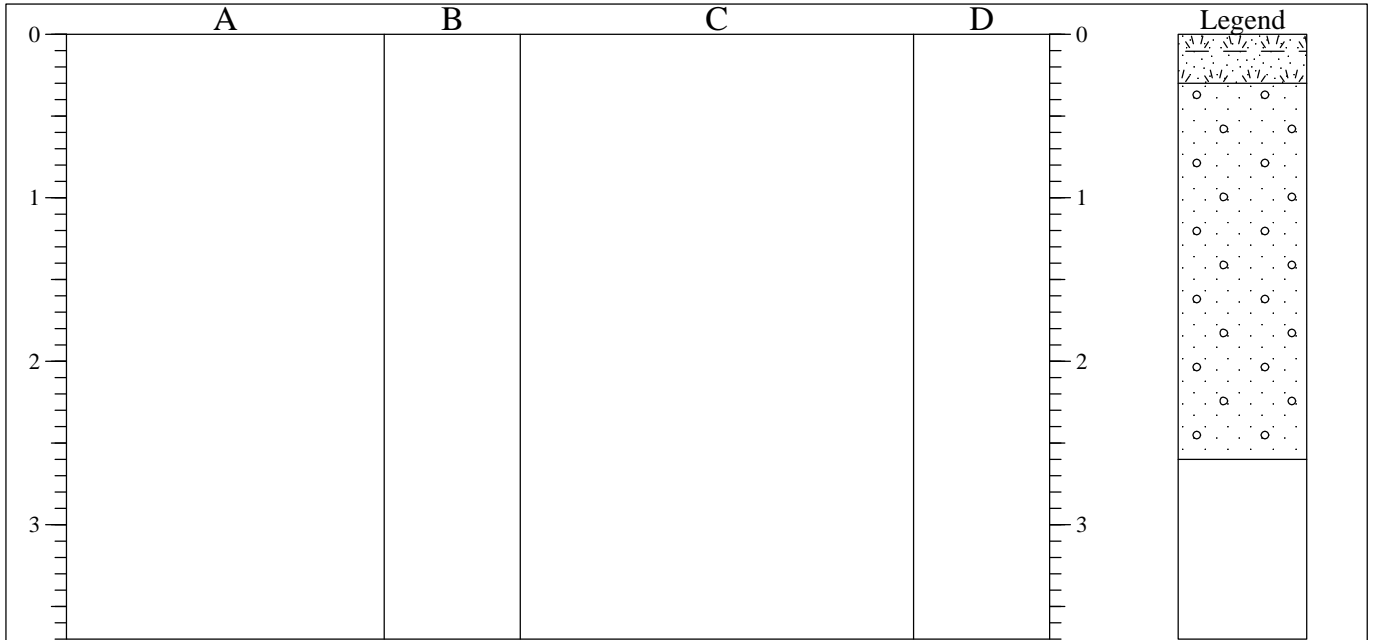

STRATA			SAMPLES & TESTS			
Depth	No	DESCRIPTION	Depth	No	Remarks/Tests	
0.00-0.30		Crops overlying dark brown clayey silty fine to medium SAND (TOPSOIL).				
0.30-2.60		Orange brown slightly gravelly fine to medium SAND (GLACIOFLUVIAL DEPOSITS).	0.20	J/D		
			0.50	CBR		2.5%
			1.00	B		
			2.00	B		
2.60		Trial Pit completed to a depth of 2.60m.				

<p><b>Shoring/Support:</b>  <b>Stability: Stable</b></p> <div style="text-align: center;"> </div>	<p><b>GENERAL REMARKS</b></p> <p>WATER OBSERVATIONS: No water ingress encountered.</p>
---	--

AGS3 UK TP LOGS.GPJ AGS3\_ALL.GDT 27/6/17

All dimensions in metres Scale 1:46.25	Client <b>Axiom Project Services Limited</b>	Method/ Plant Used <b>JCB 3CX</b>	Logged By <b>MR</b>
---	---	---	------------------------



Solum House, Unit 1 Elliott Court  
 St Johns Road, Meadowfield  
 Durham, DH7 8PN  
 Telephone: 01913786380

## TRIAL PIT LOG

Project <b>Sheriffhall South East, Gilmerton Road, Lasswade, EH18 1BD</b>				<b>TRIAL PIT No</b>  <b>TP06</b>
Job No <b>17-115</b>	Date <b>02-05-17</b>	Ground Level (m)	Co-Ordinates ( )	
Contractor <b>Arc Environmental Limited</b>				Sheet <b>1 of 1</b>

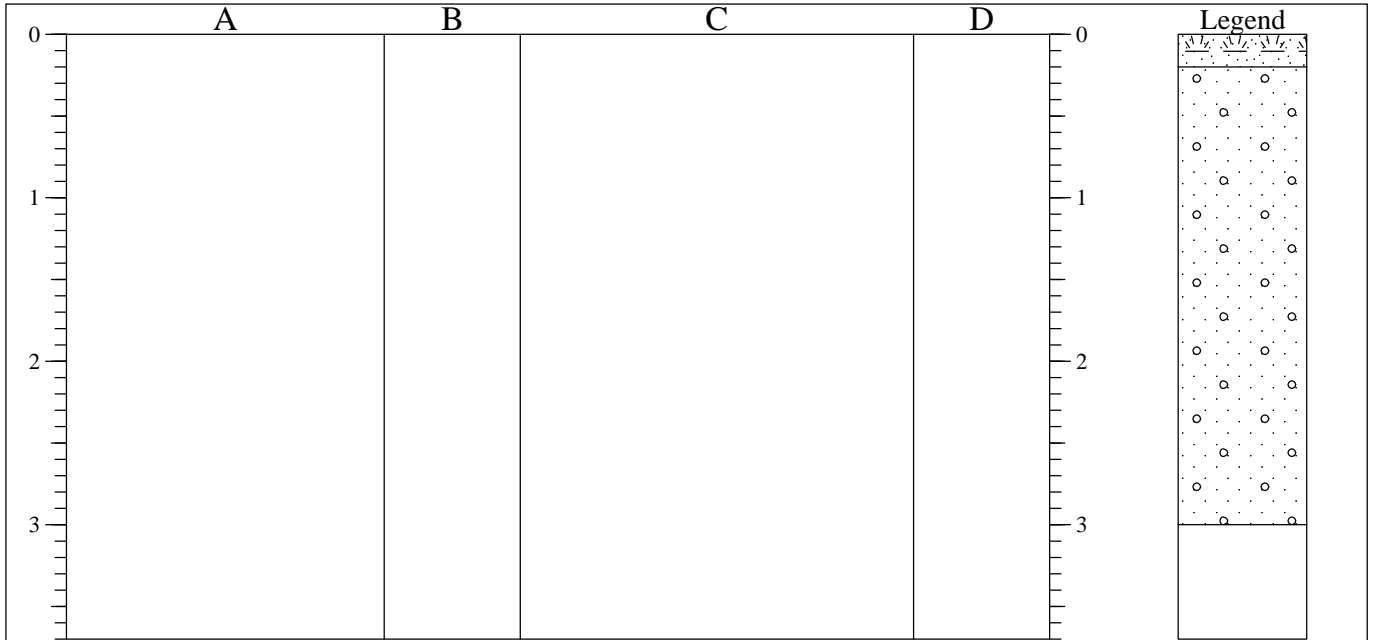

STRATA			SAMPLES & TESTS			
Depth	No	DESCRIPTION	Depth	No	Remarks/Tests	
0.00-0.20		Crops overlying dark brown clayey silty fine to medium SAND (TOPSOIL).	0.10	J/D		
0.20-3.00		Orange brown silty gravelly fine to medium SAND (GLACIOFLUVIAL DEPOSITS).	0.50	B		
		1.40 Becoming slightly gravelly	0.50	CBR		3.5%
			1.60	B		
3.00		Trial Pit completed to a depth of 3.00m.				

<p>Shoring/Support: Stability: Stable</p> <div style="text-align: center;"> </div>	<p><b>GENERAL REMARKS</b></p> <p>WATER OBSERVATIONS: No water ingress encountered.</p>
--	--

AGS3 UK TP LOGS.GPJ AGS3\_ALL.GDT 27/6/17

All dimensions in metres Scale 1:46.25	Client <b>Axiom Project Services Limited</b>	Method/ Plant Used <b>JCB 3CX</b>	Logged By <b>MR</b>
---	---	---	------------------------





Solum House, Unit 1 Elliott Court  
 St Johns Road, Meadowfield  
 Durham, DH7 8PN  
 Telephone: 01913786380

## TRIAL PIT LOG

Project <b>Sheriffhall South East, Gilmerton Road, Lasswade, EH18 1BD</b>				<b>TRIAL PIT No</b>  <b>TP07</b>
Job No <b>17-115</b>	Date <b>02-05-17</b>	Ground Level (m)	Co-Ordinates ( )	
Contractor <b>Arc Environmental Limited</b>				Sheet <b>1 of 1</b>

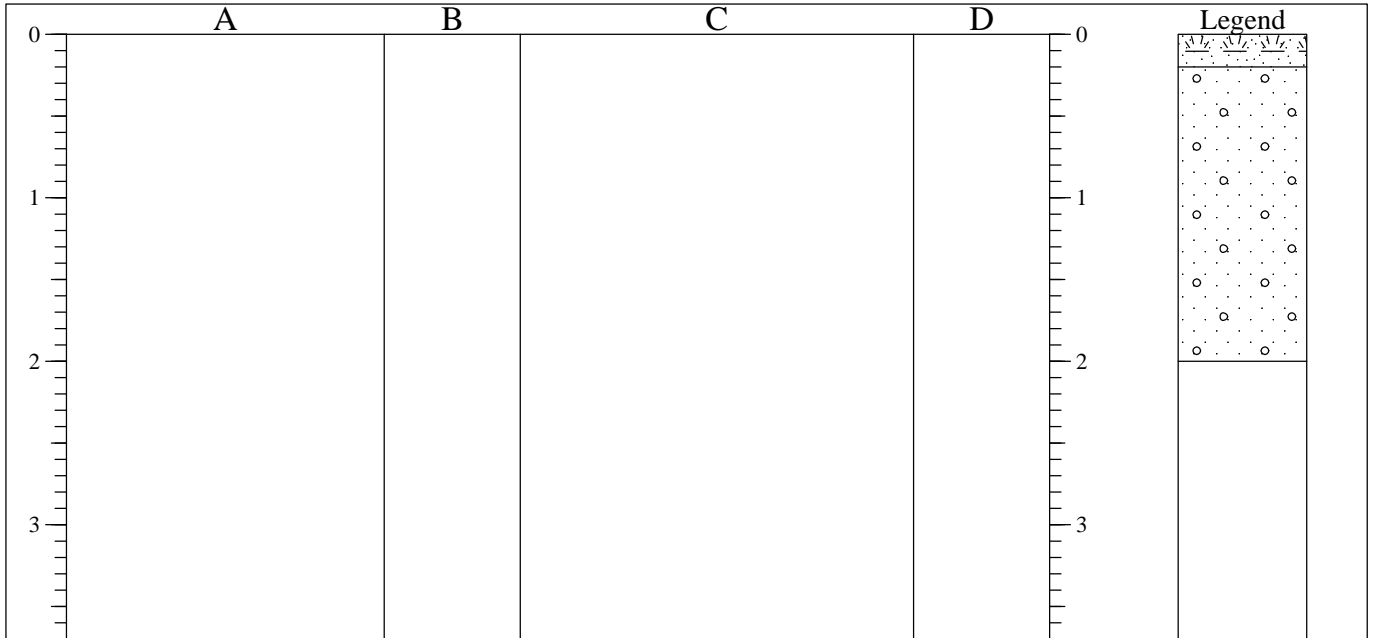

STRATA			SAMPLES & TESTS		
Depth	No	DESCRIPTION	Depth	No	Remarks/Tests
0.00-0.20		Crops overlying dark brown clayey silty fine to medium SAND (TOPSOIL).	0.10	J/D	5.0%
0.20-2.00		Orange brown very gravelly fine to medium SAND with occasional pockets of gravel (GLACIOFLUVIAL DEPOSITS).	0.50	CBR	
			0.60	B	
2.00		Trial Pit terminated due to collapse at a depth of 2.00m.	1.30	B	

<p><b>Shoring/Support:</b>  <b>Stability: Unstable</b></p> <div style="text-align: center;"> </div>	<p><b>GENERAL REMARKS</b></p> <p>WATER          OBSERVATIONS: No water ingress encountered.</p>
---	---

AGS3 UK TP LOGS.GPJ AGS3\_ALL.GDT 27/6/17

All dimensions in metres Scale 1:46.25	Client <b>Axiom Project Services Limited</b>	Method/ Plant Used <b>JCB 3CX</b>	Logged By <b>MR</b>
---	---	---	------------------------



Solum House, Unit 1 Elliott Court  
 St Johns Road, Meadowfield  
 Durham, DH7 8PN  
 Telephone: 01913786380

## TRIAL PIT LOG

Project <b>Sheriffhall South East, Gilmerton Road, Lasswade, EH18 1BD</b>				<b>TRIAL PIT No</b>  <b>TP08</b>
Job No <b>17-115</b>	Date <b>02-05-17</b>	Ground Level (m)	Co-Ordinates ( )	
Contractor <b>Arc Environmental Limited</b>				Sheet <b>1 of 1</b>

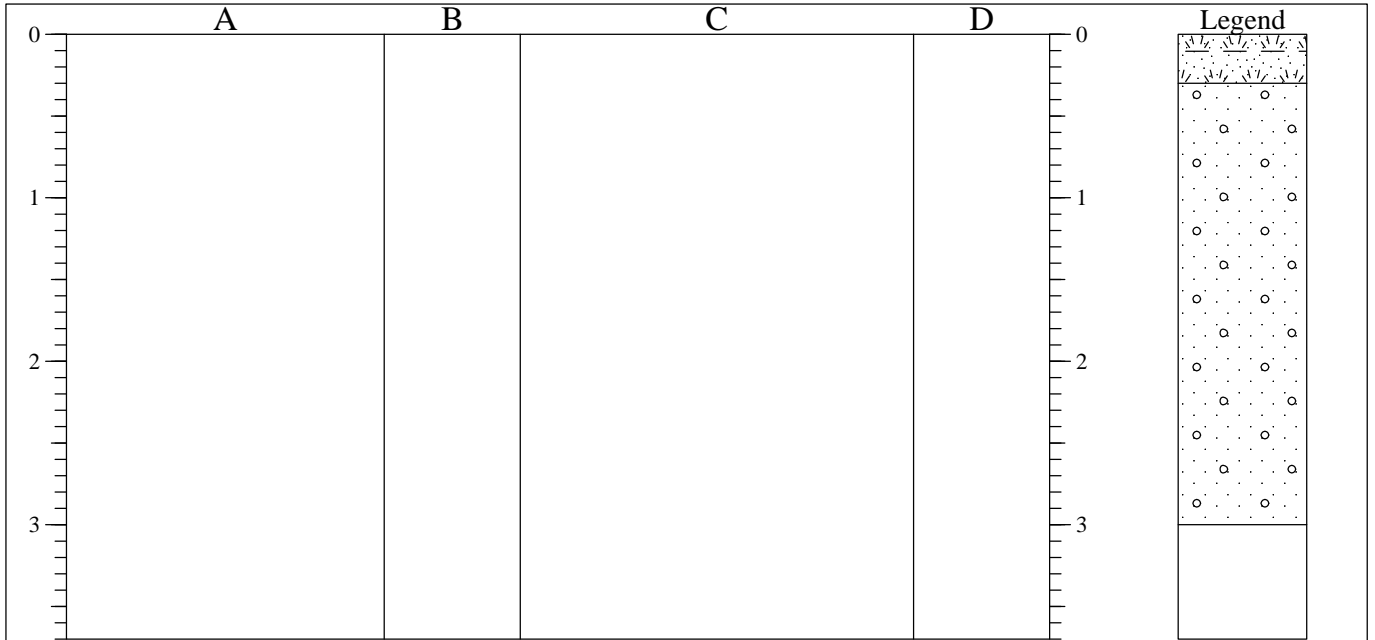

STRATA			SAMPLES & TESTS		
Depth	No	DESCRIPTION	Depth	No	Remarks/Tests
0.00-0.30		Crops overlying dark brown clayey silty fine to medium SAND (TOPSOIL).			
0.30-3.00		Orange brown gravelly fine to medium SAND (GLACIOFLUVIAL DEPOSITS).  1.50 Becoming light brown	0.20	J/D	5.5%
			0.50	CBR	
			1.00	B	
			1.60	B	
2.50	B				
3.00		Trial Pit completed to a depth of 3.00m.			

<p>Shoring/Support: Stability: Stable</p> <div style="text-align: center;"> </div>	<p><b>GENERAL REMARKS</b></p> <p>WATER OBSERVATIONS: No water ingress encountered.</p>
--	--

AGS3 UK TP LOGS.GPJ AGS3\_ALL.GDT 27/6/17

All dimensions in metres Scale 1:46.25	Client <b>Axiom Project Services Limited</b>	Method/ Plant Used <b>JCB 3CX</b>	Logged By <b>MR</b>
---	---	---	------------------------



Solum House, Unit 1 Elliott Court  
 St Johns Road, Meadowfield  
 Durham, DH7 8PN  
 Telephone: 01913786380

## TRIAL PIT LOG

Project <b>Sheriffhall South East, Gilmerton Road, Lasswade, EH18 1BD</b>				<b>TRIAL PIT No TP09</b>
Job No 17-115	Date 02-05-17	Ground Level (m)	Co-Ordinates ( )	
Contractor <b>Arc Environmental Limited</b>				Sheet 1 of 1

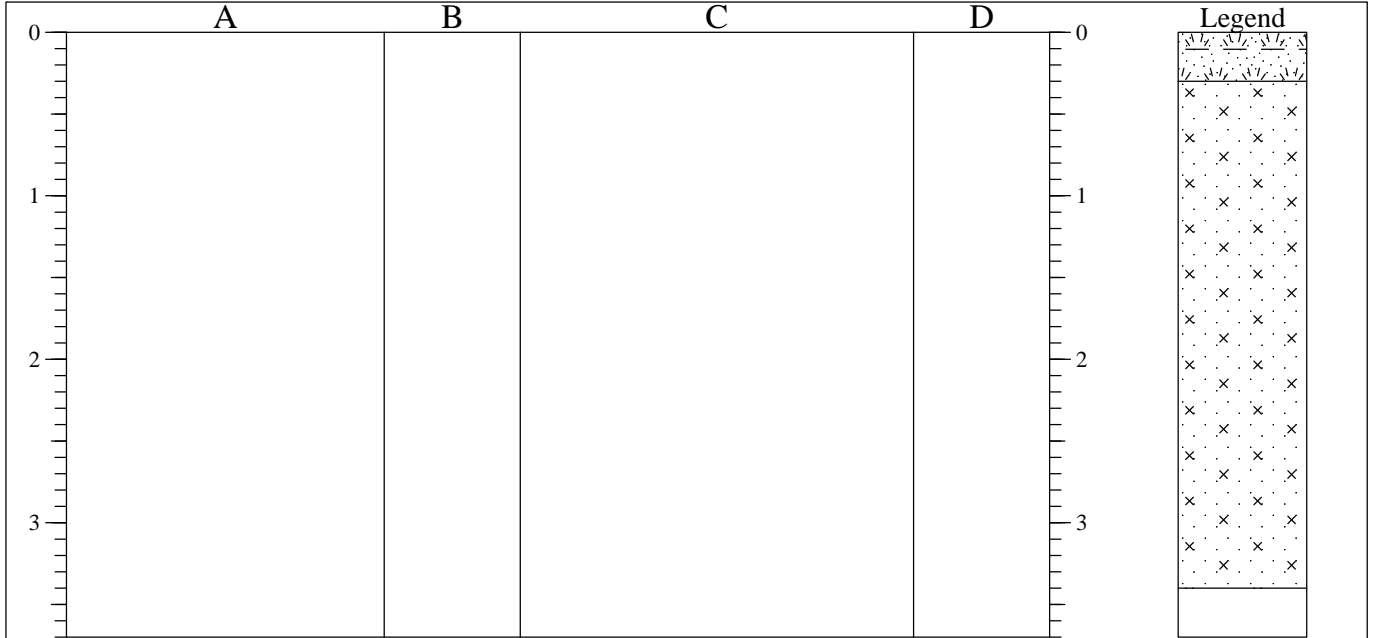

STRATA			SAMPLES & TESTS		
Depth	No	DESCRIPTION	Depth	No	Remarks/Tests
0.00-0.30		Crops overlying dark brown slightly silty SAND (TOPSOIL).	0.10-0.20	J/D	
0.30-3.40		Orange brown initially grey mottled silty fine to medium SAND (GLACIOFLUVIAL DEPOSITS).	0.50-0.60	B	
			1.30-1.50	B	
			1.80-2.00	B	
			3.00-3.20	B	
3.40		Trial pit completed to a depth of 3.40m.			

<p>Shoring/Support: Stability: Stable</p> <div style="text-align: center;"> </div>	<p><b>GENERAL REMARKS</b></p> <p>WATER OBSERVATIONS: No water ingress encountered.</p>
--	--

AGS3 UK TP LOGS.GPJ AGS3\_ALL.GDT 27/6/17

All dimensions in metres Scale 1:46.25	Client <b>Axiom Project Services Limited</b>	Method/ Plant Used <b>JCB 3CX</b>	Logged By <b>MH</b>
---	---	---	------------------------



Solum House, Unit 1 Elliott Court  
 St Johns Road, Meadowfield  
 Durham, DH7 8PN  
 Telephone: 01913786380

## TRIAL PIT LOG

Project <b>Sheriffhall South East, Gilmerton Road, Lasswade, EH18 1BD</b>				<b>TRIAL PIT No</b>  <b>TP10</b>
Job No <b>17-115</b>	Date <b>02-05-17</b>	Ground Level (m)	Co-Ordinates ( )	
Contractor <b>Arc Environmental Limited</b>				Sheet <b>1 of 1</b>

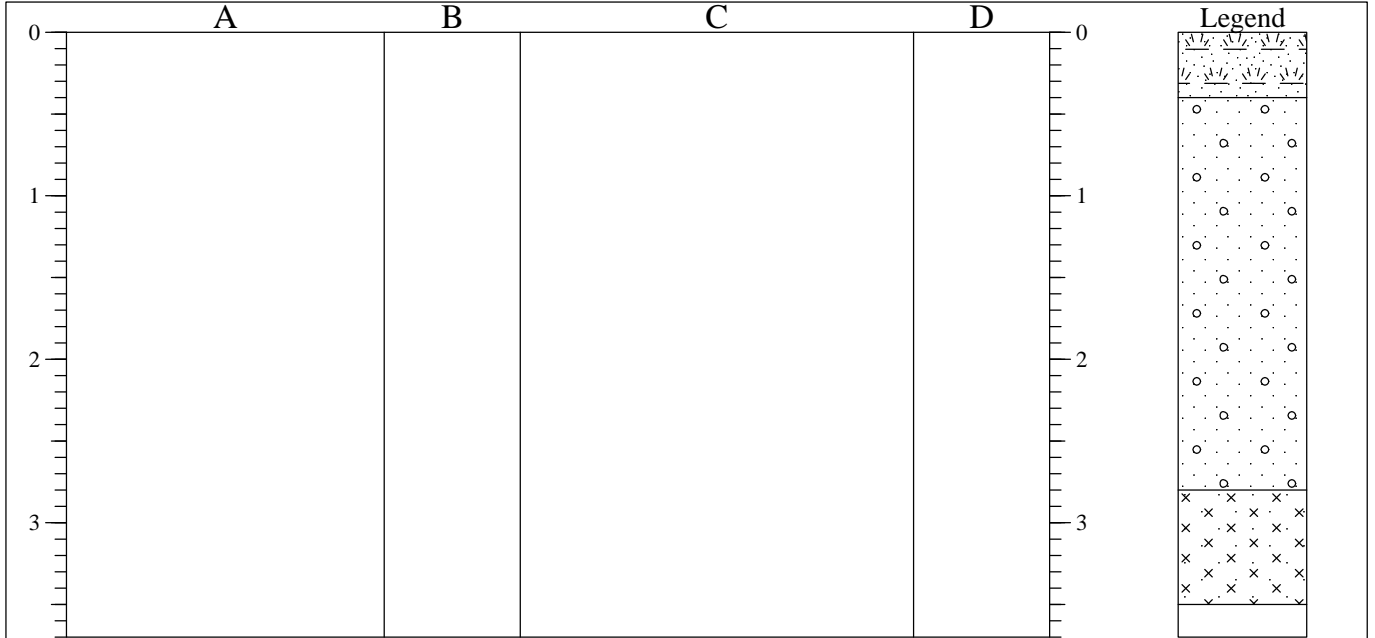

STRATA			SAMPLES & TESTS		
Depth	No	DESCRIPTION	Depth	No	Remarks/Tests
0.00-0.40		Crops overlying dark brown clayey silty fine to medium SAND (TOPSOIL).			
0.40-2.80		Orange brown slightly gravelly fine to medium SAND with occasional silt lenses (GLACIOFLUVIAL DEPOSITS).	0.30	J/D	
			0.80	B	
			2.00	B	
2.80-3.50		Soft light brown clayey very sandy SILT (GLACIOFLUVIAL DEPOSITS).	3.00	B	
3.50		Trial Pit completed to a depth of 3.50m.			

<p><b>Shoring/Support:</b>  <b>Stability: Stable</b></p> <div style="text-align: center;"> </div>	<p><b>GENERAL REMARKS</b></p> <p>WATER OBSERVATIONS: No water ingress encountered.</p>
---	--

AGS3 UK TP LOGS.GPJ AGS3\_ALL.GDT 27/6/17

All dimensions in metres Scale 1:46.25	Client <b>Axiom Project Services Limited</b>	Method/ Plant Used <b>JCB 3CX</b>	Logged By <b>MR</b>
---	---	---	------------------------



Solum House, Unit 1 Elliott Court  
 St Johns Road, Meadowfield  
 Durham, DH7 8PN  
 Telephone: 01913786380

## TRIAL PIT LOG

Project <b>Sheriffhall South East, Gilmerton Road, Lasswade, EH18 1BD</b>				<b>TRIAL PIT No TP11</b>
Job No <b>17-115</b>	Date <b>02-05-17</b>	Ground Level (m)	Co-Ordinates ( )	
Contractor <b>Arc Environmental Limited</b>				Sheet <b>1 of 1</b>

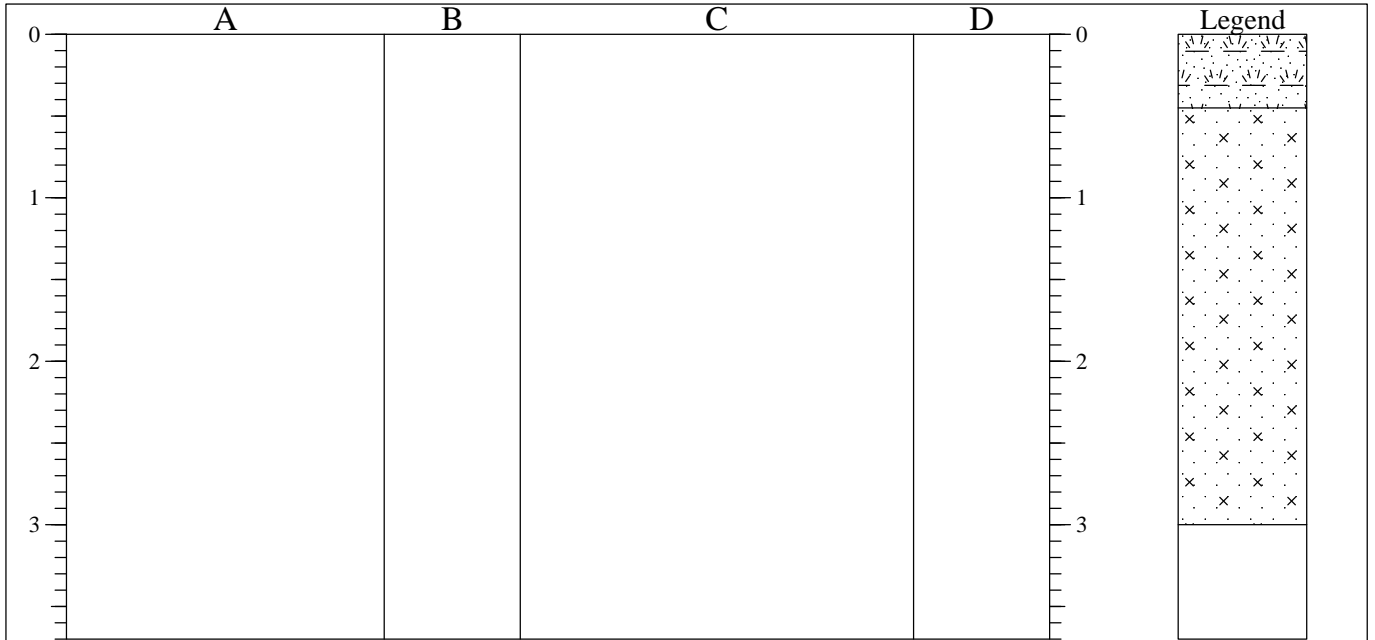

STRATA			SAMPLES & TESTS		
Depth	No	DESCRIPTION	Depth	No	Remarks/Tests
0.00-0.45		Crops overlying dark brown clayey silty fine to medium SAND (TOPSOIL).			
0.45-3.00		Orange brown initially grey mottled very silty fine to medium SAND (GLACIOFLUVIAL DEPOSITS).	0.30-0.40	J/D	
			1.00-1.20	B	
			1.80-2.00	B	
		2.30 Becoming clayey and very silty	2.00-2.60	B	
3.00		Trial pit completed to a depth of 3.00m	2.80-3.00	B	

<p>Shoring/Support: Stability: Stable</p> <div style="text-align: center;"> </div>	<p><b>GENERAL REMARKS</b></p> <p>WATER OBSERVATIONS: No water ingress encountered.</p>
--	--

AGS3 UK TP LOGS.GPJ AGS3\_ALL.GDT 27/6/17

All dimensions in metres Scale 1:46.25	Client <b>Axiom Project Services Limited</b>	Method/ Plant Used <b>JCB 3CX</b>	Logged By <b>MH</b>
---	---	---	------------------------





Solum House, Unit 1 Elliott Court  
 St Johns Road, Meadowfield  
 Durham, DH7 8PN  
 Telephone: 01913786380

## TRIAL PIT LOG

Project <b>Sheriffhall South East, Gilmerton Road, Lasswade, EH18 1BD</b>				<b>TRIAL PIT No</b>  <b>TP12</b>
Job No <b>17-115</b>	Date <b>02-05-17</b>	Ground Level (m)	Co-Ordinates ( )	
Contractor <b>Arc Environmental Limited</b>				Sheet <b>1 of 1</b>

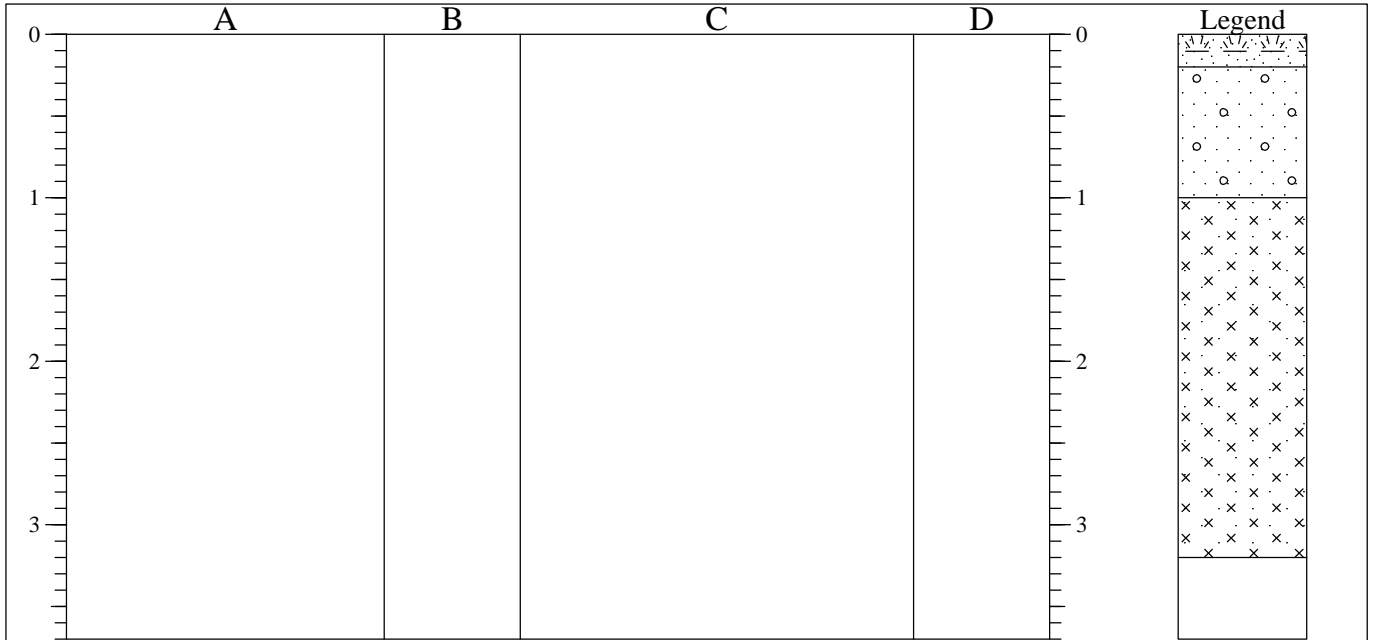

STRATA			SAMPLES & TESTS		
Depth	No	DESCRIPTION	Depth	No	Remarks/Tests
0.00-0.20		Crops overlying dark brown clayey silty fine to medium SAND (TOPSOIL).	0.10	J/D	
0.20-1.00		Orange brown gravelly fine to medium SAND (GLACIOFLUVIAL DEPOSITS).	0.80	B	
1.00-3.20		Firm orange brown and grey mottled clayey sandy SILT (GLACIOFLUVIAL DEPOSITS).	1.50	B	
		2.00 Becoming soft and slightly saturated	2.50	B	
3.20		Trial Pit completed to a depth of 3.20m.			

<p><b>Shoring/Support:</b>  <b>Stability: Stable</b></p> <div style="text-align: center;"> </div>	<p><b>GENERAL REMARKS</b></p> <p>WATER OBSERVATIONS: No water ingress encountered.</p>
---	--

AGS3 UK TP LOGS.GPJ AGS3\_ALL.GDT 27/6/17

All dimensions in metres Scale 1:46.25	Client <b>Axiom Project Services Limited</b>	Method/ Plant Used <b>JCB 3CX</b>	Logged By <b>MR</b>
---	---	---	------------------------



Solum House, Unit 1 Elliott Court  
 St Johns Road, Meadowfield  
 Durham, DH7 8PN  
 Telephone: 01913786380

## TRIAL PIT LOG

Project <b>Sheriffhall South East, Gilmerton Road, Lasswade, EH18 1BD</b>				<b>TRIAL PIT No</b>  <b>TP13</b>
Job No <b>17-115</b>	Date <b>02-05-17</b>	Ground Level (m)	Co-Ordinates ( )	
Contractor <b>Arc Environmental Limited</b>				Sheet <b>1 of 1</b>

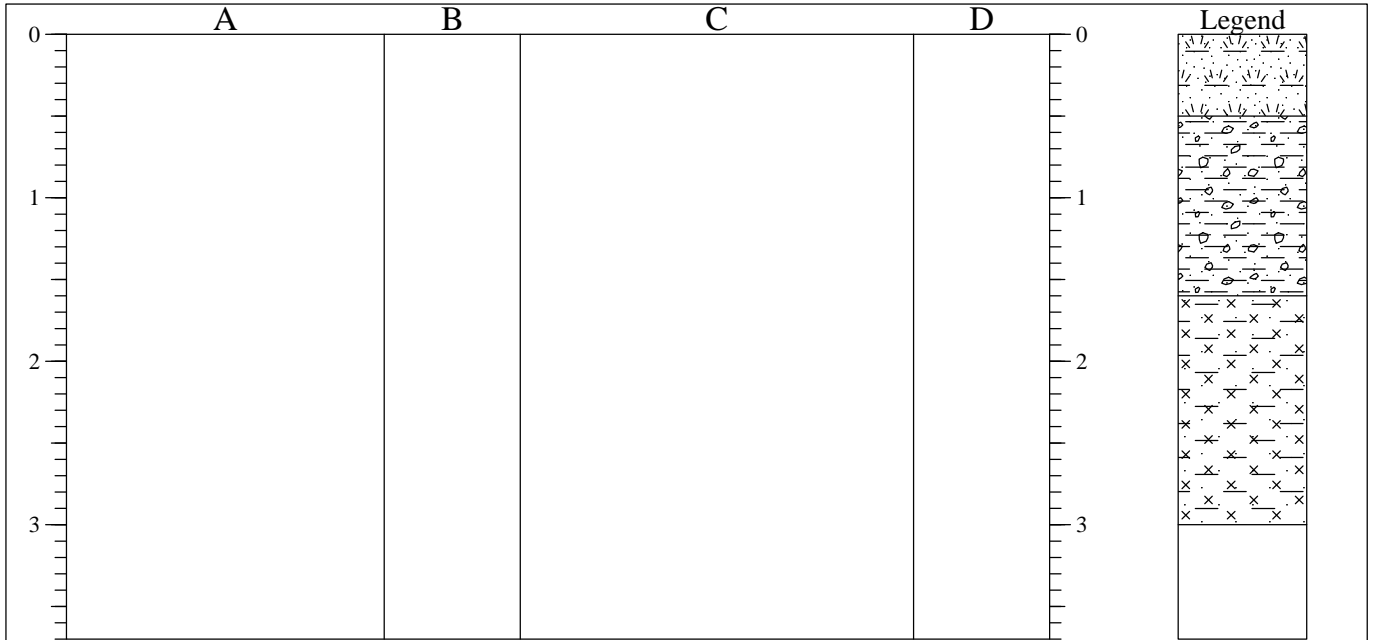

STRATA			SAMPLES & TESTS		
Depth	No	DESCRIPTION	Depth	No	Remarks/Tests
0.00-0.50		Crops overlying light grey brown sandy slightly gravelly CLAY (TOPSOIL).	0.10-0.20	J/D	
			0.30-0.40	B	
0.50-1.60		Soft orange brown sandy slightly gravelly CLAY. Gravel is subangular to rounded fine to coarse of sandstone and mudstone (GLACIOFLUVIAL DEPOSITS).	0.60-0.80	B	
1.60-3.00		Soft (extremely low strength) grey brown clayey very sandy SILT (GLACIOFLUVIAL DEPOSITS).	1.80-2.00	B	7kN/m <sup>2</sup>
			1.80	V	
3.00		Trial pit completed to a depth of 3.00m.	2.80-3.00	B	6kN/m <sup>2</sup>
			2.80	V	

<p>Shoring/Support: Stability: Stable</p> <div style="text-align: center;"> </div>	<p><b>GENERAL REMARKS</b></p> <p>WATER OBSERVATIONS: No water ingress encountered.</p>
--	--

AGS3 UK TP LOGS.GPJ AGS3\_ALL.GDT 27/6/17

All dimensions in metres Scale 1:46.25	Client <b>Axiom Project Services Limited</b>	Method/ Plant Used <b>JCB 3CX</b>	Logged By <b>MH</b>
---	---	---	------------------------



Solum House, Unit 1 Elliott Court  
 St Johns Road, Meadowfield  
 Durham, DH7 8PN  
 Telephone: 01913786380

## TRIAL PIT LOG

Project <b>Sheriffhall South East, Gilmerton Road, Lasswade, EH18 1BD</b>				<b>TRIAL PIT No TP14</b>
Job No 17-115	Date 02-05-17	Ground Level (m)	Co-Ordinates ( )	
Contractor <b>Arc Environmental Limited</b>				Sheet 1 of 1

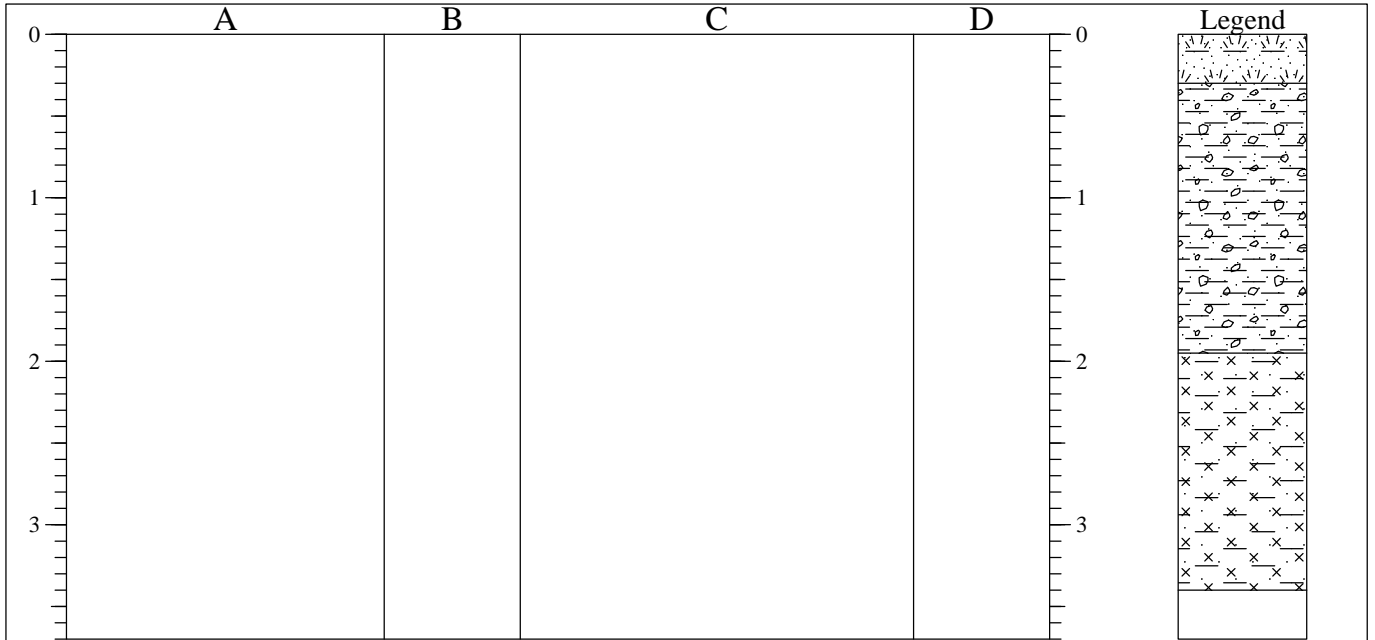

STRATA			SAMPLES & TESTS		
Depth	No	DESCRIPTION	Depth	No	Remarks/Tests
0.00-0.30		Crops overlying light grey brown sandy slightly gravelly CLAY (TOPSOIL).	0.10-0.20	J/D	
0.30-1.95		Soft (low strength) orange brown sandy slightly gravelly CLAY (GLACIOFLUVIAL DEPOSITS).	1.00	V	31kN/m <sup>2</sup>
			1.20-1.40	B	
1.95-3.40		Soft (extremely low strength) grey brown clayey very sandy SILT (GLACIOFLUVIAL DEPOSITS).	2.00-2.10	B	8kN/m <sup>2</sup>
			2.00	V	
			2.50	V	7kN/m <sup>2</sup>
			3.10-3.20	B	
3.40		Trial pit completed to a depth of 3.40m.			

<p>Shoring/Support: Stability: Stable</p> <div style="text-align: center;"> </div>	<p><b>GENERAL REMARKS</b></p> <p>WATER OBSERVATIONS: Slight seepage noted at a depth of 1.95m.</p>
--	--

All dimensions in metres Scale 1:46.25	Client <b>Axiom Project Services Limited</b>	Method/ Plant Used <b>JCB 3CX</b>	Logged By <b>MH</b>
---	---	---	------------------------

AGS3 UK TP LOGS.GPJ AGS3\_ALL.GDT 27/6/17



Solum House, Unit 1 Elliott Court  
 St Johns Road, Meadowfield  
 Durham, DH7 8PN  
 Telephone: 01913786380

## TRIAL PIT LOG

Project <b>Sheriffhall South East, Gilmerton Road, Lasswade, EH18 1BD</b>				<b>TRIAL PIT No</b>  <b>TP15</b>
Job No <b>17-115</b>	Date <b>02-05-17</b>	Ground Level (m)	Co-Ordinates ( )	
Contractor <b>Arc Environmental Limited</b>				Sheet <b>1 of 1</b>

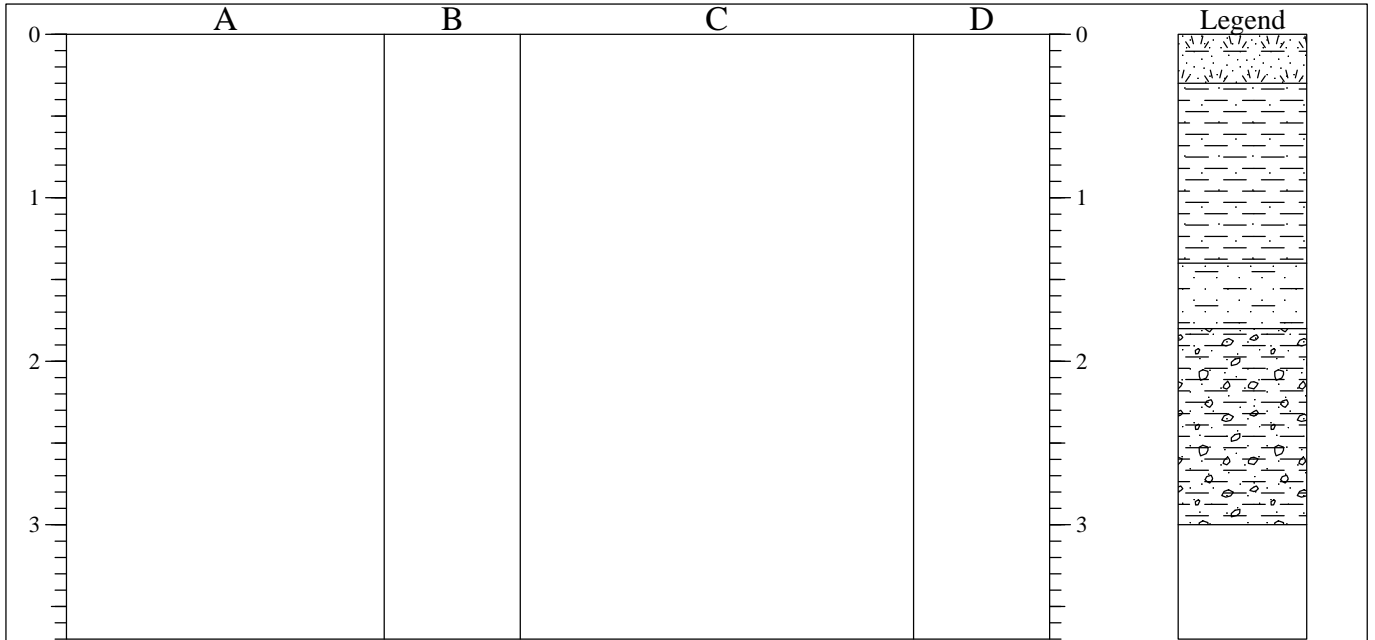

STRATA			SAMPLES & TESTS		
Depth	No	DESCRIPTION	Depth	No	Remarks/Tests
0.00-0.30		Crops overlying light grey brown sandy slightly gravelly CLAY (TOPSOIL).	0.10-0.20	J/D	30kN/m <sup>2</sup>
0.30-1.40		Soft and firm (low strength) orange brown initially grey mottled slightly sandy CLAY (GLACIOFLUVIAL DEPOSITS).	0.50 0.60-0.80	V B	
1.40-1.80		Grey brown clayey silty fine to medium SAND (GLACIOFLUVIAL DEPOSITS).	1.50-1.60	B	58kN/m <sup>2</sup>  >120kN/m <sup>2</sup>
1.80-3.00		Initially soft becoming stiff (medium and high strength) purple brown silty slightly gravelly sandy CLAY. Gravel is subangular to rounded fine to coarse of sandstone and mudstone (GLACIAL TILL).	1.70-1.80	B	
			2.00-2.10 2.00	B V	
2.50	V				
3.00		Trial pit completed to a depth of 3.00m.	2.90-3.00	B	

<p>Shoring/Support: Stability: Stable</p> <div style="text-align: center;"> </div>	<p><b>GENERAL REMARKS</b></p> <p>WATER OBSERVATIONS: Slight seepage noted at a depth of 1.80m.</p>
--	--

All dimensions in metres Scale 1:46.25	Client <b>Axiom Project Services Limited</b>	Method/ Plant Used <b>JCB 3CX</b>	Logged By <b>MH</b>
---	---	---	------------------------

AGS3 UK TP LOGS.GPJ AGS3\_ALL.GDT 27/6/17



Solum House, Unit 1 Elliott Court  
 St Johns Road, Meadowfield  
 Durham, DH7 8PN  
 Telephone: 01913786380

## TRIAL PIT LOG

Project <b>Sheriffhall South East, Gilmerton Road, Lasswade, EH18 1BD</b>				<b>TRIAL PIT No</b>  <b>TP16</b>
Job No <b>17-115</b>	Date <b>02-05-17</b>	Ground Level (m)	Co-Ordinates ( )	
Contractor <b>Arc Environmental Limited</b>				Sheet <b>1 of 1</b>

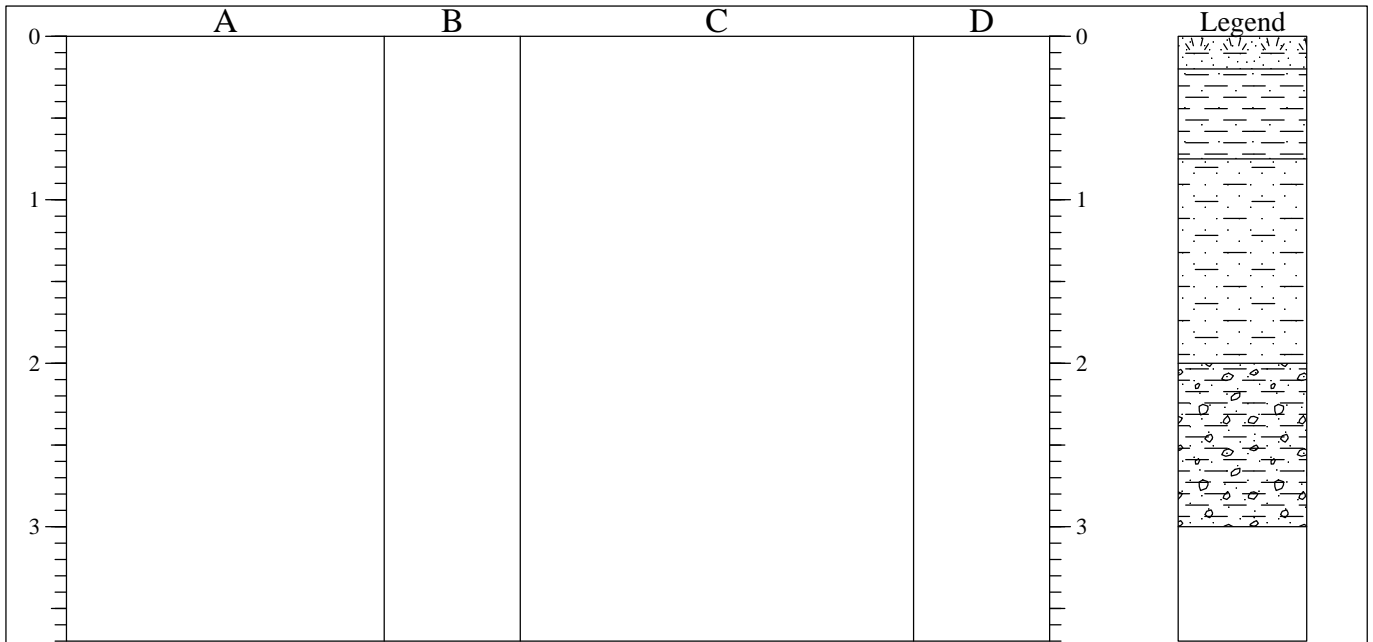

STRATA			SAMPLES & TESTS		
Depth	No	DESCRIPTION	Depth	No	Remarks/Tests
0.00-0.20		Crops overlying light grey brown sandy slightly gravelly CLAY (TOPSOIL).	0.05-0.15	J/D	32kN/m <sup>2</sup>          >120kN/m <sup>2</sup>
0.20-0.75		Soft and firm (low strength) orange brown initially grey mottled slightly sandy CLAY (GLACIOFLUVIAL DEPOSITS).	0.40-0.50	B	
			0.50	V	
0.75-2.00		Grey brown clayey slightly sandy fine to medium SAND (GLACIOFLUVIAL DEPOSITS).	0.80-1.00	B	
		1.30 Becoming orange brown.	1.50-1.70	B	
2.00-3.00		Firm becoming stiff (high strength) purple brown slightly sandy gravelly CLAY. Gravel is subangular to rounded fine to coarse of sandstone and mudstone (GLACIAL TILL).	2.30-2.50	B	
			2.70	V	
3.00		Trial pit completed to a depth of 3.00m.	2.80-3.00	B	

<p>Shoring/Support: Stability: Stable</p> <div style="text-align: center;"> </div>	<p><b>GENERAL REMARKS</b></p> <p>WATER : Slight seepage noted at a depth of 1.90m.</p>
--	--

All dimensions in metres Scale 1:46.25	Client <b>Axiom Project Services Limited</b>	Method/ Plant Used <b>JCB 3CX</b>	Logged By <b>MH</b>
---	---	---	------------------------

AGS3 UK TP LOGS.GPJ AGS3\_ALL.GDT 27/6/17