

This copy has been made by or with the authority of Midlothian Council pursuant to Section 47 of the Designs and Patents Act 1988. Unless that Act provides a relevant exception to copyright, the copy must not be copied without the prior permission of the copyright owner.

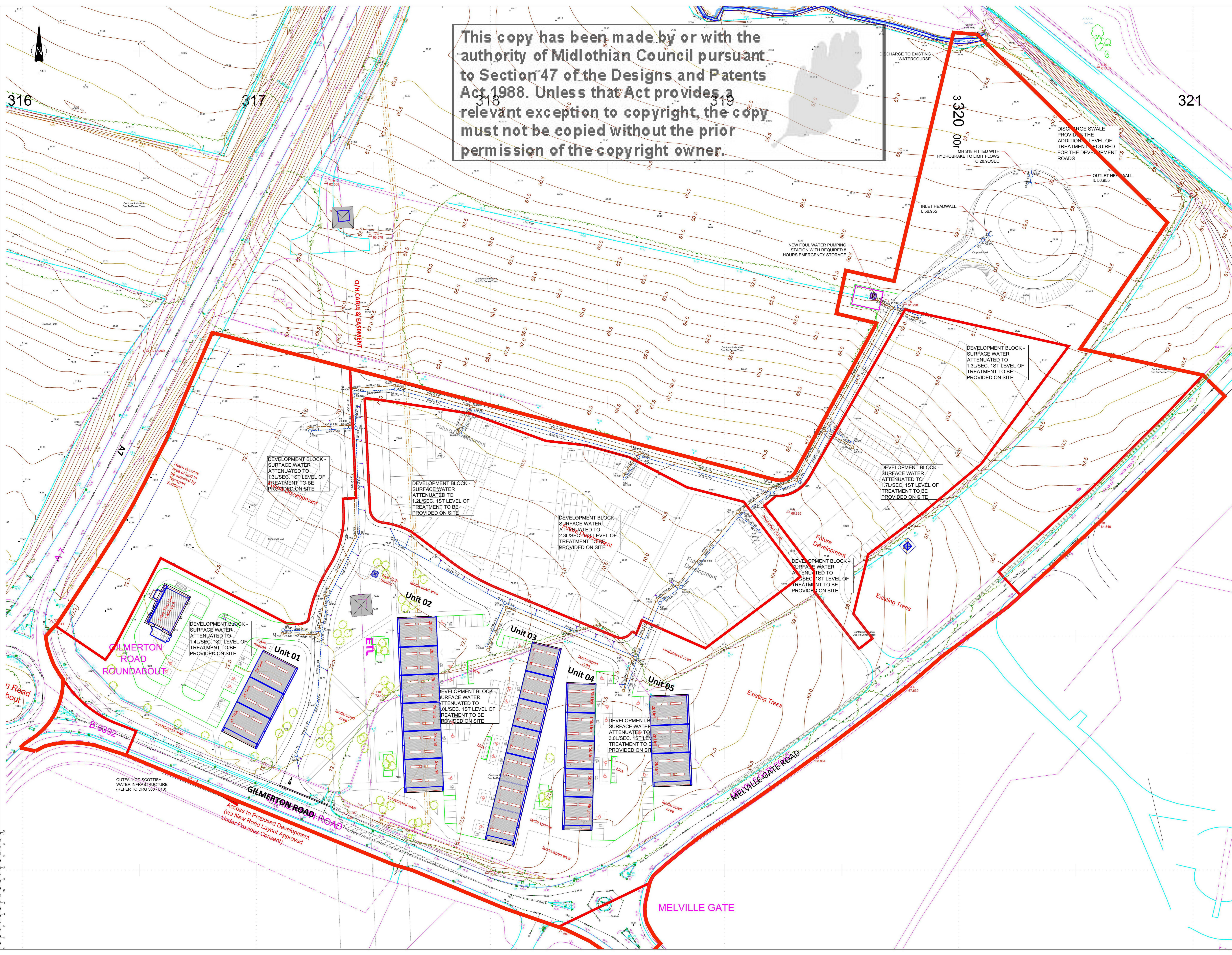

NOTES

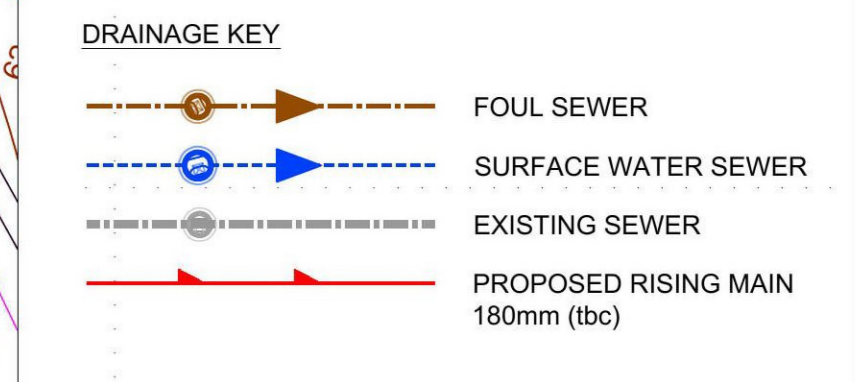

IMPORTANT
HEALTH, SAFETY & ENVIRONMENTAL INFORMATION

IN ADDITION TO THE HAZARDS AND RISKS NORMALLY ASSOCIATED WITH THE TYPE OF WORK DETAILED ON THIS DRAWING, PLEASE NOTE THE FOLLOWING ADDITIONAL RISKS TO HEALTH AND SAFETY:

CONSTRUCTION PHASE:
• NO UNUSUAL RISK

IT IS ASSUMED THAT ALL WORKS WILL BE CARRIED OUT BY A COMPETENT CONTRACTOR WORKING, WHERE APPROPRIATE, TO AN APPROVED METHOD STATEMENT.

REV	AMENDMENTS	BY	CHKD	APPROV	DATE
0					



CLIENT: BUCCLEUGH PROPERTY

PROJECT: PROPOSED MIXED USE DEVELOPMENT SHERIFFHALL SOUTH

TITLE: PROPOSED SITE DRAINAGE LAYOUT INCLUDING SUDS

STATUS: INFORMATION

DRAWN	CHECKED	APPROVED
RD	MF	-
DATE: Nov 2021	DATE: Nov 2021	DATE:
DRAWING SCALE: 1:500	ORIGINAL DRAWING SIZE: 1189 x 841 - A0	
DRAWING NO: 4536 - 300 - 001	REV: 0	