

This copy has been made by or with the authority of Midlothian Council pursuant to Section 47 of the Designs and Patents Act 1988. Unless that Act provides a relevant exception to copyright, the copy must not be copied without the prior permission of the copyright owner.

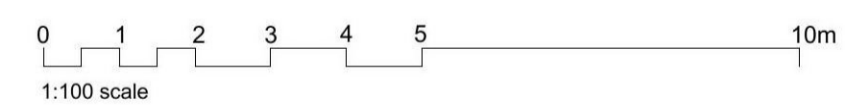
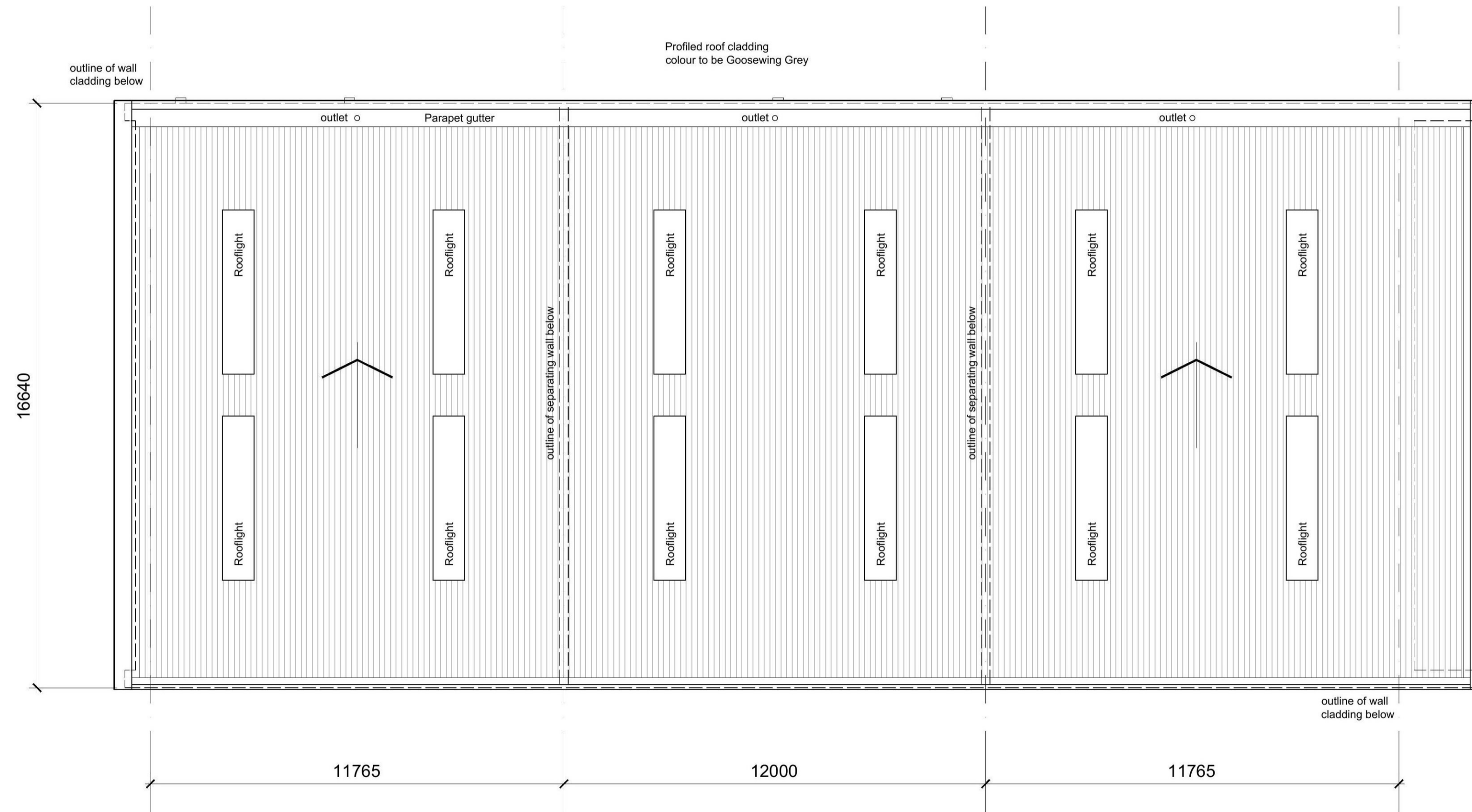

HALLIDAY FRASER MUNRO
CHARTERED ARCHITECTS & PLANNING CONSULTANTS

Project:
Proposed Mixed Use Development
Sheriffhall South East

Client:
Buccleuch Property

Title:
Unit 01
Roof Plan

| Document Reference | | | | | | |
|--------------------|---------------|--------|------------------|------|----------|----------------|
| Project Code | Original Code | Volume | Location / Level | Type | Revision | Drawing Number |
| 11658 | HFM | - ZZ | - ZZ | - DR | - A | P(20) 103 |

Drawing Status: Planning
Scale: 1:100 @ A1
Revision: [blank]
Date: Sept 2021

Do not scale this drawing.
Ordnance Survey material is reproduced with the permission of the controller of her Majesty's Stationery Office Crown Copyright reserved.
The copyright of this drawing subsists in Halliday Fraser Munro Ltd.

Registered Office:
8 Victoria Street,
Aberdeen, AB10 1XB
T: 01224 388 700
E: info@hfm.co.uk
W: hfm.co.uk