

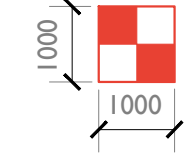

Notes:
Drawings are based on survey data and may not accurately represent what is physically present.
Do not scale from this drawing **unless for planning purposes**. All dimensions are to be verified on site before proceeding with the work.
All dimensions are in millimeters unless noted otherwise.
Purcell shall be notified in writing of any discrepancies.

Note:
The following summarises the purpose of the investigations in each area. These are to be read with the scope and methodology key below:

- A** - To determine extension of west wing from early to mid 19th century, demolished in the 1930's.
- B** - To determine extent of early to mid 19th century construction fabric vs 1890's stone over-clad addition.
- C** - To determine remaining fabric from original Nash Service wing following upward extension and subsequent demolition in the 1930's.
- D** - To determine roof structure above corrugated sheets.
- E** - To determine structural foundation and/or wall build up within existing footprint (non original Nash footprint).

Investigation Scope and Methodology Key:

-  - 1.0x1.0m (plan size) trial pit to establish depth and profile of the existing foundation. Depth of foundation unknown. Trial pit to be dug to a depth 100mm lower than the existing foundation. Where digging pits next to existing brick footings care is to be taken to ensure that the brick corbels are not damaged during excavation. External finishes to be carefully set aside for reinstatement on completion of the investigation.
-  - 0.5x2.0m (plan size) trial pit to establish depth and profile of historic foundation to previously demolished 'west wing'. Depth of foundation unknown. Trial pit to be dug to a depth 100mm lower than the existing foundation. Where digging pits next to existing brick footings care is to be taken to ensure that the brick corbels are not damaged during excavation. Allow for reinstating the turf on completion of the investigation.
- 1** - Wall finishes to be carefully removed each side of the wall to determine wall construction. 50mm diameter core to be made through the full depth of the wall to confirm thickness and build-up. (Where investigation is proposed to external wall no finishes are to be removed). Finishes to be reinstated and made good on completion of the investigation. External holes are to be filled using the core and sealed in mortar.
- 2** - Carefully remove floor finish and set aside. Lift floor boards to expose a minimum of 3No. timber floor joists. There must be sufficient access to measure the width, depth and spacing of the joists. Replace boards and finishes on completion of the investigation.
- 3** - Carefully remove 0.5x0.5m of the ceiling to determine construction of floor over. allow for drilling through slab to confirm thickness - removing floor finishes as required to prevent any damage. Ceiling and floor finishes to be reinstated on completion of investigation.
- 4** - Carefully remove floor finish and set aside. If timber floor - Lift floor boards to expose a minimum of 3No. timber floor joists. If concrete floor - allow for drilling through slab to confirm thickness and if there is a void below. Replace boards and finishes on completion of the investigation.
-  - Existing hardwood flooring to be re-polished and/or stained to a darker tone. Refer to proposals set out in the Schedule of Interior Finishes and photographs of the sample in the DASHIA report.

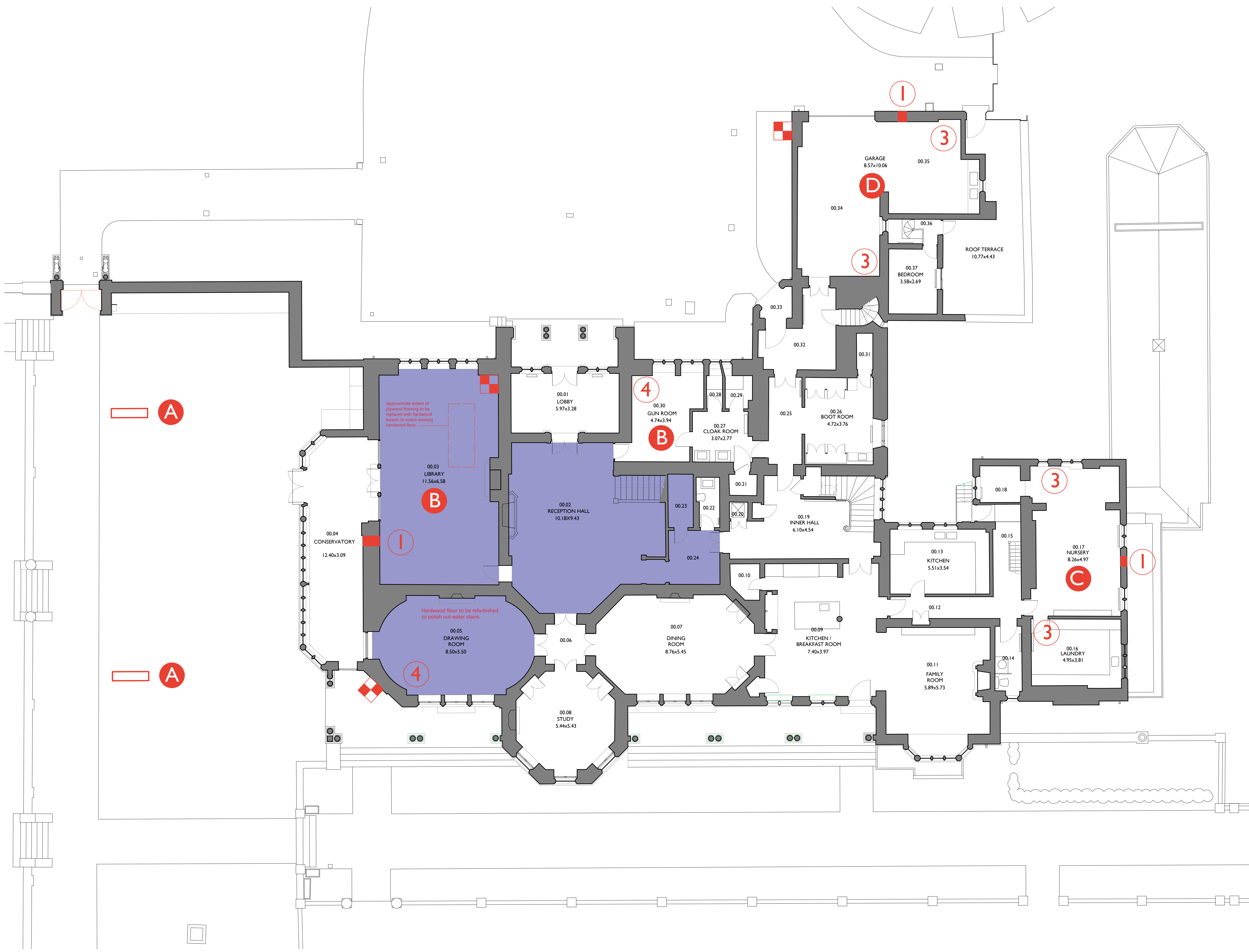

P01	17/12/2021	FF	DZ	P01.01
REV	DATE	BY	CHK	DESCRIPTION

CLIENT
Ropemaker Property Limited

PROJECT
Hollycombe Estate

JOB NUMBER
241179



TITLE
**Opening Up_Decor Ground Floor Plan
As Proposed
Hollycombe House**

SIZE	SCALE	LAST REVISED	DRAWN	CHECKED
A1L	1:100	17/12/2021	FF	DZ
REV	SUITABILITY/REASON FOR ISSUE			
P01	S4 - Planning			
DRAWING NAME				
241179-PUR-01-GF-DR-A-2100				

I Ground Floor Plan_Proposed Opening Up Works / Decoration
2100 1:100 @ A1

