

**ELEVATION 01**  
SCALE - 1:50

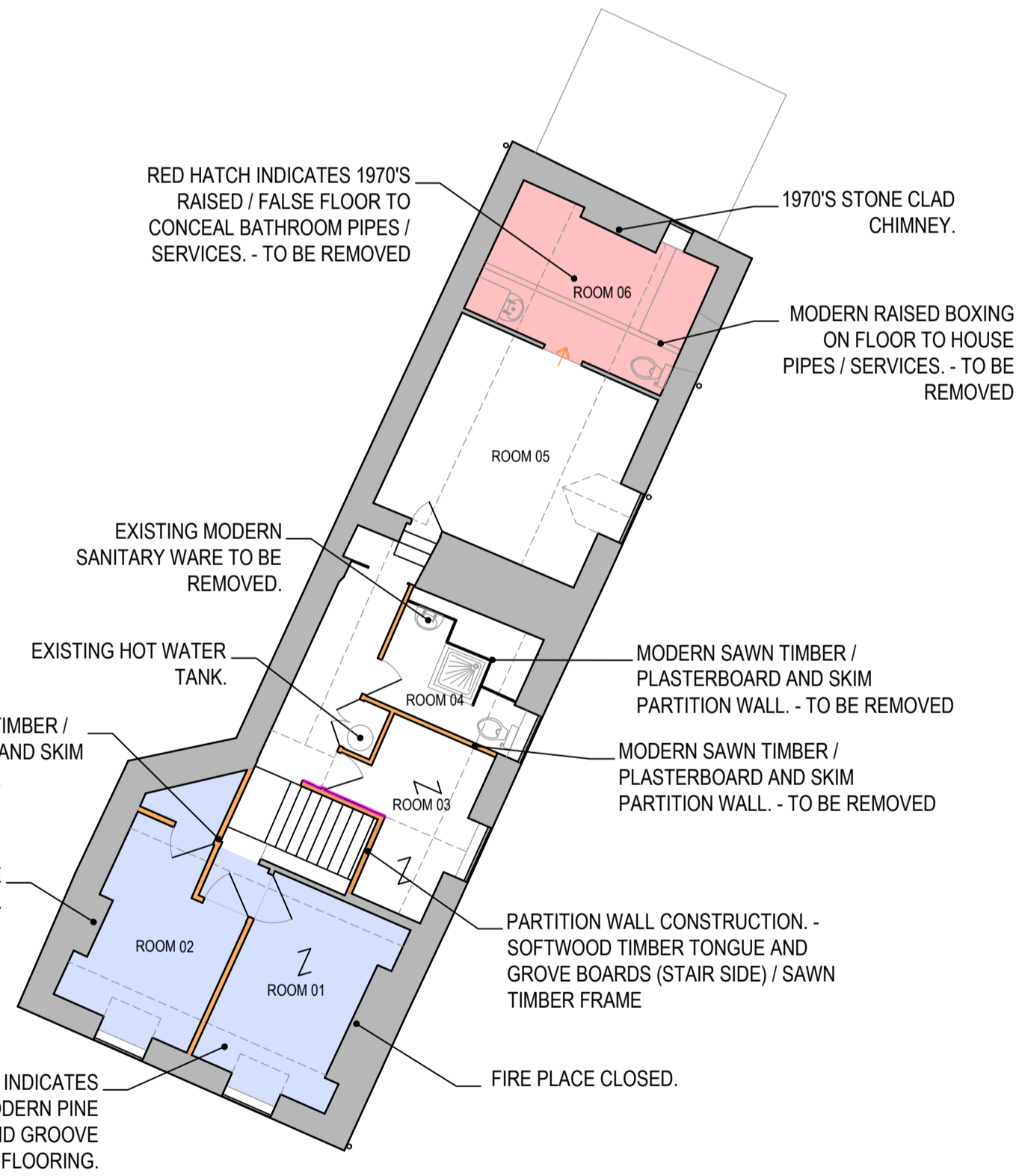

**FIRST FLOOR PLAN**  
SCALE - 1:100



**GROUND FLOOR PLAN**  
SCALE - 1:100

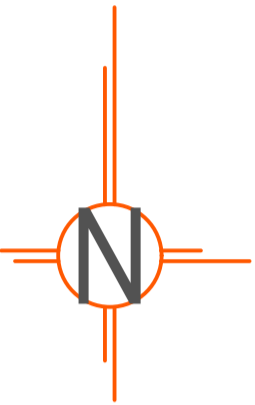

- KEY**
- DIRECTION OF TIMBER FLOOR JOISTS
  - MODERN SAWN TIMBER / PLASTERBOARD AND SKIM PARTITION WALL
  - STONE & LARGE TERRACOTTA TILES
  - (SF) - SOLID FLOOR
  - (PC) - PLASTERBOARD CEILING
  - POINTED STONE WALL
  - PLASTERBOARD FACE



B 05.01.22 REVISED PLANNING APPLICATION  
A 11.08.21 AMENDED IN ACCORDANCE WITH CLIENT COMMENTS

Revisions	
Project	12 Main Street Bulwick NN17 3DY

Drawing  
**EXISTING - Plans**

**Harris McCormack Architects**  
harrismccormackarchitects.co.uk

ArcHaus Peterborough Road Wansford PE8 6JN  
t 01780 433 334 architects@harrismccormack.co.uk

Date	Scale	Drawn
23/06/21	VRS @ A1	
Job No.	Drawing No.	Revision
20-965	(08)002	B

This drawing is the copyright of Harris McCormack Architects. The contractor is to check and verify all dimensions on site before proceeding with the works. If you are in doubt with any of the information on this drawing, ask for it to be verified. Do not scale from this drawing. To be noted.