

VELUX WINDOWS:

ALL NEW WINDOWS TO BE DOUBLE GLAZED WITH LOW E GLASS (4:16:4 MIN) AND FITTED IN ACCORDANCE WITH MANUFACTURES INSTRUCTIONS, TRIMMED BOTH SIDES WITH DOUBLE RAFTERS WITH TRIMMERS ABOVE AND BELOW.

FLAT ROOF:

GRP ROOFING SYSTEM ON 126MM CELOTEX TD4000 INSULATION ON POLYTHENE VAPOUR BARRIER ON 18MM EXTERIOR PLYWOOD. TAPERED FIRINGS WITH 1:40 FALL ON 47 X 147 C16 ROOF JOISTS AT 400 C/C. FINISHED INTERNALLY WITH 9.5mm PLASTERBOARD AND SKIM COAT PLASTER.

WINDOWS & VENTILATION:

ALL NEW WINDOWS AND DOORS TO BE DOUBLE GLAZED (4:16:4 MINIMUM) USING LOW E GLAZING, MIN U VALUE 1.6, (WER C OR BETTER) WITH SILL HEIGHT SET 800mm MINIMUM ABOVE FLOOR LEVEL, HABITABLE ROOMS TO BE PROVIDED WITH RAPID VENTILATION 1/20th OF ROOM AREA AND 8000mm² BACKGROUND VENTILATION. KITCHEN TO HAVE BACKGROUND VENTILATION OF 8000mm² AND FITTED WITH A MECHANICAL EXTRACTOR TO ACHIEVE 60 L/S EXTRACTION. UTILITY EXTRACT 30 L/SEC.

PLUMBING:

SINK AND APPLIANCE WASTE PIPES TO BE 40mm DIAMETER, RUNS OVER 4 METRES TO BE 50mm DIAMETER ALL CONNECTED SEPARATELY VIA 75mm DEEP SEAL TRAPS TO EXISTING S.V.P. OR NEW 110mm COMMON BRANCH PIPE (1:40 FALL), CLEANING ACCESS TO BE PROVIDED AT CHANGE OF PIPE DIRECTION. CONNECTIONS TO S.V.P. TO BE AT LEAST 200mm FROM W.C. BRANCH.

ELECTRICAL WORKS:

ALL ELECTRICAL WORK REQUIRED TO MEET THE REQUIREMENTS OF PART P (ELECTRICAL SAFETY) MUST BE DESIGNED, INSTALLED, INSPECTED AND TESTED BY A PERSON COMPETENT TO DO SO. A BS 7671 ELECTRICAL INSTALLATION CERTIFICATE IS TO BE ISSUED RELATING TO THE WORKS BY A COMPETENT PERSON.

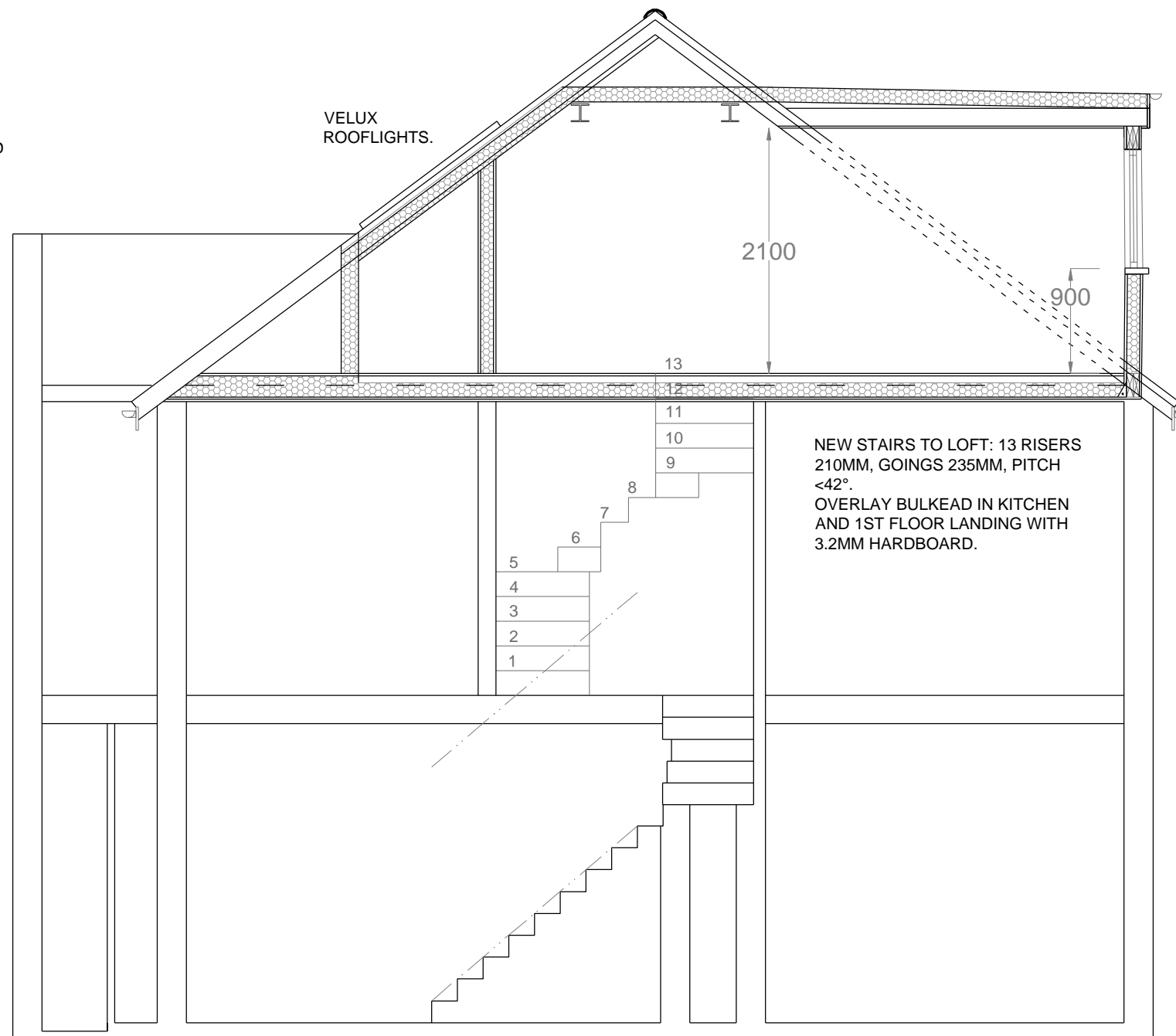

WARM DECK ROOF: ASPHALT COVERED OR GRP. 150 X 50MM JOISTS C24 @ 400MM CENTRES, FOR SPANS UP TO 3.2M. LR STRAPS @ 1500MM CENTRES. 125MM KINGSPAN THERMAROOF TR27 INSULATION BOARD. 150MM HIGH LEAD FLASHING AT JUNCTION WITH WALLS.

OVER WINDOWS: 2 NO. 150 X 50MM C24 BOLTED JOISTS (AT 900MM CENTRES), SUPPORTED ON 2 150 X 50MM C24 STUDS EITHER SIDE. WINDOW CILL HEIGHT 900MM. (125 X 6MM FLITCH PLATE RECOMMENDED OVER DOORS OR LARGER WINDOWS TO LIMIT DEFLECTION).

DOUBLE GLAZED WINDOWS WITH LOW E GLAZING. WHOLE UNIT TO ACHIEVE A U-VALUE OF 1.6W/M²K.

21MM T & G FLOORBOARDS ON C24 JOISTS SUPPORTED ON "SIMPSON" STRONG TIE HANGERS. NEW FLOOR CONSTRUCTION HUNG BETWEEN EXISTING CEILING CONSTRUCTION TO MINIMISE FLOOR DEPTH.

86 MANOR DR., WORCESTER PARK, KT4 7LL 450
CLIENT: MR & MRS CAREW-GIBBS

SURVEY DATE: 23/04/21 ISSUE DATE: 11/01/21	
PROJECT: LOFT CONVERSION	DRAWN BY: CG
DRAWING TITLE: PROPOSED SECTION	REVISION: DATE:
<input type="checkbox"/> Full planning <input type="checkbox"/> Prior Approval <input checked="" type="checkbox"/> Permitted Development	<input type="checkbox"/> Building Control <input type="checkbox"/> Draft <input type="checkbox"/> Other
SCALE: 1:50 / A3	
DWG NO: 07	

Verify all dimensions on site before commencing any work or shop drawings. Allow 50mm for tolerance to all dimensions.

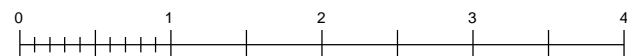

Regal Builders
77 Chalkshire Road
Butlers Cross
Aylesbury
Bucks HP17 0TJ