

0 10m 20m

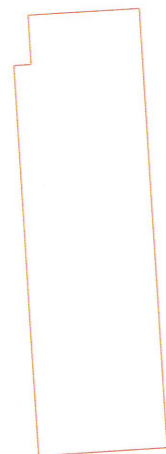

Vegetation / hedge line within verge to be cut back to ensure visibility to right of proposed access is not impeded.

Existing access to be removed

Existing map type direction sign

Existing lane designation signs to be removed, posts to remain and new signs above to be installed on existing posts

Killingwoldgraves Lane

SITE ENTRY/ EXIT

R12.0m

R6.0m

R34.9m

3.5m

3.5m

3.5m

3.5m

3.5m

3.5m

3.5m

3.5m

3.5m

3.5m

3.5m

3.5m

3.5m

3.5m

3.5m

3.5m

3.5m

3.5m

3.5m

3.5m

3.5m

3.5m

3.5m

3.5m

3.5m

3.5m

3.5m

3.5m

3.5m

3.5m

3.5m

3.5m

3.5m

3.5m

Minor amendment to splitter island to accommodate 2 lane approach

Killingwold Cottage

Killingwoldgraves Farm

A1079

Pond

KEY:

- Proposed kerb line
- Proposed carriageway widening
- Proposed road markings
- Proposed edging kerb line
- Proposed footway widening
- ERYC Killingwoldgraves Roundabout New Layout
- Existing road markings
- Site Entry / Exit - Available visibility to right 4.5m x 215m
- Site Entry / Exit - Available visibility to left 4.5m x 112.8m and tangential visibility envelope
- 90m stopping sight distance measured at 1m offset from nearside kerb line of southbound lane.
- Extents of hedge line to be removed and relocated to ensure visibility splays are maintained.

NOTES:

1. Preliminary Design Layout Only. Scheme subject to further detailed design (inc. drainage design).
2. Scheme subject to Statutory Undertakers Apparatus Search
3. Scheme drawing subject to OS Mapping which may not be 100% accurate.

Client	Level Developments Ltd
Project	Proposed Petrol Filling Station & Employment Development Killingwoldgraves Lane, Bishop Burton

Proposed Ghost Island Junction Based on 70kph (40mph) Design Speed Visibility Splays				
Rev.	Date	By	Chk	Description
B	13 05 20	OA	TK	Amended existing access annotation in response to client comment.
C	03 06 20	CW	TK	Amendments in line with ERYC comments.

Disclaimers:-

- i. This drawing is copyright and must not be copied in part or in whole unless agreed in writing by Local Transport Projects Ltd.
- ii. Reference should be made to the project's drawing register to ensure the latest drawing is being referred to.
- iii. All dimensions are to be checked by the contractor prior to commencement of work. Any discrepancy shall be reported immediately to Local Transport Projects Ltd.

iv. All work shall be carried out in accordance with local authority, statutory authority and health & safety requirements & regulations.

v. This drawing is produced to be printed and read in colour. Reproduction in black and white may prevent correct interpretation of some aspects.

Based on OS mapping supplied by the Client and OS mapping
© Crown Copyright and Database Rights 2020.
Ordnance Survey 0100031673

Drawn	CW	Date	31 01 2020
Scale	1 : 1000	Checked	JH
Status	PRELIMINARY		
Drawing number	A3		
Project	LTP/4030/T1	Drawing	02
Job	02	Sheet	02
Revision	C		

© Local Transport Projects

local transport projects
traffic engineering and transport planning

INSTITUTE OF HIGHWAY ENGINEERS
25 000

Armstrong House,
The Flemington Centre,
Beverley,
East Riding of Yorkshire.
HU17 0NW.

01482 679 911
info@local-transport-projects.co.uk
www.local-transport-projects.co.uk
Registered No. 5295328