

Important

The contractor will be held to have examined the site and checked all dimensions and levels before commencing construction work. No assumption should be made without reference to the architect. No dimensions should be scaled from this drawing.

| Revision | Date | By |
|----------|------|----|
|          |      |    |

- GENERAL**
- Drawings and areas are indicative only and are subject to a full measured site survey.
- All materials to be installed fully in accordance with the manufacturers recommendations.
- All construction to be carried out in accordance with all the relevant current Health and safety guidelines and regulations.
- All works to comply with the latest building Scotland Regulations and to the satisfaction of Building Control
- All electrical works to comply with the latest edition of the I.E.E Regulations
- Do not scale drawing.

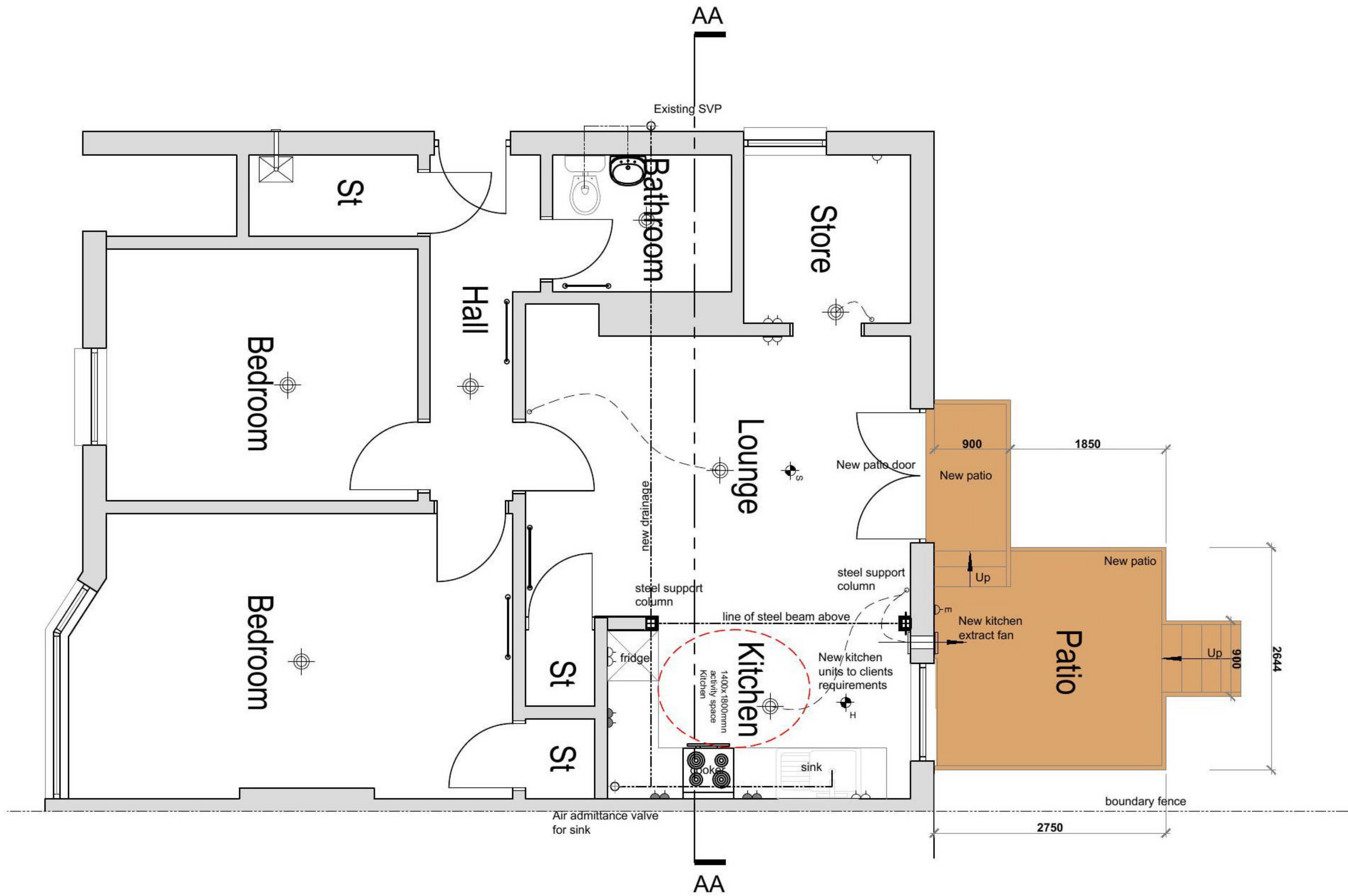

## Planning Approval

Client

Ailsa Gollan

Project Title

Proposed Internal Kitchen Alterations  
202 Chirnside Road, Hillington,  
Glasgow G52 2LQ

Drawing Title

Plan Proposed

**Architectural Design Ltd**  
Complete Bespoke Architectural Services

5 Cherrybank Walk, Airdrie  
North Lanarkshire ML6 0HZ

Scale

1:50

Date

Dec 2021

|           |             |      |
|-----------|-------------|------|
| Job No.   | Drawing No. | Rev. |
| A1-681/21 | L (2-) 004  | -    |

Ground Floor Plan As Existing  
scale @ A3