

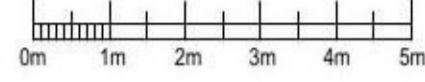

Front Elevation (1:100 @ A1)

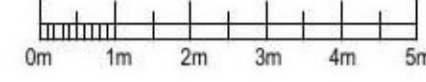

Side Elevation (1:100 @ A1)



Rear Elevation (1:100 @ A1)

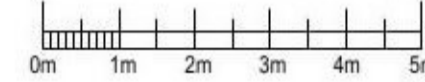

Side Elevation (1:100 @ A1)

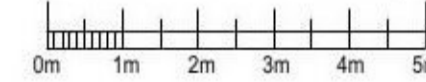

WALLS - Off white roughcast with partial areas of oak vertical cladding

WINDOWS - Anthracite grey uPVC Windows

ROOFLINE - Anthracite grey uPVC

ROOF - Natural slate roof finish

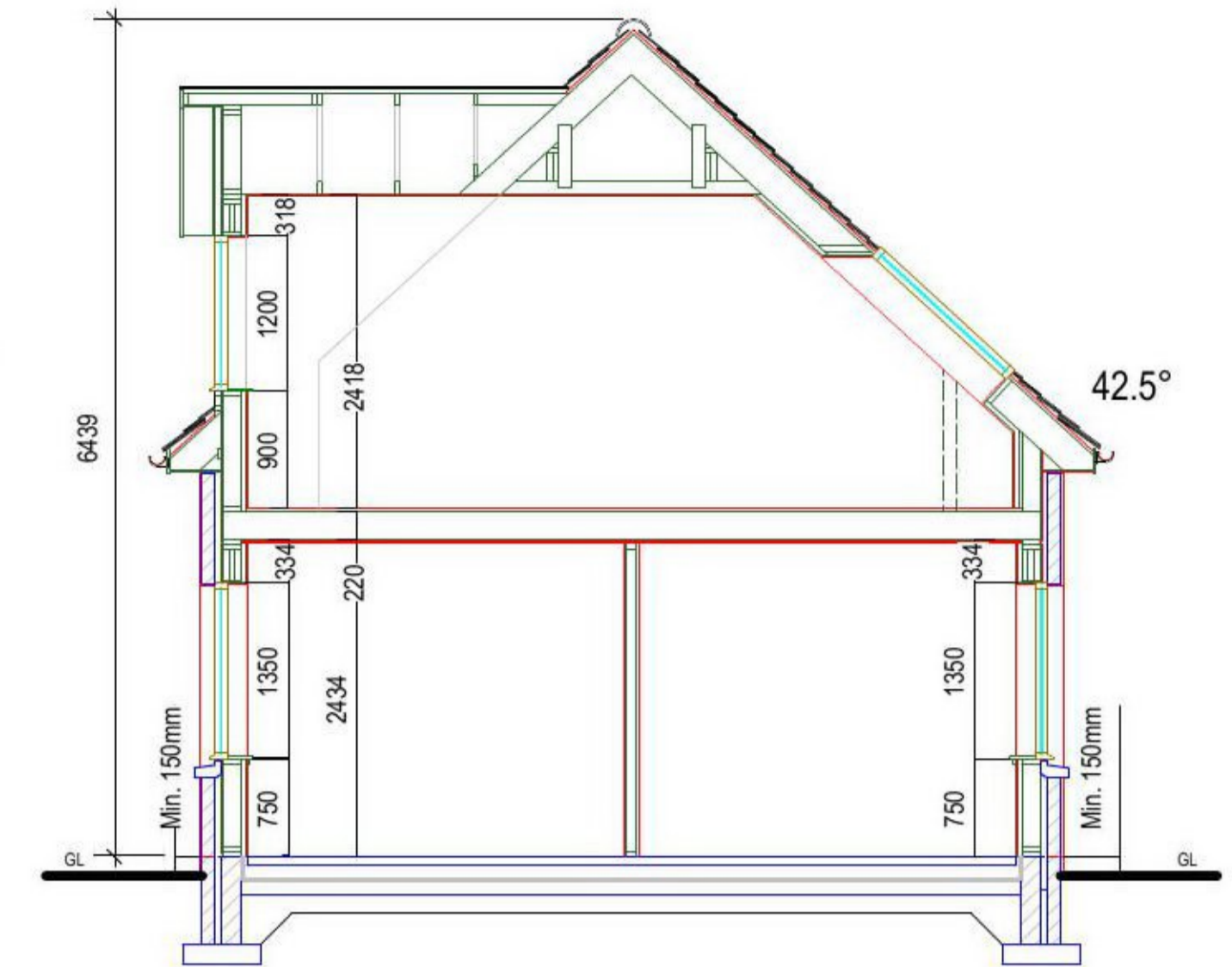

Section (1:50 @ A1)

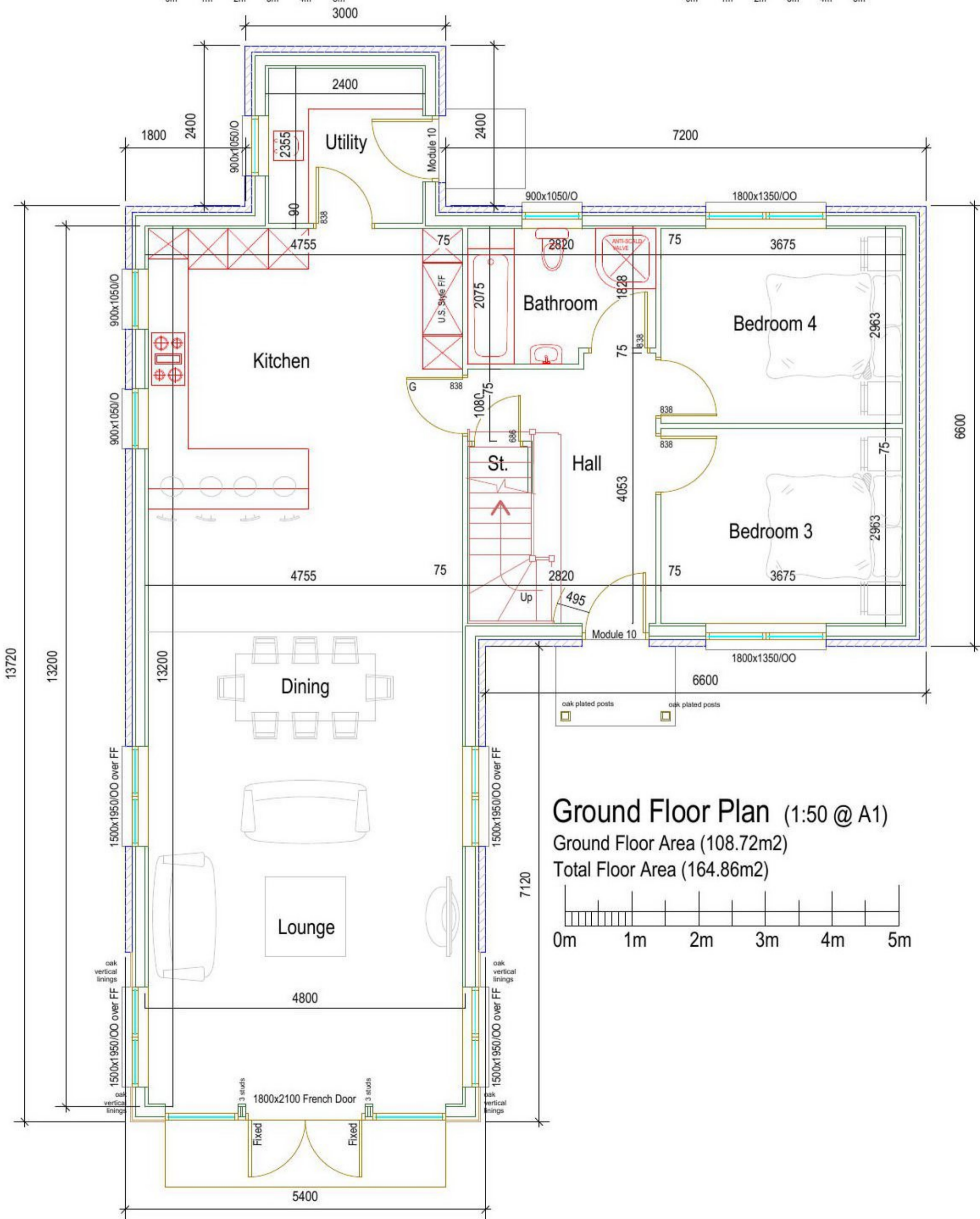
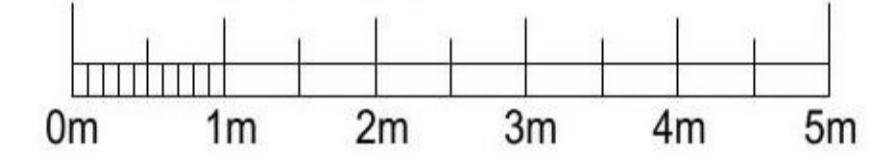

Ground Floor Plan (1:50 @ A1)

Ground Floor Area (108.72m²)
Total Floor Area (164.86m²)

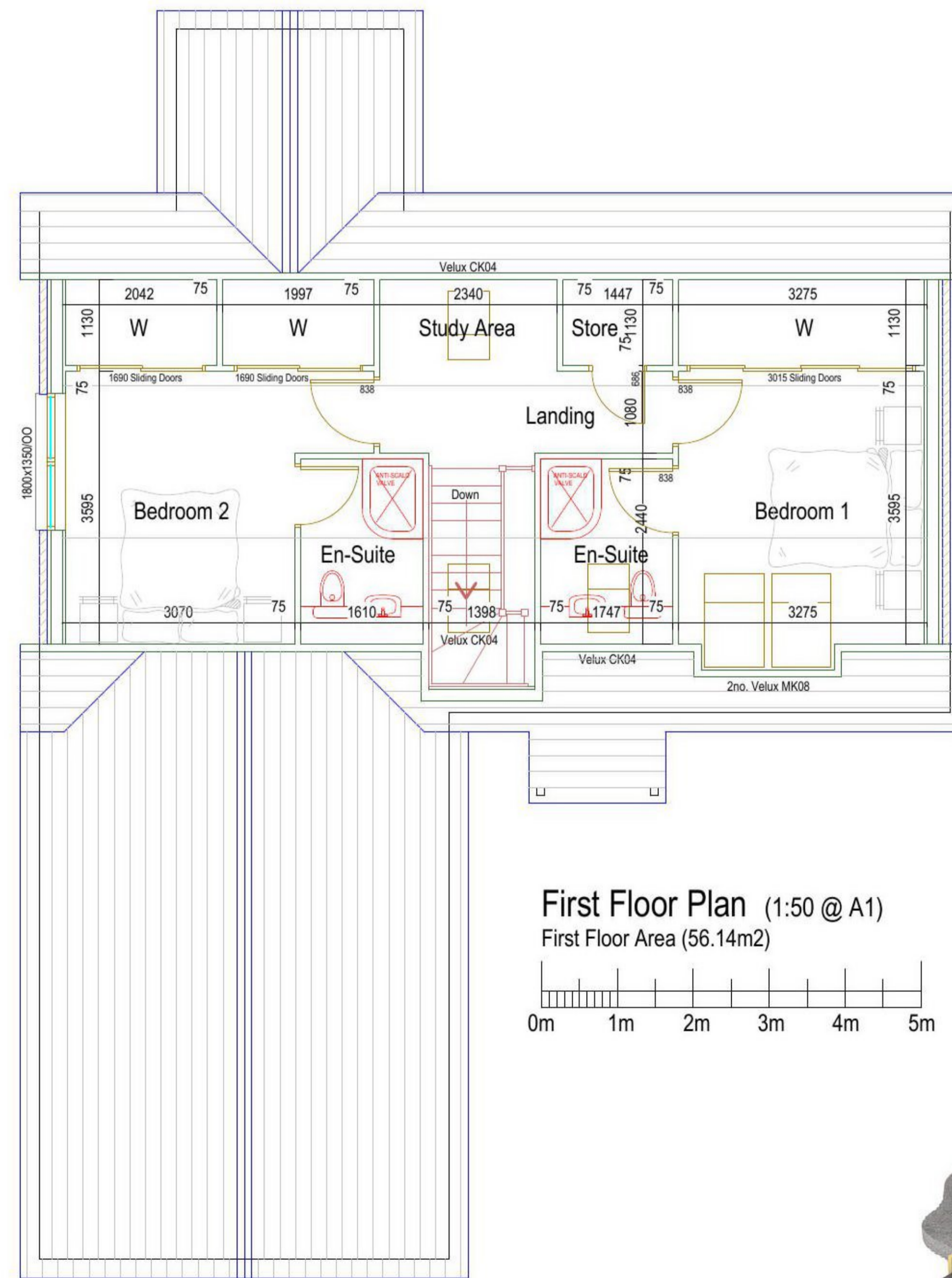
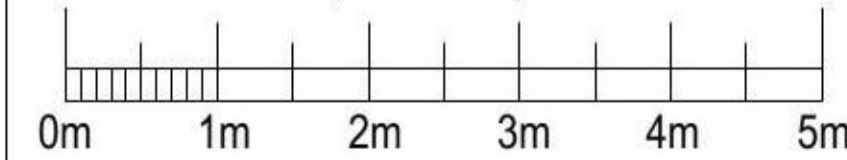

First Floor Plan (1:50 @ A1)

First Floor Area (56.14m²)

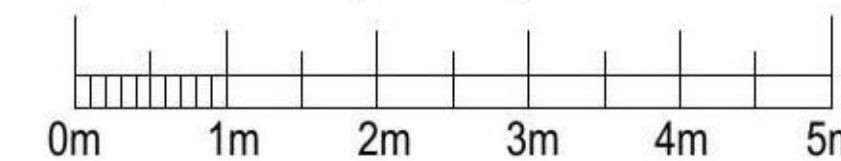

COPYRIGHT:
THIS DRAWING IS COPYRIGHT & CANNOT BE COPIED IN WHOLE OR IN PART
WITHOUT THE WRITTEN CONSENT OF SCOTFRAME TIMBER ENGINEERING LIMITED.

B	Section added for planning	01/11/21
A	Vertical cladding / cladding amended / four lounge windows, 150mm above FFL	11/10/21
Rev		Date

Client: **John Wood**

Site: **Proposed New House,
Spey (amended) House Type,
King Street, Bradfield**

scotframe
timber frame | engineering

SCOTFRAME TIMBER ENGINEERING LTD, INVERURIE BUSINESS PARK,
CROFTFORD AVENUE, INVERURIE, ABERDEENSHIRE, AB51 0ZJ

Also A11:
4 GRAYSHILL ROAD, WESTFIELD, CLIPSHALD G68 9HD

scales:	drawn:	date:	Dwg No:	rev:
1:50, 100 @ A1	A Smilie	Aug 2021	SF31117.1.P1	B

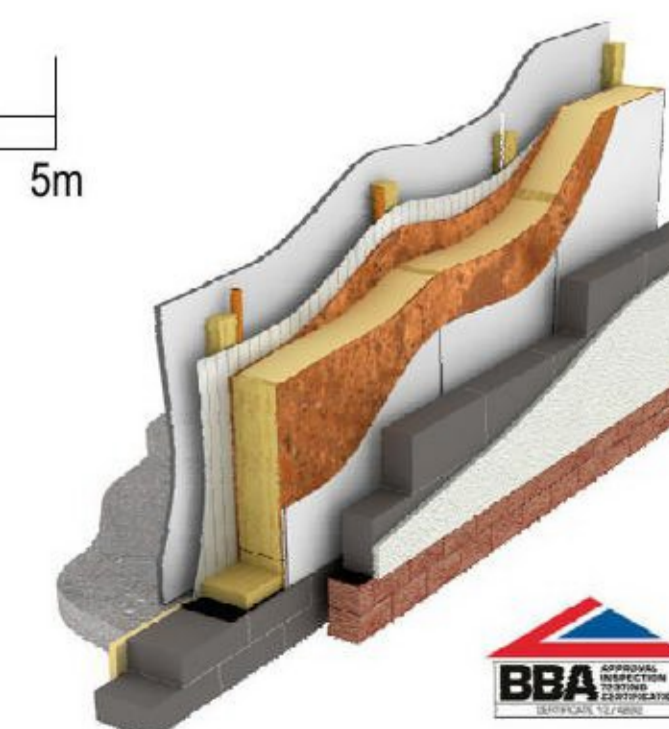

Val-U-Therm