

Gross area
 Living / Kitchen
 4.5m x 8.20m = 36.9 sq.m.
 Shower room
 1.6m X 2.08m = 3.32 sq.m.
 Utility room
 1.6m x 3.67m = 5.87 sq.m.

Additional internal area
 Living / Kitchen
 4.2m x 7.75m = 32.55 sq.m.
 Shower room
 1.3m X 1.99m = 2.458 sq.m.
 Utility room
 1.3m x 3.38m = 4.38 sq.m.

Gross area
 Living / Kitchen
 4.5m x 8.20m = 36.9 sq.m.
 Shower room
 1.6m X 2.08m = 3.32 sq.m.

Additional internal area
 Living / Kitchen
 4.2m x 7.75m = 32.55 sq.m.
 Shower room
 1.3m X 1.92m = 2.47 sq.m.
 Utility room
 3.12m x 2.38m = 7.14 sq.m.

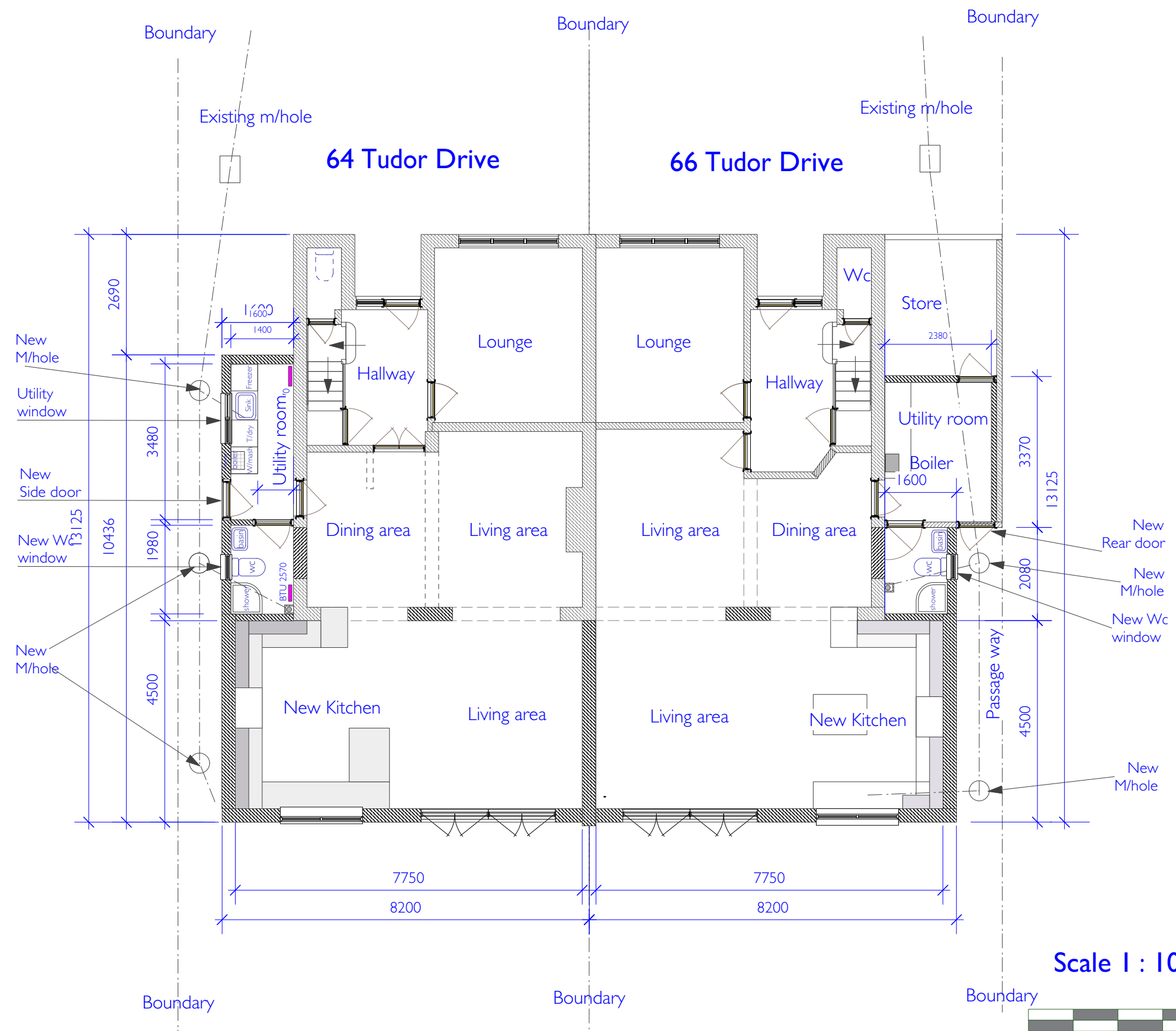

Scale 1 : 100 New ground floor plan

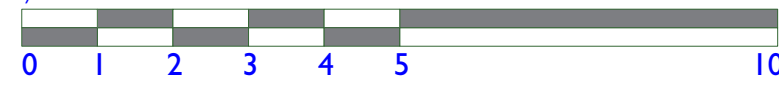

Holdsworth Designs
 12 Greentrees Avenue, Tonbridge, Kent, TN10 4ND
 Tel. 07740 320081
 Email: martynholdsworth@gmail.com

Client	Mr. James Ashcroft & Mr. Tom Knight	Address	64 / 66 Tudor Drive Otford Kent TN14 5QR	Scale	1 : 100	Drawing Title	New Gr. fl. Plan Added labeling Revised 24.01.2022	Drawing Number	21/14.08
Project	Kitchen & Dayroom extension			Drawn by	MGH	Date			