

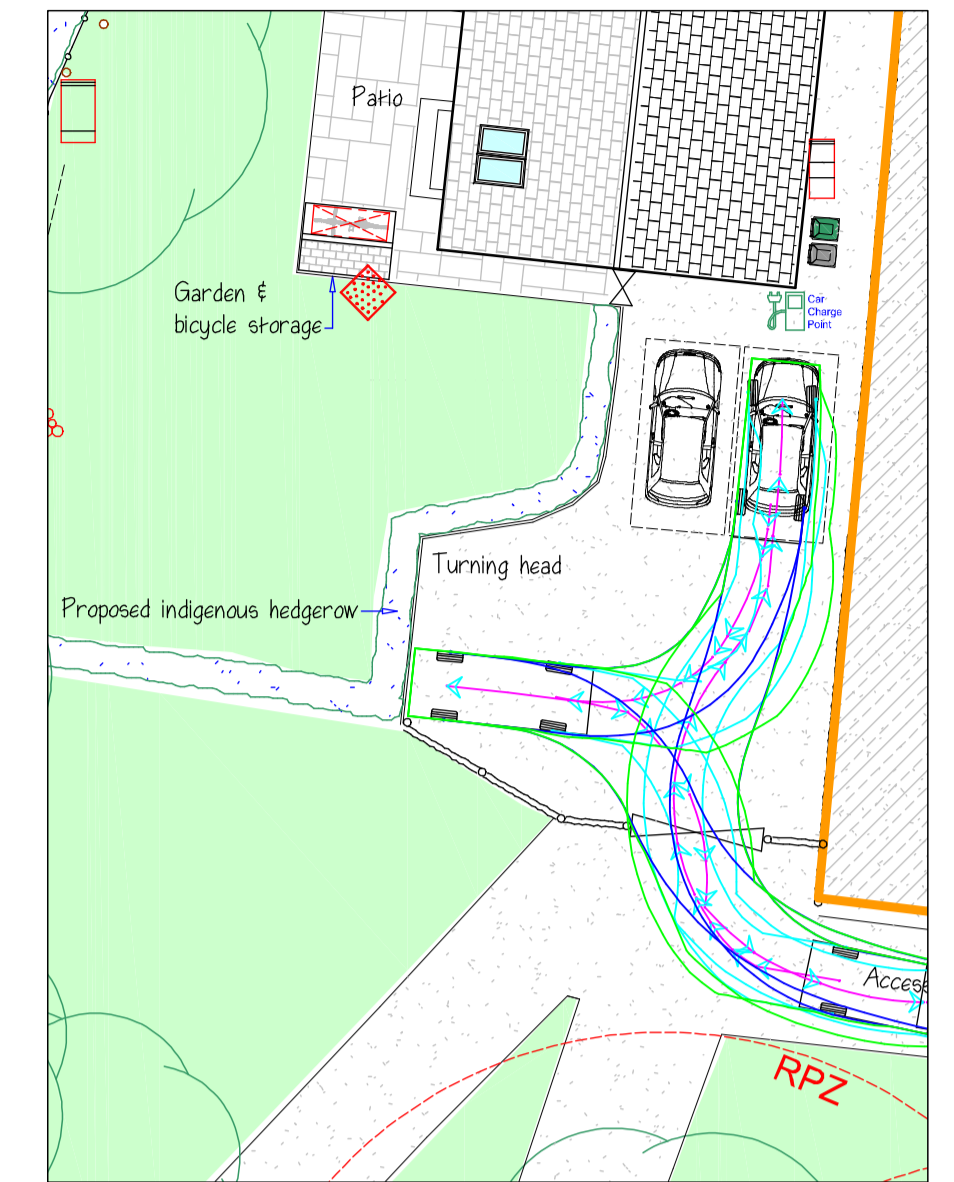

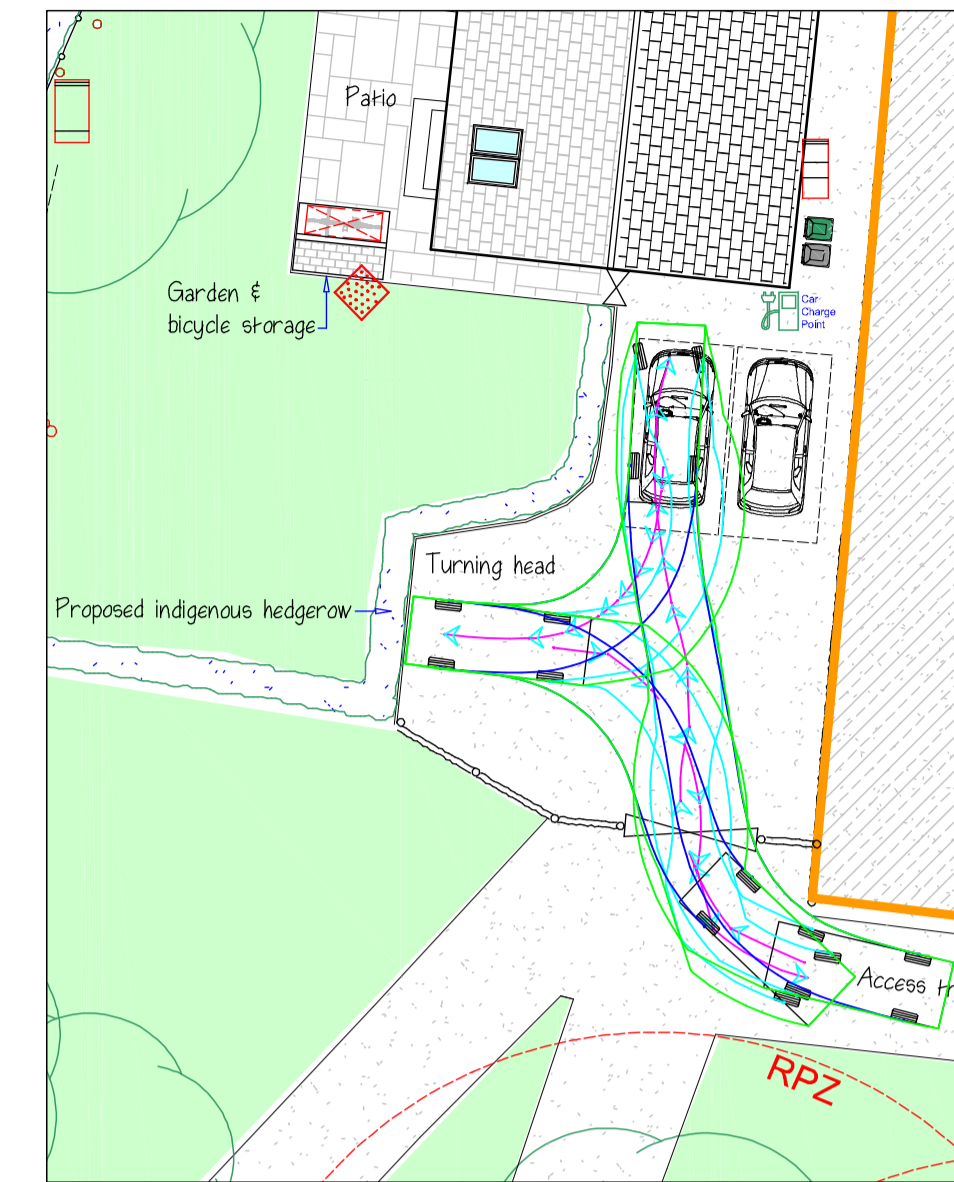





Site Plan showing Vehicle Tracking  
I: 200



Ecology Legend

-  IFF Schwieger Barbox with built-in wooden rear panel. Positioned at a height of between 3-6 m and SW facing.
-  Habitat Barbox 001, clad in material to match the elevation, built-in to the structure. Positioned 5-7 m above ground, near the eaves or gable apex of the property and SW facing.
-  Robin and wren diamond nestbox, positioned less than 2m above the ground in an area well hidden with vegetation.
-  House Sparrow Terrace FSC Nest Box placed between 1.5 and 5.5m above ground, preferably near to vegetation.
-  Log Pile For Insects & Reptiles  
The log pile will be sited away from living trees and shrubs in a semi-shady spot, it will comprise of any branches of trees that have fallen or been felled onsite. Piles should be fairly compact to maintain the humidity needed to decompose the wood.
-  A - Wooden Bird box  
Wooden bird box suitable for Hhs, sparrow or starlings to be fixed 2 - 4m up a tree or wall in a NE direction, tilted slightly forward so as to avoid the driving rain getting inside. There will be a clear flight path to the nest without any clutter directly in front of the entrance.
-  B - Bee Nesting Box  
Bee nest box to be positioned in full sunshine, so facing SE or S and at least 1m from the ground. Placed near vegetation with no vegetation obscuring or shading the nest entrances and in a stable, fixed position that will not sway in the wind or be easily knocked or dislodged.

Revisions:  
Rev2 25/01/22: Outline for previously approved application changed to yellow.  
Rev1 13/01/22: Proposed PFR fence to North. Hedgerow added. Bar boxes shown. Treatment plant and drainage shown.

Client: Mr A. Dean  
Address: Judge House Farm, Woodcock Lane, Grafty Green, Maidstone, Kent ME17 2AY

Job: Conversion of agricultural barn to 5 bed dwelling

Title: Proposed Site Plan

Scale: I: 200

Date: December 2021 Drawn by: Issue: Planning

Drawing Number: 1854 D04 Rev2  
(Original size: A1)

These drawings and all structural sizes and design are produced for planning/building regulation purposes only. Do not use site layout drawings for conveyancing. Contractors must verify all dimensions on site prior to setting out any work or drawings. Any discrepancies to be reported immediately.  
All rights are retained

