

Reproduced by permission of Ordnance Survey on behalf of the Controller of Her Majesty's Stationery Office All rights reserved. © Crown Copyright licence no. 100022432

PARKING LOCATION

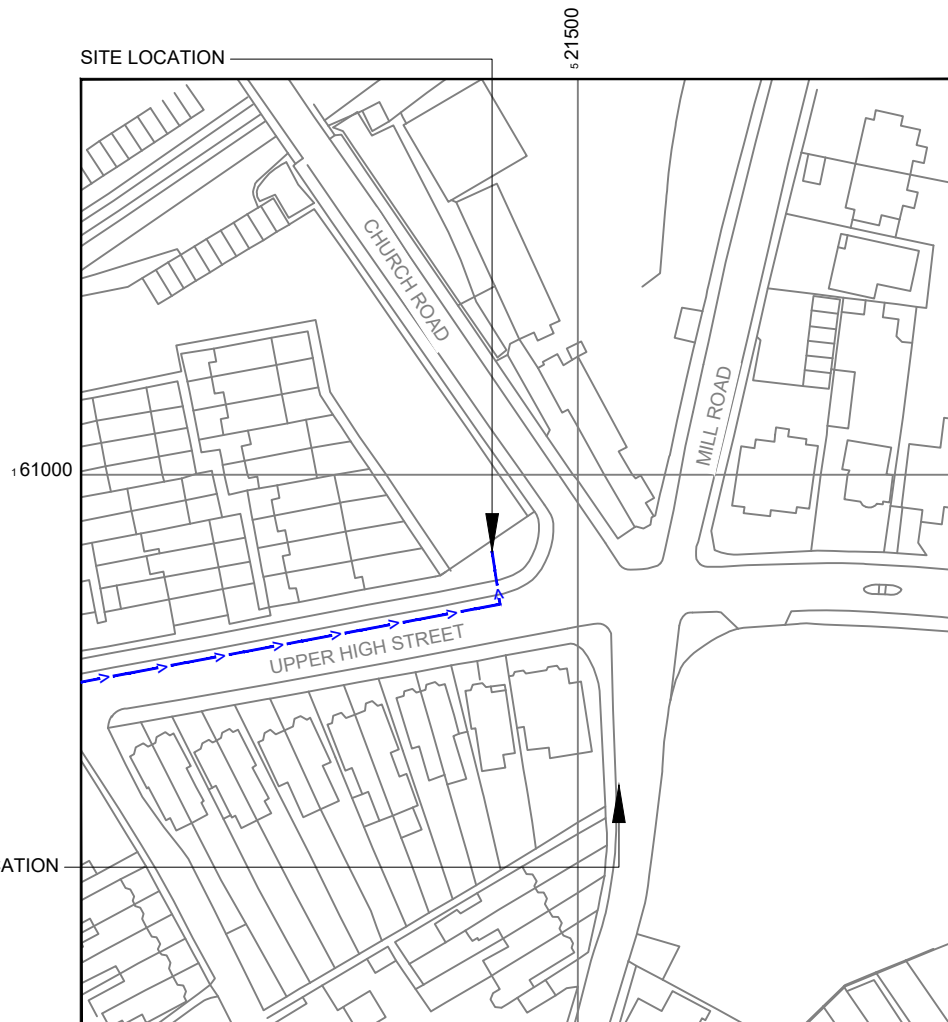

Reproduced by permission of Ordnance Survey on behalf of the Controller of Her Majesty's Stationery Office All rights reserved. © Crown Copyright licence no. 100022432

NGR E: 521486 N: 160988

SITE AREA PLAN

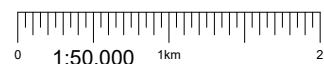

SITE LOCATION PLAN

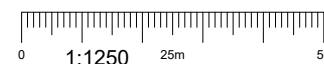

SITE PHOTOGRAPH



GOOGLE MAPS QR CODE

GOOGLE MAPS - <https://tinyurl.com/pvmmaj4x>

STREETVIEW - <https://tinyurl.com/935ce4jz>

NOTES:

- ALL DIMENSIONS IN MM UNLESS OTHERWISE NOTED.

Access Route To Site:

DIRECTIONS TO SITE:

GET ON M56 IN BEECHWOOD, RUNCORN FROM A557, A533, A5126 AND EXIT 12  
 9 MIN (5.6 MI)  
 TAKE M6, M6 TOLL, M40 AND M25 TO KINGSTON RD/A243 IN LEATHERHEAD. TAKE EXIT 9 FROM M25  
 3 HR 18 MIN (210 MI)  
 FOLLOW A243 AND B280 TO UPPER HIGH ST/A2022 IN EPSOM

REV	MODIFICATION	BY	CH	DATE
A	Issued for Planning	JMS	RWB	11.11.21

**CK Hutchison Networks (UK) Limited**

Great Brighams Mead,  
 Vastern Road, Reading,  
 Berkshire, England,  
 RG1 8DJ

Design Consultant & Principal Contractor:



Great British Communications  
 Lapping House, Block 3 Forward Point,  
 Tan House Lane, Widnes, Cheshire, WAB 0SL  
 t. 44 (0)151 420 4128  
[www.gbcservices.co.uk](http://www.gbcservices.co.uk)

Site Name: **PIKES HILL**

3UK Nominal ID: **EAE19894**

Address:  
**UPPER HIGH STREET  
 EPSOM  
 EPSOM AND EWELL  
 SURREY  
 KT17 4TA**

Title: **002 SITE LOCATION PLAN**

Project: **UNILATERAL SW**

Purpose of Issue: **PLANNING**

MBNL/TM/H3G Cell ID:  
**TBC/TBC/KT0761**

Drawing No: **EAE19894\_MBNL\_TM\_KT0761\_GA\_REV A**

Issue: **A**

100mm  
50mm  
10mm

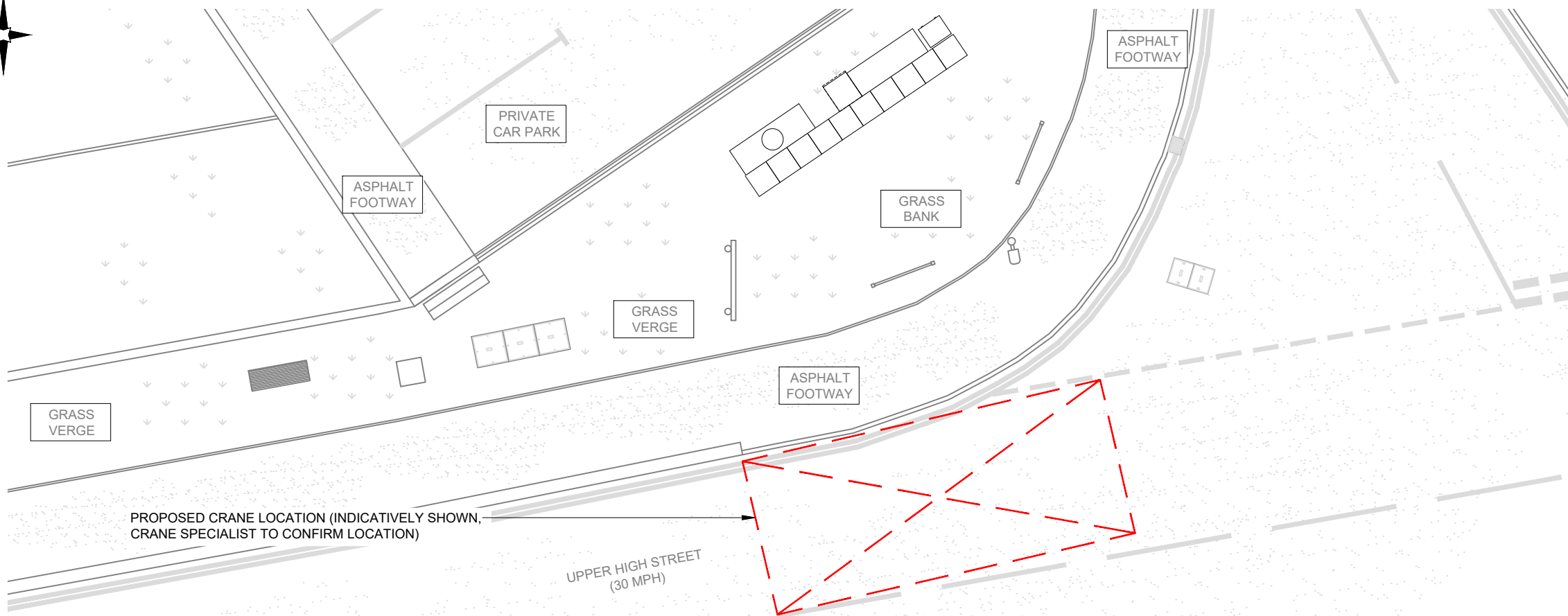

CRANE LOCATION

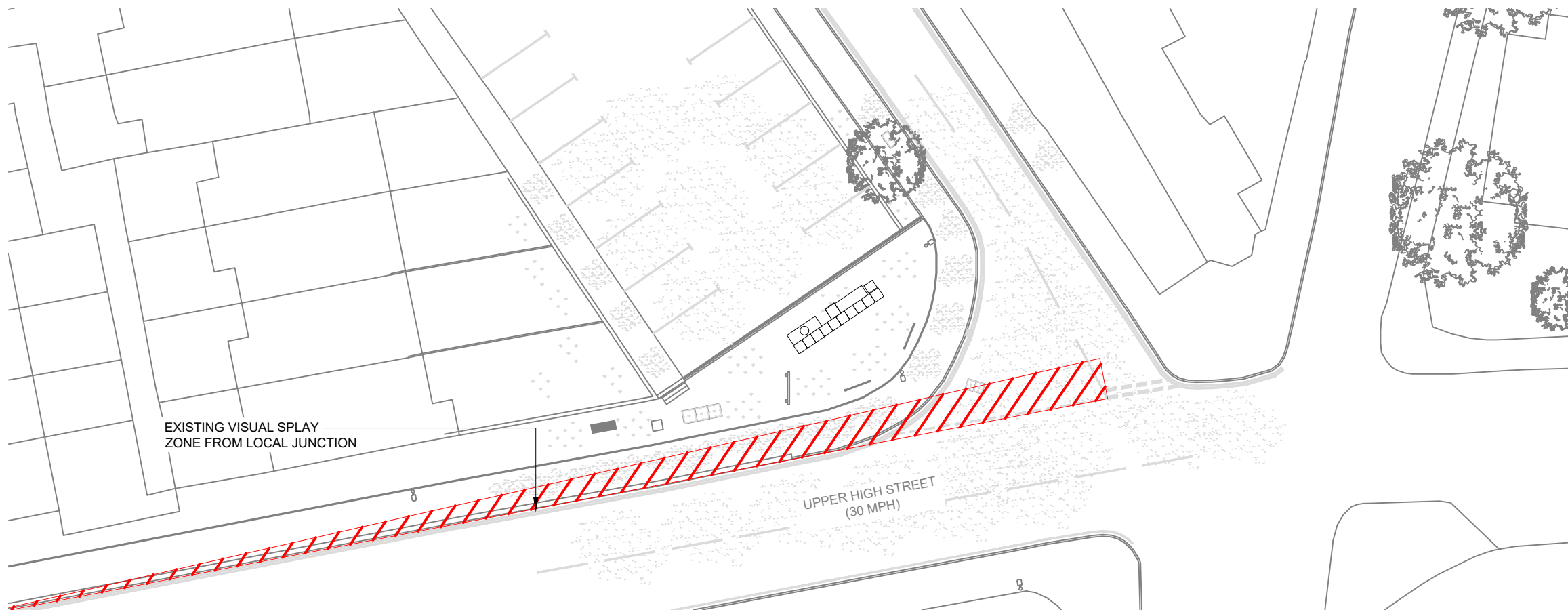
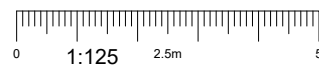

VISUAL SPLAY PLAN

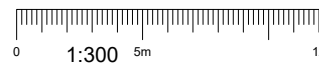

NOTES:

CRANE LOCATION INDICATIVELY SHOWN. CRANE SPECIALIST TO CONFIRM LOCATION.



REV	MODIFICATION	BY	CH	DATE
A	Issued for Planning	JMS	RWB	11.11.21

**CK Hutchison Networks (UK) Limited**  
 Great Brighams Mead,  
 Vastern Road, Reading,  
 Berkshire, England,  
 RG1 8DJ

Design Consultant & Principal Contractor:



Great British Communications  
 Lapping House, Block 3 Forward Point,  
 Ton House Lane, Widnes, Cheshire, WAB 0SL  
 t. 44 (0)151 420 4128  
 www.gbcservices.co.uk

Site Name: **PIKES HILL**

3UK Nominal ID: **EAE19894**

Address: **UPPER HIGH STREET  
 EPSOM  
 EPSOM AND EWELL  
 SURREY  
 KT17 4TA**

Title: **005 CRANE LOCATION &  
 VISUAL SPLAY PLAN**

Project: **UNILATERAL SW**

Purpose of Issue: **PLANNING**

MBNL/TM/H3G Cell ID:  
**TBC/TBC/KT0761**

Drawing No: **EAE19894\_MBNL\_TM\_KT0761\_GA\_REV A**

Issue: **A**

100mm  
50mm  
10mm

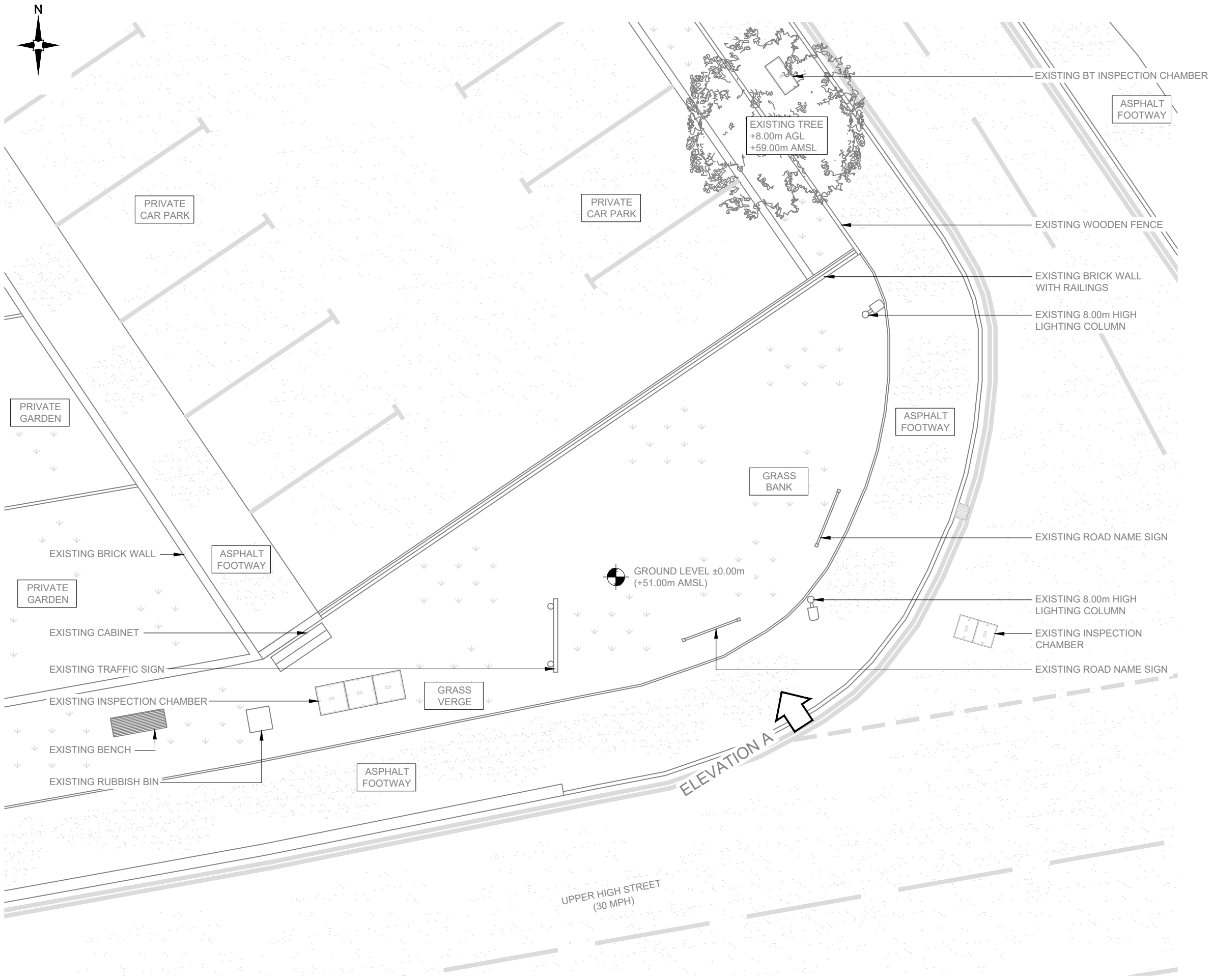

NOTES:  
1. ALL DIMENSIONS IN MM UNLESS OTHERWISE NOTED.

A	Issued for Planning	JMS	RWB	11.11.21
REV	MODIFICATION	BY	CH	DATE

**CK Hutchison Networks (UK) Limited**  
 Great Brighams Mead,  
 Vastern Road, Reading,  
 Berkshire, England,  
 RG1 8DJ

Design Consultant & Principal Contractor:  
  
**Great British Communications**  
 Lapping House, Block 3 Forward Point,  
 Ton House Lane, Widnes, Cheshire, WAB 0SL  
 t. 44 (0)151 420 4128  
 www.gbcservices.co.uk

Site Name: **PIKES HILL**

3UK Nominal ID: **EAE19894**

Address: **UPPER HIGH STREET  
 EPSOM  
 EPSOM AND EWELL  
 SURREY  
 KT17 4TA**

Title: **100 EXISTING SITE PLAN**

Project: **UNILATERAL SW**

Purpose of Issue: **PLANNING**

MBNL/TM/H3G Cell ID:  
**TBC/TBC/KT0761**

Drawing No: **EAE19894\_MBNL\_TM\_KT0761\_GA\_REV A** Issue: **A**

100mm  
50mm  
10mm



UPPER HIGH STREET  
(30 MPH)

ELEVATION A

GROUND LEVEL ±0.00m  
(+51.00m AMSL)

EXISTING TREE  
+8.00m AGL  
+59.00m AMSL

PRIVATE CAR PARK

PRIVATE CAR PARK

ASPHALT FOOTWAY

EXISTING BT INSPECTION CHAMBER

EXISTING WOODEN FENCE

EXISTING BRICK WALL WITH RAILINGS

EXISTING 8.00m HIGH LIGHTING COLUMN

PRIVATE GARDEN

ASPHALT FOOTWAY

GRASS BANK

EXISTING ROAD NAME SIGN

EXISTING 8.00m HIGH LIGHTING COLUMN

EXISTING INSPECTION CHAMBER

EXISTING ROAD NAME SIGN

ASPHALT FOOTWAY

PRIVATE GARDEN

EXISTING BRICK WALL

EXISTING CABINET

EXISTING TRAFFIC SIGN

EXISTING INSPECTION CHAMBER

GRASS VERGE

EXISTING BENCH

EXISTING RUBBISH BIN

ASPHALT FOOTWAY

100mm  
50mm  
10mm

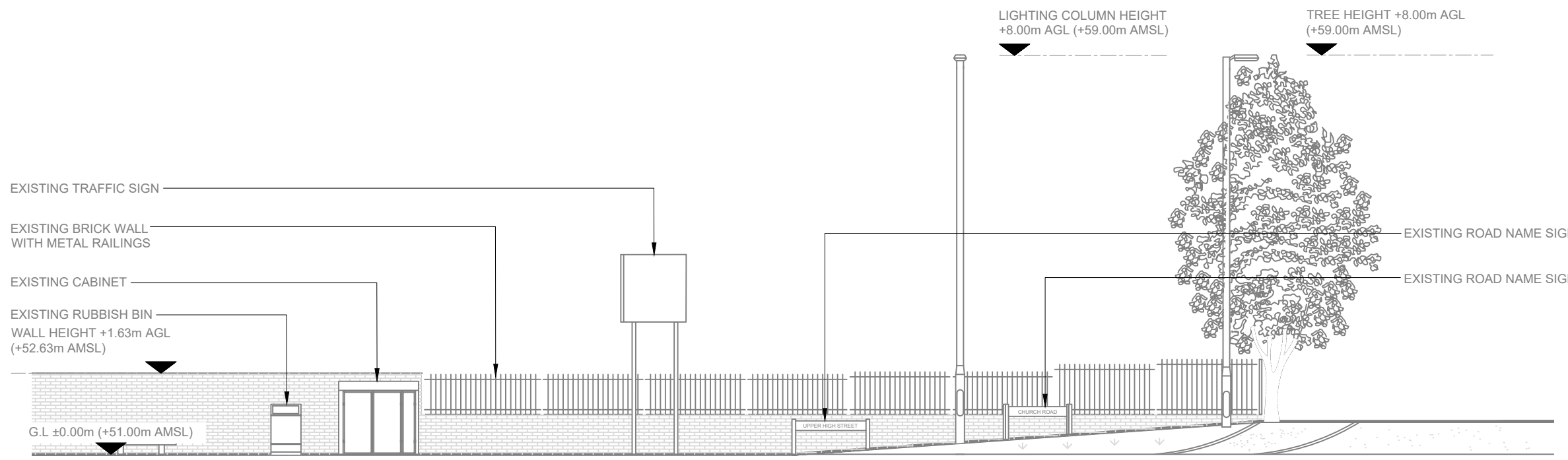

EXISTING ELEVATION A

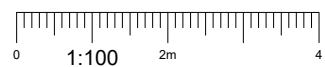

NOTES:  
1. ALL DIMENSIONS IN MM UNLESS OTHERWISE NOTED.

A	Issued for Planning	JMS	RWB	11.11.21
REV	MODIFICATION	BY	CH	DATE

**CK Hutchison Networks (UK) Limited**  
Great Brighams Mead,  
Vastern Road, Reading,  
Berkshire, England,  
RG1 8DJ

Design Consultant & Principal Contractor:



**Great British Communications**  
Lapwing House, Block 3 Forward Point,  
Ton House Lane, Widnes, Cheshire, WAB 0SL  
t. 44 (0)151 420 4128  
www.gbcservices.co.uk

Site Name: **PIKES HILL**

3UK Nominal ID: **EAE19894**

Address: **UPPER HIGH STREET  
EPSOM  
EPSOM AND EWELL  
SURREY  
KT17 4TA**

Title: **150 EXISTING SITE ELEVATION**

Project: **UNILATERAL SW**

Purpose of Issue: **PLANNING**

MBNL/TM/H3G Cell ID: **TBC/TBC/KT0761**

Drawing No: **EAE19894\_MBNL\_TM\_KT0761\_GA\_REV A** Issue: **A**

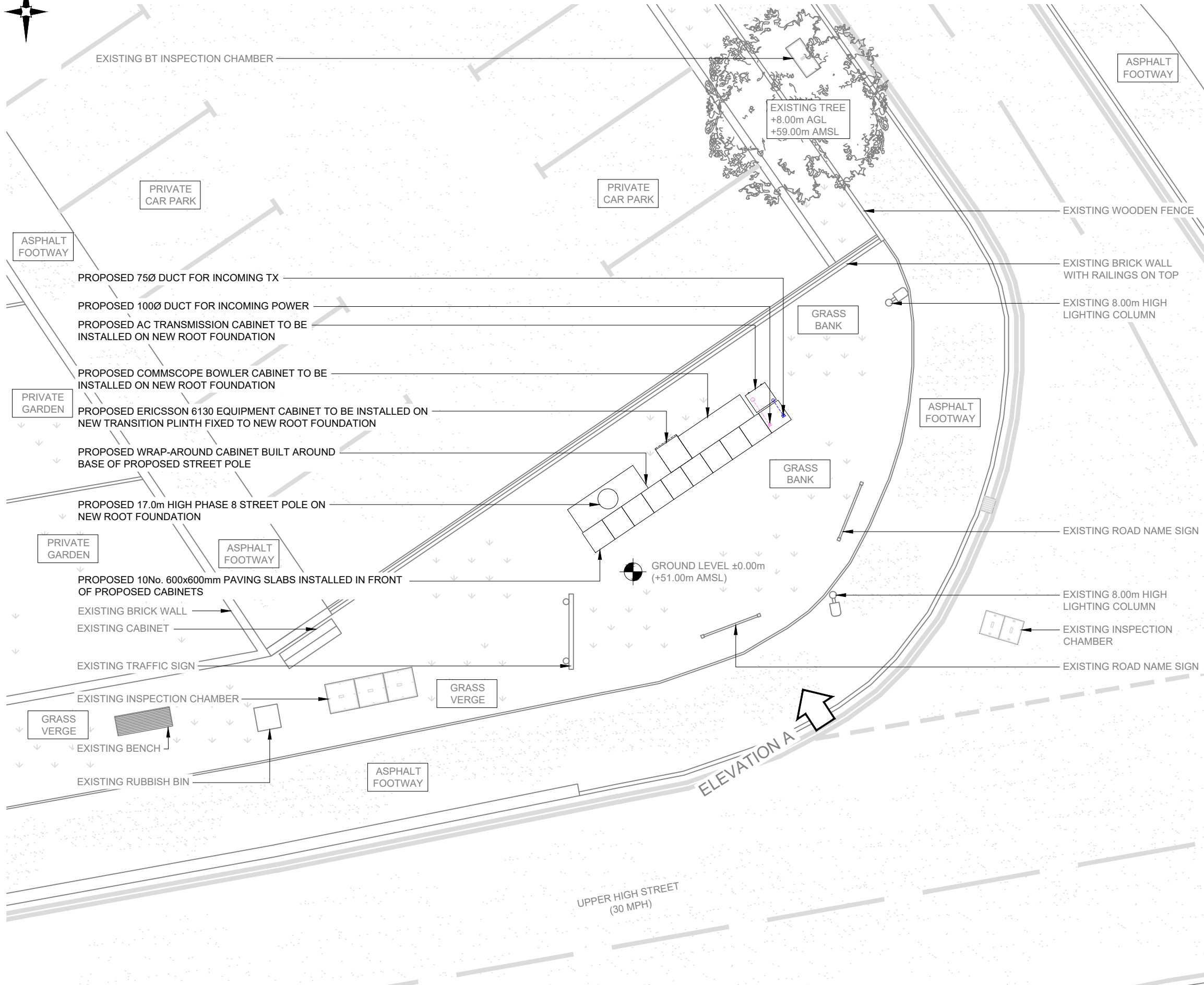

PROPOSED SITE PLAN  
 0 1:100 2m 4

NOTES:  
 1. ALL DIMENSIONS IN MM UNLESS OTHERWISE NOTED.

A	Issued for Planning	JMS	RWB	11.11.21
REV	MODIFICATION	BY	CH	DATE

**CK Hutchison Networks (UK) Limited**  
 Great Brighams Mead,  
 Vastern Road, Reading,  
 Berkshire, England,  
 RG1 8DJ

Design Consultant & Principal Contractor:  
  
 Great British Communications  
 Lapping House, Block 3 Forward Point,  
 Ton House Lane, Widnes, Cheshire, WAB 0SL  
 t. 44 (0)151 420 4128  
 www.gbcservices.co.uk

Site Name: **PIKES HILL**

3UK Nominal ID: **EAE19894**

Address: **UPPER HIGH STREET  
 EPSOM  
 EPSOM AND EWELL  
 SURREY  
 KT17 4TA**

Title: **215 PROPOSED SITE PLAN**

Project: **UNILATERAL SW**

Purpose of Issue: **PLANNING**

MBNL/TM/H3G Cell ID:  
**TBC/TBC/KT0761**

Drawing No: **EAE19894\_MBNL\_TM\_KT0761\_GA\_REV A**

Issue: **A**

100mm  
 50mm  
 10mm

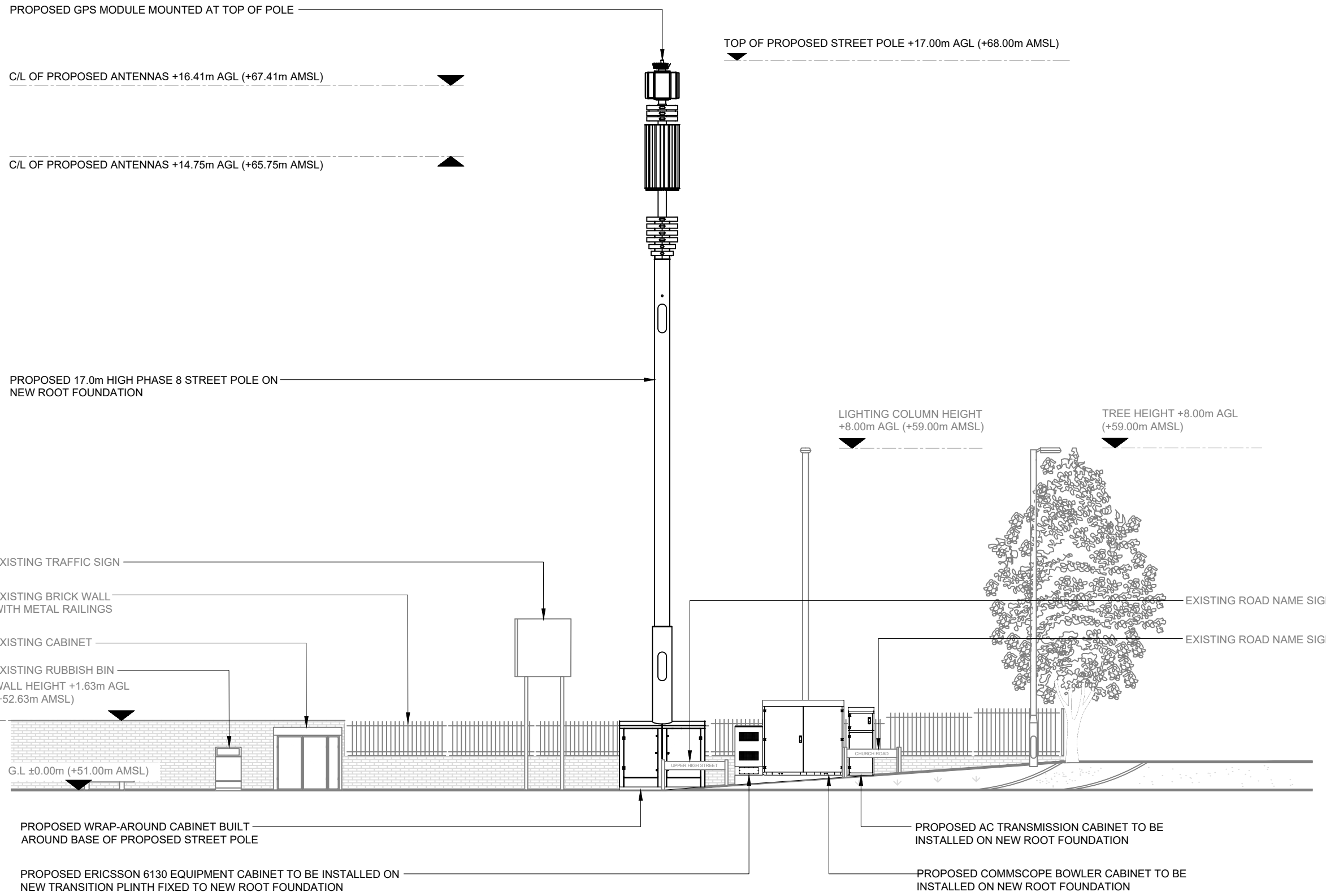

PROPOSED SITE ELEVATION A

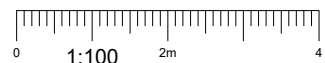

NOTES:  
1. ALL DIMENSIONS IN MM UNLESS OTHERWISE NOTED.

REV	MODIFICATION	BY	CH	DATE
A	Issued for Planning	JMS	RWB	11.11.21

**CK Hutchison Networks (UK) Limited**  
Great Brighams Mead,  
Vastern Road, Reading,  
Berkshire, England,  
RG1 8DJ

Design Consultant & Principal Contractor:  
**GBC**  
Great British Communications  
Lapwing House, Block 3 Forward Point,  
Ton House Lane, Widnes, Cheshire, WAB 0SL  
t. 44 (0)151 420 4128  
www.gbcservices.co.uk

Site Name: **PIKES HILL**

3UK Nominal ID: **EAE19894**

Address: **UPPER HIGH STREET  
EPSOM  
EPSOM AND EWELL  
SURREY  
KT17 4TA**

Title: **265 PROPOSED SITE ELEVATION**

Project: **UNILATERAL SW**

Purpose of Issue: **PLANNING**

MBNL/TM/H3G Cell ID:  
**TBC/TBC/KT0761**

Drawing No: **EAE19894\_MBNL\_TM\_KT0761\_GA\_REV A**

Issue: **A**

### PROPOSED ANTENNA & RF EQUIPMENT SCHEDULE

EXISTING/PROPOSED	ANTENNA REFERENCE	FUNCTION	FEEDER/FIBRE						BIAS T's/RRU's		ANTENNAS									
			LENGTH(m) & DIAMETER (SEE GUIDANCE NOTES BELOW)			TYPE (COAX OR FIBRE)	FEEDERS QTY	FIBRE QTY	FIBRE LENGTH	FILTER	DIPLEXER	BIAS T	RRU QTY (HL= HIGH LEVEL, E= ENCLOSURE)	ANT. REF.	ANTENNA MANUFACTURERS PART No.	BRG°	HEIGHT TO TOP (m)	HEIGHT TO C/L (m)	HEIGHT TO U/S (m)	LOCATION (POLE MOUNTED, HEADFRAME, WITHIN SHROUD ETC)
			MF1	MF(J1)	TOTAL															
SECTOR 1 PROPOSED	A1	5G	-	-	-	DC FIBRE	-	3	21m	-	-	-	-	A1a	AIR 3278	0°	16.72	16.41	16.10	UPPER HEADFRAME
	A2	800	1/2"=14	1/2"=7m(2)	21m	DC FIBRE+COAX	4	-	-	-	-	-	E	A2a A2b A2c A2d A2e A2f A2g	HUAWEI AHP4517R12v06	0°	15.50	14.75	14.00	LOWER HEADFRAME
		1400	1/2"=14	1/2"=7m(2)	21m	DC FIBRE+COAX	4	-	-	1	-	-	E							
		1800 /2100	1/2"=14	1/2"=7m(2)	21m	DC FIBRE+COAX	4	-	-	-	-	1	E							
		-	-	-	-	-	-	-	-	-	-	-	-							
SECTOR 2 PROPOSED	B1	5G	-	-	-	DC FIBRE	-	3	21m	-	-	-	-	B1a	AIR 3278	120°	16.72	16.41	16.10	UPPER HEADFRAME
	B2	800	1/2"=14	1/2"=7m(2)	21m	DC FIBRE+COAX	4	-	-	-	-	-	E	B2a B2b B2c B2d B2e B2f B2g	HUAWEI AHP4517R12v06	120°	15.50	14.75	14.00	LOWER HEADFRAME
		1400	1/2"=14	1/2"=7m(2)	21m	DC FIBRE+COAX	4	-	-	1	-	-	E							
		1800 /2100	1/2"=14	1/2"=7m(2)	21m	DC FIBRE+COAX	4	-	-	-	-	1	E							
		-	-	-	-	-	-	-	-	-	-	-	-							
SECTOR 3 PROPOSED	C1	5G	-	-	-	DC FIBRE	-	3	21m	-	-	-	-	C1a	AIR 3278	240°	16.72	16.41	16.10	UPPER HEADFRAME
	C2	800	1/2"=14	1/2"=7m(2)	21m	DC FIBRE+COAX	4	-	-	-	-	-	E	C2a C2b C2c C2d C2e C2f C2g	HUAWEI AHP4517R12v06	240°	15.50	14.75	14.00	LOWER HEADFRAME
		1400	1/2"=14	1/2"=7m(2)	21m	DC FIBRE+COAX	4	-	-	1	-	-	E							
		1800 /2100	1/2"=14	1/2"=7m(2)	21m	DC FIBRE+COAX	4	-	-	-	-	1	E							
		-	-	-	-	-	-	-	-	-	-	-	-							

#### GPS LINE KEY

SECTOR ID	NODE TYPE	NODE C/L (m) AGL	GPS NODE CABLE LENGTH (m)
1	GPS	17.00m	35m

A	Issued for Planning	JMS	RWB	11.11.21
REV	MODIFICATION	BY	CH	DATE

### CK Hutchison Networks (UK) Limited

Great Brighams Mead,  
Vastern Road, Reading,  
Berkshire, England,  
RG1 8DJ

Design Consultant & Principal Contractor:



Great British Communications  
Lapping House, Block 3 Forward Point,  
Ton House Lane, Widnes, Cheshire, WAB 0SL  
t. 44 (0)151 420 4128  
www.gbcservices.co.uk

Site Name: **PIKES HILL**

3UK Nominal ID: **EAE19894**

Address: **UPPER HIGH STREET  
EPSOM  
EPSOM AND EWELL  
SURREY  
KT17 4TA**

Title: **304 PROPOSED CONFIGURATION  
ANTENNA SCHEDULE**

Project: **UNILATERAL SW**

Purpose of Issue: **PLANNING**

MBNL/TM/H3G Cell ID:  
**TBC/TBC/KT0761**

Drawing No: **EAE19894\_MBNL\_TM\_KT0761\_GA\_REV A** Issue: **A**

100mm  
50mm  
10mm

### Support Structure Schedule

Structure ID	Status	Equipment Description / Type	Structure Manufacturer	Height AGL (m)	Colour (RAL Colour)	Headframe Details	Foundation / Support Grillage / Host Structure Details	Support Bolt Details	MBNL Ref:	Comments
ST1	PROPOSED	PHASE 8 POLE	HEL / VALMONT	17.00m	GREEN-6021	-	ROOT	-	N/A	WITH WRAPAROUND CABINET

### Equipment Schedule

Equipment ID	Quantity	Status	Equipment Description / Type	Equipment Manufacturer	Dimensions (W x D x H)	Weight (kg)	Colour (RAL Colour)	Material	Location	Power	Power cable length (m)	MBNL Ref:	Comments
CAB1	1	PROPOSED	AC TRANSMISSION	COMMSCOPE	600x500x1585	110	GREEN-6021	STEEL	OUTDOOR	-	-	-	FIBRE ONLY - TX SUPPLIER TBC
CAB2	1	PROPOSED	6130	ERICSSON	650x700x950	130	GREEN-6021	STEEL	OUTDOOR	-	-	-	COMPLETE WITH TRANSITION PLINTH
CAB3	1	PROPOSED	BOWLER	COMMSCOPE	1900x600x1752	220	GREEN-6021	STEEL	OUTDOOR	-	-	-	

DEPENDENCY	STATUS
RF Compliance	Sector A - Step 1.0 SW Sector B - Step 3.0 SW Sector C - Step 2.0 SW
Building Regulations Approval	N/A
Asbestos	N/A
Planning Conditions	TBC by Local Authority
Geotech Report	N/A
Structural Calculations	N/A
Intrusive Building Survey	N/A
Global Design Check	N/A
Rigging Survey	N/A
FIXITS	N/A
Power	Proposed 1 phase 100A supply - DNO Quote Approval Required
Transmission Solution	Fibre only
Cooling Solution	Manufacturers Cooling
Line of Site Survey	N/A
Services Search	Completed - 12.10.21
Trial Hole Report	Pending
Other	-

REV	MODIFICATION	BY	CH	DATE
A	Issued for Planning	JMS	RWB	11.11.21

**CK Hutchison Networks (UK) Limited**  
 Great Brighams Mead,  
 Vastern Road, Reading,  
 Berkshire, England,  
 RG1 8DJ

Design Consultant & Principal Contractor:  
  
**Great British Communications**  
 Lapping House, Block 3 Forward Point,  
 Ton House Lane, Widnes, Cheshire, WAB 0SL  
 t. 44 (0)151 420 4128  
 www.gbcservices.co.uk

Site Name: **PIKES HILL**

3UK Nominal ID: **EAE19894**

Address: **UPPER HIGH STREET  
 EPSOM  
 EPSOM AND EWELL  
 SURREY  
 KT17 4TA**

Title: **307 EQUIPMENT SCHEDULES & DEPENDENCIES**

Project: **UNILATERAL SW**

Purpose of Issue: **PLANNING**

MBNL/TM/H3G Cell ID:  
**TBC/TBC/KT0761**

Drawing No: **EAE19894\_MBNL\_TM\_KT0761\_GA\_REV A** Issue: **A**

100mm  
50mm  
10mm