

Notes:
 this drawing is copyright to Koda Architects Ltd | do NOT scale off
 this drawing | all dimensions to be checked on site - do not rely on
 these measurements any errors or discrepancies to be reported
 to the architect immediately

DESCRIPTION:	DATE	REV.
proposal to illustrate and consider the impact of the garage set due north of hope cottage with the access path repositioned accordingly.	21.01.22	B
changed orientation of garage and access to it in relation to the drive and house introduction of pv panels on roof and additional roof light illustrated.	10.12.21	A

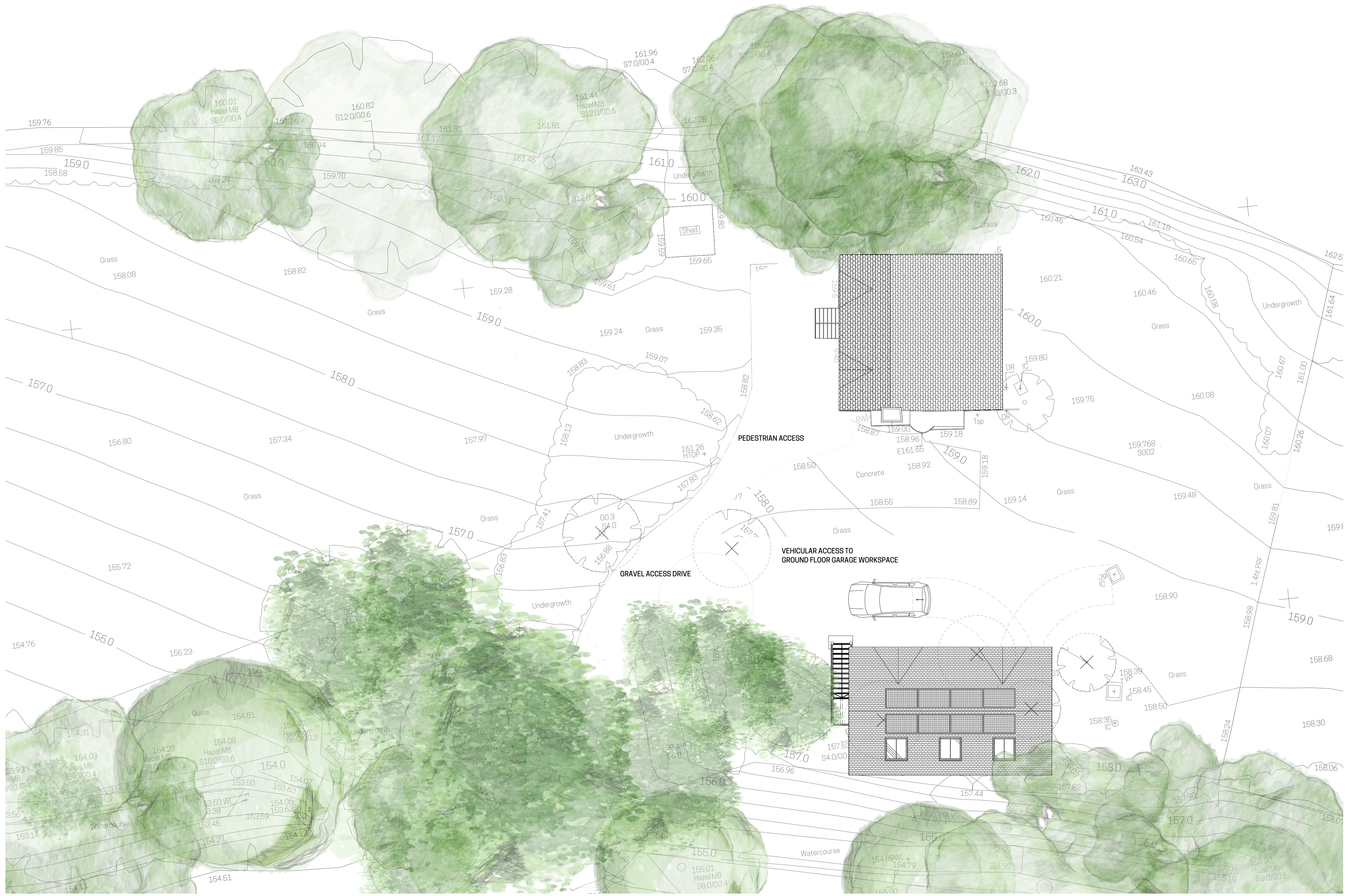

KODA

architects and historic building consultants

E: info@kodaarchitects.com
 T: 01432 805459 W: www.kodaarchitects.com

CLIENT: MR AND MRS COOKE
 SITE ADDRESS: Hope Cottage
 Batchcott
 Richards Castle
 LUDLOW
 SY8 4EB

DWG No: 1864-303
 Date: JANUARY 2022
 Rev: -
 Scale: 1:100 @ A1 1:200 @ A3
 Drawn by: FG
 Status: *PLANNING*
 Drawing title: PROPOSED BLOCK PLAN