



B360

Entrance control / Self-closing pedestrian gate

The B360 self-closing pedestrian gate has been designed to complement other perimeter protection systems including fencing, gates and vehicle barriers. The B360 particularly excels when combined with the Heras full height B700 security turnstiles, providing emergency or disability access to site and meeting the requirements of health and safety and DDA standards with no compromise in security.

Expertly designed and manufactured to withstand elemental wear and vandal tampering, the B360 can be integrated with existing site access control systems and can be supplied with control technology to suit bespoke site requirements.

Applicable for internal or external use, the B360 pedestrian gates can be finished with a wide range of coating colours to fit with any palette.

- **Heavy duty design and construction ensures longevity and low maintenance requirements**
- **Range of design and finish options to accommodate the aesthetics of any site**
- **Capable of full integration with any existing site access technology or systems**
- **Excels when deployed in combination with vehicle gates, barriers or turnstiles for total perimeter control and emergency or disability access**
- **Safe design with hidden closer and no trapping hazards**

Drawings (dimensions in mm)

Right-hand opening gate

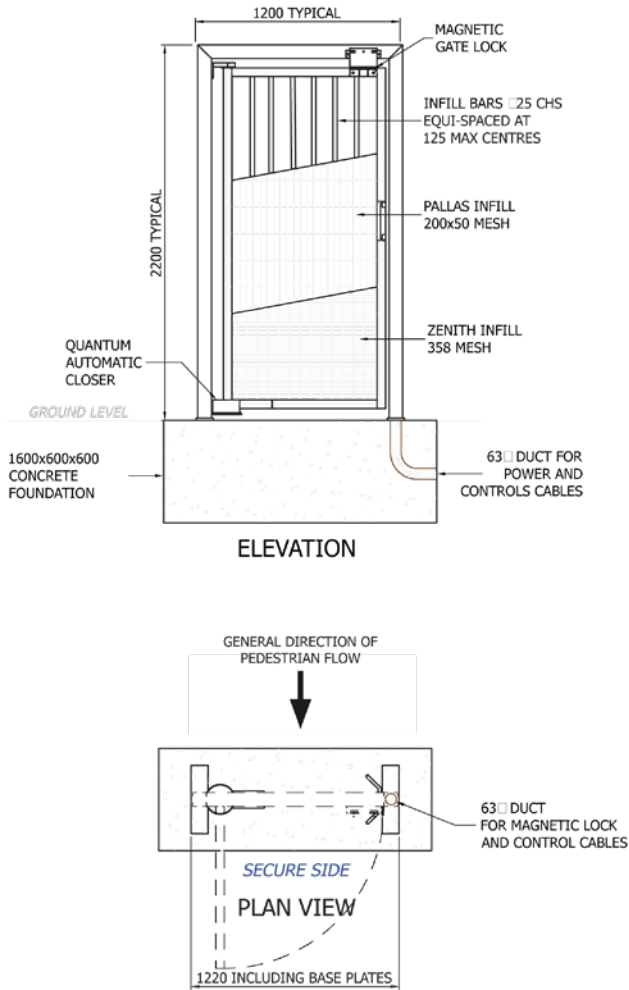

Left-hand opening gate

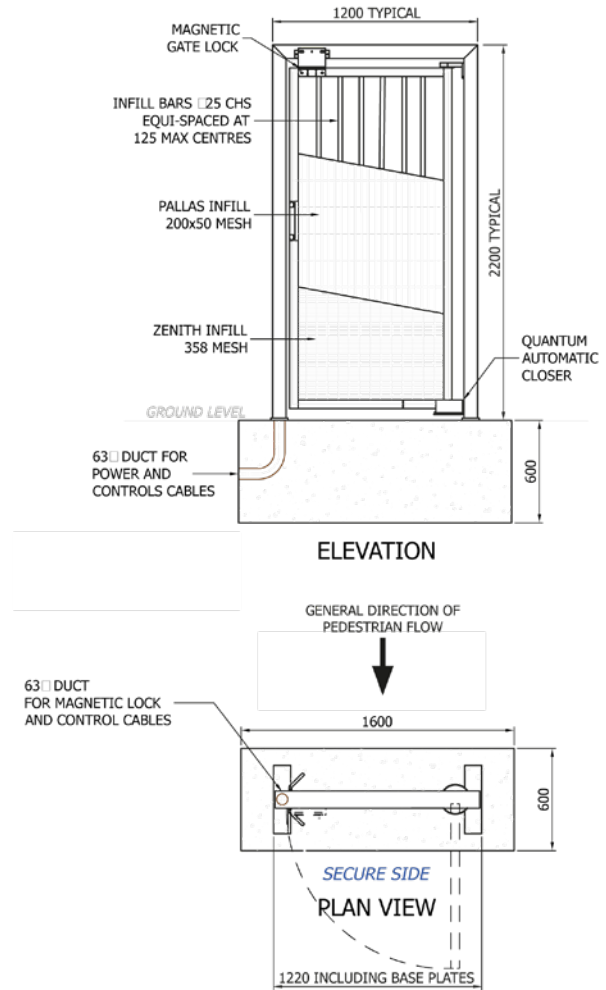

General specification

- Welded construction self-closing pedestrian gate fabricated from hollow RHS section steel frame
- Fully continuous and finished welds
- Heavy hollow RHS steel section gate support frame
- All steel section sizes are dependent on final gate size and local environmental conditions
- Electro magnetic lock
- Hydraulic self closing unit

Finish

Various options available in a range of RAL colours:

- Hot dip galvanised
- Hot dip galvanised and polyester powder coated to 75 microns
- Hot zinc spray and polyester powder coated to 75 microns

Options & software

- Choice of widths, heights and designs
- Access control readers
- Intercom
- Dug in or base plated posts

Infill

- Bars - 25 x 25 mm RHS vertical bar in-fills at approx. 125 mm centres
- Zenith 358 Mesh
- Pallas Mesh
- Palisade

Ordering information

Contact your local Heras office for precise ordering details.



B300

Entrance control / Swing gate

The B300 automated swing gate, available in single or double leaf orientation, is a complete entrance control solution for office buildings, schools, commercial and industrial sites.

The gate frame is constructed of square hollow section steel with a choice welded-mesh, palisade or vertical bar infill. Adjustable, sealed bearing hinges prevent crushing hazards and enable the gate leaf to be opened 90°. Further security can be added with anti-climb devices such as spikes or razor/ barbed wire. Other system integration options include a range of detection systems and access control.

Automated gates are secured closed with locking hydraulic operators and magnetic lock installed as standard. All gates are fitted with safety edges and photocells to comply with UK and EU safety standards.

All gates are anti-corrosion treated, being galvanised and powder coated to a choice of BS or RAL colours. Special finishes are available to ensure suitability for harsh environmental conditions.

- **Sealed bearing safety hinges**
- **Available in single and double leaf**
- **Easily integrated with access control and increased security options**
- **Available in various infills (bar, mesh, palisade)**
- **Safety edges and photocells fitted as standard**

Experts in perimeter protection



Drawings

General layout double leaf gate

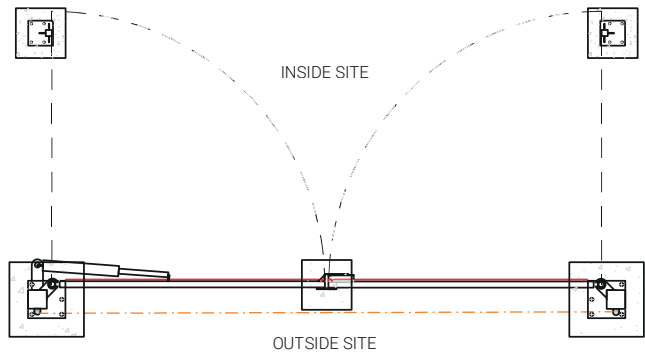
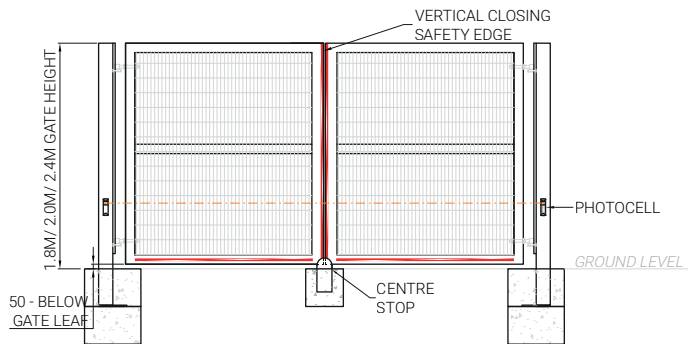

Technical specifications

Single leaf clear opening	Up to 4 m
Double leaf clear opening	4 - 8 m
Standard heights	1.8, 2.0, 2.4 m
Material	Heavy steel fully welded
Colour (other colours available upon request)	RAL 6005 (moss green) RAL 6009 (fir green) RAL 7016 (anthracite grey) RAL 9005 (jet black)
Finish	Epoxy coated Galvanized Powder coating (80 µm thick; 80 buchholz hardness)
Infill	Bar Pallas mesh Zenith mesh Palisade
Locking	Magnetic lock closed Magnetic lock open (only required if open for long period of time)
Leaf	Single or double
Base options	Dug-in Baseplated
Drive	Electro-hydraulic
Operating speed	25-30 seconds

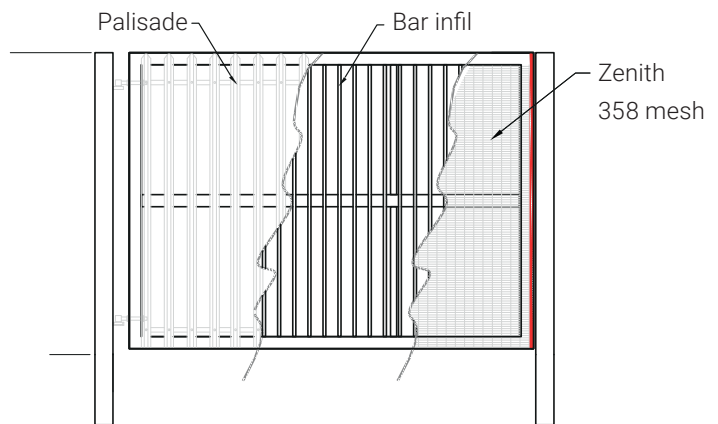

Certificates

- Steel quality is S235JR according to BS EN 10025
- Powder coating according to BS EN 5254

Ordering information

Contact your local Heras office for precise ordering details.

Suggested accessories / products

- Pallas / Zenith / Palisade matching fenceline
- Signage
- Traffic lights
- Warning sounders
- Laser safety curtains for high risk areas
- Toppings available: barbed wire, electric fence



Triton

Demarcation / Welded mesh

The Triton fencing system is ideal where security is required but without an oppressive and intimidating appearance. It is designed to be resilient and yet remain unobtrusive and elegant. This system is capable of blending into its environment or enhancing the surroundings as a design feature.

Triton panels are manufactured from nominal 5.0mm dia. thick steel wire profiled horizontal sections that significantly increase the rigidity of the panel. The mesh itself is 55mm x 200mm, fully welded at every intersection. The panels have a barbed edge and a flush edge.

The client has the option of installing the barbed edge at the top of the fence, as a deterrent to climbing, or at the bottom, for

example where the fencing is one of the lower heights in a playground situation. Please be aware that if you require the barb down option then an inverted clip will need to be ordered.

- **Secure and attractive**
- **Cost-effective**
- **Can be integrated with detection and entrance control options**
- **Unique Hexaclip fixings (anti-tamper)**
- **Difficult to climb**

Drawings (dimensions in mm)

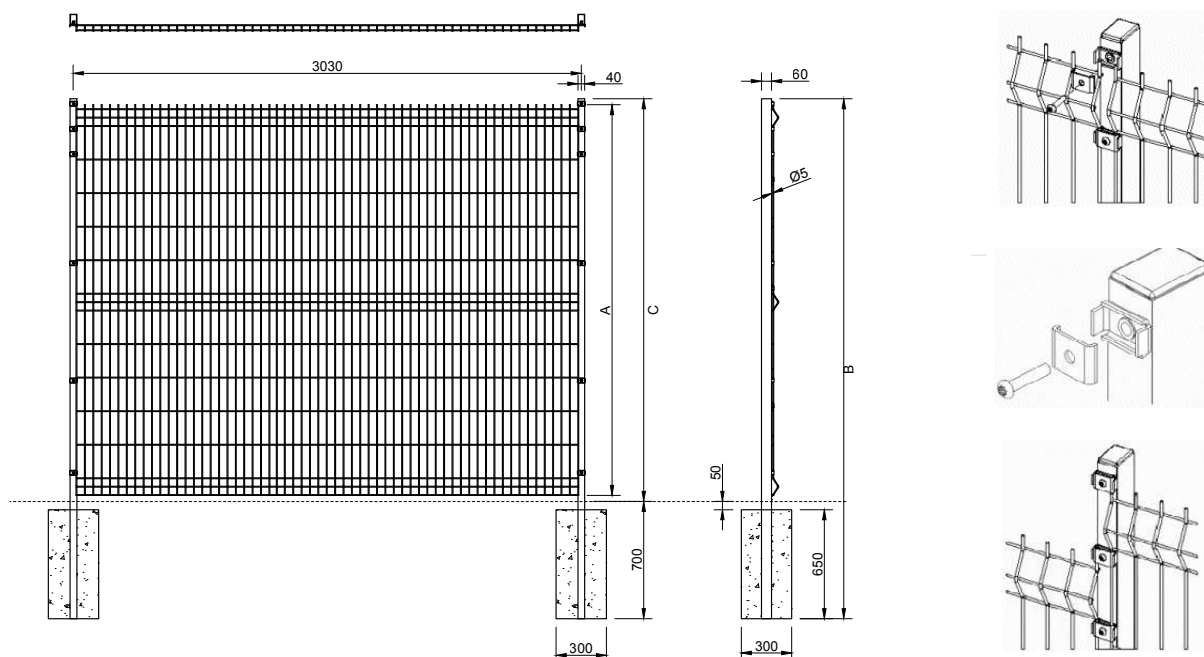

Technical specifications

Type	Panel height (A)	Post length with concrete surround (B)	Post length with base plate (C)	Fastener clips
Triton 180	1730	2400	1800	7
Triton 200	1930	2700	2000	8
Triton 240	2330	3100	2400	8

Material	Fully welded steel
Colour (other colours available upon request)	RAL 6005 (moss green) RAL 9005 (jet black)
Finish	Pre-galvanized and powder coating
Panel width	2510 mm
Post centre-to-centre	2530 mm
Post profile	60 x 40 mm
Clip fasteners	M8 x 40 security bolts
Wire diameter	5 mm
Vertical wire spacing	50 mm
Horizontal wire spacing	200 mm

Certificates

- Products are produced according to EN 10218-2 and EN 10223-4
- The quality is S235JR according to EN 10025 and hot dip galvanized according to EN ISO 1461
- The quality for coated posts is S220 GD + Z275 M.A.C. according to EN 10346
- Powder coating according to EN 5254

Ordering information

Contact your local Heras office for precise ordering details.

Suggested accessories / products

- Standard Heras gate with Pallas infill
- Electric fence

TRITON FENCE PANEL (SCALE 1:25)

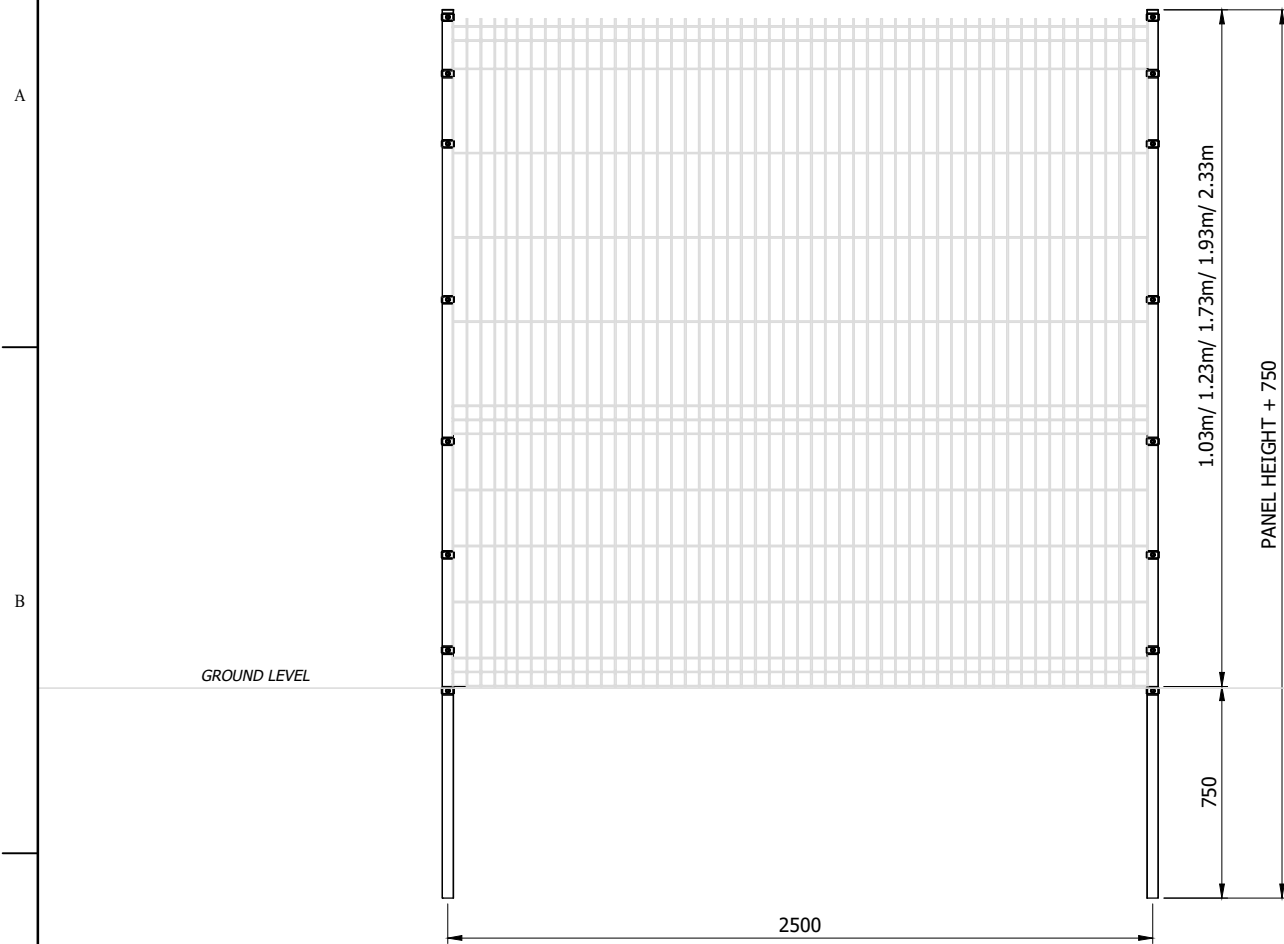

TRITON FENCE PANEL- PLAN VIEW (SCALE 1:20)

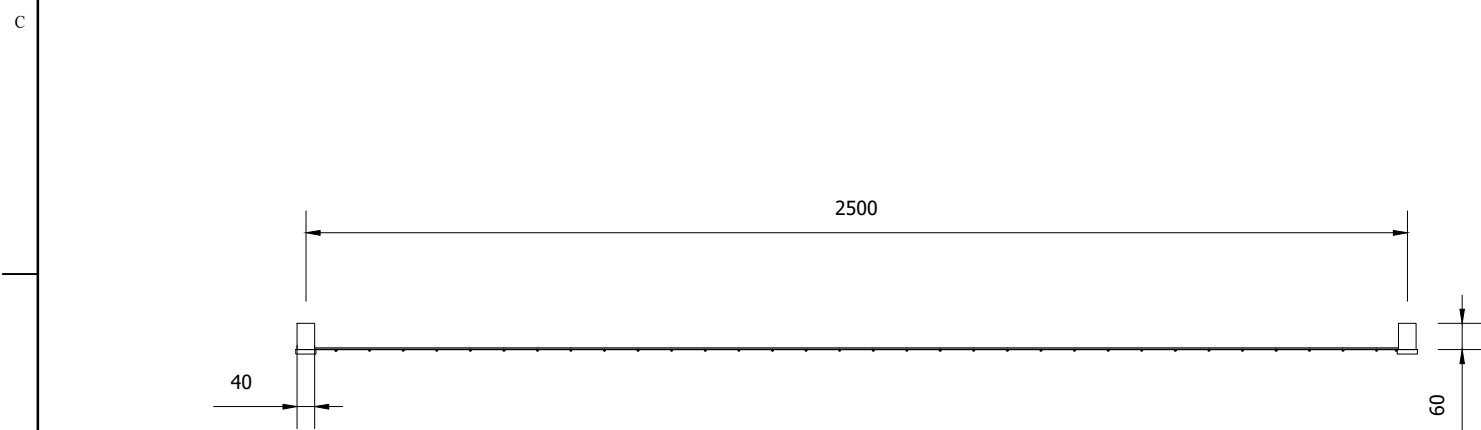

TRITON FENCING FIXINGS

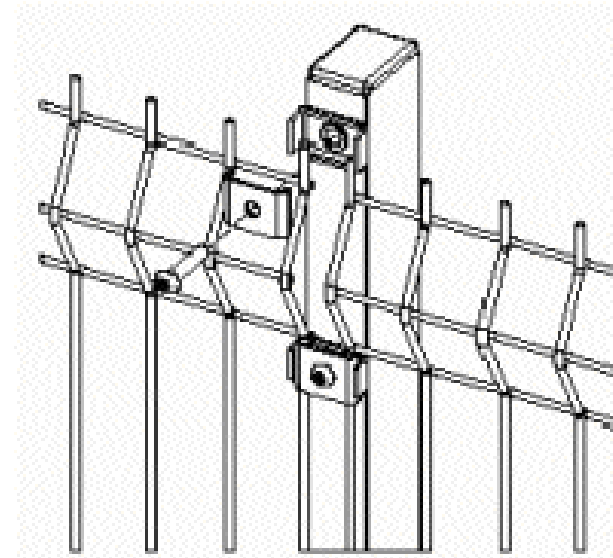

EXPLODED VIEW OF TRITON FENCING FIXINGS

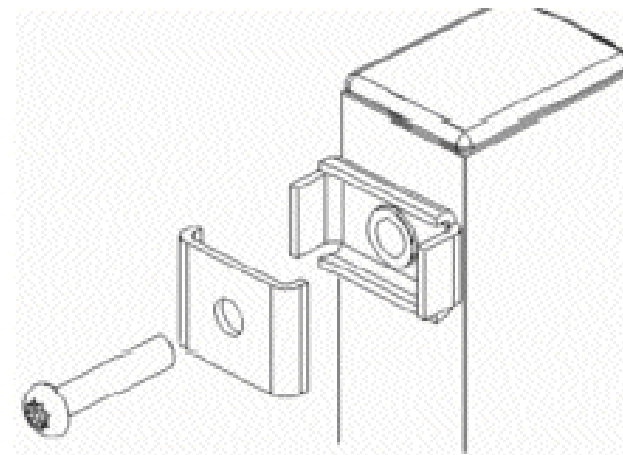

TRITON FENCING

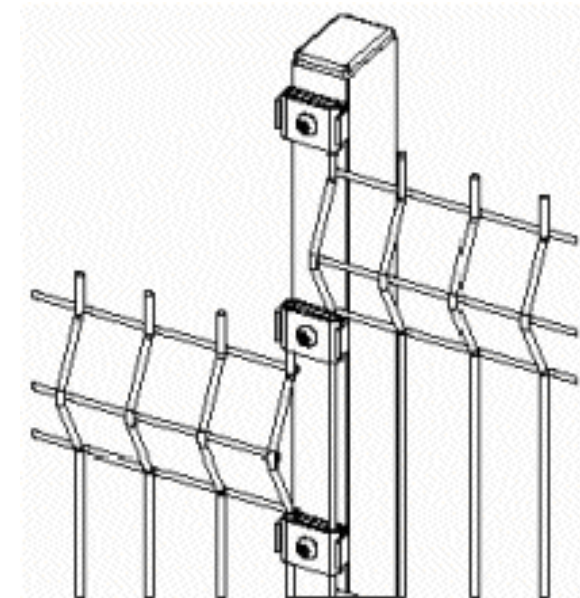

DO NOT SCALE - IF IN DOUBT ASK

THIS DRAWING REMAINS THE COPYRIGHT OF HERAS
ENTRANCE CONTROL AND MUST NOT BE
REPRODUCED IN WHOLE OR IN PART WITHOUT
PRIOR WRITTEN PERMISSION

INFORMATION ONLY - NOT FOR
CONSTRUCTION/MANUFACTURE

NOTES

1. ALL DIMENSIONS IN MILLIMETRES UNLESS SHOWN OTHERWISE
2. STANDARD MATERIAL: MILD STEEL
3. STANDARD FINISH: POLYESTER POWDER COATED.

STANDARD FINISH:

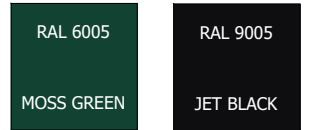

Revision	Stability Description	Drawn	Checked	Revised	Date
A	FIRST ISSUE	BO			02.07.19



A CRH COMPANY

33 Stakehill Industrial Estate, Middleton, Manchester M24 2RW
Tel: 0161 655 1020 E-mail: cc.sales@heras.co.uk

Product Name: TRITON FENCING	Product Number: 100
---------------------------------	------------------------

Drawing Title:
TRITON FENCE PANEL DETAILS

Finish:	Scale: AS SHOWN	Sheet Size: A3
---------	--------------------	-------------------

Drawing Number: 100_TRITON_04	Revision: A
----------------------------------	----------------

S:\MIDDLETON\DESIGN\02_PRE_SALES\02_SALES_SPECIFICATION\100_FENCING\FENCING_MASTER.DWG 100mm 75 50 25