

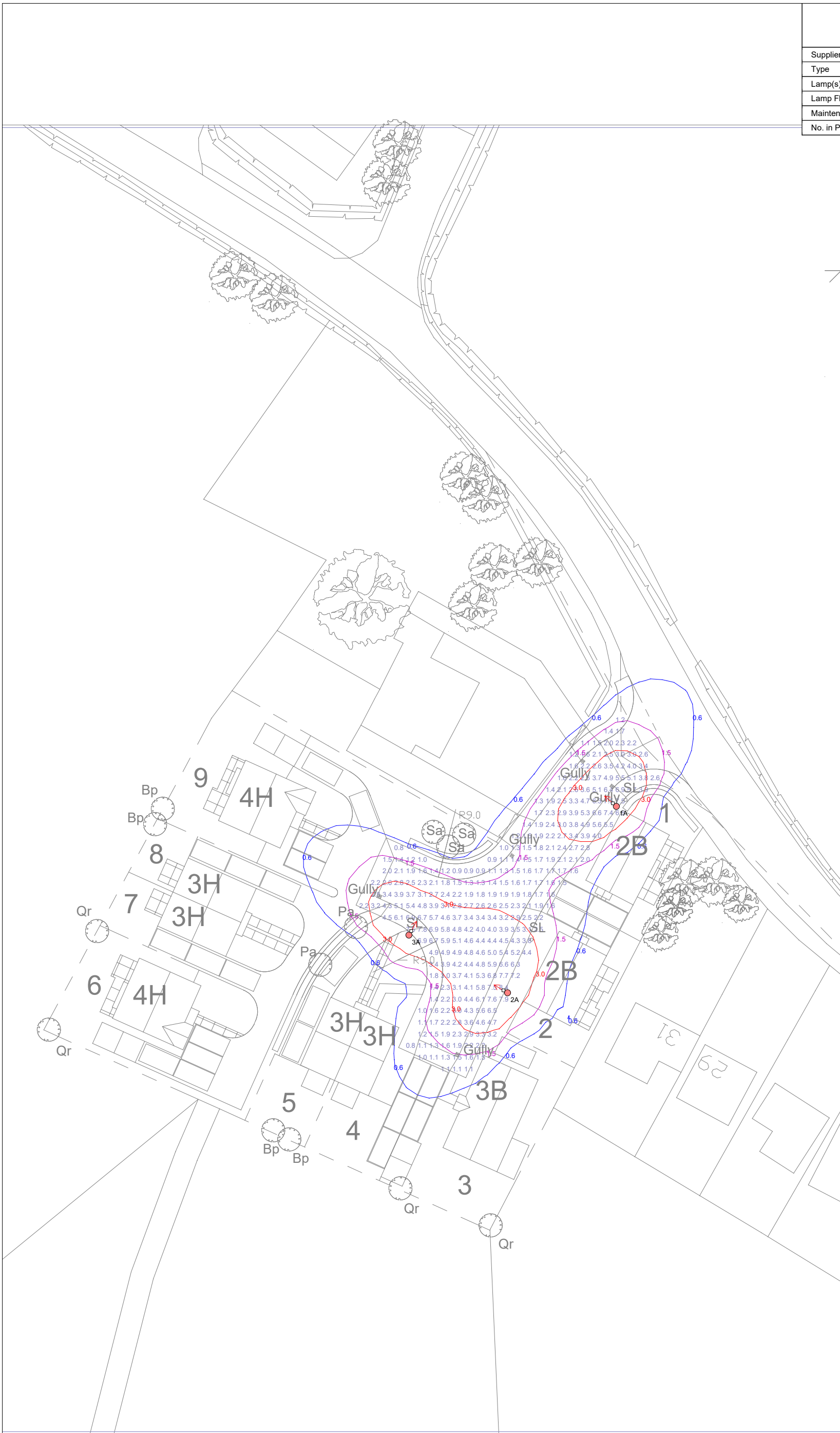

Supplier	TRT Lighting
Type	OPM4 LED 19W GR2 (Red) 3000 K EXP
Lamp(s)	42 0019 0000 100
Lamp Flux (klm)	2.64
Maintenance Factor	0.83
No. in Project	3

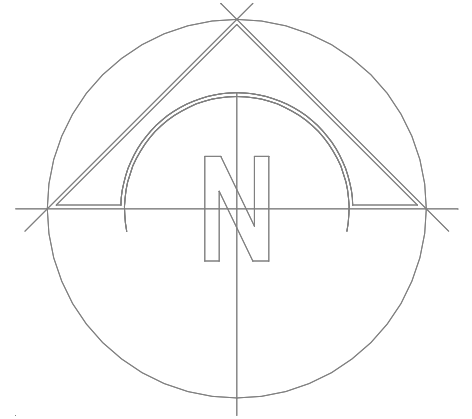

PROJECT NAME:
Gate Farm, Trewern

PROJECT No:
Design Check (R0) DIMMED 50%

SCALE: 1:500 **DATE:** 25 January 2022

CALCULATION:
Horizontal Illuminance (lux)

DESIGNER:
Pete Harris

Lighting Residential Roads - Designed in Accordance with BS5489-1:2020
The main purpose of lighting for subsidiary roads, namely access roads, residential roads and associated pedestrian areas, footpaths and cycle tracks and areas associated with those roads is to enable pedestrians and cyclists to orientate themselves and detect vehicular and other hazards, and to discourage crime against people and property. The lighting on such roads can provide some guidance for motorists, but is unlikely to be sufficient for revealing objects on the road without the use of headlights.

P5 - Eav = 3.00-4.50 Lux, Emin 0.60 Lux [DIMMED 50%]
≤6.00m in environmental zones E1 or E2 from BS5489 LMF = 0.92
Maintenance factor = LLMF x LMF = 0.90 x 0.92 = 0.83
Pre-programmed to dim to 50% between Midnight and 05.00am and labelled PN50 on heat sink

No account is taken for the blocking effect caused by buildings, trees etc. The calculation shown by this drawing assumes that the whole area being considered is in the same plane, i.e. there are no changes in gradient or elevation.

This lighting design proposal is a suggested lighting layout to present how TRT products could be used to meet the design criteria. No design risk assessment has been conducted for the lighting layout and TRT may not have undertaken a site survey. The lighting design has been based entirely on information supplied by others and therefore TRT cannot be held responsible for any risk associated with implementation of the design. This lighting design proposal should be considered only as guidance and not as a final design for the purposes of Construction Design and Management Regs 2015.

PREPARED BY:
Pete Harris
Senior Applications Engineer | Exterior Lighting
T: +44(0)1527 521162 | M: +44(0)7767 160 417
E: pete.harris@trtlighting.co.uk
W: www.trtlighting.co.uk
TRT Lighting Ltd. | Heming Point | Claybrook Drive
Washford Ind Est | Redditch | B98 0FH

Results Grid 1	
Eav	3.17
Emin	0.79
Emax	8.45
Emin/Emax	0.09
Emin/Eav	0.25